

Submit 5 Copies  
Appropriate District Office  
DISTRICT I  
P.O. Box 1980, Hobbs, NM 88240

DISTRICT II  
P.O. Drawer DD, Artesia, NM 88210

DISTRICT III  
1000 Rio Brazos Rd., Aztec, NM 87410

RECEIVED

State of New Mexico  
Energy, Minerals and Natural Resources Department

JUL 14 '89

OIL CONSERVATION DIVISION

P.O. Box 2088  
Santa Fe, New Mexico 87504-2088

Form C-104  
Revised 1-1-89  
See Instructions  
at Bottom of Page

Transporter	Oil	<input checked="" type="checkbox"/>
Operator	Gas	<input checked="" type="checkbox"/>

O. C. D.

ARTESIA OFFICE

REQUEST FOR ALLOWABLE AND AUTHORIZATION  
TO TRANSPORT OIL AND NATURAL GAS

Operator YATES PETROLEUM CORPORATION	Well API No. API #30-015-25183
Address 105 South 4th St., Artesia, New Mexico 88210	
Reason(s) for Filing (Check proper box) <input type="checkbox"/> Other (Please explain)	
New Well <input type="checkbox"/>	Change in Transporter of:
Recompletion <input checked="" type="checkbox"/>	Oil <input type="checkbox"/> Dry Gas <input type="checkbox"/>
Change in Operator <input type="checkbox"/>	Casinghead Gas <input type="checkbox"/> Condensate <input type="checkbox"/>

If change of operator give name  
and address of previous operator

II. DESCRIPTION OF WELL AND LEASE

Lease Name Powell-Kissinger BS	Well No. 2	Pool Name, Including Formation Eagle Creek Permo Penn	Kind of Lease State, Federal or Fee	Lease No. FEE
Location Unit Letter 0 : 990 Feet From The South Line and 1650 Feet From The East Line Section 33 Township 17S Range 25E, NMPM, Eddy County				

III. DESIGNATION OF TRANSPORTER OF OIL AND NATURAL GAS

Name of Authorized Transporter of Oil <input type="checkbox"/> or Condensate <input checked="" type="checkbox"/> Navajo Refining Co.	Address (Give address to which approved copy of this form is to be sent) PO Box 159, Artesia, NM 88210					
Name of Authorized Transporter of Casinghead Gas <input type="checkbox"/> or Dry Gas <input checked="" type="checkbox"/> Transwestern Pipeline Co.	Address (Give address to which approved copy of this form is to be sent) PO Box 1188, Houston, TX 77001					
If well produces oil or liquids, give location of tanks.	Unit 0	Sec. 33	Twp. 17s	Rge. 25e	Is gas actually connected? YES	When ? RECONNECTED 7-5-89

If this production is commingled with that from any other lease or pool, give commingling order number:

IV. COMPLETION DATA

Designate Type of Completion - (X)	Oil Well	Gas Well	New Well	Workover	Deepen	Plug Back	Same Res'v	Diff Res'v
		X				X		X
Date Spudded RECOMPLETION 6-12-89	Date Compl. Ready to Prod. 6-19-89		Total Depth 8500'		P.B.T.D. 6770'			
Elevations (DF, RKB, RT, GR, etc.) 3552' GR	Name of Producing Formation Cisco		Top Oil/Gas Pay 6492'		Tubing Depth 6465'			
Perforations 6492-6639'					Depth Casing Shoe 8500'			
TUBING, CASING AND CEMENTING RECORD								
HOLE SIZE	CASING & TUBING SIZE		DEPTH SET		SACKS CEMENT			
17 1/2"	13-3/8"		249'		259 sx (in place)			
12 1/2"	8-5/8"		1120'		600 sx (in place)			
7-7/8"	5 1/2"		8500'		1895 sx (in place)			
	2-7/8"		6465'					

V. TEST DATA AND REQUEST FOR ALLOWABLE

OIL WELL (Test must be after recovery of total volume of load oil and must be equal to or exceed top allowable for this depth or be for full 24 hours.)

Date First New Oil Run To Tank	Date of Test	Producing Method (Flow, pump, gas lift, etc.)	
Length of Test	Tubing Pressure	Casing Pressure	Choke Size
Actual Prod. During Test	Oil - Bbls.	Water - Bbls.	Gas - MCF

GAS WELL

Actual Prod. Test - MCF/D 708	Length of Test 12 hrs	Bbls. Condensate/MMCF -	Gravity of Condensate -
Testing Method (pilot, back pr.) Back Pressure	Tubing Pressure (Shut-in) 195 psi	Casing Pressure (Shut-in) Pkr	Choke Size 24/64"

VI. OPERATOR CERTIFICATE OF COMPLIANCE

I hereby certify that the rules and regulations of the Oil Conservation  
Division have been complied with and that the information given above  
is true and complete to the best of my knowledge and belief.

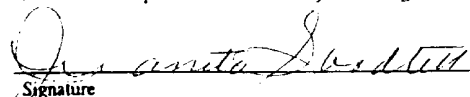

Signature  
Juanita Goodlett, Production Supervisor

Printed Name  
7-13-89 Title  
505/748-1471

Date  
Telephone No.

OIL CONSERVATION DIVISION

Date Approved JUL 31 1989

By ORIGINAL SIGNED BY

MIKE WILLIAMS

Title SUPERVISOR, DISTRICT II

INSTRUCTIONS: This form is to be filed in compliance with Rule 1104

- 1) Request for allowable for newly drilled or deepened well must be accompanied by tabulation of deviation tests taken in accordance with Rule 111.
- 2) All sections of this form must be filled out for allowable on new and recompleted wells.
- 3) Fill out only Sections I, II, III, and VI for changes of operator, well name or number, transporter, or other such changes.
- 4) Submit Form C-104 must be filed for each well in multiply completed wells.

STATE OF NEW MEXICO  
ENERGY AND MINERALS DEPARTMENT

OIL CONSERVATION DIVISION

P. O. BOX 2688

SANTA FE, NEW MEXICO 87501

Form C-102  
Revised 10-1-78

RECEIVED  
All distances must be from the outer boundaries of the Section.

Operator Yates Petroleum Corporation			Lease Powell-Kissinger BS			Well No. 2
Unit Letter 0	Section 33	Township 17 South	Range O. C. D.	County 25 East	Eddy	
Actual Footage Location of Well:						
990 feet from the South		ARTESIA, OFFICE line and 1650		feet from the East		line
Ground Level Elev. 3552'	Producing Formation Permo Penn		Pool Eagle Creek Permo Penn		Dedicated Acreage: 320 Acres	

1. Outline the acreage dedicated to the subject well by colored pencil or hatchure marks on the plat below.
2. If more than one lease is dedicated to the well, outline each and identify the ownership thereof (both as to working interest and royalty).
3. If more than one lease of different ownership is dedicated to the well, have the interests of all owners been consolidated by communitization, unitization, force-pooling, etc?

☐ Yes ☒ No If answer is "yes," type of consolidation \_\_\_\_\_

If answer is "no," list the owners and tract descriptions which have actually been consolidated. (Use reverse side of this form if necessary.) \_\_\_\_\_

No allowable will be assigned to the well until all interests have been consolidated (by communitization, unitization, forced-pooling, or otherwise) or until a non-standard unit, eliminating such interests, has been approved by the Division.

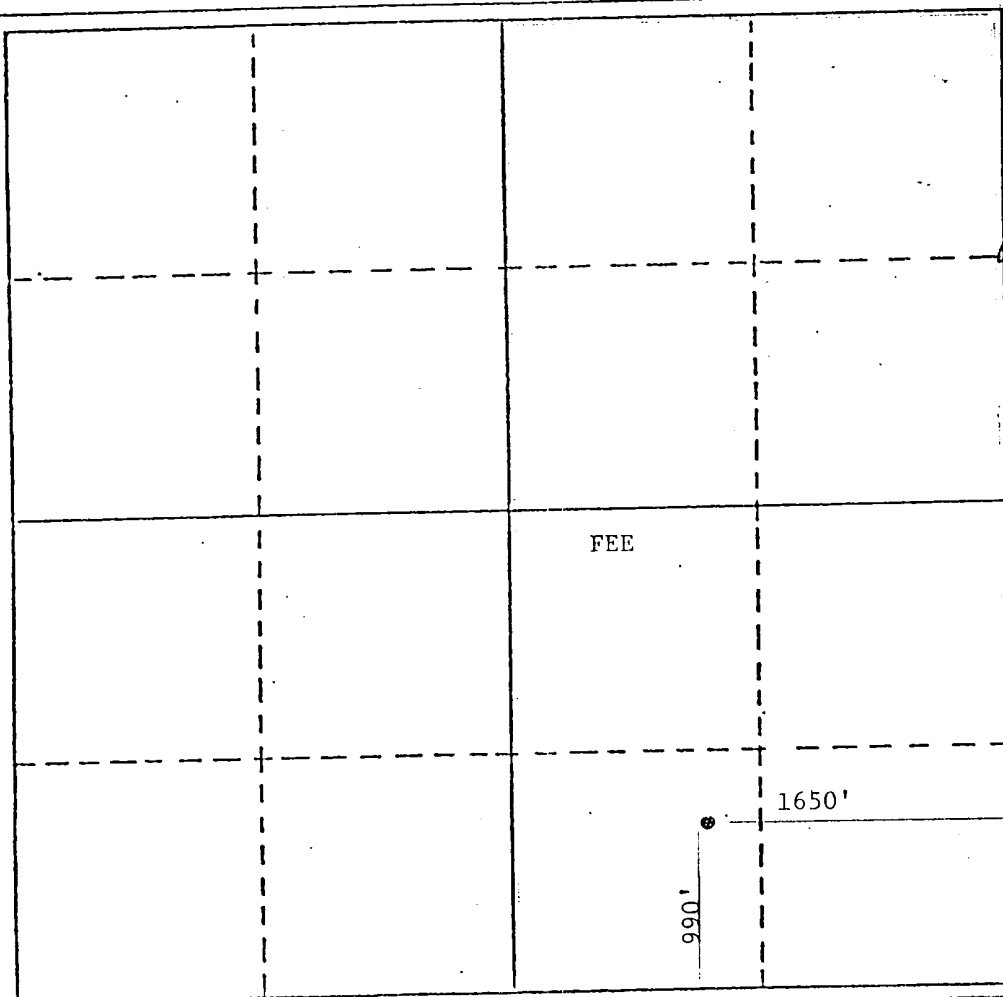

CERTIFICATION

I hereby certify that the information contained herein is true and complete to the best of my knowledge and belief.

*Juanita Goodlett*  
Name

Juanita Goodlett

Position  
Production Supervisor

Company  
Yates Petroleum Corporation

Date  
12-4-89

I hereby certify that the well location shown on this plat was plotted from field notes of actual surveys made by me or under my supervision, and that the same is true and correct to the best of my knowledge and belief.

REFER TO ORIGINAL PLAT.

Date Surveyed

Registered Professional Engineer  
and/or Land Surveyor

Certificate No.

0 330 660 990 1320 1650 1980 2310 2640 2970 3300 3630 3960 4290 4620 4950 5280 5610 5940 6270 6600