

30-015-25240

STATE OF NEW MEXICO
ENERGY AND MINERALS DEPARTMENT

OIL CONSERVATION DIVISION

RECEIVED BY

P. O. BOX 2088

ARTESIA, NEW MEXICO 87501

MAR 29 1985

O. C. D.

ARTESIA, OFFICE

Form C-101
Revised 10-1-78

NO. OF COPIES RECEIVED	
DISTRIBUTION	
SANTA FE	✓
FILL	✓
U.S.G.S.	2
LAND OFFICE	
OPERATOR	✓

5A. Indicate type of Lease	
STATE	✓
FEE	XX

5. State Oil & Gas Lease No.

APPLICATION FOR PERMIT TO DRILL, DEEPEN, OR PLUG BACK

1a. Type of Work

DRILL ☒DEEPEN ☐PLUG BACK ☐

b. Type of Well

OIL WELL ☒GAS WELL ☐

OTHER

SINGLE ZONE ☒MULTIPLE ZONE ☐

2. Name of Operator

Marbob Energy Corporation ✓

3. Address of Operator

P.O. Drawer 217, Artesia, N.M. 88210

4. Location of Well

UNIT LETTER M LOCATED 660 FEET FROM THE South LINE

AND 465 FEET FROM THE West LINE OF SEC. 23 TWP. 17S RGE. 28E NMADP

7. Unit A, Lease Name

8. Form or Lease Name

Tenneco Fee

9. Well No.

1

10. Field and Pool, or Wildcat
Red Lake On Grbg SA12. County
Eddy

19. Proposed Depth

3500'

19A. Formation

San Andres

19. Method or C.T.

Rotary

11. Elevations (Show whether DT, RT, etc.)

3578.8' GR

11A. Kind & Status Plug. Bond

Statewide active

11B. Drilling Contractor

Larue Drilling Co.

12. Approx. Date Work will start

4/8/85

23.

PROPOSED CASING AND CEMENT PROGRAM

SIZE OF HOLE	SIZE OF CASING	WEIGHT PER FOOT	SETTING DEPTH	SACKS OF CEMENT	EST. TOP
12 1/4"	8 5/8"	24#	500'	300	Circ.
7 7/8"	5 1/2"	15.50#	3500'	500	Attempt to circ

We propose to drill to 500', set 8 5/8" casing, reduce hole & drill on to 3500' to test the San Andres formation, run 5 1/2" casing and cement.

APPROVED FOR 180 DAYS
10-2-85
CLOSING UNDERWAY

POSTED TO
API & NL
4-5-85

1. ABOVE SPACE DESCRIBE PROPOSED PROGRAM; IF PROPOSAL IS TO DEEPEN OR PLUG BACK, GIVE DATA ON PRESENT PRODUCTIVE ZONE AND PROPOSED NEW PRODUCTIVE ZONE. GIVE BLOWOUT PREVENTER PROGRAM, IF ANY.

I hereby certify that the information above is true and complete to the best of my knowledge and belief.

Signed Carlye Purcella Title Production Clerk Date 3/28/85

(This space for State Use)

APPROVED BY Mike Williams TITLE OIL AND GAS INSPECTOR DATE APR -2 1985

CONDITIONS OF APPROVAL, IF ANY:

**N. M. MEXICO OIL CONSERVATION COMMISSION
WELL LOCATION AND ACREAGE DEDICATION PLAT**

Form C-102
Supersedes C-128
Effective 1-1-65

All distances must be from the outer boundaries of the Section

Operator MARBOB ENERGY CORP.			Lease TENNECO FEE		Well No. 1
Tract Letter M	Section 23	Township 17 SOUTH	Range 28 EAST	County EDDY	
Actual Footage Location of Well: <div style="display: flex; justify-content: space-between;"> 660 feet from the SOUTH line and 465 feet from the WEST line </div>					
Ground Level Elev. 3578.8	Producing Formation San Andres	Pool Red Lake Qn Grbg SA	Dedicated Acreage: 40 Acres		

1. Outline the acreage dedicated to the subject well by colored pencil or hatchure marks on the plat below.
2. If more than one lease is dedicated to the well, outline each and identify the ownership thereof (both as to working interest and royalty).
3. If more than one lease of different ownership is dedicated to the well, have the interests of all owners been consolidated by communitization, unitization, force-pooling, etc?

☐ Yes ☐ No If answer is "yes," type of consolidation _____

If answer is "no," list the owners and tract descriptions which have actually been consolidated. (Use reverse side of this form if necessary.) _____

No allowable will be assigned to the well until all interests have been consolidated (by communitization, unitization, forced-pooling, or otherwise) or until a non-standard unit, eliminating such interests, has been approved by the Commission.

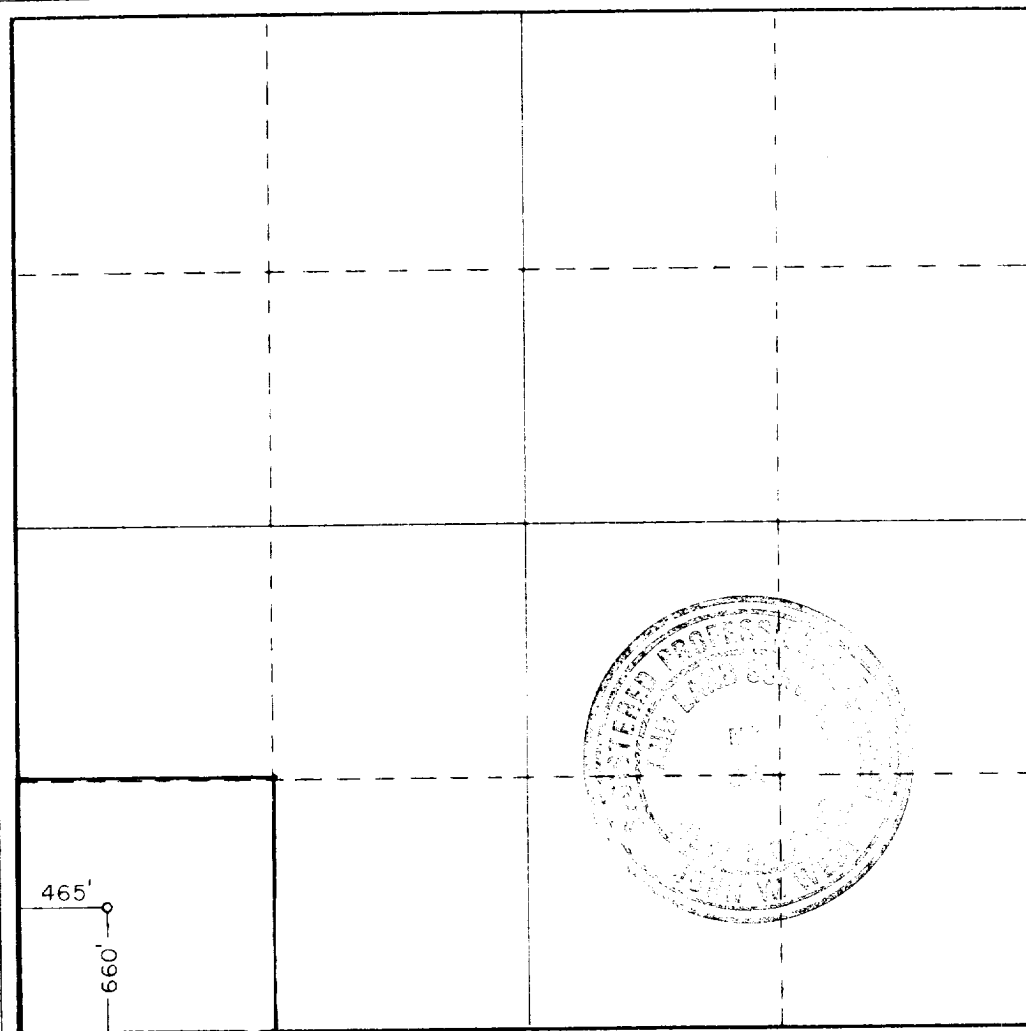

CERTIFICATION

I hereby certify that the information contained herein is true and complete to the best of my knowledge and belief.

Carolyn Purcella

Name
Carolyn Purcella

Position
Production Clerk

Company
Marbob Energy Corporation

Date
3/28/85

I hereby certify that the well location shown on this plat was plotted from field notes of actual surveys made by me or under my supervision, and that the same is true and correct to the best of my knowledge and belief.

Date Surveyed
MARCH 11, 1985

Registered Professional Engineer and/or Land Surveyor

John W. West

Certificate No. **JOHN W. WEST, 676**
RONALD J. EIDSON, 3239

0 330 660 990 1320 1650 1980 2310 2640 2970 3300 3630 3960 4290 4620 4950 5280 5610 5940 6270 6600