

UNITED STATES
DEPARTMENT OF THE INTERIOR
BUREAU OF LAND MANAGEMENT

RECEIVED BY DATE

(Other instructions on
reverse side)

JUN 03 1985

Form approved.
Budget Bureau No. 1004-0136
Expires August 31, 1985

LEASE DESIGNATION AND SERIAL NO.

NM-58033

IF INDIAN, ALLOTTEE OR TRIBE NAME

UNIT AGREEMENT NAME

FARM OR LEASE NAME

COASTAL FEDERAL

WELL NO.

1

FIELD AND POOL, OR WILDCAT

High Lonesome--Queen (Ex)

SEC., T., R., M., OR BLK.
AND SURVEY OR AREA

Sec. 19-16S-29E

COUNTY OR PARISH

Eddy

STATE

NM

1a. TYPE OF WORK

DRILL ☒

DEEPEN ☐

PLUG BACK ☐

b. TYPE OF WELL

OIL
WELL ☒

GAS
WELL ☐

OTHER

SINGLE
ZONE ☒

MULTIPLE
ZONE ☐

2. NAME OF OPERATOR

UPLAND PRODUCTION COMPANY

(Michael O. Hedrick)

(Phone 915-682-7570)

3. ADDRESS OF OPERATOR

P. O. Box 481, Midland, Texas 79702

4. LOCATION OF WELL (Report location clearly and in accordance with any State requirements.)*

At surface

1980' FNL & 1980' FEL of Section

At proposed prod. zone

same

(Unit G)

(SW 1/4 NE 1/4)

14. DISTANCE IN MILES AND DIRECTION FROM NEAREST TOWN OR POST OFFICE*

18 miles east-northeast of Artesia, NM

15. DISTANCE FROM PROPOSED*

LOCATION TO NEAREST

PROPERTY OR LEASE LINE, FT.

(Also to nearest drlg. unit line, if any)

660'

(660')

16. NO. OF ACRES IN LEASE

40

17. NO. OF ACRES ASSIGNED
TO THIS WELL

40

18. DISTANCE FROM PROPOSED LOCATION*

TO NEAREST WELL, DRILLING, COMPLETED,

OR APPLIED FOR, ON THIS LEASE, FT.

NA

19. PROPOSED DEPTH

1900' Queen

20. ROTARY OR CABLE TOOLS

Rotary

21. ELEVATIONS (Show whether DF, RT, GR, etc.)

3637' G.L.

22. APPROX. DATE WORK WILL START*

June 1, 1985

23.

PROPOSED CASING AND CEMENTING PROGRAM

SIZE OF HOLE	SIZE OF CASING	WEIGHT PER FOOT	SETTING DEPTH	QUANTITY OF CEMENT
12 1/4"	8 5/8"	24.0#	250/280'	Sufficient to circulate
7 7/8"	4 1/2"	10.5#	1900'	150 sacks

Pay zone will be selectively perforated and stimulated as needed for optimum production.

Attached are: 1. Well Location & Acreage Dedication Plat
2. Supplemental Drilling Data
3. Surface Use Plan

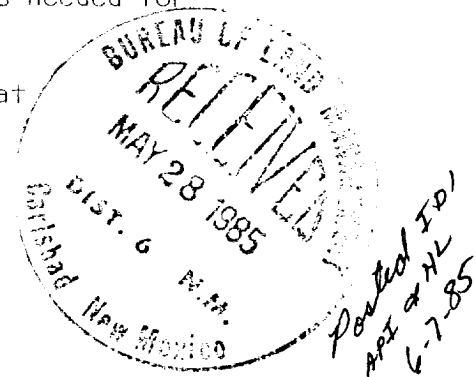

IN ABOVE SPACE DESCRIBE PROPOSED PROGRAM: If proposal is to deepen or plug back, give data on present productive zone and proposed new productive zone. If proposal is to drill or deepen directionally, give pertinent data on subsurface locations and measured and true vertical depths. Give blowout preventer program, if any.

24.

SIGNED

James A. Knaut

TITLE

Agent

DATE

May 23, 1985

(This space for Federal or State office use)

PERMIT NO.

APPROVAL DATE

APPROVED BY

TITLE

DATE

5-31-85

CONDITIONS OF APPROVAL, IF ANY:

APPROVAL SUBJECT TO
GENERAL REQUIREMENTS AND
SPECIAL STIPULATIONS

*See Instructions On Reverse Side

NEW MEXICO OIL CONSERVATION COMMISSION
WELL LOCATION AND ACREAGE DEDICATION PLAT

Form C-102
 Supersedes C-128
 Effective 1-1-65

All distances must be from the outer boundaries of the Section

Operator UPLAND PRODUCTION CO.			Lease COASTAL FED.			Well No. 1		
Tract Letter G	Section 19	Township 16S	Range 29E	County EDDY				
Actual Portage Location of Well:								
1980		feet from the NORTH		line and 1980		feet from the EAST		line
Ground Level Elev. 3637.2	Producing Formation Queen		Pool High Lonesome--Queen			Dedicated Acreage: 40 Acres		

1. Outline the acreage dedicated to the subject well by colored pencil or hachure marks on the plat below.
2. If more than one lease is dedicated to the well, outline each and identify the ownership thereof (both as to working interest and royalty).
3. If more than one lease of different ownership is dedicated to the well, have the interests of all owners been consolidated by communitization, unitization, force-pooling, etc?

☒ Yes ☐ No If answer is "yes," type of consolidation _____

If answer is "no," list the owners and tract descriptions which have actually been consolidated. (Use reverse side of this form if necessary.) _____

No allowable will be assigned to the well until all interests have been consolidated (by communitization, unitization, forced-pooling, or otherwise) or until a non-standard unit, eliminating such interests, has been approved by the Commission.

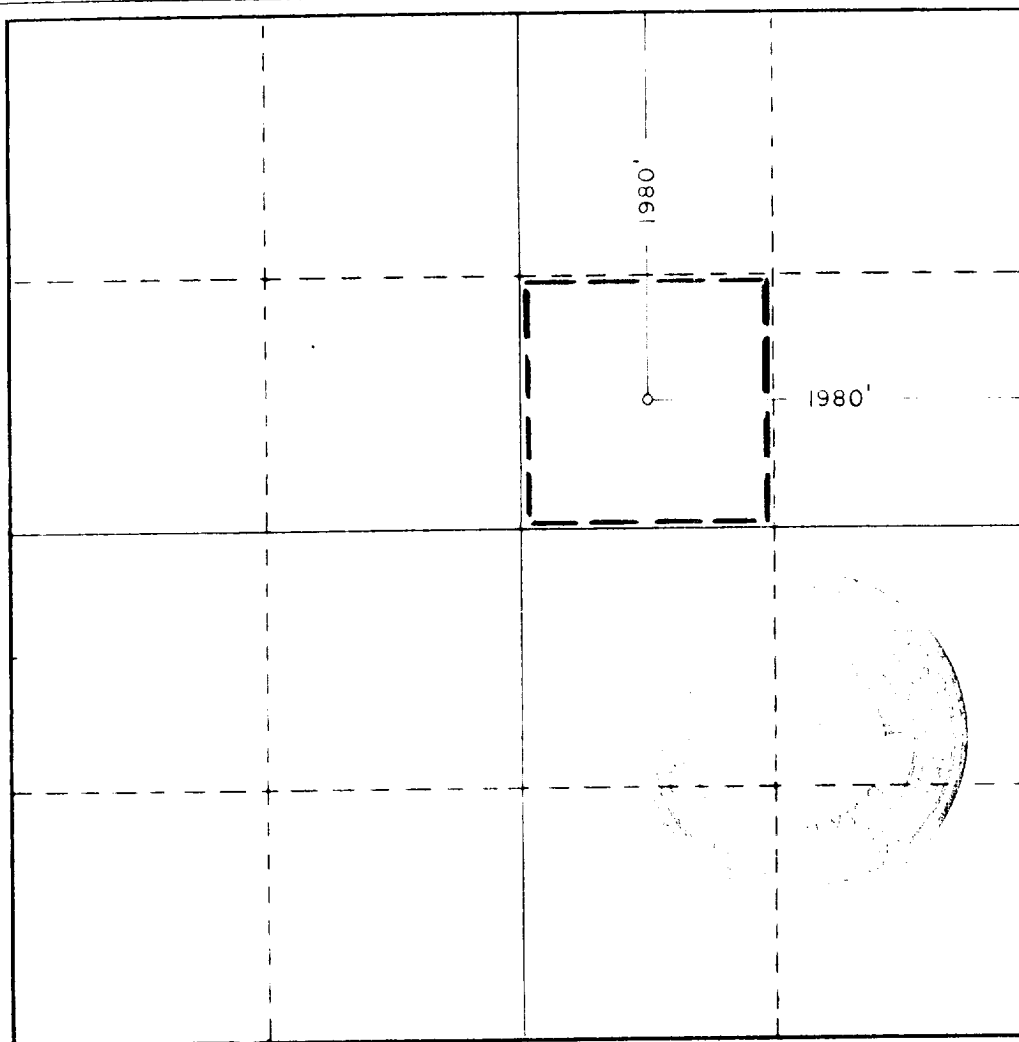

CERTIFICATION

I hereby certify that the information contained herein is true and complete to the best of my knowledge and belief.

James A. Knauf

Name
James A. Knauf

Position
Agent

Company
UPLAND PRODUCTION COMPANY

Date
May 23, 1985

I hereby certify that the well location shown on this plat was plotted from field notes of actual surveys made by me or under my supervision, and that the same is true and correct to the best of my knowledge and belief.

Date Surveyed
5/11/85

Registered Professional Engineer and/or Land Surveyor

John W. West

Certificate No. **JOHN W. WEST, 676**
RONALD J. EIDSON, 3239

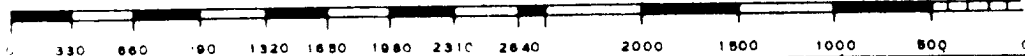

BLOWOUT PREVENTER ARRANGEMENT

Upland Production Company
Well #1 Coastal Federal
SW $\frac{1}{4}$ NE $\frac{1}{4}$ Sec. 19-16S-29E

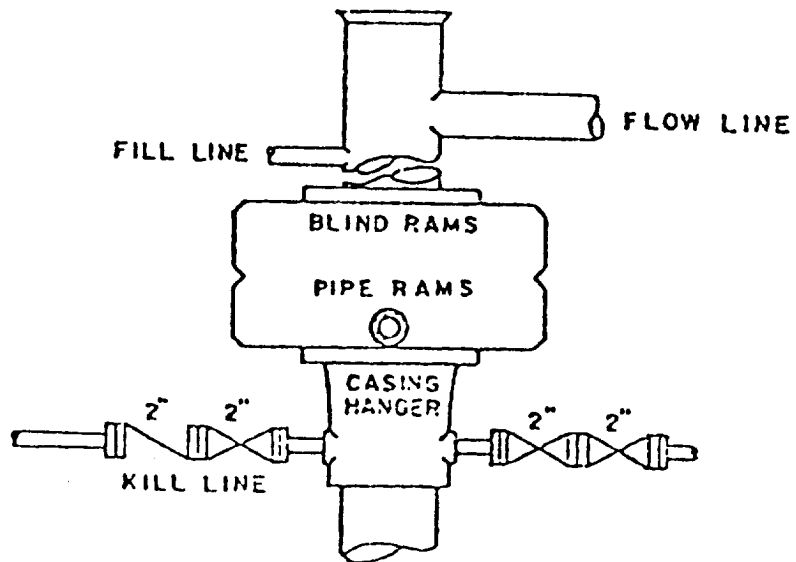

SUPPLEMENTAL DRILLING DATA

UPLAND PRODUCTION COMPANY
WELL #1 COASTAL FEDERAL
SW $\frac{1}{4}$ NE $\frac{1}{4}$ SEC. 19-16S-29E
EDDY COUNTY, NEW MEXICO

1. SURFACE FORMATION: Sandy soils of Quaternary Age.
2. ESTIMATED TOPS OF GEOLOGIC MARKERS: (Elevation 3637' G.L.)

Anhydrite	250'	Seven Rivers	920'
Salt	280'	Queen	1510'
Base Salt	620'	Penrose	1740'
Yates	770'	Grayburg	1900'

3. ANTICIPATED POROSITY ZONES:

Water: Above 150'
Oil: Seven Rivers, Queen, and Grayburg.

4. CASING DESIGN:

<u>Size</u>	<u>Interval</u>	<u>Weight</u>	<u>Grade</u>	<u>Joint</u>
8 5/8"	0 - 280'	24.0#	K-55	STC
4 1/2"	0 - 1900'	10.5#	K-55	STC

5. PRESSURE CONTROL EQUIPMENT: An annular or a Double Ram-Type Preventer.

6. CIRCULATING MEDIUM:

0 - 280' Fresh water mud with gel or lime as needed for viscosity control.

280 - 1500' Brine water.

1500 - 1900' Salt water mud, conditioned as necessary for control of viscosity and water loss.

7. AUXILIARY EQUIPMENT: Drill string safety valve.
8. TESTING, LOGGING AND CORING PROGRAMS: No coring or DST's are planned. Electric Logs will include a CNL-FDC w/GR.
9. ABNORMAL PRESSURES, TEMPERATURES OR GASES: None anticipated.
10. ANTICIPATED STARTING DATE: It is planned that operations will commence about June 1, 1985. Duration of drilling, testing, and completion operations should be 10-40 days.

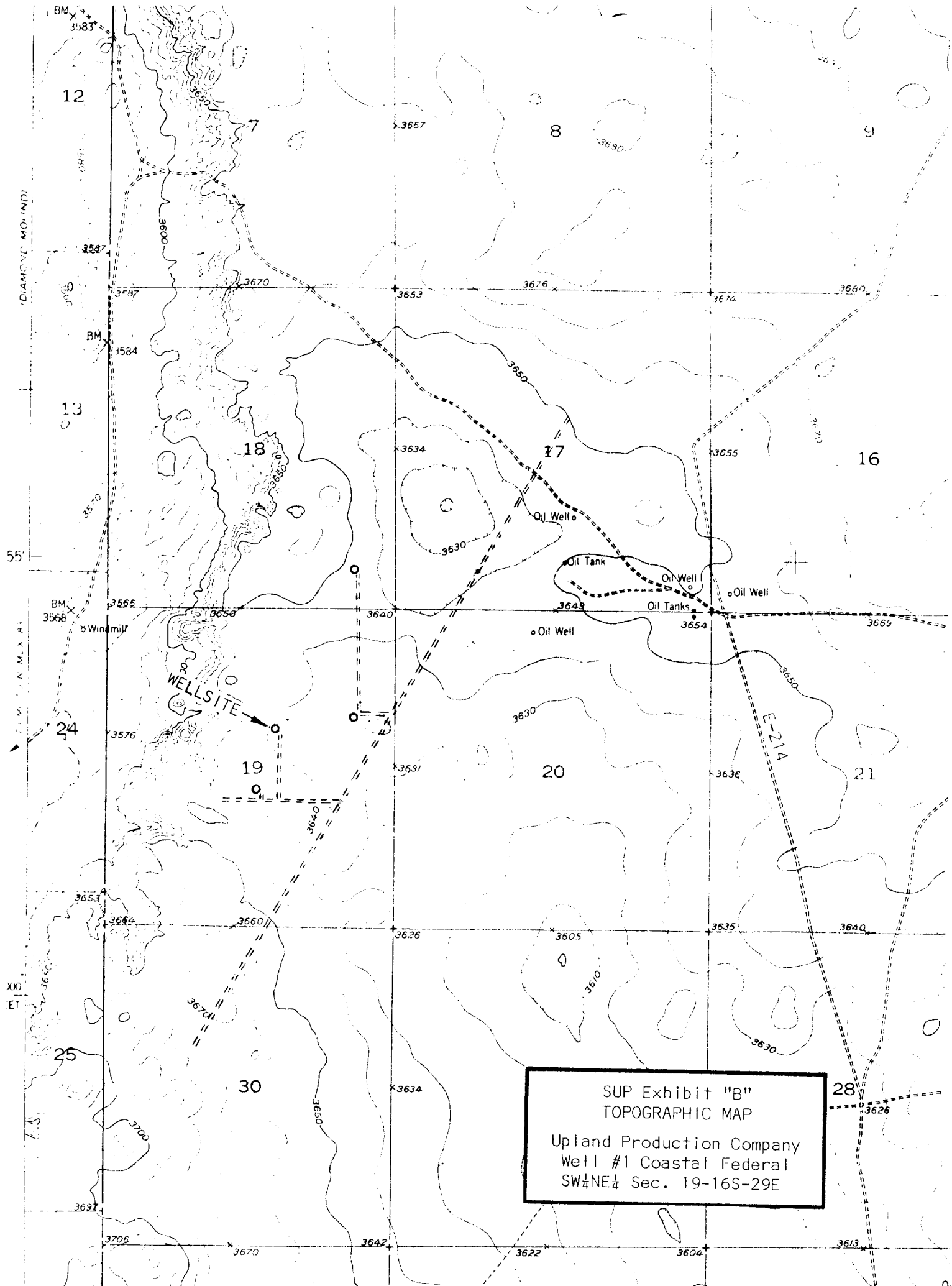

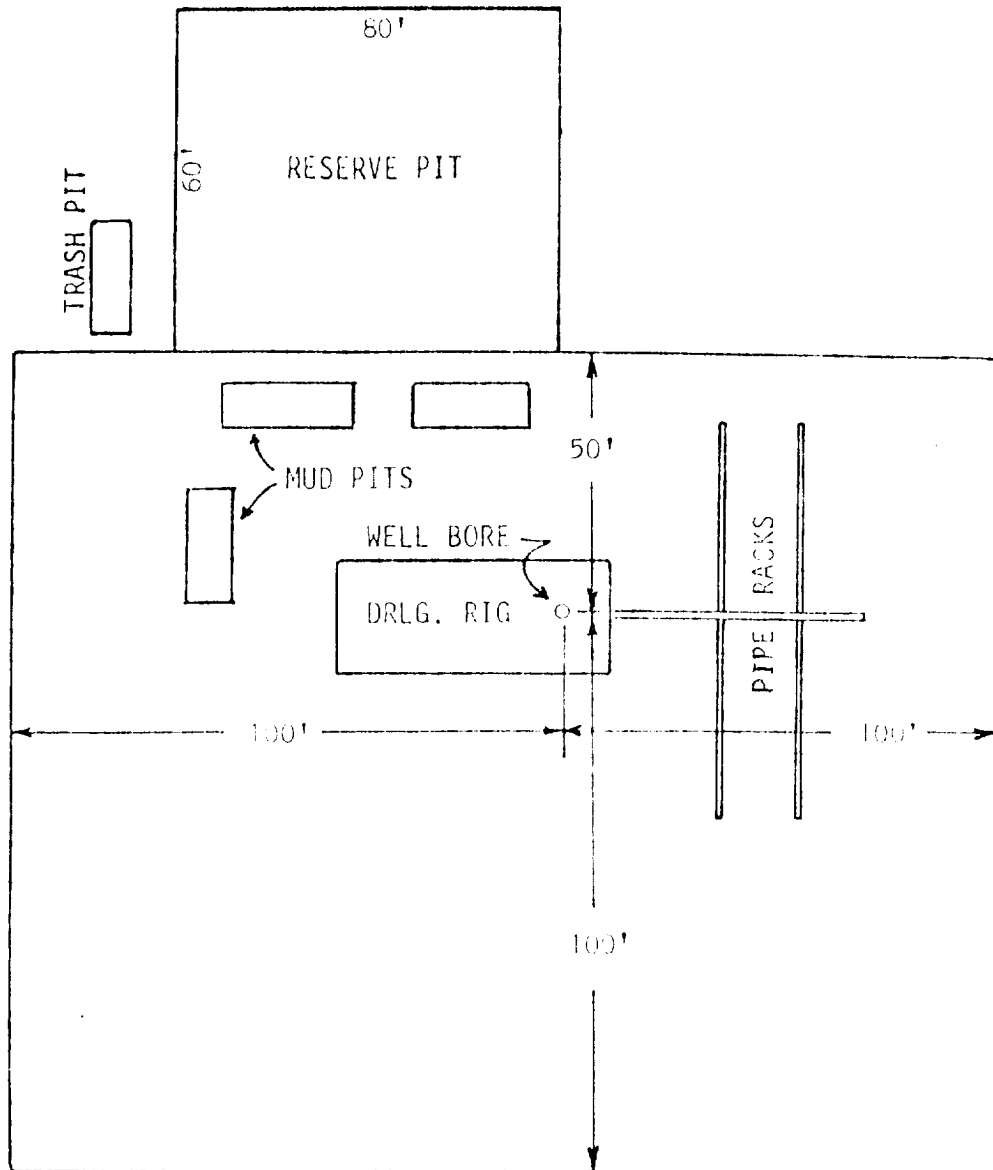

SUP Exhibit "D"
 SKETCH OF WELL PAD
 Upland Production Company
 Well #1 Coastal Federal
 SW $\frac{1}{4}$ NE $\frac{1}{4}$ Sec. 19-16S-29E