

N MEXICO OIL CONSERVATION COMMISS
WELL LOCATION AND ACREAGE DEDICATION PLAT

Form C-124
 Supersedes C-128
 Effective 1-1-85

All distances must be from the outer boundaries of the Section

Operator J. CLEO THOMPSON & JAMES CLEO THOMPSON JR. A PARTNERSHIP UNIT OPERATOR			Lease WEST SQUARE LAKE UNIT TRACT 6		Well No. 9
Unit Letter N	Section 35	Township 16S	Range 30E	County EDDY	
Actual Footage Location of Well: 720 feet from the SOUTH line and 1345 feet from the WEST line					
Ground Level Elev. 3781.0	Producing Formation GRAYBURG-SAN ANDRES		Pool SQUARE LAKE GRAYBURG-SAN ANDRES		Dedicated Acreage 40

1. Outline the acreage dedicated to the subject well by colored pencil or hatchure marks on the plat below.
2. If more than one lease is dedicated to the well, outline each and identify the ownership thereof (both as to working interest and royalty).
3. If more than one lease of different ownership is dedicated to the well, have the interests of all owners been consolidated by communitization, unitization, force-pooling, etc?

☐ Yes ☐ No If answer is "yes," type of consolidation _____

If answer is "no," list the owners and tract descriptions which have actually been consolidated. (Use reverse side of this form if necessary.) _____

No allowable will be assigned to the well until all interests have been consolidated (by communitization, unitization, forced-pooling, or otherwise) or until a non-standard unit, eliminating such interests, has been approved by the Commission.

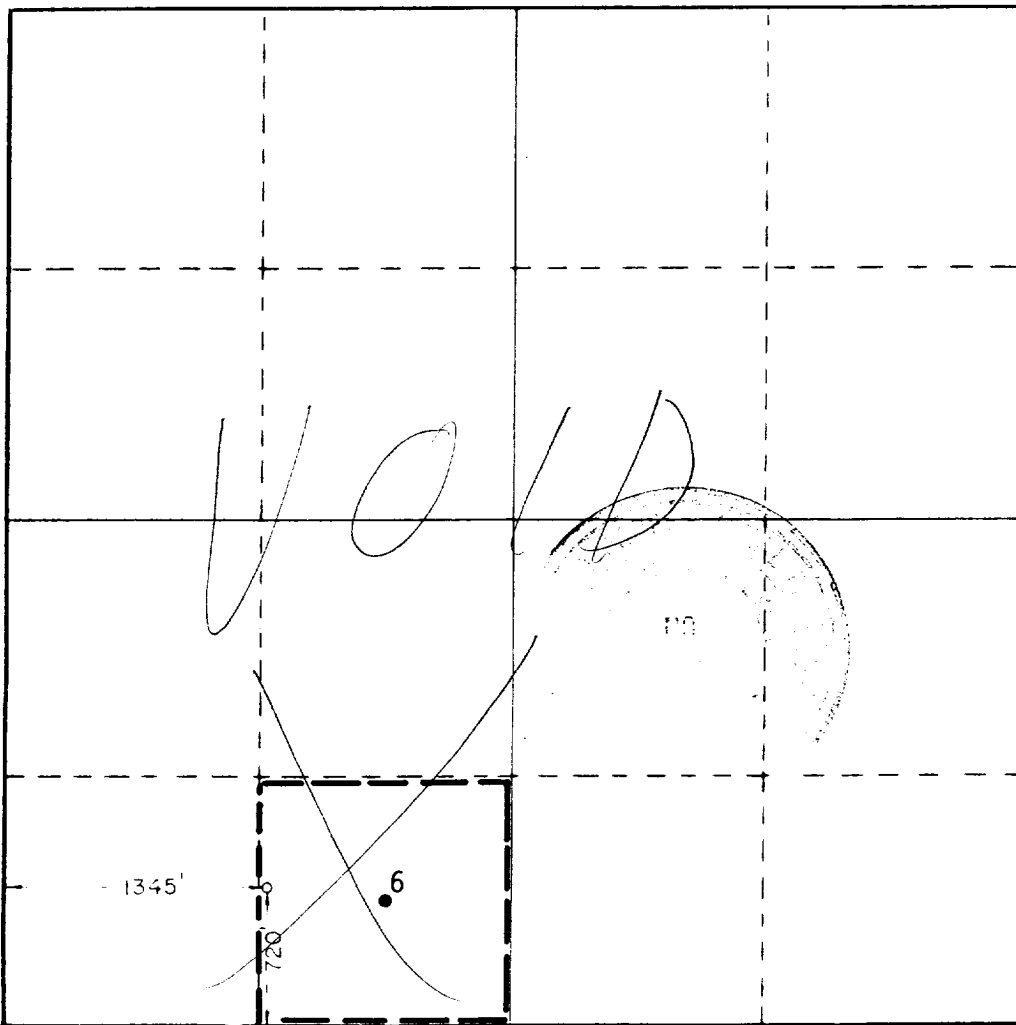

CERTIFICATION

I hereby certify that the information contained herein is true and complete to the best of my knowledge and belief.

Name *Arthur R. Brown*
Arthur R. Brown

Position
Agent

Company **J. CLEO THOMPSON & JAMES CLEO THOMPSON, JR.**

Date
JUNE 20, 1985

I hereby certify that the well location shown on this plat was plotted from field notes of actual surveys made by me or under my supervision, and that the same is true and correct to the best of my knowledge and belief.

Date Surveyed
6/11/85

Registered Professional Engineer and/or Land Surveyor

John W. West

Certificate No. **JOHN W. WEST, 476**
RONALD J. EIDSON, 3239