

(May 1963)

SUBMIT TRIPLICATE*

(Other instructions on reverse side)

Form approved.

Budget Bureau No. 42-R1425.

RECEIVED BY

DRAWER DE

Artesia, NM

COMMUNITY

UNITED STATES
DEPARTMENT OF THE INTERIOR
GEOLOGICAL SURVEY

OCT 10 1985

30-015-25437

5. LEASE DESIGNATION AND SERIAL NO.

NM 41655

6. IF INDIAN, ALLOTTEE OR TRIBE NAME

7. UNIT AGREEMENT NAME

8. FARM OR LEASE NAME

Scott Federal

9. WELL NO.

1

10. FIELD AND POOL, OR WILDCAT

Red Lake (O.G.S.A.)

11. SEC., T., R., M., OR BLK.
AND SURVEY OR AREA

Sec. 12-T17S-R27E

12. COUNTY OR PARISH 13. STATE

Eddy

NM

12. TYPE OF WORK

ARTESIA, OFFICE

DRILL ☒DEEPEN ☐PLUG BACK ☐

13. TYPE OF WELL

OIL WELL ☒GAS WELL ☐

OTHER

SINGLE ZONE ☐MULTIPLE ZONE ☐

2. NAME OF OPERATOR

H & S Oil Company ✓

3. ADDRESS OF OPERATOR

Suite 303, First National Bank Bldg, Artesia, NM 88210

4. LOCATION OF WELL (Report location clearly and in accordance with any State requirements.)

At surface

660' FSL and 660' FEL, Sec. 12- T17S- R27E, NMPM

At proposed prod. zone

Same

14. DISTANCE IN MILES AND DIRECTION FROM NEAREST TOWN OR POST OFFICE*

Approximately Nine (9) miles East of Artesia, NM

15. DISTANCE FROM PROPOSED*

LOCATION TO NEAREST
PROPERTY OR LEASE LINE, FT.
(Also to nearest drlg. unit line, if any)

660'

16. NO. OF ACRES IN LEASE

160

17. NO. OF ACRES ASSIGNED
TO THIS WELL

40

18. DISTANCE FROM PROPOSED LOCATION*
TO NEAREST WELL, DRILLING, COMPLETED,
OR APPLIED FOR, ON THIS LEASE, FT.

19. PROPOSED DEPTH

1850'

20. ROTARY OR CABLE TOOLS

Rotary

21. ELEVATIONS (Show whether DF, RT, GR, etc.)

3501 GR

22. APPROX. DATE WORK WILL START*

October 20, 1985

23.

PROPOSED CASING AND CEMENTING PROGRAM

SIZE OF HOLE	SIZE OF CASING	WEIGHT PER FOOT	SETTING DEPTH	QUANTITY OF CEMENT
11 1/2" / 12 1/4"	8 5/8"	29#	275'	125 sacks circulated
7 7/8"	5 1/2"	15 1/2#	1850'	515 sacks circulated

Mud Program: Exhibit F

BOP Program: Rega, See Exhibit E

IN ABOVE SPACE DESCRIBE PROPOSED PROGRAM: If proposal is to deepen or plug back, give data on present productive zone and proposed new productive zone. If proposal is to drill or deepen directionally, give pertinent data on subsurface locations and measured and true vertical depths. Give blowout preventer program, if any.

24.

SIGNED

Frederick R. Spurr

TITLE Partner

DATE 9/23/85

(This space for Federal or State office use)

PERMIT NO.

APPROVAL DATE

APPROVED BY

TITLE

DATE 10-9-85

CONDITIONS OF APPROVAL, IF ANY:

*See Instructions On Reverse Side

APPROVAL SUBJECT TO
GENERAL REQUIREMENTS AND
SPECIAL STIPULATIONS
ATTACHED

NEW MEXICO OIL CONSERVATION COMMISSION
WELL LOCATION AND ACREAGE DEDICATION PLAT

Form C-102
Supersedes C-12R
Effective 1-1-65

All distances must be from the outer boundaries of the Section.

Operator H & S Oil Company		Lease Scott Federal		Well No. 1
Unit Letter P	Section 12	Township 17 South	Range 27 East	County Eddy
Actual Well Location of Wells: 660 feet from the South line and 660 feet from the East line				
Ground Level Elev. 3501	Producing Formation		Pool Red Lake (O.G.S.A.)	Dedicated Acreage: 40 Acres

1. Outline the acreage dedicated to the subject well by colored pencil or hatchure marks on the plat below.
2. If more than one lease is dedicated to the well, outline each and identify the ownership thereof (both as to working interest and royalty).
3. If more than one lease of different ownership is dedicated to the well, have the interests of all owners been consolidated by communitization, unitization, force-pooling, etc?

☐ Yes ☐ No If answer is "yes," type of consolidation _____

If answer is "no," list the owners and tract descriptions which have actually been consolidated. (Use reverse side of this form if necessary.) _____

No allowable will be assigned to the well until all interests have been consolidated (by communitization, unitization, forced-pooling, or otherwise) or until a non-standard unit, eliminating such interests, has been approved by the Commission.

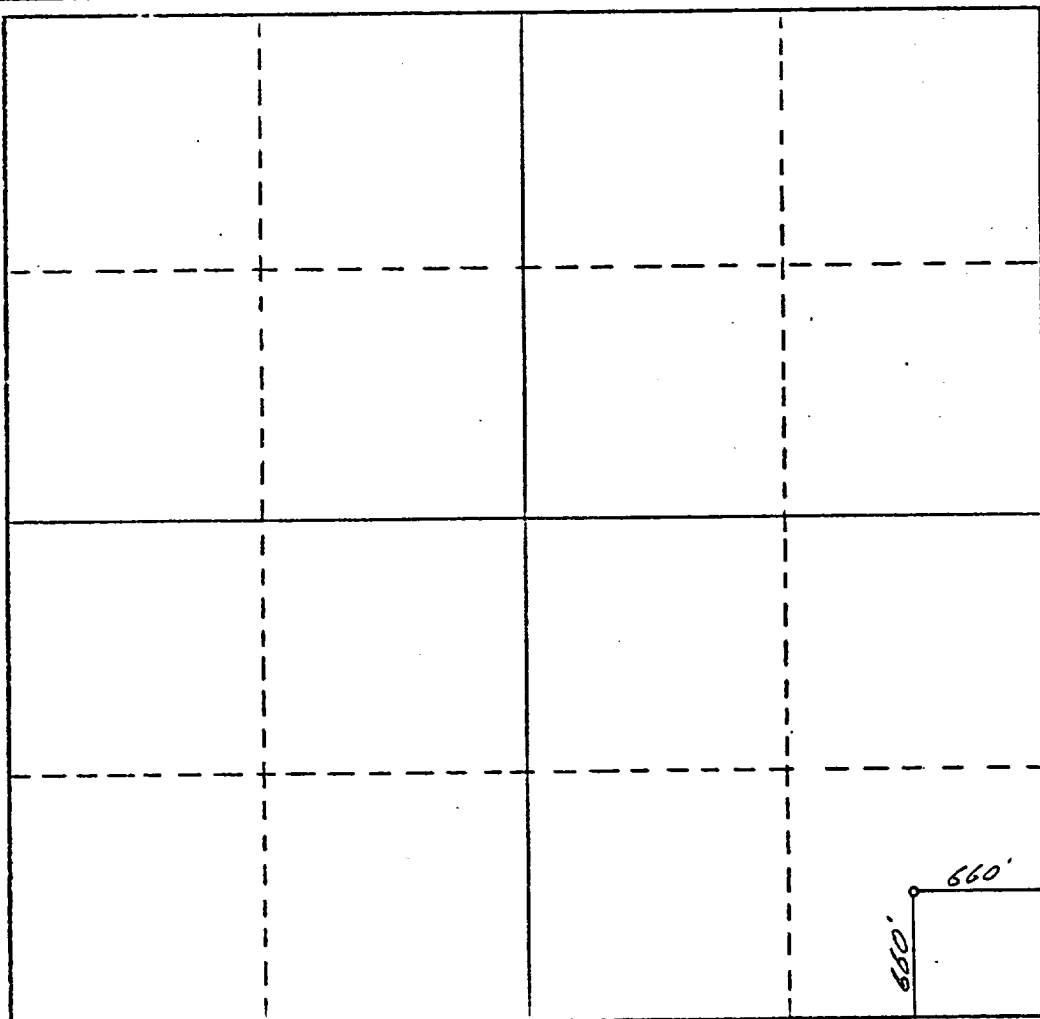

CERTIFICATION

I hereby certify that the information contained herein is true and complete to the best of my knowledge and belief.

Herbert R. Spencer
Name

Herbert R. Spencer

Position
Partner

Company
H & S OIL COMPANY

Date
9/23/85

I hereby certify that the well location shown on this plat was plotted from field notes of actual surveys made by me or under my supervision, and that the same is true and correct to the best of my knowledge and belief.

September 17, 1985

Date Surveyed
P.R. Patton

Registered Professional Engineer
and/or Land Surveyor

8112

Certificate No.

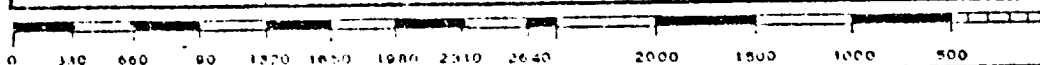
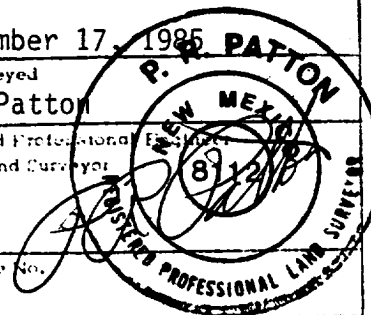

REGAN BLOWOUT PREVENTERS

The Regan Torus Blowout Preventer is used primarily on production and workover rigs for well control up to 3000 PSI working pressure

DESIGN FEATURES

- The Torus Preventer is designed for minimum height to facilitate its use with production and workover rigs.
- The rubber packer will conform to any object in the well bore. Sealing ability is not affected by minor damage to the inner bore.
- The packer will seal on open hole at full working pressure.
- The dual packer design increases the reliability of the preventer since the outer rubber is never exposed to the well bore. Under ordinary service, the outer packer is rarely replaced.

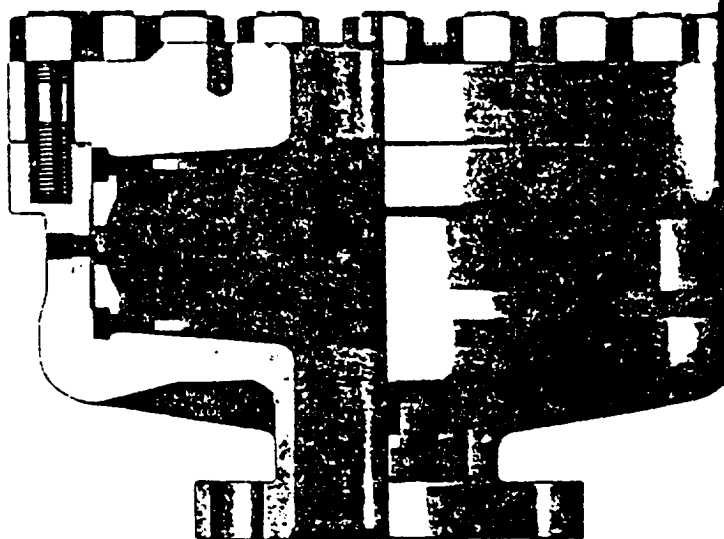

TORUS BLOWOUT PREVENTER
PATENTED

SPECIFICATIONS

Nominal Size	Test Pressure (psi)	DIMENSIONS (in.)			Weight (lb.)	End Flanges (1)	R/RX Ring Grooves	Side Outlet	(1) Bottom flange holes for use with either 2000 psi API-5B flange or used with obsolete S flange. Top flange studded for 3000 psi flange unless otherwise noted.
		Outside Diameter	Thru Bore	Overall Height					
6	3000 6000	27 23 1/2	7 1/4 7 1/4	19 1/4 21 1/4	1360 1950	Nom. 5 Nom. 6	45 45	None 2" L.P.	
8	3000	34 1/4	9	25	2625	Nom. 8	43	None	

H & S Oil Company
Scott Federal No. 1
Federal Lease No. NM 41655
660' FSL & 660' FEL
Section 12 - T17S - R27E
Eddy County, New Mexico

Application For Drilling

H & S OIL COMPANY
Scott Federal No. 1
660' FSL 660' FEL
Section 12-T17S-R27E
Eddy County, New Mexico

In conjunction with Form 9-331C, Application for Permit to Drill subject well, H & S Oil Company submits the following ten items of pertinent information in accordance with USGS requirements:

1. The geologic surface formation is Permian.
2. The estimated tops of geologic markers are as follows:

Seven Rivers	412'
Queen	980'
Grayburg	1300'
San Andres	1720'

3. The estimated depths at which anticipated water, oil or gas formations are expected to be encountered:

Water: Approximately 80' and 150'
Oil or Gas: Approximately 1720' to 1750'

4. Proposed casing program: See Form 9-331C
5. Pressure Control Equipment: See Exhibit E
6. Mud Program: See Exhibit F
7. Auxiliary Equipment: See Exhibit G
8. Testing, Logging and Coring Programs:

Logging: Electric Log Program, Compensated Neutron,
Compensated Neutron, Compensated Density &
Micro Laterlog
9. No abnormal pressures or temperatures are anticipated.
10. Anticipated starting date: As soon as possible.

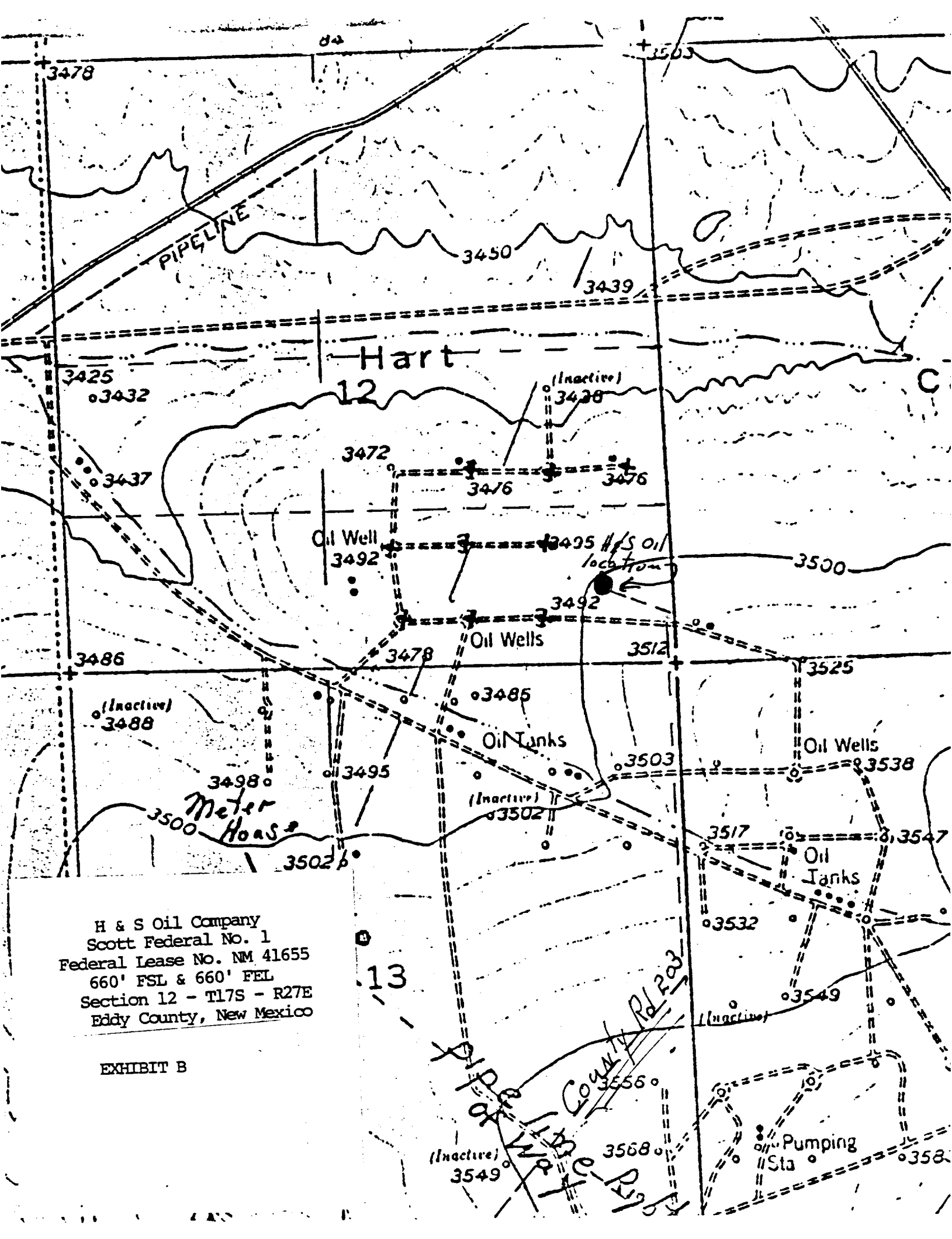

H & S Oil Company
Scott Federal No. 1
Federal Lease No. NM 41655
660' FSL & 660' FEL
Section 12 - T17S - R27E
Eddy County, New Mexico

EXHIBIT B

Scale $\frac{1}{2}" = 20'$

1N

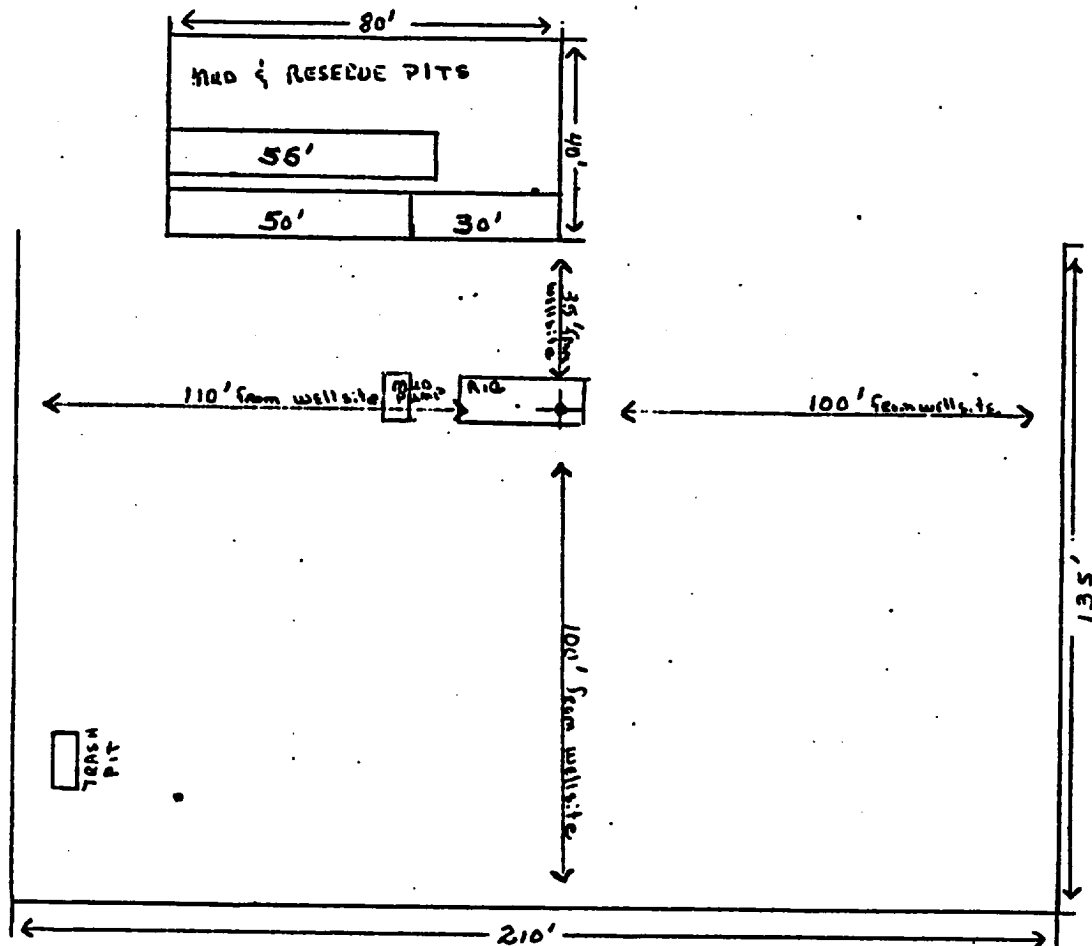

DRILLING PAD - LEVELED AND CALICHD

PITS WILL BE DUG TO COVER GARBAGE AND TRASH, WHICH WILL BE KEPT IN CONTAINERS UNTIL WELL IS COMPLETED.

H & S Oil Company
Scott Federal No. 1
Federal Lease No. NM 41655
660' FSL & 660' FEL
Section 12 - T17S - R27E
Eddy County, New Mexico

EXHIBIT D