

PROPOSED BOP STACK

8 5/8" CASING

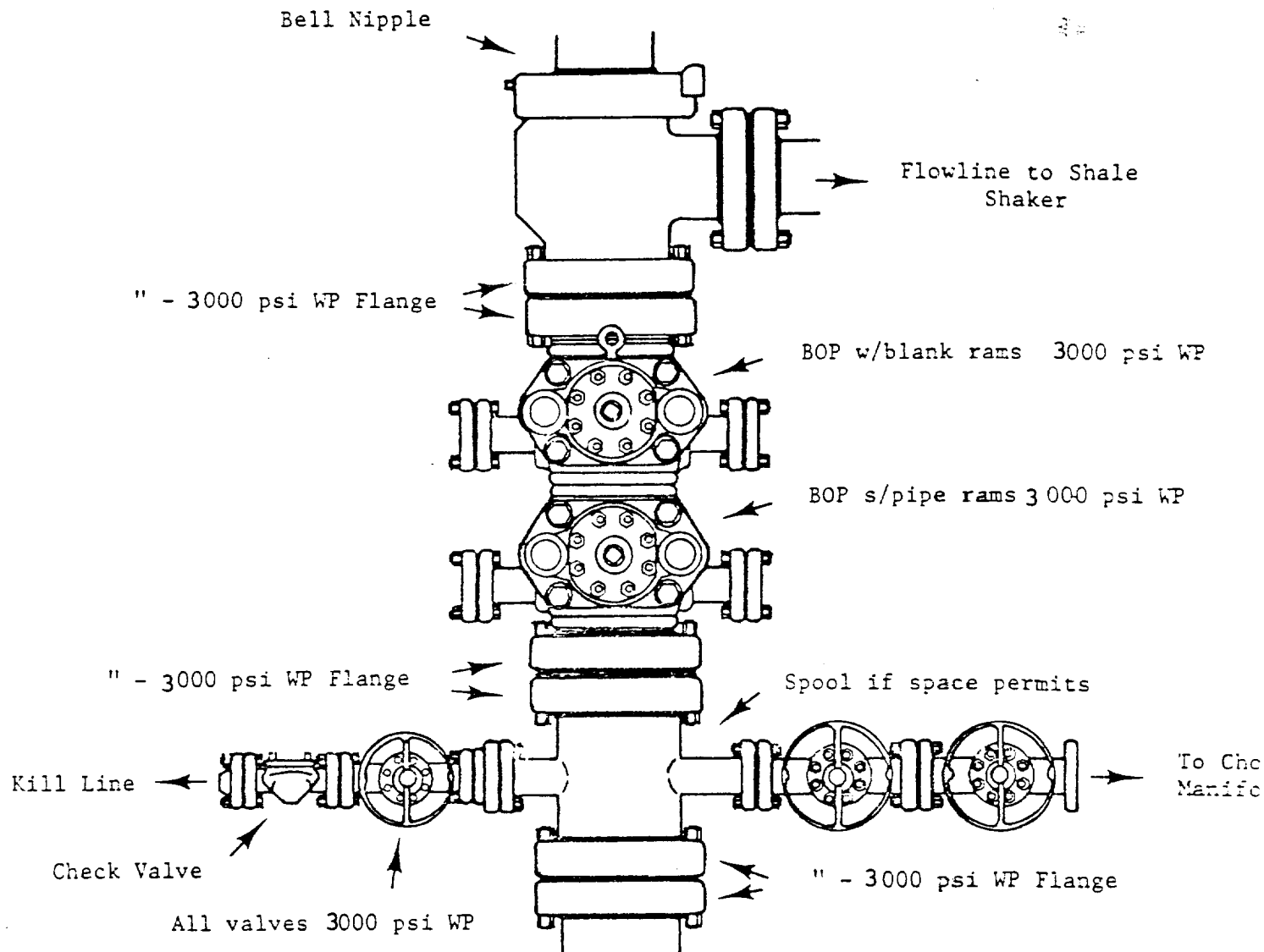

Mobil Producing  
Texas & New Mexico Inc.  
Houston, Texas

Lease Federal C Sec. 4

Well Number 1

County Eddy State NM

MOBIL PRODUCING TX. & N.M. INC.

LEASE: Federal C Sec. 4

WELL: #1

FIELD: Northeast Square Lake

COUNTY: Eddy

STATE: N.M.

TEN POINT WELL CONTROL & RESOURCE PROTECTION DATA

1. The geologic name of the surface formation \_\_\_\_\_.
2. The estimated tops of important geologic markers.

| <u>Formation Name</u> | <u>Depth (Top)</u> | <u>Formation</u>  | <u>Top</u>   |
|-----------------------|--------------------|-------------------|--------------|
| <u>Yates</u>          | <u>1970'</u>       | <u>San Andres</u> | <u>3565'</u> |
| <u>Queen</u>          | <u>2830'</u>       |                   |              |
| <u>Penrose</u>        | <u>3060'</u>       |                   |              |
| <u>Grayburg</u>       | <u>3226'</u>       |                   |              |

3. The estimated depth at which anticipated water, oil, gas or other mineral-bearing formations are expected to be encountered.

| <u>Formation Name</u> | <u>Depth (Top)</u> | <u>Type of Mineral</u> |
|-----------------------|--------------------|------------------------|
| <u>Queen</u>          | <u>2830'</u>       | <u>Oil</u>             |
| <u>(Premier</u>       |                    |                        |
| <u>Grayburg Sand)</u> | <u>3226'</u>       | <u>Oil</u>             |
| _____                 | _____              | _____                  |
| _____                 | _____              | _____                  |

4. The proposed casing program, including the size, grade, and weight-per-foot of each string and whether new or used. (Shown on Form 9-331C)
5. The lessee's or operator's minimum specifications for pressure control equipment which is to be used, a schematic diagram thereof showing sizes, pressure ratings (or API series), and the testing procedures and testing frequency. (See attachment)
6. The type and characteristics of the proposed circulating medium or mediums to be employed for rotary drilling and the quantities and types of mud and weighting material to be maintained.

See attached for 9-331-C. A sufficient quantity of mud & chemicals will  
be maintained at the well site to meet anticipated conditions, recognizing  
the time required to replenish supplies from local sources.

THIS DRAWING AND ALL INFORMATION THEREON IS THE PROPERTY OF MOBIL PRODUCING TEXAS & NEW MEXICO INC. AND SHALL NOT BE COPIED OR USED EXCEPT FOR THE PURPOSE FOR WHICH IT IS EXPRESSLY FURNISHED. THE DRAWING AND ANY COPIES THEREON (PARTIAL OR COMPLETE) SHALL BE RETURNED TO THE OWNER ON DEMAND.

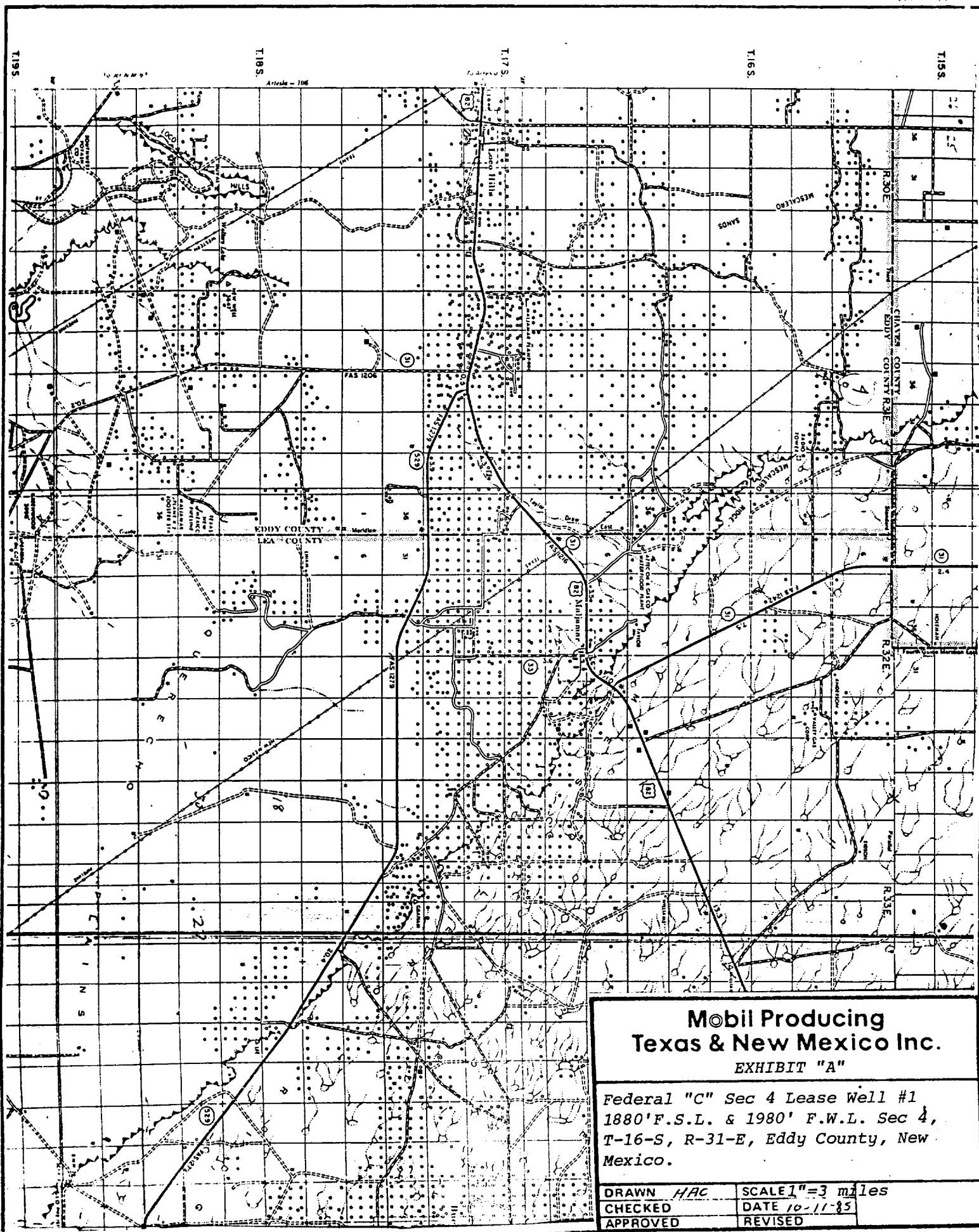

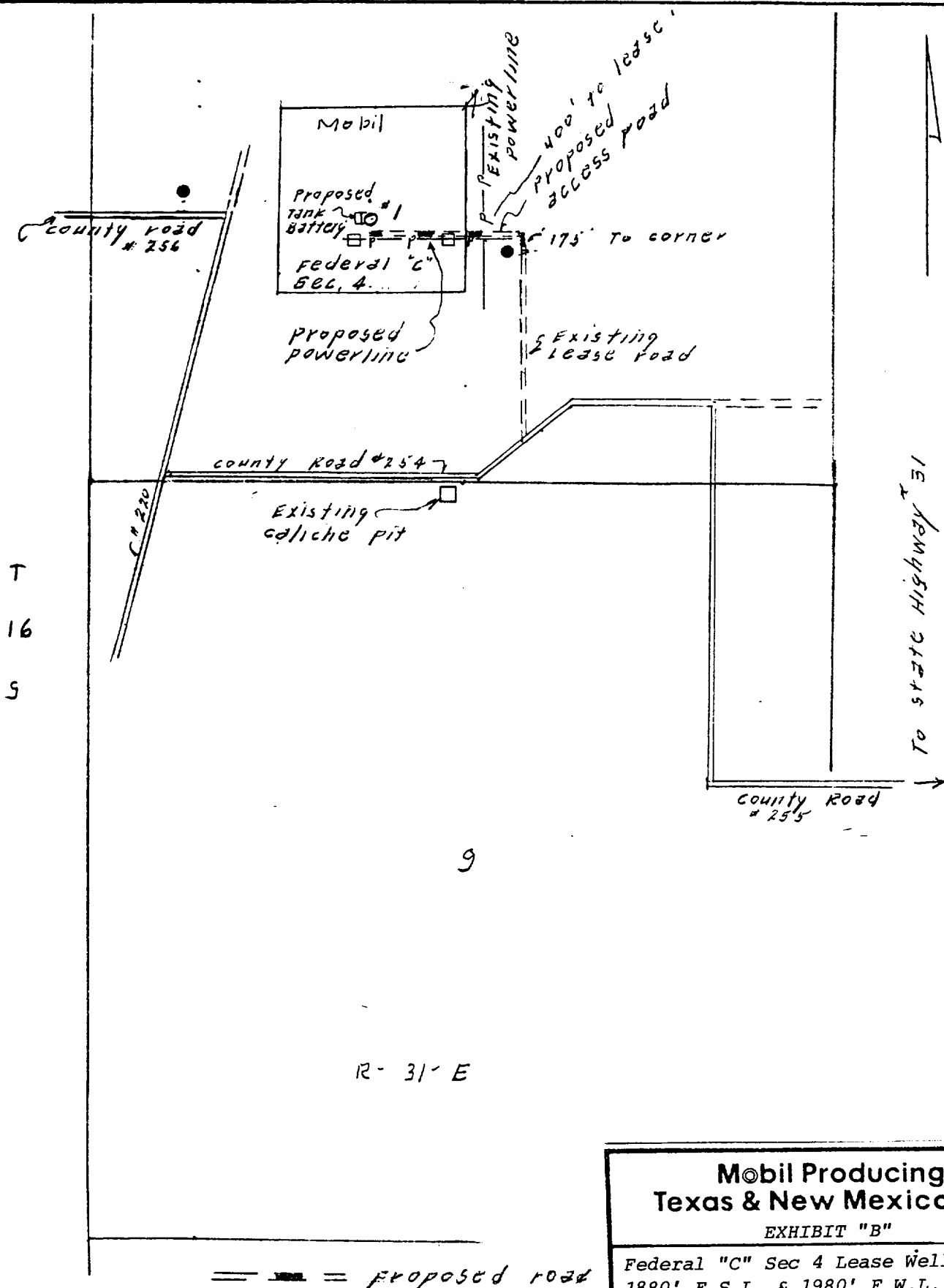

# **Mobil Producing Texas & New Mexico Inc.**

EXHIBIT "B"

Federal "C" Sec 4 Lease Well #1  
1880' F.S.L. & 1980' F.W.L. Sec 4,  
T-16-S, R-31-E, Eddy County, New  
Mexico

|              |                 |
|--------------|-----------------|
| DRAWN H.A.C. | SCALE "1"=1000' |
| CHECKED      | DATE 10-11-85   |
| APPROVED     | REVISED         |