

50-015-25528

UNITED STATES
DEPARTMENT OF THE INTERIOR
GEOLOGICAL SURVEY

APPLICATION FOR PERMIT TO DRILL, DEEPEN, OR PLUG BACK

1a. TYPE OF WORK
DRILL ☒ DEEPEN ☐ PLUG BACK ☐

b. TYPE OF WELL
OIL WELL ☒ GAS WELL ☐ OTHER ☐
SINGLE ZONE ☐ MULTIPLE ZONE ☐

2. NAME OF OPERATOR
McClellan Oil Corporation ✓

3. ADDRESS OF OPERATOR
P.O. Drawer 730, Roswell, NM 88202

4. LOCATION OF WELL (Report location clearly and in accordance with an State requirements*)
At surface 1650' FSL & 440' FWL

At proposed prod. zone 330

RECEIVED BY
DEC 20 1985
O. C. D.
ARTESIA, OFFICE

5. LEASE DESIGNATION AND SERIAL NO.

LC-046119-A

6. IF INDIAN, ALLOTTEE OR TRIBE NAME

7. UNIT AGREEMENT NAME

8. FARM OR LEASE NAME

Renee Fed.

9. WELL NO.

4

10. FIELD AND POOL, OR WILDCAT

High Lonesome

11. SEC., T., R., M., OR BLK.
AND SURVEY OR AREA

Sec. 17-T16S-R29E

12. COUNTY OR PARISH 13. STATE

Eddy

NM

14. DISTANCE IN MILES AND DIRECTION FROM NEAREST TOWN OR POST OFFICE*

20 miles northwest of Loco Hills, N.M.

15. DISTANCE FROM PROPOSED*
LOCATION TO NEAREST
PROPERTY OR LEASE LINE, FT.
(Also to nearest drig. unit line, if any)

330
440

16. NO. OF ACRES IN LEASE
640

17. NO. OF ACRES ASSIGNED
TO THIS WELL

40

18. DISTANCE FROM PROPOSED LOCATION*
TO NEAREST WELL, DRILLING, COMPLETED,
OR APPLIED FOR, ON THIS LEASE, FT.

996'

19. PROPOSED DEPTH
1850'

20. ROTARY OR CABLE TOOLS

Rotary

21. ELEVATIONS (Show whether DF, RT, GR, etc.)

3626' G.L.

22. APPROX. DATE WORK WILL START*

Dec. 17, 1985

23. PROPOSED CASING AND CEMENTING PROGRAM

SIZE OF HOLE	SIZE OF CASING	WEIGHT PER FOOT	SETTING DEPTH	QUANTITY OF CEMENT
12-1/4"	8-5/8"	20 lbs.	250'-300'	300 sx "C" + 2% CaCl ₂
7-7/8"	5-1/2"	14 lbs.	1850'	400 sx "C"

Propose to drill a well to the Penrose Sand in the Queen formation. Will run 8-5/8" casing to the top of the salt. Will drill with fresh water and mud up with 30 viscosity mud at total depth. If production is indicated by logs, will run 5-1/2" casing and attempt completion.

Estimated formation tops: Salt 240' Queen 1458'
Yates 712' Penrose 1700'

IN ABOVE SPACE DESCRIBE PROPOSED PROGRAM: If proposal is to deepen or plug back, give data on present productive zone and proposed new productive zone. If proposal is to drill or deepen directionally, give pertinent data on subsurface locations and measured and true vertical depths. Give blowout preventer program, if any.

24.

SIGNED Mark McClellan TITLE Geologist DATE 11/7/85

(This space for Federal or State office use)

PERMIT NO. _____ APPROVAL DATE _____

APPROVED BY _____ TITLE _____ DATE 12-19-85

CONDITIONS OF APPROVAL, IF ANY:

*See Instructions On Reverse Side

APPROVAL SUBJECT TO
GENERAL REQUIREMENTS AND
SPECIAL STIPULATIONS
ATTACHED

OIL CONSERVATION DIVISION

STATE OF NEW MEXICO
ENERGY AND MINERALS DEPARTMENTP. O. BOX 2088
SANTA FE, NEW MEXICO 87501Form C-102
Revised 10-1-78

All distances must be from the outer boundaries of the Section.

Operator McClellan Oil Corp.			Lease Rene Federal		Well No. #4
Unit Letter L	Section 17	Township 16 South	Range 29 East	County Eddy	
Actual Footage Location of Well: 330 feet from the West line and 1650 feet from the South line					
Ground Level Elev. 3626	Producing Formation Penrose	Pool High Lonesome		Dedicated Acreage: 40 Acres	

- Outline the acreage dedicated to the subject well by colored pencil or hatchure marks on the plat below.
- If more than one lease is dedicated to the well, outline each and identify the ownership thereof (both as to working interest and royalty).
- If more than one lease of different ownership is dedicated to the well, have the interests of all owners been consolidated by communitization, unitization, force-pooling, etc?

☐ Yes ☐ No If answer is "yes," type of consolidation _____

If answer is "no," list the owners and tract descriptions which have actually been consolidated. (Use reverse side of this form if necessary.) _____

No allowable will be assigned to the well until all interests have been consolidated (by communitization, unitization, forced-pooling, or otherwise) or until a non-standard unit, eliminating such interests, has been approved by the Division

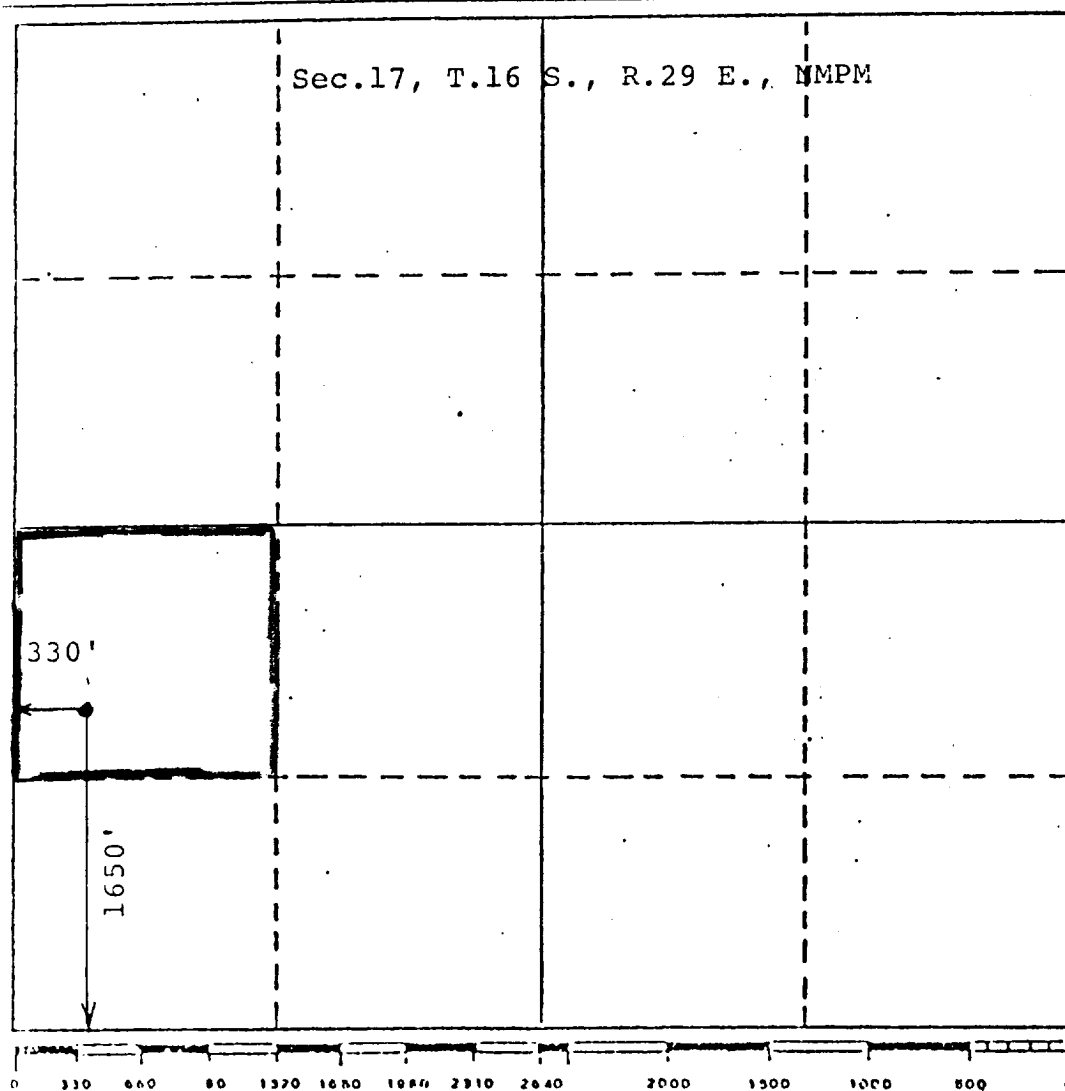

CERTIFICATION

I hereby certify that the information contained herein is true and complete to the best of my knowledge and belief.

Mark McClellan

Name

Mark McClellan

Position

Geologist

Company

McClellan Oil Corporation

Date

12-17-85

I hereby certify that the well location shown on this plat was plotted from field notes of actual surveys made by me or under my supervision, and that the same is true and correct to the best of my knowledge and belief.

Date Surveyed

November 1985

Registered Professional Engineer and/or Land Surveyor

John B. Jaques
John B. Jaques, PE &
Certification No. 02290

PLUGGING PREVENTER SPECIFICATION

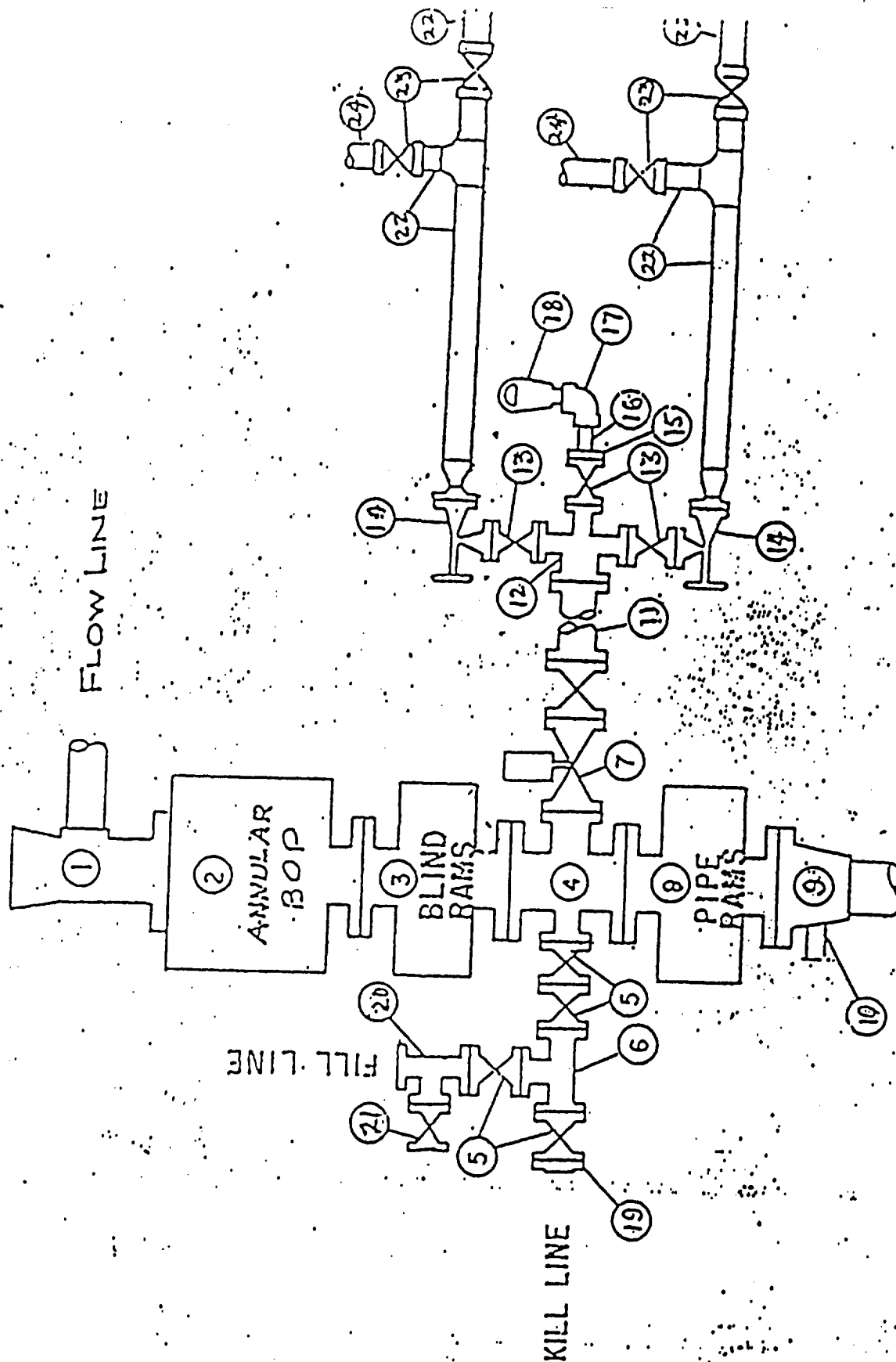

SURFACE USE PLAN EXHIBIT "F"
McClellan Oil Corporation
Renee Fed. No. 4
Sec. 17-T16S-R29E
Eddy County, N.M.

McClellan Oil Corp.
Renee Fed. No. 4

REQUIREMENTS
(NTL-6)

1. Location: 1650' FSL & 440' FWL of Sec. 17-T16S-R29E
2. Elevation: 3626' G.L.
3. Geologic name of surface formation: See archaeological report
4. Type of drilling rig and associated equipment: Rotary
5. Proposed drilling depth and objective formation: 1850' - Penrose
6. Estimated tops of geologic markers:

Yates	<u>712'</u>	San Andres	<u> </u>	Abo	<u> </u>
7-Rivers	<u> </u>	Glorieta	<u> </u>	Wolfcamp	<u> </u>
Queen	<u>1458'</u>	Tubb	<u> </u>		
7. Estimated depths of any oil, water, or gas: Possible oil and gas at 1700'.
- 8-9. Proposed casing program:

<u>8-5/8"</u>	@	<u>230'</u>	Grade	<u>J-55</u>	Wt.	<u>20 lb.</u>	Type Cement	<u>Class "C"</u>
<u>5-1/2"</u>	@	<u>1850'</u>	Grade	<u>J-55</u>	Wt.	<u>14 lb.</u>	Type Cement	<u>Class "C"</u>
10. Specifications for pressure control equipment and testing procedures:
Schaeffer type E 10" series 900 hydraulic BOP
11. Type and characteristics of drilling fluids: Drill with fresh water and mud up with 30 viscosity mud at total depth.
12. Testing, logging, and coring programs: No testing or coring is anticipated. Will run Gamma Ray-Neutron at total depth.
13. Anticipated abnormal pressures or temperature: None anticipated
14. Anticipated commencement and completion date:
12/17/85 - 12/27/85

McCLELLAN OIL CORPORATION
SUGGESTED PAD DIMENSIONS

Reserve Pits 4 ft. deep, plastic lined

Working pits 5 ft. deep

No cellar

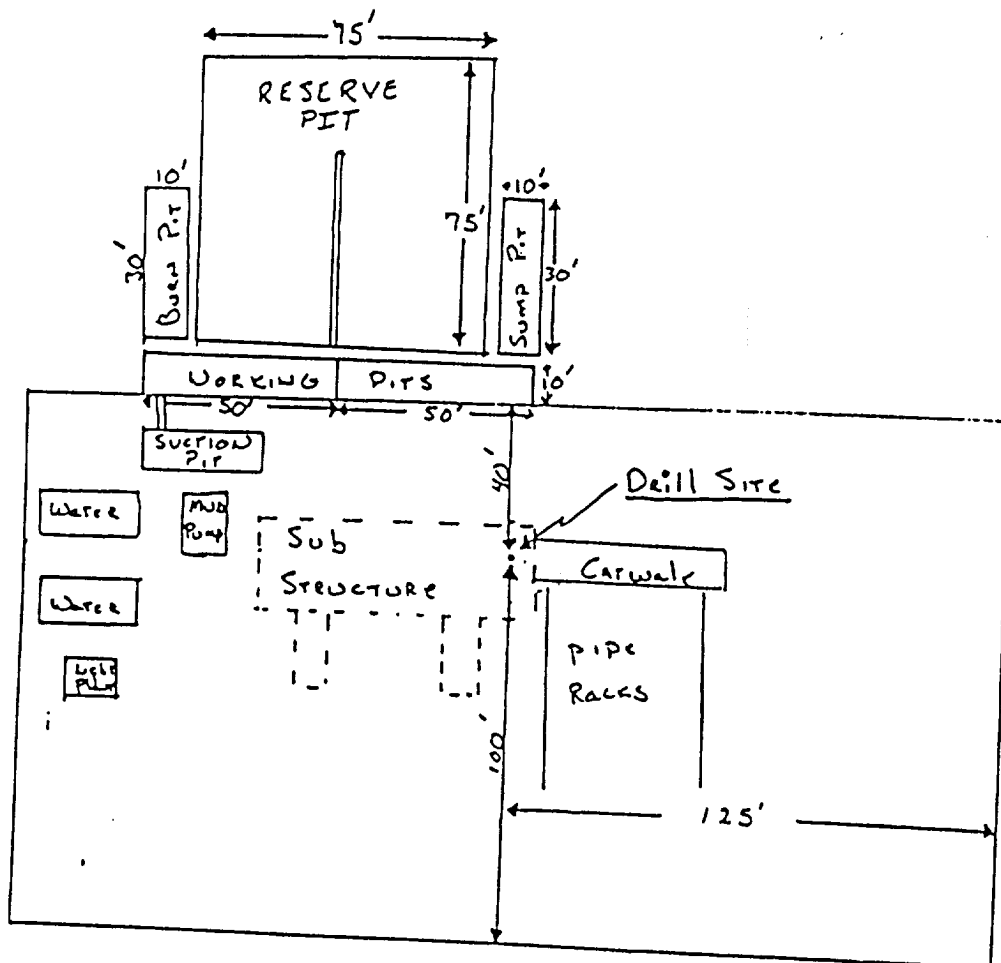

Scale 1" = 50'