

30-015-25636

ENERGY AND MINERALS DEPARTMENT

OIL CONSERVATION DIVISION

Form C-101
Revised 10-1-78

P. O. BOX 2088

SANTA FE, NEW MEXICO 87501

RECEIVED BY

JUN 30 1986

O.C.D.

ARTESIA, OFFICE

NO. OF COPIES RECEIVED	
DISTRIBUTION	
SANTA FE	<input checked="" type="checkbox"/>
FILE	<input checked="" type="checkbox"/>
U.S.G.S.	<input checked="" type="checkbox"/>
LAND OFFICE	<input checked="" type="checkbox"/>
OPERATOR	<input checked="" type="checkbox"/>

5A. Indicate Type of Lease
STATE <input checked="" type="checkbox"/> FEE <input type="checkbox"/>
5. State Oil & Gas Lease No.
E-7116

APPLICATION FOR PERMIT TO DRILL, DEEPEN OR PLUG BACK

1a. Type of Work		7. Unit Agreement Name	
b. Type of Well DRILL <input checked="" type="checkbox"/> DEEPEN <input type="checkbox"/> PLUG BACK <input type="checkbox"/> OIL WELL <input checked="" type="checkbox"/> GAS WELL <input type="checkbox"/> OTHER <input type="checkbox"/> SINGLE ZONE <input checked="" type="checkbox"/> MULTIPLE ZONE <input type="checkbox"/>		8. Farm or Lease Name Flemming State	
2. Name of Operator Marbob Energy Corporation ✓		9. Well No. 2	
3. Address of Operator P.O. Drawer 217, Artesia, New Mexico 88210		10. Field and Pool, or Wildcat Artesia On Grbg SA	
4. Location of Well UNIT LETTER <u>B</u> LOCATED <u>355</u> FEET FROM THE <u>North</u> LINE AND <u>1910</u> FEET FROM THE <u>East</u> LINE OF SEC. <u>34</u> TWP. <u>17S</u> RGE. <u>28E</u> NMPM		12. County Eddy	
19. Proposed Depth 3030'		19A. Formation San Andres	
20. Rotary or C.T. Rotary		21. Elevations (Show whether DE, RT, etc.) 3673.3' GR	
21A. Kind & Status Plug. Bond Statewide active ✓		21B. Drilling Contractor LaRue Drilling Co.	
22. Approx. Date Work will start 8/15/86			

23.

PROPOSED CASING AND CEMENT PROGRAM

SIZE OF HOLE	SIZE OF CASING	WEIGHT PER FOOT	SETTING DEPTH	SACKS OF CEMENT	EST. TOP
12 1/4"	8 5/8"	24#	500'	300	Circulate
7 7/8"	5 1/2"	15.50#	3030'	600	Attempt to circ

We propose to drill to 500', run and cement 8 5/8" casing, reduce hole and drill to 3030' to test the San Andres formation, run and cement 5 1/2" casing, put well on production.

APPROVAL VALID FOR 180 DAYS
PERMIT EXPIRES 1-1-87
UNLESS DRILLING UNDERWAY

IN ABOVE SPACE DESCRIBE PROPOSED PROGRAM: IF PROPOSAL IS TO DEEPEN OR PLUG BACK, GIVE DATA ON PRESENT PRODUCTIVE ZONE AND PROPOSED NEW PRODUCTIVE ZONE. GIVE BLOWOUT PREVENTER PROGRAM, IF ANY.

I hereby certify that the information above is true and complete to the best of my knowledge and belief.

Signed Charles Williams Title Production Clerk Date 6/26/86

(This space for State Use)

Original Signed By
Mike Williams

Oil & Gas Inspector

APPROVED BY _____ DATE JUL 1 1986

CONDITIONS OF APPROVAL, IF ANY:

**MEXICO OIL CONSERVATION COMMISSION
WELL LOCATION AND ACREAGE DEDICATION PLAT**

Form C-102
Supersedes C-128
Effective 1-1-65

All distances must be from the outer boundaries of the Section

Operator Marbob Energy Corp. ✓			Lease FLEMMING State		Well No. 2
Unit Letter B	Section 34	Township 17 South	Range 28 East	County Eddy	
Actual Footage Location of Well: 355 feet from the North line and 1910 feet from the East line					
Ground Level Elev. 3673.3'	Producing Formation San Andres		Pool Artesia On Grbg SA	Dedicated Acreage: 40 Acres	

1. Outline the acreage dedicated to the subject well by colored pencil or hatchure marks on the plat below.
2. If more than one lease is dedicated to the well, outline each and identify the ownership thereof (both as to working interest and royalty).
3. If more than one lease of different ownership is dedicated to the well, have the interests of all owners been consolidated by communitization, unitization, forced-pooling, or otherwise? **OFFICE**

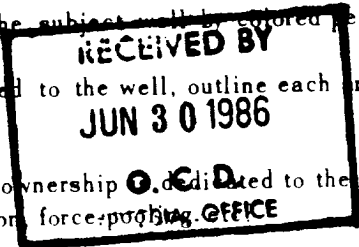

☐ Yes ☐ No If answer is "yes," type of consolidation _____

If answer is "no," list the owners and tract descriptions which have actually been consolidated. (Use reverse side of this form if necessary.) _____

No allowable will be assigned to the well until all interests have been consolidated (by communitization, unitization, forced-pooling, or otherwise) or until a non-standard unit, eliminating such interests, has been approved by the Commission.

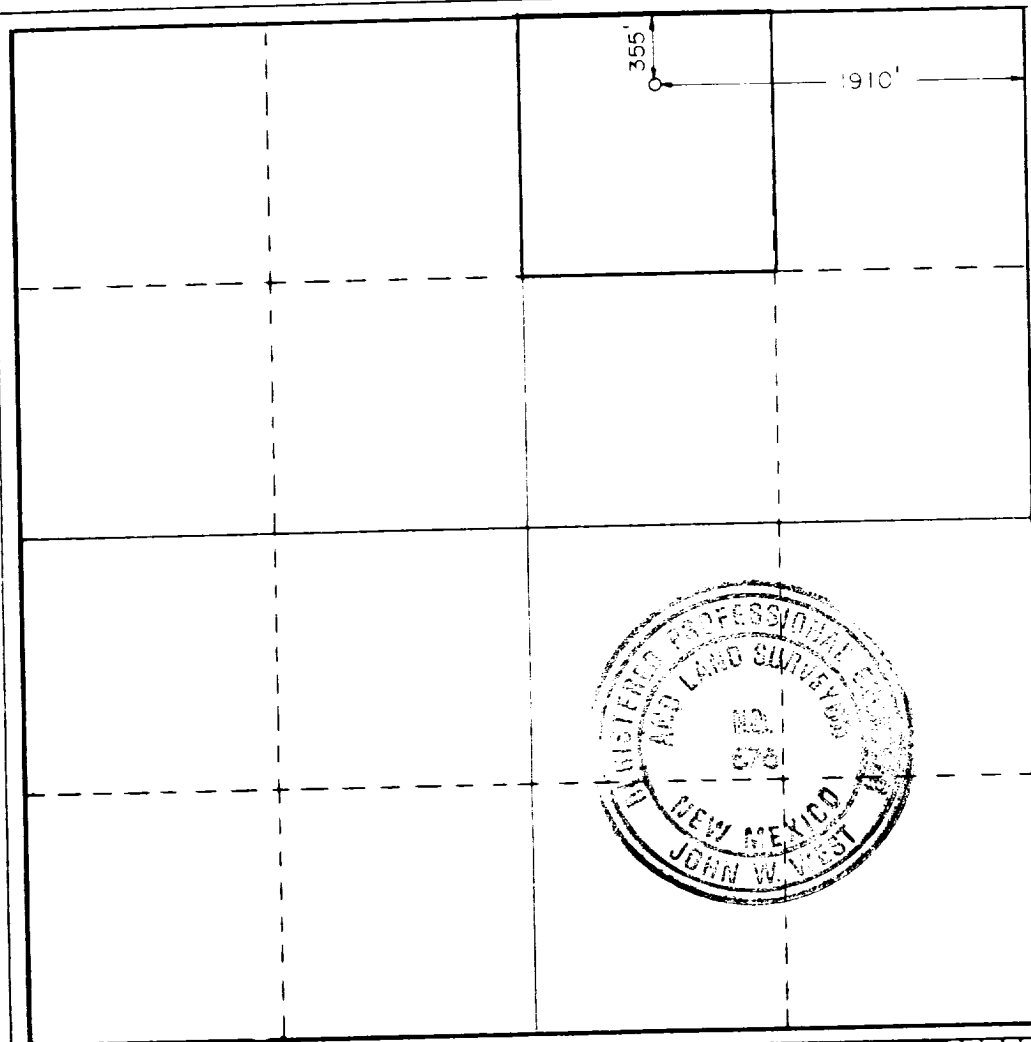

CERTIFICATION

I hereby certify that the information contained herein is true and complete to the best of my knowledge and belief.

Carolyn Purcella
Name

Carolyn Purcella
Position

Production Clerk
Company

Marbob Energy Corporation
Date

6/26/86

I hereby certify that the well location shown on this plat was plotted from field notes of actual surveys made by me or under my supervision, and that the same is true and correct to the best of my knowledge and belief.

Date Surveyed
May 23, 1986

Registered Professional Engineer and/or Land Surveyor

John W. West
Certificate No. **JOHN W. WEST, 676**
RONALD J. EIDSON, 3239