

Submit to Appropriate  
District Office  
Sta. Lease - 6 copies  
Fee Lease - 5 copies

State of New Mexico  
Energy, Minerals and Natural Resources Department

Form C-101  
Revised 1-1-89

DISTRICT I  
P.O. Box 1980, Hobbs, NM 88240

DISTRICT II  
P.O. Drawer DD, Artesia, NM 88210

DISTRICT III  
1000 Rio Brazos Rd., Aztec, NM 87410

OIL CONSERVATION DIVISION

P.O. Box 2088  
Santa Fe, New Mexico 87504-2088

API NO. (assigned by OCD on New Wells)

30-015-27619

5. Indicate Type of Lease

STATE ☒

FEE ☐

6. State Oil & Gas Lease No.

647

APPLICATION FOR PERMIT TO DRILL, DEEPEN, OR PLUG BACK

1a. Type of Work:

DRILL ☒

RE-ENTER ☐

DEEPEN ☐

PLUG BACK ☐

b. Type of Well:

OIL WELL ☒

GAS WELL ☐

OTHER ☐

SINGLE ZONE ☐

MULTIPLE ZONE ☐

2. Name of Operator

SDX Resources, Inc. ✓

7. Lease Name or Unit Agreement Name

26-1  
Arco State 26-1

8. Well No.

1

3. Address of Operator

Post Office Box 5061, Midland, Texas 79704

9. Pool name or Wildcat

Artesia-Q-GR-SA

4. Well Location

Unit Letter K : 1650 Feet From The S Line and 1650 Feet From The W Line

Section 26 Township 17S Range 28E NMPM Eddy County

10. Proposed Depth

3500' +/-

11. Formation

GR-SA

12. Rotary or C.T.

Rotary

13. Elevations (Show whether DF, RT, GR, etc.)

3655' Grd.

14. Kind & Status Plug Bond

Blanket

15. Drilling Contractor

Capstar

16. Approx. Date Work will start

August 15, 1993

17. PROPOSED CASING AND CEMENT PROGRAM

SIZE OF HOLE	SIZE OF CASING	WEIGHT PER FOOT	SETTING DEPTH	SACKS OF CEMENT	EST. TOP
12 1/4"	8 5/8"	24#	500 350'+	300	Surface
7 7/8"	5 1/2"	15.50#	3500'+/-	300	Surface

Plan to drill a 12 1/4" hole to approximately 350' and set 8 5/8" surface casing. Circulate "C" cement. Drill 7 7/8" hole to TD. Run open hole logs (LDT-CNL-GR and DLL). Run 5 1/2" casing and circulate 50/50 POZ "C" cement. Perforate the Grayburg-San Andres and stimulate as necessary for optimum production.

Mud Program: Fresh water mud 0' - 350'.  
Salt water mud 350' - TD.

APPROVED FOR 180  
BY 2-3-94  
DATE 2-3-94

10-1  
8-6-93  
NEW ART

IN ABOVE SPACE DESCRIBE PROPOSED PROGRAM: IF PROPOSAL IS TO DEEPEN OR PLUG BACK, GIVE DATA ON PRESENT PRODUCTIVE ZONE AND PROPOSED NEW PRODUCTIVE ZONE. GIVE BLOWOUT PREVENTER PROGRAM, IF ANY.

I hereby certify that the information above is true and complete to the best of my knowledge and belief.

SIGNATURE Rebecca Robinson TITLE Agent DATE 8-2-93

TYPE OR PRINT NAME Rebecca Robinson TELEPHONE NO.

(This space for State Use)

ORIGINAL SIGNED BY  
MIKE WILLIAMS  
SUPERVISOR, DISTRICT II

APPROVED BY \_\_\_\_\_ TITLE \_\_\_\_\_ DATE \_\_\_\_\_

CONDITIONS OF APPROVAL, IF ANY:

AUG 7 1993

Submit to Appropriate  
District Office  
State Lease - 4 copies  
Fee Lease - 3 copies

State of New Mexico  
Energy, Minerals and Natural Resources Department

Form C-102  
Revised 1-1-89

OIL CONSERVATION DIVISION

P.O. Box 2088  
Santa Fe, New Mexico 87504-2088

DISTRICT I  
P.O. Box 1980, Hobbs, NM 88240

DISTRICT II  
P.O. Drawer DD, Artesia, NM 88210

DISTRICT III  
1000 Rio Brazos Rd., Aztec, NM 87410

WELL LOCATION AND ACREAGE DEDICATION PLAT

All Distances must be from the outer boundaries of the section

Operator <b>SDX RESOURCES, INC.</b>			Lease <b>ARCO STATE 26-1</b>		Well No. <b>1</b>
Unit Letter <b>K</b>	Section <b>26</b>	Township <b>17 SOUTH</b>	Range <b>28 EAST</b>	NMPM	County <b>EDDY COUNTY, NM</b>
Actual Footage Location of Well: <b>1650</b> feet from the <b>SOUTH</b> line and <b>1650</b> feet from the <b>WEST</b> line					
Ground level Elev. <b>3655.</b>	Producing Formation <b>Grayburg-San Andres</b>		Pool <b>Artesia-Q-GR-SA</b>		Dedicated Acreage: <b>40</b> Acres

1. Outline the acreage dedicated to the subject well by colored pencil or hatchure marks on the plat below.

2. If more than one lease is dedicated to the well, outline each and identify the ownership thereof (both as to working interest and royalty).

3. If more than one lease of different ownership is dedicated to the well, have the interest of all owners been consolidated by communitization, unitization, force-pooling, etc.?

☐ Yes

☐ No

If answer is "yes" type of consolidation

If answer is "no" list the owners and tract descriptions which have actually been consolidated. (Use reverse side of this form if necessary.)

No allowable will be assigned to the well until all interests have been consolidated (by communitization, unitization, forced-pooling, or otherwise) or until a non-standard unit, eliminating such interest, has been approved by the Division.

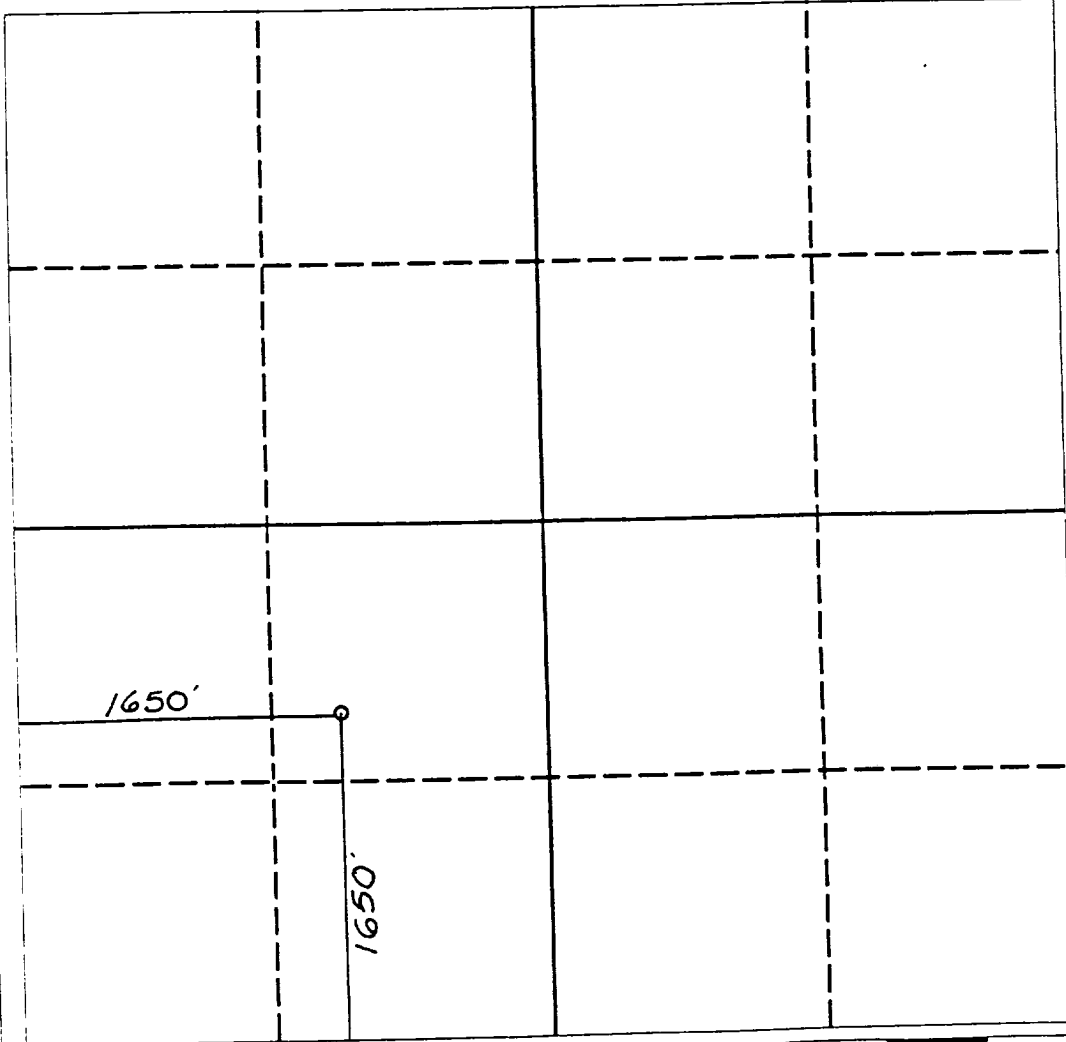

OPERATOR CERTIFICATION

I hereby certify that the information contained herein is true and complete to the best of my knowledge and belief.

Signature

Printed Name

Chuck Morgan

Position

Engineer

Company

SDX Resources, Inc.

Date

August 2, 1993

SURVEYOR CERTIFICATION

I hereby certify that the well location shown on this plat was plotted from field notes of actual surveys made by me or under my supervision, and that the same is true and correct to the best of my knowledge and belief.

Date

JULY 30 1993

Signature & Seal of  
Professional Surveyor

Professional Engineer

Certificate No.

NM PE&PS NO 5412