

District I
PO Box 1980, Hobbs, NM 88241-1980
District II
811 S. 1st Street, Artesia, NM 88210-2834
District III
1000 Rio Brazos Rd., Aztec, NM 87410
District IV
2040 South Pacheco, Santa Fe, NM 87505

State of New Mexico
Energy, Minerals & Natural Resources Department

OIL CONSERVATION DIVISION
2040 South Pacheco
Santa Fe, NM 87505

0191 800 5204
Form C-101
Revised October 18, 1994
Instructions on back
Submit to Appropriate District Office
State Lease - 6 Copies
Fee Lease - 5 Copies

☐ AMENDED REPORT

MAR 1998
RECEIVED
OIL CONSERVATION DIVISION
ARTESIA

APPLICATION FOR PERMIT TO DRILL, RE-ENTER, DEEPEN, PLUGBACK, OR ADD A ZONE

¹ Operator name and Address ARCO PERMIAN P.O. BOX 1610 MIDLAND, TX 79702		² OGRID Number 000990
⁴ Property Code 22954	⁵ Property Name WASHINGTON "33" STATE	³ API Number 30-015-30187 ⁶ Well No. 2

⁷ Surface Location

UL or lot no.	Section	Township	Range	Lot. Idn	Feet from the	North/South Line	Feet from the	East/West line	County
A	33	17S	28E		990	NORTH	930	EAST	EDDY

⁸ Proposed Bottom Hole Location If Different From Surface

UL or lot no.	Section	Township	Range	Lot. Idn	Feet from the	North/South Line	Feet from the	East/West line	County

⁹ Proposed Pool 1 WILDCAT (YESO)	¹⁰ Proposed Pool 2 ARTESIA (Q-G-SA)
--	---

¹¹ Work Type Code N	¹² Well Type Code O	¹³ Cable/Rotary R	¹⁴ Lease Type Code S	¹⁵ Ground Level Elevation 3677'
¹⁶ Multiple NO	¹⁷ Proposed Depth 4200	¹⁸ Formation YESO	¹⁹ Contractor	²⁰ Spud Date 4/98

²¹ Proposed Casing and Cement Program

Hole Size	Casing Size	Casing weight/foot	Setting Depth	Sacks of Cement	Estimated TOC
12-1/4	8-5/8	24#	500'	450	CIRC. TO SURF.
7-7/8	5-1/2	15.5#	4200	1200	CIRC. TO SURF.

²² Describe the proposed program. If this application is to DEEPEN or PLUG BACK give the data on the present productive zone and proposed new productive zone. Describe the blowout prevention program, if any. Use additional sheets if necessary

DRILL SURFACE HOLE W/FRESH WATER TO 500'. SET & CEMENT 8-5/8" CASING.
DRILL 7-7/8" HOLE TO 2000' W/SATURATED BRINE. DRILL TO 4200' W/SALT GEL
USING PRE-HYDRATED FW GEL SWEEPS, FL +/- 15 CC. LOG WELL, RUN & CEMENT
5-1/2" CASING. COMPLETE AND TEST YESO FORMATION

SUBJECT WELL PLANNED AS A 4200' STRAIGHT HOLE.
3000 PSI BOPE WILL BE USED FROM 500' TO TD.

Posted ID-1
N & API
4-10-98

²³ I hereby certify that the information given above is true and complete to the best of my knowledge and belief.

Signature:

Elizabeth A. Casbeer

Printed name: ELIZABETH A. CASBEER

Title: REG/COMP ANALYST

OIL CONSERVATION DIVISION

Approved by:

ORIGINAL SIGNED BY TIM W. GUM
DISTRICT II SUPERVISOR

Title:

Approval Date: 4-2-98 Expiration Date: 4-2-99

DISTRICT I
P.O. Box 1980, Hobbs, NM 88241-1980

DISTRICT II
P.O. Drawer DD, Artesia, NM 88211-0719

DISTRICT III
1000 Rio Brazos Rd., Aztec, NM 87410

DISTRICT IV
P.O. Box 2088, Santa Fe, N.M. 87504-2088

State of New Mexico
Energy, Minerals and Natural Resources Department

Form C-102
Revised February 10, 1994
Submit to Appropriate District Office
State Lease - 4 Copies
Fee Lease - 3 Copies

OIL CONSERVATION DIVISION

P.O. Box 2088
Santa Fe, New Mexico 87504-2088

☐ AMENDED REPORT

WELL LOCATION AND ACREAGE DEDICATION PLAT

API Number	Pool Code	Pool Name
Property Code	Property Name	Well Number
OGRID No.	Operator Name	Elevation
000990	WASHINGTON 33 STATE ARCO PERMIAN	2 3677'

Surface Location

UL or lot No.	Section	Township	Range	Lot Idn	Feet from the	North/South line	Feet from the	East/West line	County
A	33	17 S	28 E		990	NORTH	930	EAST	EDDY

Bottom Hole Location If Different From Surface

UL or lot No.	Section	Township	Range	Lot Idn	Feet from the	North/South line	Feet from the	East/West line	County
---------------	---------	----------	-------	---------	---------------	------------------	---------------	----------------	--------

Dedicated Acres	Joint or Infill	Consolidation Code	Order No.
40			

NO ALLOWABLE WILL BE ASSIGNED TO THIS COMPLETION UNTIL ALL INTERESTS HAVE BEEN CONSOLIDATED
OR A NON-STANDARD UNIT HAS BEEN APPROVED BY THE DIVISION

01	06	04	013
07	09		
08	010	014	
021			
022			

OPERATOR CERTIFICATION

I hereby certify that the information contained herein is true and complete to the best of my knowledge and belief.

Elizabeth Casbeer
Signature
ELIZABETH CASBEER
Printed Name
REG. / COMP. ANALYST
Title
3/23/98
Date

SURVEYOR CERTIFICATION

I hereby certify that the well location shown on this plat was plotted from field notes of actual surveys made by me or under my supervision and that the same is true and correct to the best of my belief.

FEBRUARY 25, 1998

Date Surveyed CDG
Signature & Seal of Professional Surveyor
RONALD J. EDSON 3-03-98
88-11-0345
Certificate No. RONALD J. EDSON 3239
GARY EDSON 12641

VICINITY MAP

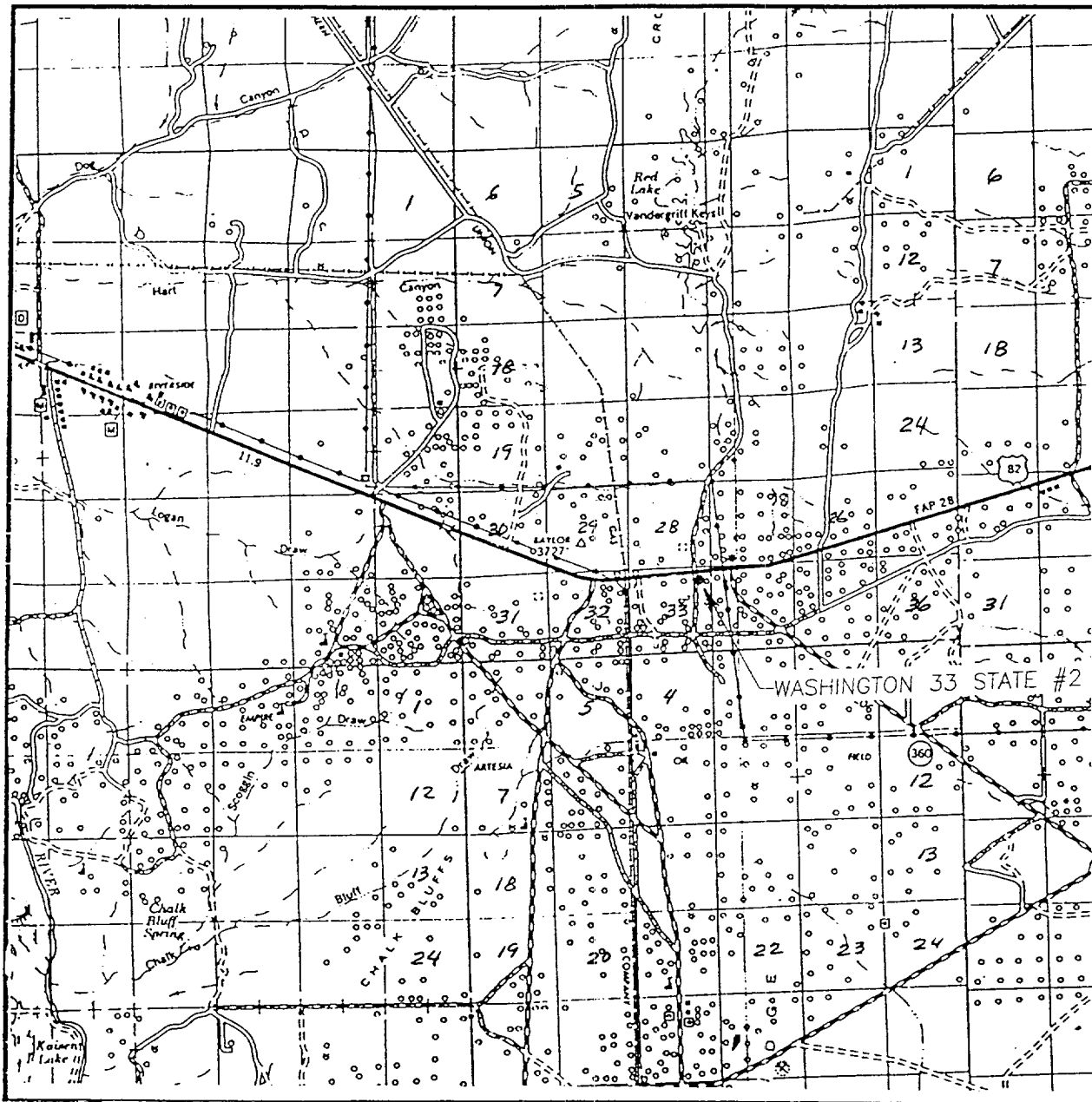

SCALE: 1" = 2 MILES

SEC. 33 TWP. 17-S RGE. 28-E

SURVEY N.M.P.M.

COUNTY EDDY

DESCRIPTION 990' FNL & 930' FEL

ELEVATION 3677'

OPERATOR ARCO PERMIAN

LEASE WASHINGTON 33 STATE

JOHN WEST ENGINEERING
HOBBS, NEW MEXICO
(505) 393-3117

FLATON



RED LAKE , NM

**JOHN WEST ENGINEERING
HOBBS, NEW MEXICO
(505) 393-3117**