

# N. M. Oil Cons. Division

811 S. 1ST ST.

ARTESIA, NM 88210-2834

SUBMIT IN

(Other Ins reverse)

PLICATE\*

(ons on re)

FORM APPROVED

OMB NO. 1004-0136

Expires: February 28, 1995

## DEPARTMENT OF THE INTERIOR

### BUREAU OF LAND MANAGEMENT

#### APPLICATION FOR PERMIT TO DRILL OR DEEPEN

##### 1a. TYPE OF WORK

DRILL ☒

DEEPEN ☐

##### b. TYPE OF WELL

OIL WELL ☐

GAS WELL ☒

OTHER

SINGLE ZONE ☒

MULTIPLE ZONE ☐

##### 2. NAME OF OPERATOR

MURCHISON OIL & GAS, INC.

15363

##### 3. ADDRESS AND TELEPHONE NO.

1445 ROSS AVE., STE. 5300, LB 152, DALLAS, TX. 75202-2883

##### 4. LOCATION OF WELL (Report location clearly and in accordance with any State requirements.)\*

At surface

1980' FNL & 660' FWL SWNW (E)

At proposed prod. zone

##### 14. DISTANCE IN MILES AND DIRECTION FROM NEAREST TOWN OR POST OFFICE\*

7 MILES SOUTHEAST OF ARTESIA, NM.

##### 15. DISTANCE FROM PROPOSED\*

LOCATION TO NEAREST PROPERTY OR LEASE LINE, FT. (Also to nearest drig. unit line, if any)

660'

##### 18. DISTANCE FROM PROPOSED LOCATION\*

TO NEAREST WELL, DRILLING, COMPLETED, OR APPLIED FOR, ON THIS LEASE, FT.

4200'

##### 16. NO. OF ACRES IN-LEASE

640

##### 19. PROPOSED DEPTH

9300

##### 17. NO. OF ACRES ASSIGNED TO THIS WELL

320

##### 20. ROTARY OR CABLE TOOLS

ROTARY

##### 21. ELEVATIONS (Show whether DF, RT, GR, etc.)

3377 GR

##### 22. APPROX. DATE WORK WILL START\*

10-1-99

##### 23. PROPOSED CASING AND CEMENTING PROGRAM

SIZE OF HOLE	GRADE, SIZE OF CASING	WEIGHT PER FOOT	SETTING DEPTH	QUANTITY OF CEMENT
17 1/2"	13-3/8 H-40	48#	400	420 SX-CIRCULATE
12 1/4"	8-5/8 K-55	24# or 32#	1800	515 SX-CIRCULATE
7 7/8"	5-1/2 N-80, S-95	17#	9300	640 SX-EST TOP @ 5500'

IT IS PROPOSED TO DRILL THIS WELL TO A TD OF 9300' AND TEST THE MORROW FORMATION.

THE BLOWOUT PREVENTION PROGRAM IS AS FOLLOWS:

- 1) ONE SET OF DRILL PIPE RAMS (5M)
- 2) ONE SET OF BLIND RAMS (5M)
- 3) ONE SET OF HYDRILL (3M)

APPROVAL SUBJECT TO  
GENERAL REQUIREMENTS AND  
SPECIAL STIPULATIONS  
ATTACHED

IN ABOVE SPACE DESCRIBE PROPOSED PROGRAM: If proposal is to deepen, give data on present productive zone and proposed new productive zone. If proposal is to drill or deepen directionally, give pertinent data on subsurface locations and measured and true vertical depths. Give blowout prevention program, if any.

24.

SIGNED

TITLE VICE PRESIDENT OPERATIONS

DATE

8/17/99

(This space for Federal or State office use)

PERMIT NO.

APPROVAL DATE

Application approval does not warrant or certify that the applicant holds legal or equitable title to those rights in the subject lease which would entitle the applicant to conduct operations thereon.

CONDITIONS OF APPROVAL, IF ANY:

Acting

/S/LARRY D. BRAY

Assistant Field Office Manager.  
Lands and Minerals

APPROVED BY

TITLE

DATE

9-24-99

\*See Instructions On Reverse Side

APPROVED FOR 1 YEAR

Title 18 U.S.C. Section 1001 makes it a crime for any person knowingly and willfully to make to any department or agency of the

RECEIVED  
AUG 26 1999  
BLM  
ROSWELL, NM

DISTRICT II  
P.O. Drawer DD, Artesia, NM 88211-0719

DISTRICT III  
1000 Rio Brazos Rd., Aztec, NM 87410

DISTRICT IV  
P.O. BOX 2088, SANTA FE, N.M. 87504-2088

## OIL CONSERVATION DIVISION

P.O. Box 2088  
Santa Fe, New Mexico 87504-2088

☐ AMENDED REPORT

### WELL LOCATION AND ACREAGE DEDICATION PLAT

API Number	Pool Code	Pool Name
Property Code	Property Name POTTER FEDERAL	Well Number 2
OGRID No.	Operator Name MURCHISON OIL & GAS INC.	Elevation 3377

#### Surface Location

UL or lot No.	Section	Township	Range	Lot Idn	Feet from the	North/South line	Feet from the	East/West line	County
E	29	17 S	27 E		1980	NORTH	660	WEST	EDDY

#### Bottom Hole Location If Different From Surface

UL or lot No.	Section	Township	Range	Lot Idn	Feet from the	North/South line	Feet from the	East/West line	County
					Dedicated Acres	Joint or Infill	Consolidation Code	Order No.	

NO ALLOWABLE WILL BE ASSIGNED TO THIS COMPLETION UNTIL ALL INTERESTS HAVE BEEN CONSOLIDATED  
OR A NON-STANDARD UNIT HAS BEEN APPROVED BY THE DIVISION

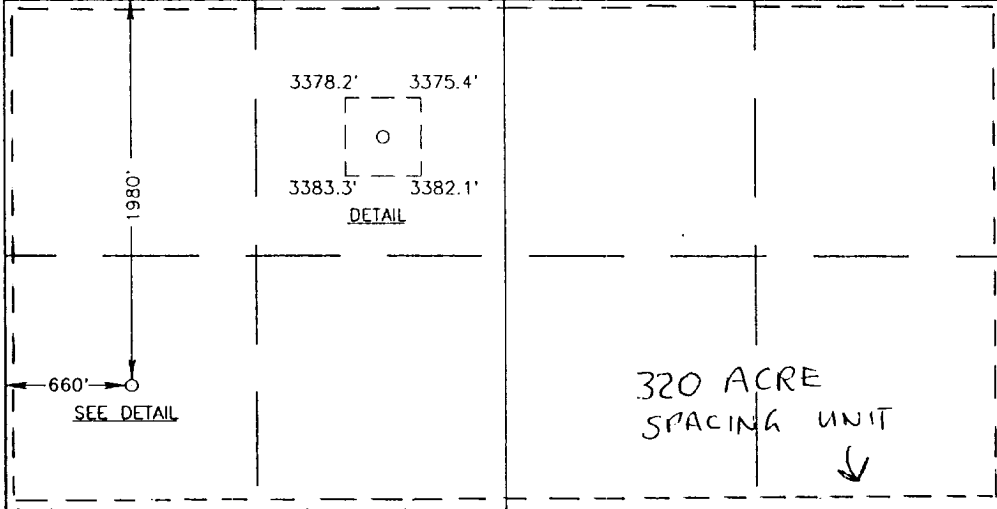
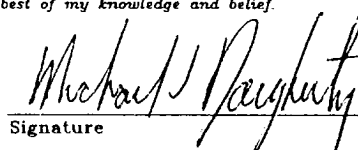
	<b>OPERATOR CERTIFICATION</b>  I hereby certify the the information contained herein is true and complete to the best of my knowledge and belief.   Signature MICHAEL S. DAUGHERTY Printed Name V P OPERATIONS Title 8/25/99 Date
	<b>SURVEYOR CERTIFICATION</b>  I hereby certify that the well location shown on this plat was plotted from field notes of actual surveys made by me or under my supervision, and that the same is true and correct to the best of my belief.  AUGUST 20, 1999 Date Surveyed Signature of Ronald J. Eidson Professional Surveyor NEW MEXICO REGISTERED PROFESSIONAL SURVEYOR No. 3239 3239 12641 McDONALD 12185 DMCC 8-24-99

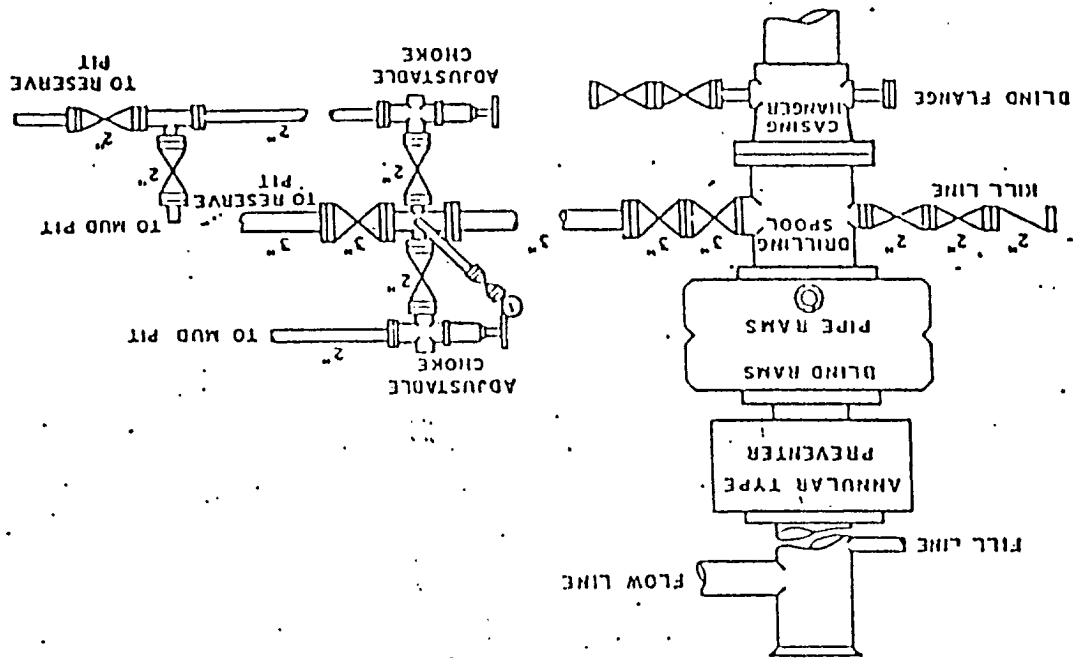

After the wellsite is cleaned and pits and sumps backfilled, any obstruction to the natural drainage will be corrected by ditching or terracing. All disturbed areas, including any access road no longer needed, will be ripped. Those areas will be reseeded with grass if, in the opinion of the land owner, it is required.

12. Operator's Representatives

The Field representatives responsible for assuring compliance with the approved surface use and operations plan are as follows:

Michael S. Daugherty  
1445 Ross Ave., Ste. 5300, LB 152  
Dallas, TX. 75202-2883  
Office Phone: (214) 953-1414  
Home Phone: (972) 618-0792

Randy Ford  
P.O. Box 51037  
Midland, TX. 79710  
Office Phone: (915) 682-0440  
Pager Phone: (800) 518-9809

13. Certification

I hereby certify that I, or persons under my direct supervision, have inspected the proposed drill site and access route; that I am familiar with the conditions which presently exist; that the statements made in this plan are, to the best of my knowledge, true and correct; and, that the work associated with the operations proposed herein will be performed by MOGI and its contractors and sub-contractors in conformity with this plan and the terms and conditions under which it is approved.

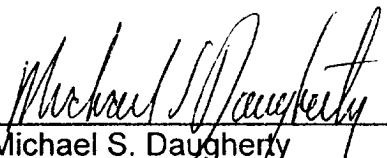
  
\_\_\_\_\_  
Michael S. Daugherty  
Vice President, Operations  
Murchison Oil & Gas, Inc.

8/25/99  
Date

# VICINITY MA.

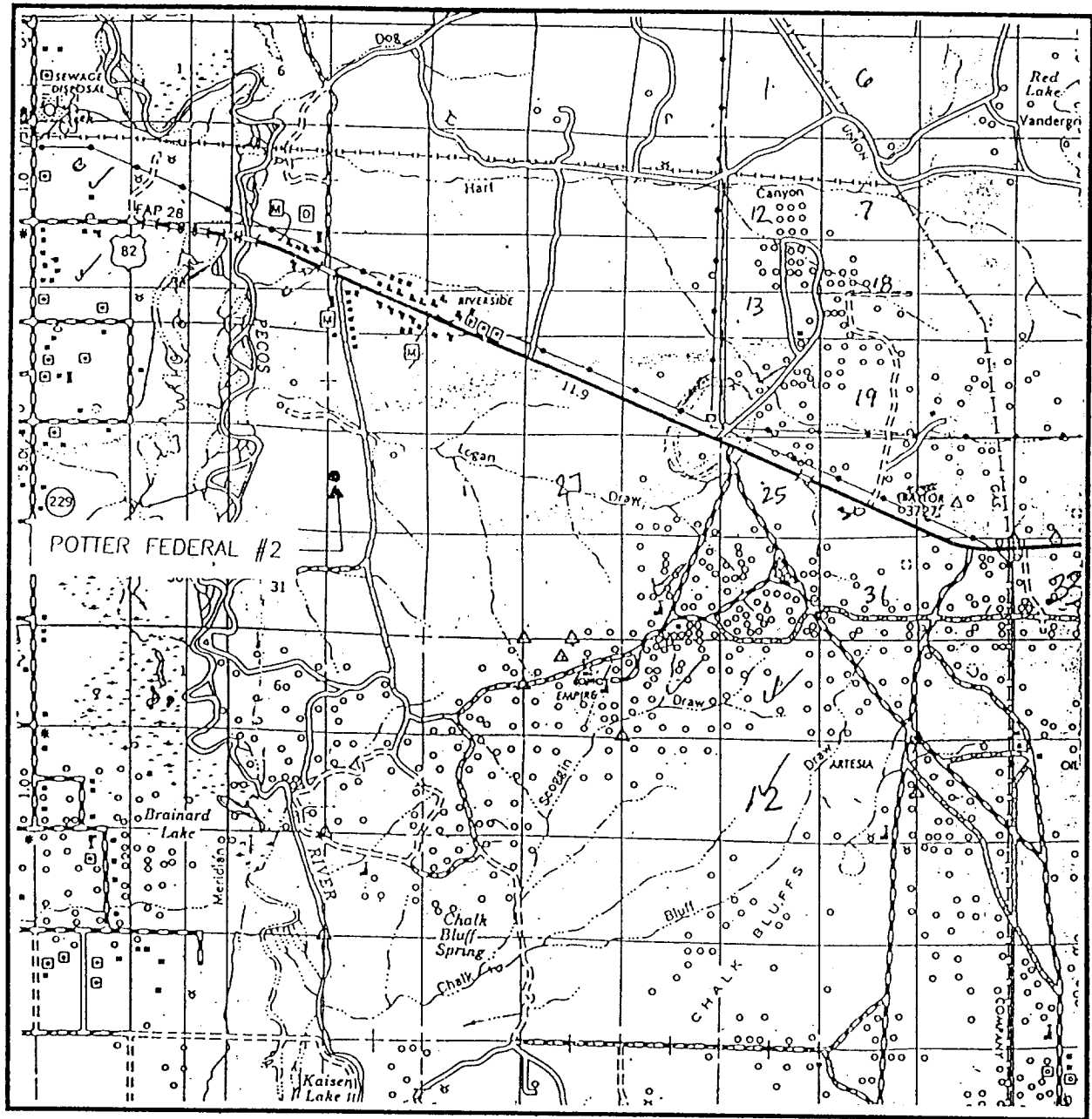

SCALE: 1" = 2 MILES

SEC. 29 TWP. 17-S RGE. 27-E

SURVEY N.M.P.M.

COUNTY EDDY

DESCRIPTION 1980' FNL & 660' FWL

ELEVATION 3377

OPERATOR MURCHISON OIL & GAS INC.

LEASE POTTER FEDERAL

**JOHN WEST SURVEYING**  
**HOBBS, NEW MEXICO**  
**(505) 393-3117**