

STATE OF NEW MEXICO
ENERGY AND MINERALS DEPARTMENT

NO. OF COPIES RECEIVED	
DISTRIBUTION	
SANTA FE	<input checked="" type="checkbox"/>
FILE	<input checked="" type="checkbox"/>
U.S.G.S.	
LAND OFFICE	
OPERATOR	<input checked="" type="checkbox"/>

OIL CONSERVATION DIVISION
RECEIVED

P. O. BOX 2088

SANTA FE, NEW MEXICO 87501

OCT 5 1982

O. C. D.
ARTESIA OFFICE

Form C-103
Revised 10-1-78

5a. Indicate Type of Lease	
State <input checked="" type="checkbox"/>	Fee <input type="checkbox"/>
5. State Oil & Gas Lease No.	
LG 734	

SUNDRY NOTICES AND REPORTS ON WELLS

(DO NOT USE THIS FORM FOR PROPOSALS TO DRILL OR TO DEEPEN OR PLUG BACK TO A DIFFERENT RESERVOIR.
USE "APPLICATION FOR PERMIT -" (FORM C-101) FOR SUCH PROPOSALS.)

OIL WELL <input type="checkbox"/>	GAS WELL <input checked="" type="checkbox"/>	OTHER <input type="checkbox"/>
Name of Operator Yates Petroleum Corporation		
Address of Operator 207 South 4th St., Artesia, NM 88210		
Location of Well UNIT LETTER <u>J</u> <u>1980</u> FEET FROM THE <u>South</u> LINE AND <u>1980</u> FEET FROM THE <u>East</u> LINE, SECTION <u>20</u> TOWNSHIP <u>17S</u> RANGE <u>18E</u> NMPM.		

7. Unit Agreement Name Little Cuevo Unit
8. Farm or Lease Name Little Cuevo Unit
9. Well No. 1
10. Field and Pool, or Wildcat Wildcat Abo
12. County Chaves

15. Elevation (Show whether DF, RT, GR, etc.)
5328' GR

6. Check Appropriate Box To Indicate Nature of Notice, Report or Other Data

NOTICE OF INTENTION TO:

PERFORM REMEDIAL WORK <input type="checkbox"/>	PLUG AND ABANDON <input type="checkbox"/>
TEMPORARILY ABANDON <input type="checkbox"/>	CHANGE PLANS <input type="checkbox"/>
PULL OR ALTER CASING <input type="checkbox"/>	OTHER <input type="checkbox"/>

SUBSEQUENT REPORT OF:

REMEDIAL WORK <input type="checkbox"/>	ALTERING CASING <input type="checkbox"/>
COMMENCE DRILLING OPNS. <input checked="" type="checkbox"/>	PLUG AND ABANDONMENT <input type="checkbox"/>
CASING TEST AND CEMENT JOBS <input type="checkbox"/>	OTHER <input type="checkbox"/>

7. Describe Proposed or Completed Operations (Clearly state all pertinent details, and give pertinent dates, including estimated date of starting any proposed work) SEE RULE 1103.

9-30-82. Moving in rat hole digger. Spudded a 12-1/4" hole at 5:30 PM 9-30-82.
Reamed out 12-1/4" hole to 40'. Set 40' of 14" conductor pipe.

8. I hereby certify that the information above is true and complete to the best of my knowledge and belief.

Original Signed By Leslie A. Clements TITLE Engineering Secretary DATE 10-4-82

APPROVED BY Supervisor District II TITLE DATE OCT 12 1982
CONDITIONS OF APPROVAL, IF ANY:

STATE OF NEW MEXICO
ENERGY AND MINERALS DEPARTMENT

OIL CONSERVATION DIVISION
P. O. BOX 2088
SANTA FE, NEW MEXICO 87501

Form C-101
Revised 10-1-78

NO. OF COPIES RECEIVED	
DISTRIBUTION	
SANTA FE	<input checked="" type="checkbox"/>
FILE	<input checked="" type="checkbox"/>
U.S.G.S.	<input checked="" type="checkbox"/>
LAND OFFICE	<input checked="" type="checkbox"/>
OPERATOR	<input checked="" type="checkbox"/>

5A. Indicate Type of Lease STATE <input checked="" type="checkbox"/> FEDERAL <input type="checkbox"/>
5. State Oil & Gas Lease No. LG-734
7. Unit Agreement Name Little Cuevo Unit
8. Farm or Lease Name Little Cuevo Unit
9. Well No. 1
10. Field and Pool, or Wildcat Wildcat - Abo
12. County Chaves

APPLICATION FOR PERMIT TO DRILL, DEEPEN, OR PLUG BACK

1. Type of Work
Type of Well
OIL WELL ☐ GAS WELL ☒ OTHER ☐

2. Name of Operator
Yates Petroleum Corporation

3. Address of Operator
207 S. 4th, Artesia, New Mexico 88210

4. Location of Well
UNIT LETTER J LOCATED 1980 FEET FROM THE South LINE
1980 FEET FROM THE East LINE OF SEC. 20 TWP. 17S RGE. 18E NMPM

RECEIVED
SEP 29 1982

19. Proposed Depth appr. 6100'	19A. Formation Abo	20. Rotary or C.T. Rotary
21A. Kind & Status Plug, Bond Blanket	21B. Drilling Contractor LaRue Drilling	22. Approx. Date Work will start ASAP

PROPOSED CASING AND CEMENT PROGRAM

SIZE OF HOLE	SIZE OF CASING	WEIGHT PER FOOT	SETTING DEPTH	SACKS OF CEMENT	EST. TOP
12 1/4"	9 5/8"	32#	1200'	500 sx	circulated
7 7/8"	5 1/2 or 4 1/2"	15.5#-9.5#	TD	700 sx	

We intend to drill and test the Abo and other formations. Will set approximately 1200' of 9 5/8" surface casing and circulate the cement to shut off caving. If needed, 7" intermediate could be run with enough cement to tie back into the surface casing. If commercial, production casing will be run and cemented with adequate cover.

MUD PROGRAM: FW gel and LCM to 1200', KCL added to 2500', SW gel/KCL to TD.

BOP PROGRAM: BOP will be installed at the offset and tested daily.

GAS NOT DEDICATED.

APPROVAL VALID FOR 180 DAYS
PERMIT EXPIRES 4/5/83
UNLESS DRILLING UNDERWAY

ABOVE SPACE DESCRIBE PROPOSED PROGRAM: IF PROPOSAL IS TO DEEPEN OR PLUG BACK, GIVE DATA ON PRESENT PRODUCTIVE ZONE AND PROPOSED NEW PRODUCTION ZONE. GIVE BLOWOUT PREVENTER PROGRAM, IF ANY.

I hereby certify that the information above is true and complete to the best of my knowledge and belief.

Signed Leslie A. Clements Title Regulatory Coordinator Date 9/28/82

(This space for State Use)

PROVED BY Leslie A. Clements
Supervisor, District II

CONDITIONS OF APPROVAL, IF ANY

Notify N.M.O.C.C. in sufficient
time to witness cementing
the 9 5/8" casing

Post ID-1
10-15-82
chg

**W MEXICO OIL CONSERVATION COMMISSION
WELL LOCATION AND ACREAGE DEDICATION PLAT**

Form C-102
Supersedes C-128
Effective 1-1-65

All distances must be from the outer boundaries of the Section.

Operator YATES PETROLEUM CORPORATION			Lease Little Cuevo Unit		Well No. 1
Unit Letter J	Section 20	Township 17 South	Range 18 East	County Chaves	
Actual Footage Location of Well: 1980 feet from the South line and 1980 feet from the East line					
Ground Level Elev. 5358.	Producing Formation Abo		Pool Wildcat		Dedicated Acreage: 160 Acres

- Outline the acreage dedicated to the subject well by colored pencil or hachure marks on the plat below.
- If more than one lease is dedicated to the well, outline each and identify the ownership thereof (both as to working interest and royalty).
- If more than one lease of different ownership is dedicated to the well, have the interests of all owners been consolidated by communitization, unitization, force-pooling, etc?

☒ Yes ☐ No If answer is "yes," type of consolidation **unitization**

If answer is "no," list the owners and tract descriptions which have actually been consolidated. (Use reverse side of this form if necessary.) _____

No allowable will be assigned to the well until all interests have been consolidated (by communitization, unitization, forced-pooling, or otherwise) or until a non-standard unit, eliminating such interests, has been approved by the Commission.

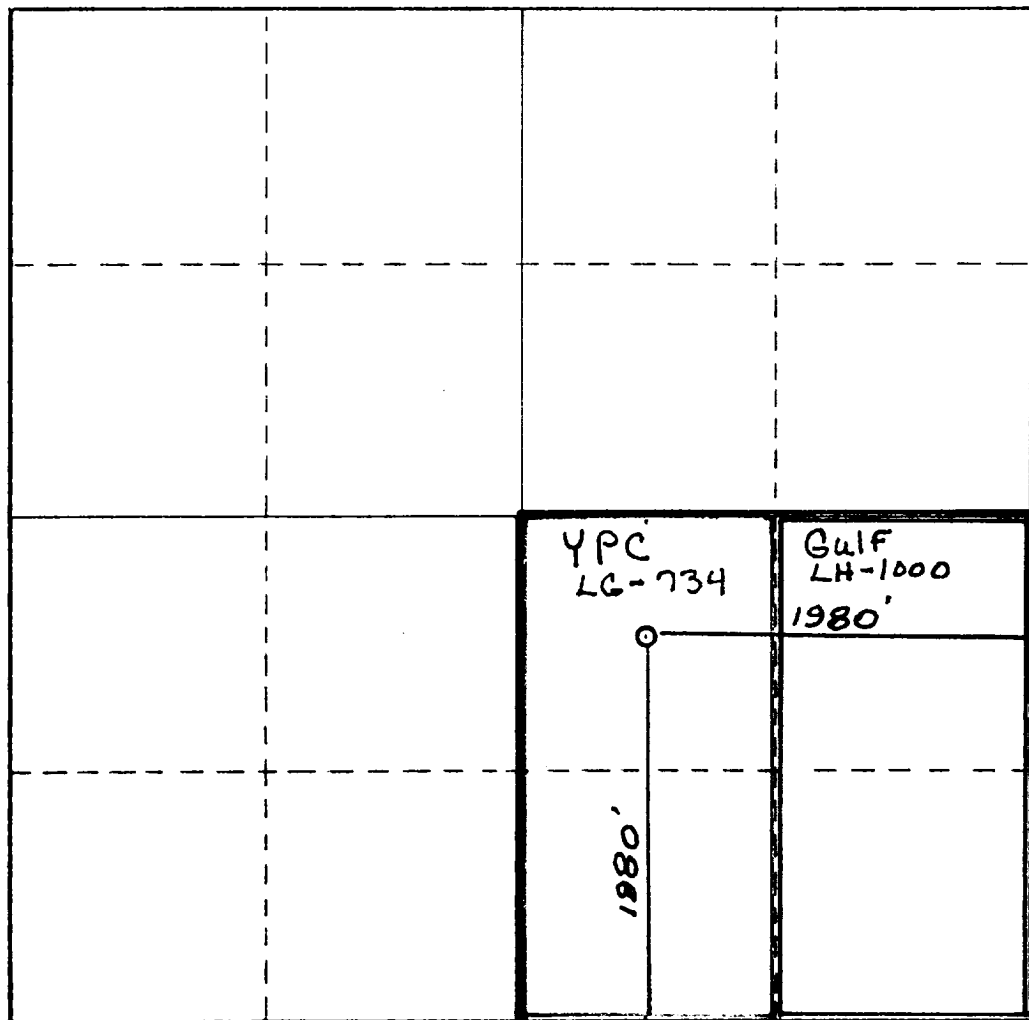

CERTIFICATION

I hereby certify that the information contained herein is true and complete to the best of my knowledge and belief.

Name
Gliserio Rodriguez
Position
Regulatory Manager
Company
Yates Petroleum Corp.
Date
9/28/82

I hereby certify that the well location shown on this plat was plotted from field notes of actual surveys made by me or under my supervision and that the same is true and correct to the best of my knowledge and belief.

Date Surveyed
September 27, 1982

Registered Professional Engineer and/or Land Surveyor

Certificate No.
NM PE&LS #5412

0 330 660 990 1320 1650 1980 2310 2640 2000 1500 1000 500 0

EXHIBIT B

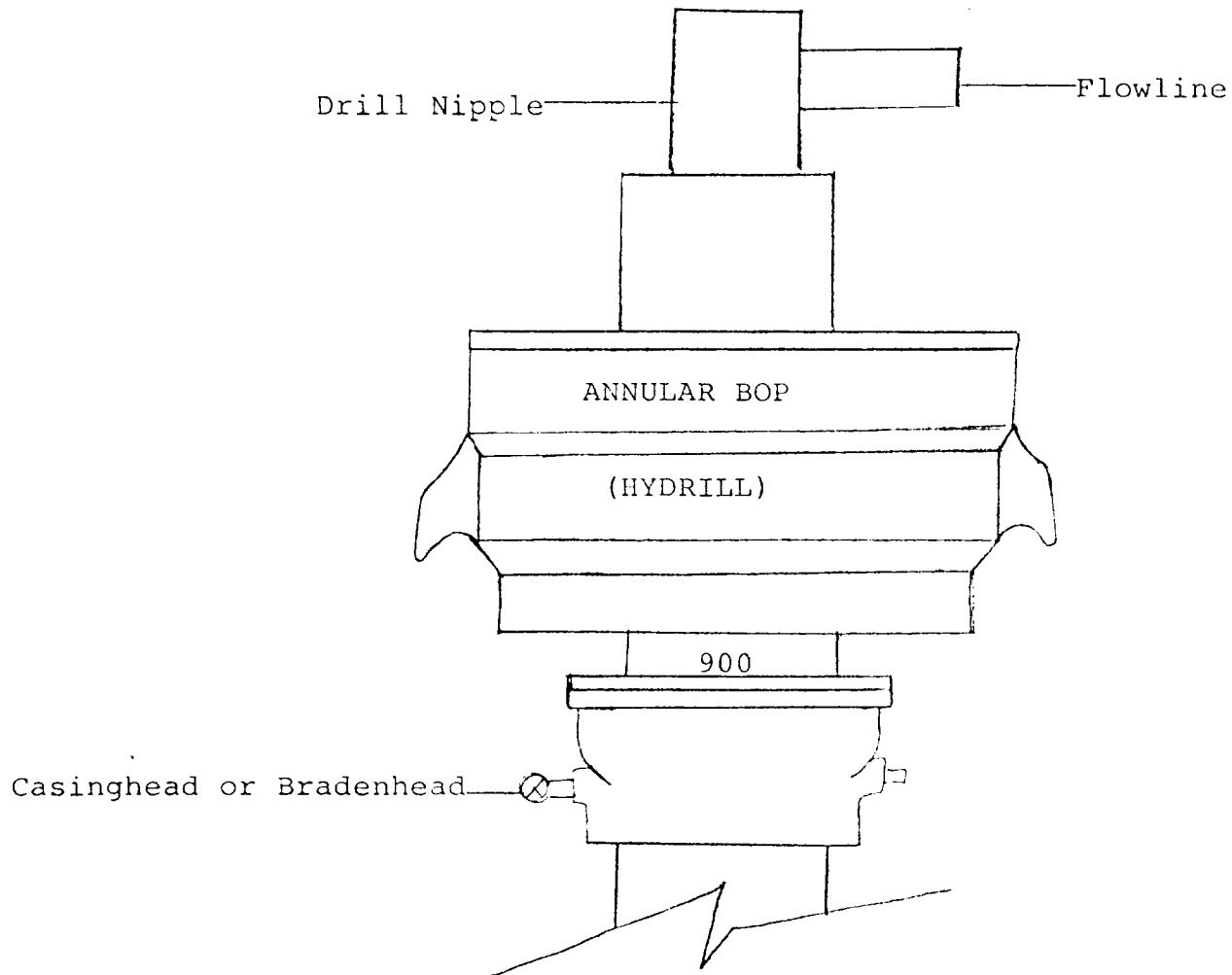

THE FOLLOWING CONSTITUTE MINIMUM BLOWOUT PREVENTER REQUIREMENTS

1. All preventers to be hydraulically operated with secondary manual controls installed prior to drilling out from under casing.
2. All connections from operating manifolds to preventers to be all steel. Hole or tube a minimum of one inch in diameter.
3. The available closing pressure shall be at least 15% in excess of that required with sufficient volume to operate the BOP's.
4. All connections to and from preventer to have a pressure rating equivalent to that of the BOP's.
5. Hole must be kept filled on trips below intermediate casing.