

(SUBMIT IN TRIPLICATE)

Land Office

Lease No.

Unit

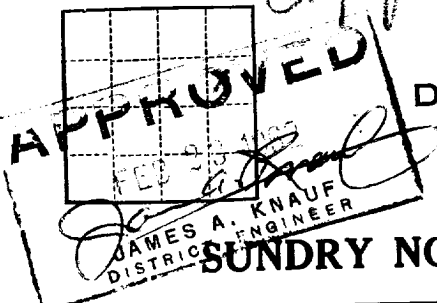

UNITED STATES  
DEPARTMENT OF THE INTERIOR  
GEOLOGICAL SURVEY

RECEIVED

FEB 27 1962

SUNDRY NOTICES AND REPORTS ON WELLS

NOTICE OF INTENTION TO DRILL.....	<input checked="" type="checkbox"/>	SUBSEQUENT REPORT OF WATER SHUT-OFF.....	
NOTICE OF INTENTION TO CHANGE PLANS.....		SUBSEQUENT REPORT OF SHOOTING OR ACIDIZING.....	
NOTICE OF INTENTION TO TEST WATER SHUT-OFF.....		SUBSEQUENT REPORT OF ALTERING CASING.....	
NOTICE OF INTENTION TO RE-DRILL OR REPAIR WELL.....		SUBSEQUENT REPORT OF RE-DRILLING OR REPAIR.....	
NOTICE OF INTENTION TO SHOOT OR ACIDIZE.....		SUBSEQUENT REPORT OF ABANDONMENT.....	
NOTICE OF INTENTION TO PULL OR ALTER CASING.....		SUPPLEMENTARY WELL HISTORY.....	
NOTICE OF INTENTION TO ABANDON WELL.....			

(INDICATE ABOVE BY CHECK MARK NATURE OF REPORT, NOTICE, OR OTHER DATA)

Artesia, New Mexico February 26, 1962

Wright Federal

Well No. 4 is located 1980 ft. from ~~NS~~<sup>N</sup> line and 660 ft. from ~~EW~~<sup>E</sup> line of sec. 1

SENE Sec. 1  
(1/4 Sec. and Sec. No.)

17S  
(Twp.)

29E  
(Range)

N.M.P.M.  
(Meridian)

Square Lake  
(Field)

Eddy

(County or Subdivision)

New Mexico

(State or Territory)

FEB 26 1962

The elevation of the ~~ground~~<sup>Ground</sup> level above sea level is 3685 ft.

DETAILS OF WORK

(State names of and expected depths to objective sands; show sizes, weights, and lengths of proposed casings; indicate mudding jobs, cementing points, and all other important proposed work)

We propose to drill a well at the above location to a depth of approximately 2900 feet to test the Lovington sand of the San Andres section.

We will run approximately 550 feet of 8 5/8" surface casing and cement same with 50 sacks. We expect to run approximately 2125 feet of 7" as a water string pulling same when the oil string is cemented. We will run an oil string of 5 1/2" or 4 1/2" cementing with 100 or 125 sacks \*perforate the sections as determined by the electric log and complete well.

\* Sufficient to cover Red Sand  
I understand that this plan of work must receive approval in writing by the Geological Survey before operations may be commenced.

Company Kincaid & Watson Drilling Company

Address P.O. Box 498

Artesia, New Mexico

By

Title Assistant Secretary

NUMBER OF COPIES RECEIVED	
SUBSTANTIATION	
SANTA FE	
FILE	
U.S.G.S.	
LAND OFFICE	
TRANSPORTER	OIL GAS
PRODUCTION OFFICE	
OPERATOR	

**NEW MEXICO OIL CONSERVATION COMMISSION**  
**WELL LOCATION AND ACREAGE DEDICATION PLAT**  
 SEE INSTRUCTIONS FOR COMPLETING THIS FORM ON THE REVERSE SIDE

FORM C-128  
Revised 5/1/57

30-015-02891

**SECTION A**

Operator <b>Kincaid &amp; Watson Drilling Co.</b>		Lease <b>Wright-Federal</b>		Well No. <b>4</b>
Unit Letter <b>H</b>	Section <b>1</b>	Township <b>17 South</b>	Range <b>29 East</b>	County <b>Eddy</b>
Actual Footage Location of Well: <b>1980</b> feet from the <b>North</b> line and <b>660</b> feet from the <b>East</b> line				
Ground Level Elev. <b>3685</b>	Producing Formation <b>San Andres</b>	Pool <b>Square Lake</b>	Dedicated Acreage: <b>40</b> Acres	

1. Is the Operator the only owner in the dedicated acreage outlined on the plat below? YES ☒ NO \_\_\_\_ . ("Owner" means the person who has the right to drill into and to produce from any pool and to appropriate the production either for himself or for himself and another. (65-3-29 (e) NMSA 1935 Comp.)
2. If the answer to question one is "no," have the interests of all the owners been consolidated by communitization agreement or otherwise? YES \_\_\_\_ NO \_\_\_\_ . If answer is "yes," Type of Consolidation \_\_\_\_\_
3. If the answer to question two is "no," list all the owners and their respective interests below:

Owner	Land Description	FEB 26 1962
		U.S.C.
		AD

**SECTION B**

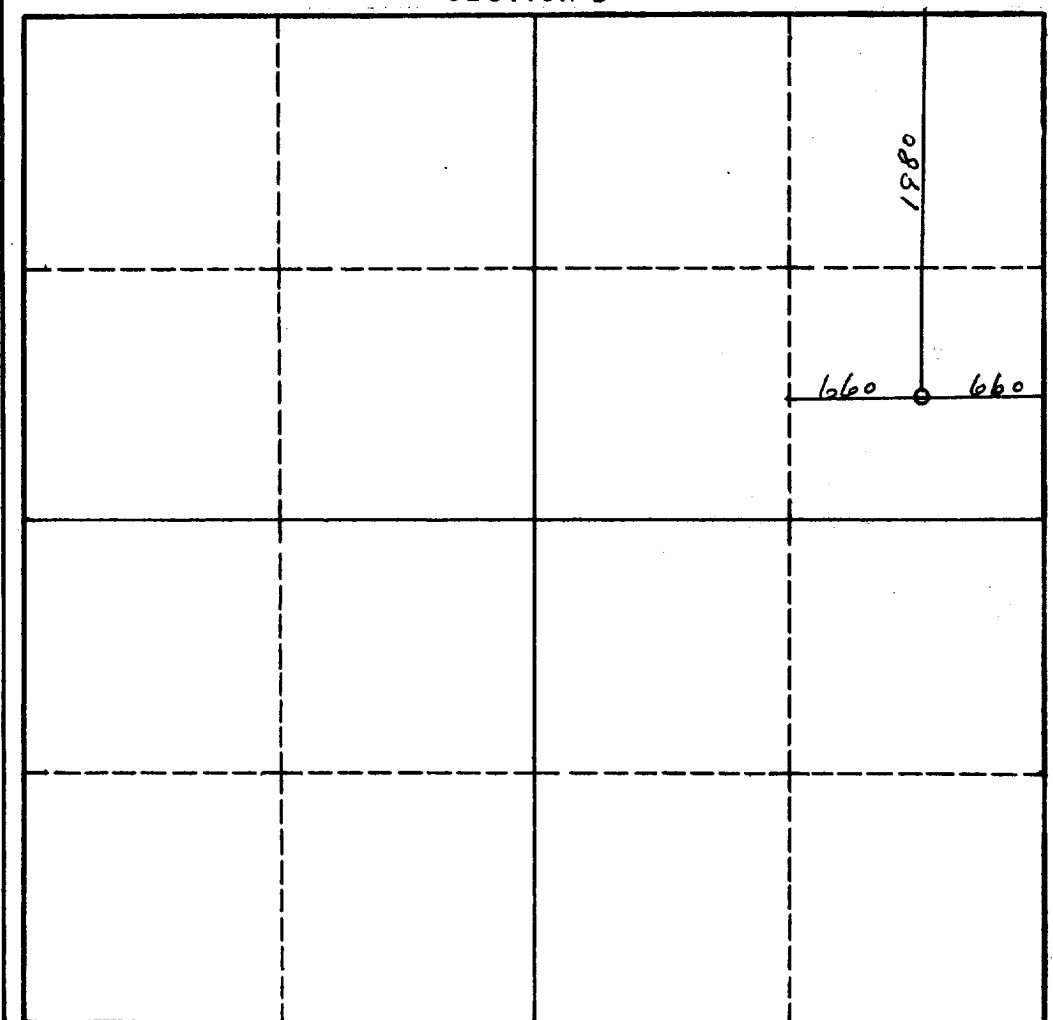

**CERTIFICATION**

I hereby certify that the information in SECTION A above is true and complete to the best of my knowledge and belief.

Name <i>[Signature]</i>
Position <b>Assistant Secretary</b>
Company <b>Kincaid &amp; Watson Drlg. Co</b>
Date <b>February 26, 1962</b>

I hereby certify that the well location shown on the plat in SECTION B was plotted from field notes of actual surveys made by me or under my supervision, and that the same is true and correct to the best of my knowledge and belief.

Date Surveyed <b>Sept., 20, 1961</b>
Registered Professional Engineer and/or Land Surveyor <i>[Signature]</i>
Certificate No. <b>1502</b>

## **INSTRUCTIONS FOR COMPLETION OF FORM C-128**

1. Operator shall furnish and certify to the information called for in Section A.
2. Operator shall outline the dedicated acreage for *both* oil and gas wells on the plat in Section B.
3. A registered professional engineer or land surveyor registered in the State of New Mexico or approved by the Commission shall show on the plat the location of the well and certify this information in the space provided.
4. All distances shown on the plat must be from the outer boundaries of the Section.
5. If additional space is needed for listing owners and their respective interests as required in question 3 of Section A, please use space below.