

(SUBMIT IN TRIPLICATE)

UNITED STATES  
DEPARTMENT OF THE INTERIOR  
GEOLOGICAL SURVEY

Land Office .....

Lease No. **NM 025733**

Unit .....

## SUNDRY NOTICES AND REPORTS ON WELLS

NOTICE OF INTENTION TO DRILL.....	<input checked="" type="checkbox"/>	SUBSEQUENT REPORT OF WATER SHUT-OFF.....	
NOTICE OF INTENTION TO CHANGE PLANS.....		SUBSEQUENT REPORT OF SHOOTING OR ACIDIZING.....	
NOTICE OF INTENTION TO TEST WATER SHUT-OFF.....		SUBSEQUENT REPORT OF ALTERING CASING.....	
NOTICE OF INTENTION TO RE-DRILL OR REPAIR WELL.....		SUBSEQUENT REPORT OF RE-DRILLING OR REPAIR.....	
NOTICE OF INTENTION TO SHOOT OR ACIDIZE.....		SUBSEQUENT REPORT OF ABANDONMENT.....	
NOTICE OF INTENTION TO PULL OR ALTER CASING.....		SUPPLEMENTARY WELL HISTORY.....	
NOTICE OF INTENTION TO ABANDON WELL.....			

(INDICATE ABOVE BY CHECK MARK NATURE OF REPORT, NOTICE, OR OTHER DATA)

December 18, 1957

Root 2-1 1650  
Well No. ~~2222~~ 2 is located 1990 ft. from ☒ N line and 660 ft. from ☒ E line of sec. 1  
SW/4 NW/4 17S 29E NMPM  
(1/4 Sec. and Sec. No.) (Twp.) (Range) (Meridian)  
Anderson Eddy New Mex. Co.  
(Field) (County or Subdivision) (State or Territory)

The elevation of the derrick floor above sea level is 3666 ft.

### DETAILS OF WORK

(State names of and expected depths to objective sands; show sizes, weights, and lengths of proposed casings; indicate mudding jobs, cementing points, and all other important proposed work)

Well will be drilled with rotary tools, 350 feet of 8 5/8" pipe will be run as a surface string and cemented with 50 sacks. It is expected that the total depth will be about 2730' and a string of 5 1/2" pipe will be run to total depth, cemented with 100 sacks, the plan then is to perforate two zones which is anticipated at about 2510' and about 2655', two zones being what is commonly known as Loco Hills and Premier. If above works out according to plans electric log will be run, the two zones perforated and treated with oil sand frac.

RECEIVED  
DEC 23 1957

I understand that this plan of work must receive approval in writing by the Geological Survey before operations may be commenced.

Company O. H. Randel.Address Box 88, Carlsbad, N. M.

By

Title Operator.



APPROVED

DEC 23 1957

ROBERT F. EVANS  
DISTRICT ENGINEER

Form C-128  
Revised 5/1/57

NEW MEXICO OIL CONSERVATION COMMISSION

Well Location and Acreage Dedication Plat

Section A

Date Dec. 18, 1957

Operator O. H. Randel Lease Federal Root  
Well No. 2-1 Unit Letter E Section 1 Township 17S Range 29 E NMPM  
Located 660 Feet From West Line, 1980 Feet From North Line  
County Eddy G. L. Elevation 5666 Dedicated Acreage 40 Acres  
Name of Producing Formation Loco Hills & Premier Pool Anderson

1. Is the Operator the only owner\* in the dedicated acreage outlined on the plat below?  
Yes Yes No       .
2. If the answer to question one is "no," have the interests of all the owners been consolidated by communitization agreement or otherwise? Yes        No       . If answer is "yes," Type of Consolidation
3. If the answer to question two is "no," list all the owners and their respective interests below:

Owner

Land Description

RECEIVED  
DEC 23 1957

Section B

R29E

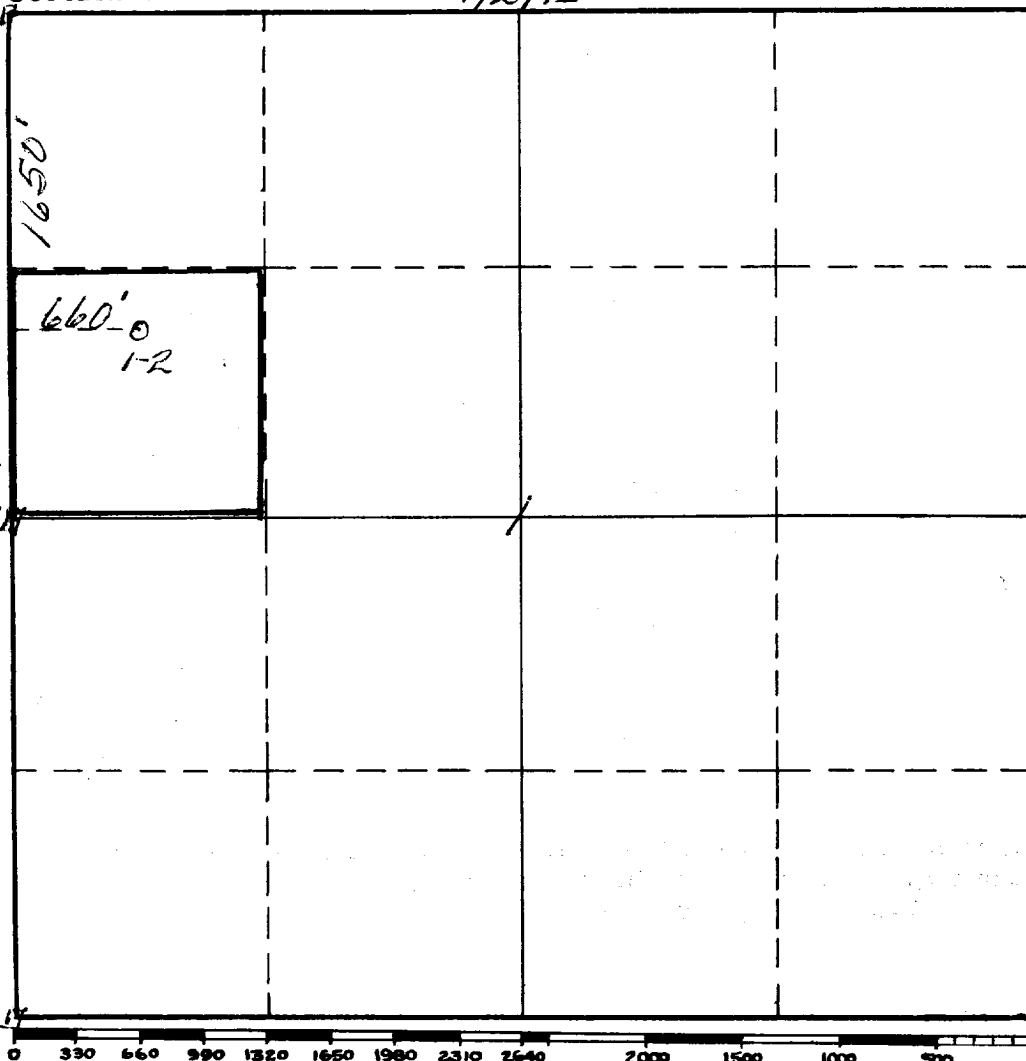

This is to certify that the information in Section A above is true and complete to the best of my knowledge and belief.

O. H. Randel  
(Operator)

Box 88,

(Representative)

Carlsbad, N. M.

Address

This is to certify that the well location shown on the plat in Section B was plotted from field notes of actual surveys made by me or under my supervision and that the same is true and correct to the best of my knowledge and belief.

Date Surveyed Dec 5, 1957

James H. Brown  
Registered Professional  
Engineer and/or Land Surveyor.

Certificate No. 542

(See instructions for completing this form on the reverse side)

STRUCTIONS FOR COMPLETION.

1. Operator shall furnish and certify to the information called for in Section A.
2. Operator shall outline the dedicated acreage for both oil and gas wells on the plat in Section B.
3. A registered professional engineer or land surveyor registered in the State of New Mexico or approved by the Commission shall show on the plat the location of the well and certify this information in the space provided.
4. All distances shown on the plat must be from the outer boundaries of Section.
5. If additional space is needed for listing owners and their respective interests as required in question 3, Section A, please use space below

\* "Owner" means the person who has the right to drill into and to produce from any pool and to appropriate the production either for himself or for himself and another. (65-3-29 (e) NMSA 1953 Comp.)