

(SUBMIT IN TRIPLICATE)

UNITED STATES  
DEPARTMENT OF THE INTERIOR  
GEOLOGICAL SURVEY

Land Office \_\_\_\_\_

Lease No. MMO25733

Unit 30-015-02847  
**RECEIVED**

**SUNDRY NOTICES AND REPORTS ON WELLS** MAR 3 1960

NOTICE OF INTENTION TO DRILL	<input checked="" type="checkbox"/>	SUBSEQUENT REPORT OF WATER SHUT-OFF	<input type="checkbox"/>
NOTICE OF INTENTION TO CHANGE PLANS	<input type="checkbox"/>	SUBSEQUENT REPORT OF SHOOTING OR ACIDIZING	<input type="checkbox"/>
NOTICE OF INTENTION TO TEST WATER SHUT-OFF	<input type="checkbox"/>	SUBSEQUENT REPORT OF ALTERING CASING	<input type="checkbox"/>
NOTICE OF INTENTION TO RE-DRILL OR REPAIR WELL	<input type="checkbox"/>	SUBSEQUENT REPORT OF RE-DRILLING OR REPAIR	<input type="checkbox"/>
NOTICE OF INTENTION TO SHOOT OR ACIDIZE	<input type="checkbox"/>	SUBSEQUENT REPORT OF ABANDONMENT	<input type="checkbox"/>
NOTICE OF INTENTION TO PULL OR ALTER CASING	<input type="checkbox"/>	SUPPLEMENTARY WELL HISTORY	<input type="checkbox"/>
NOTICE OF INTENTION TO ABANDON WELL	<input type="checkbox"/>		

(INDICATE ABOVE BY CHECK MARK NATURE OF REPORT, NOTICE, OR OTHER DATA)

February 23, 1960

Well No. Root 6-1 is located 2310 ft. from N line and 1650 ft. from E line of sec. 1

SW/4 of NE/4  
(1/4 Sec. and Sec. No.)

17S  
(Twp.)

29E  
(Range)

NMPM  
(Meridian)

Square Lake  
(Field)

Eddy  
(County or Subdivision)

New Mexico  
(State or Territory)

The elevation of the derrick floor above sea level is 3082 ft.

**DETAILS OF WORK**

(State names of and expected depths to objective sands; show sizes, weights, and lengths of proposed casings; indicate mudding jobs, cementing points, and all other important proposed work)

well will be drilled with cable tools, about 525 feet of 8 5/8" pipe will be run as surface string and cemented with 50 sacks. It is expected the total depth will be about 2700 feet. It is planned at this time to run a string of 5 1/2" new pipe to total depth and cement with 100 sacks.

**ILLEGIBLE**

I understand that this plan of work must receive approval in writing by the Geological Survey before operations may be commenced.

Company O. H. Kandel

Address 8 x 80, Carlsbad, N. M.

By [Signature]

Title Operator

NEW MEXICO OIL CONSERVATION COMMISSION  
WELL LOCATION AND ACREAGE DEDICATION PLAT

FORM C-128  
Revised 5/1/57

SEE INSTRUCTIONS FOR COMPLETING THIS FORM ON THE REVERSE SIDE

SECTION A

Operator	O.H. Randel	Lease	Federal	Well No.	6-1
Unit Leger	Section 1	Township 17 South	Range 29 East	County	Reddy
Actual Footage Location of Well:	North	1650	East		
feet from the	line and		feet from the	line	
Ground Level Elev.	3682	Producing Formation	Pool	Dedicated Acreage:	Acres

1. Is the Operator the only owner in the dedicated acreage outlined on the plat below? YES \_\_\_\_\_ NO \_\_\_\_\_. ("Owner" means the person who has the right to drill into and to produce from any pool and to appropriate the production either for himself or for himself and another. (65-3-29 (e) NMSA 1935 Comp.)
2. If the answer to question one is "no," have the interests of all the owners been consolidated by communitization agreement or otherwise? YES \_\_\_\_\_ NO \_\_\_\_\_. If answer is "yes," Type of Consolidation \_\_\_\_\_
3. If the answer to question two is "no," list all the owners and their respective interests below:

Owner	Land Description
ILLECIBLE	

SECTION B

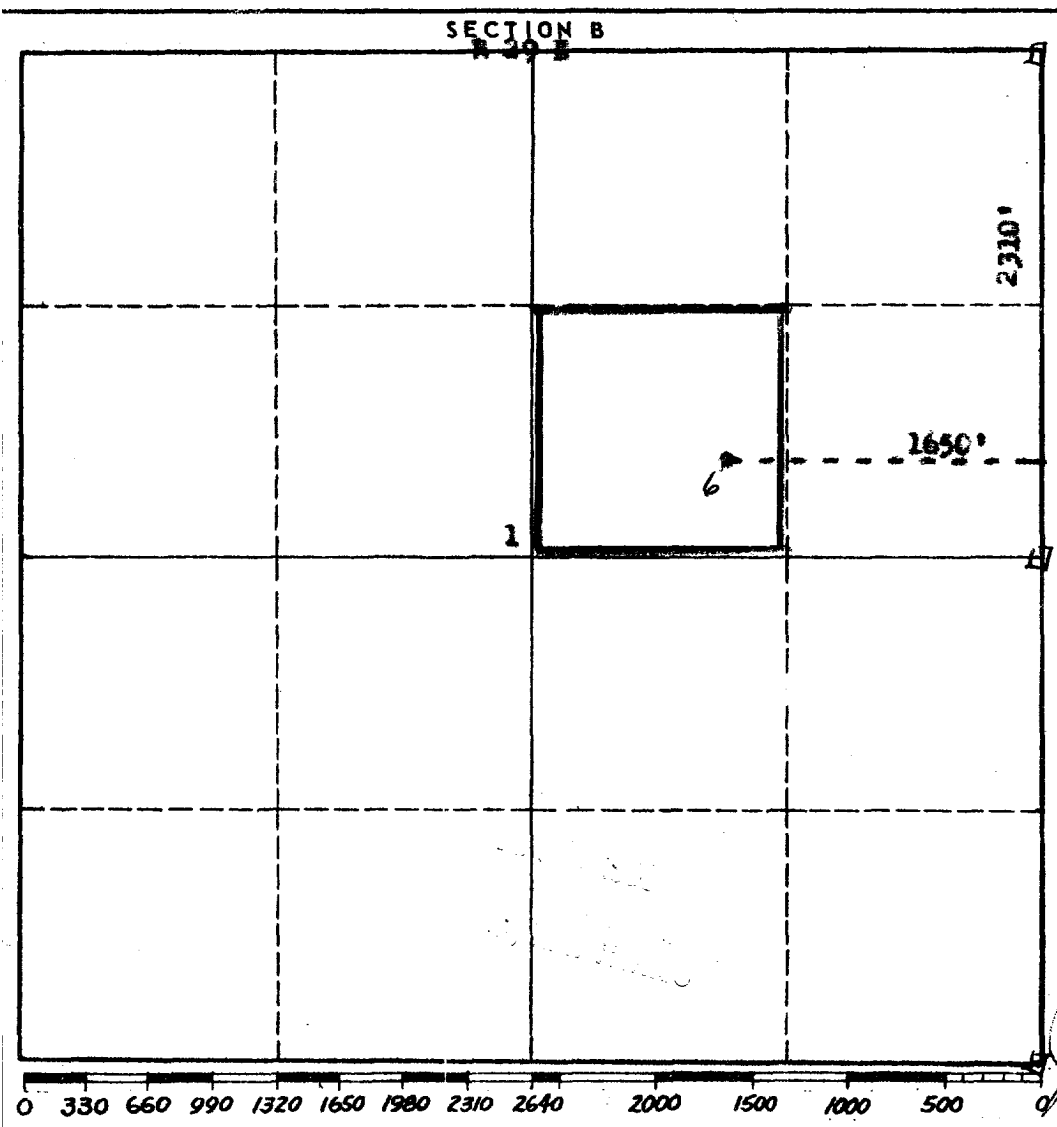

CERTIFICATION

I hereby certify that the information in SECTION A above is true and complete to the best of my knowledge and belief.

Signature

Position

Date February 23, 1960

Date

I hereby certify that the well location shown on the plat in SECTION B was plotted from field notes of actual surveys made by me or under my supervision, and that the same is true and correct to the best of my knowledge and belief.

Date Surveyed February 23, 1960

Registered Professional Engineer and/or Land Surveyor

Certificate No. N.M.L.S. No. 542

## INSTRUCTIONS FOR COMPLETION OF FORM C-128

1. Operator shall furnish and certify to the information called for in Section A.
2. Operator shall outline the dedicated acreage for *both* oil and gas wells on the plat in Section B.
3. A registered professional engineer or land surveyor registered in the State of New Mexico or approved by the Commission shall show on the plat the location of the well and certify this information in the space provided.
4. All distances shown on the plat must be from the outer boundaries of the Section.
5. If additional space is needed for listing owners and their respective interests as required in question 3 of Section A, please use space below.