

NEW MEXICO OIL CONSERVATION COMMISSION
Santa Fe, New Mexico

(Form C-101)
(Revised 7/1/52)

NOTICE OF INTENTION TO DRILL OR RECOMPLETE

Notice must be given to the District Office of the Oil Conservation Commission and approval obtained before drilling or recompletion begins. If changes in the proposed plan are considered advisable, a copy of this notice showing such changes will be returned to the sender. Submit this notice in QUINTUPLICATE. One copy will be returned following approval. See additional instructions in Rules and Regulations of the Commission.

Roswell, N.M.

(Place)

Nov 3, 1956

(Date)

OIL CONSERVATION COMMISSION
SANTA FE, NEW MEXICO

Gentlemen:

You are hereby notified that it is our intention to commence the (Drilling) (Recompletion) of a well to be known as

John M. Kelly

Eddy

(Company or Operator)

State L

(Lease)

Well No. 1

in ~~333W~~ N

The well is

located 1980 feet from the West

South

line and 660 feet from the

line of Section 5, T. 17 S., R. 29 E., NMPM.

(GIVE LOCATION FROM SECTION LINE)

Cave

Pool, Eddy

County

If State Land the Oil and Gas Lease is No. B-8559

If patented land the owner is

Address

We propose to drill well with drilling equipment as follows:

Cable tools

The status of plugging bond is on file

Drilling Contractor Donnelly Drilling Co

We intend to complete this well in the Grayburg

formation at an approximate depth of 2400 feet.

CASING PROGRAM

We propose to use the following strings of Casing and to cement them as indicated:

Size of Hole	Size of Casing	Weight per Foot	New or Second Hand	Depth	Sacks Cement
10 $\frac{1}{2}$	8 5/8	32	New	250	100
8 $\frac{1}{2}$	7	20	New	2350	100

If changes in the above plans become advisable we will notify you immediately.

ADDITIONAL INFORMATION (If recompletion give full details of proposed plan of work.)

Approved....., 19.....
Except as follows:

OIL CONSERVATION COMMISSION

By M. L. Armstrong

Title

Sincerely yours,

John M. Kelly

(Company or Operator)

By

Operator

Position

Send Communications regarding well to

Name

John M. Kelly

Address

Box 5371 Roswell, N.M.

NEW MEXICO
OIL CONSERVATION COMMISSION

Form C-128

Well Location and/or Gas Proration Plat

Operator JOHN E. KELLY Lease Eddy State "L" Date 11/31/56
Well No. 1 Section 5 Township 17 S. Range 29 E. NMPM
Located 660 Feet From South Line, 1980 Feet From West Line,
Eddy County, New Mexico. G. L. Elevation _____

Name of Producing Formation _____ Pool _____ Dedicated Acreage _____

(Note: All distances must be from outer boundaries of Section)

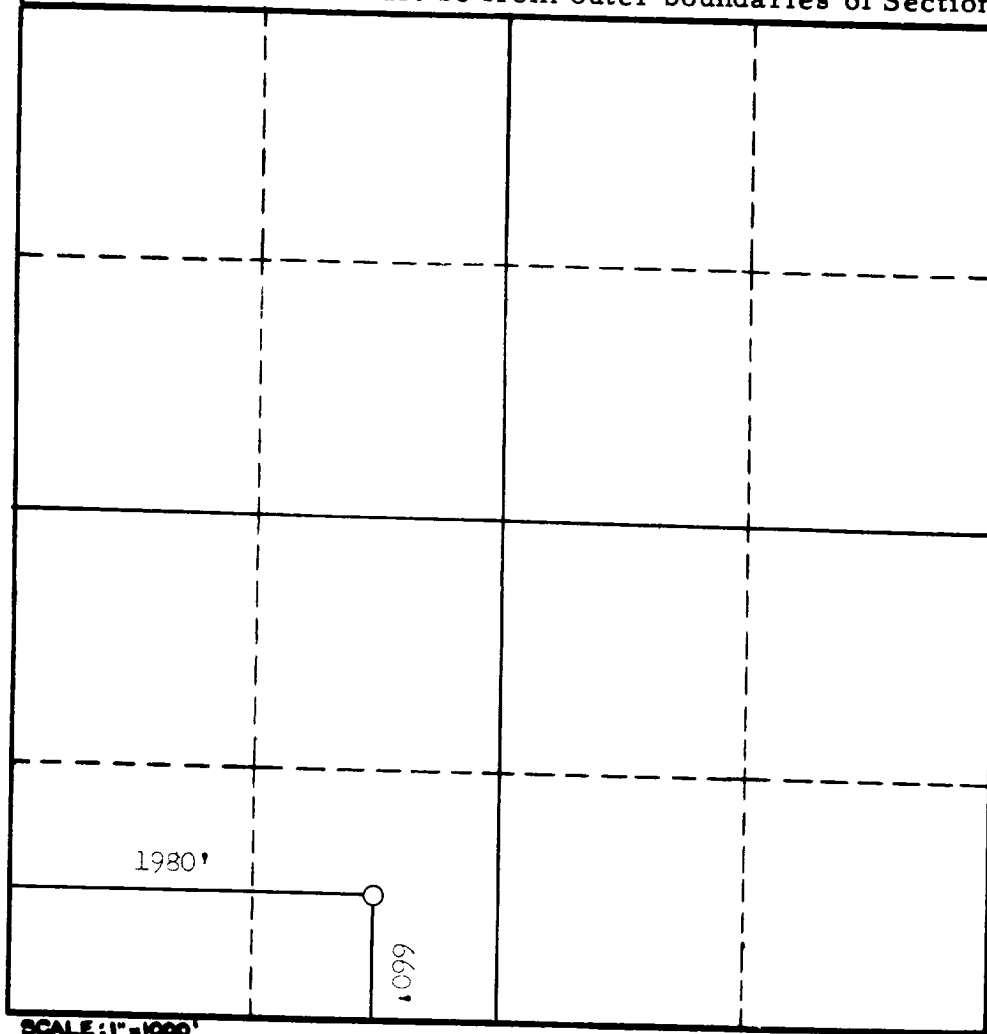

NOTE

This section of
form is to be
used for gas
wells only.



1. Is this Well a Dual Comp. ? Yes ___ No ___.
2. If the answer to Question 1 is yes, are there any other dually completed wells within the dedicated acreage ? Yes ___ No ___.

Name _____
Position _____
Representing _____
Address _____

This is to certify that the above plat was prepared from field notes of actual surveys made by me or under my supervision and that the same are true and correct to the best of my knowledge and belief.

Date Surveyed 10/31/56
George A. Kinachfield
Registered Professional Engineer and/or
Land Surveyor