

NEW MEXICO
OIL CONSERVATION COMMISSION

Form C-128

Well Location and/or Gas Proration Plat

Date 1-30-57

Operator General American Oil Co. of Texas Lease Green "B"

Well No. 7 Section 5 Township 17 S Range 29 E NMPM

Located 1650 Feet From South Line, 990 Feet From West Line,

Eddy County, New Mexico. G. L. Elevation 3644

Name of Producing Formation _____ Pool _____ Dedicated Acreage _____

(Note: All distances must be from outer boundaries of Section)

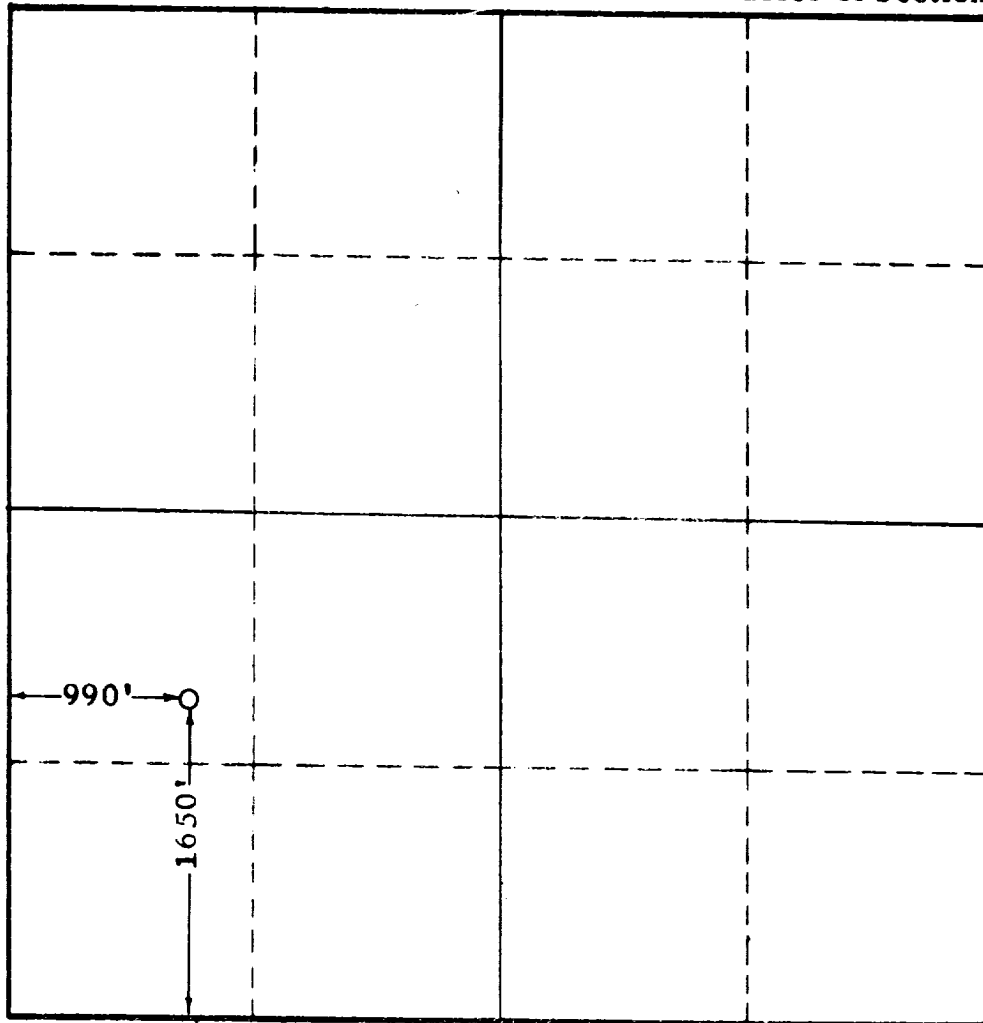

SCALE: 1"=1000'

1. Is this Well a Dual Comp.? Yes No .
2. If the answer to Question 1 is yes, are there any other dually completed wells within the dedicated acreage? Yes No .

This is to certify that the above plat was prepared from field notes of actual surveys made by me or under my supervision and that the same are true and correct to the best of my knowledge and belief.

Name _____
Position _____
Representing _____
Address _____

Date Surveyed 1-29-57

Registered John W. West
Professional Engineer and/or
Land Surveyor