

NEW MEXICO OIL CONSERVATION COMMISSION
Santa Fe, New Mexico

Form C-101
Revised (12/1/55)

NOTICE OF INTENTION TO DRILL

FEB 3 1958

Notice must be given to the District Office of the Oil Conservation Commission and approval obtained before drilling or recompletion begins. If changes in the proposed plan are considered advisable, a copy of this notice showing such changes will be returned to the sender. Submit this notice in QUINTUPLICATE. One copy will be returned following approval. See additional instructions in Rules and Regulations of the Commission. If State Land submit 6 Copies Attach Form C-128 in triplicate to first 3 copies of form C-101

Hobbs, New Mexico
(Place)

January 30, 1958
(Date)

OIL CONSERVATION COMMISSION
SANTA FE, NEW MEXICO

Gentlemen:

You are hereby notified that it is our intention to commence the Drilling of a well to be known as

John M. Kelly
(Company or Operator)

Sinclair State
(Lease)

Well No. 1, in D. The well is

located 330 feet from the North line and 330 feet from the

West line of Section 9, T. 17 S., R. 29 E., NMPM.

(GIVE LOCATION FROM SECTION LINE) Cave Pool, Eddy County

If State Land the Oil and Gas Lease is No.

If patented land the owner is.

Address.

We propose to drill well with drilling equipment as follows: Cable tools

from surface to TD

The status of plugging bond is Blanket bond on file

Drilling Contractor Donnelly Drlg. Co.

Artesia, New Mexico

We intend to complete this well in the Grayburg

formation at an approximate depth of 2400 feet.

CASING PROGRAM

We propose to use the following strings of Casing and to cement them as indicated:

Size of Hole	Size of Casing	Weight per Foot	New or Second Hand	Depth	Sacks Cement
10 1/2	8 5/8	24	New	260	100
8	7	20	New	2370	200

If changes in the above plans become advisable we will notify you immediately.

ADDITIONAL INFORMATION (If recompletion give full details of proposed plan of work.)

Approved FEB 3 1958
Except as follows:

OIL CONSERVATION COMMISSION

By M. L. Armstrong

Sincerely yours,

John M. Kelly (Operator)
By Sumner W. McArthur

Position Production Superintendent
Send Communications Regarding Well No.

Name John M. Kelly

Address Box 5671 Roswell, New Mexico

1000

NEW MEXICO OIL CONSERVATION COMMISSION
Well Location and Acreage Dedication Plat

FEB 3 1958

Section A.

Date January 30, 1958

Operator John M. Kelly Lease Sinclair State
Well No. 1 Unit Letter D Section 9 Township 17 Range 29 NMPM
Located 330 Feet From North Line, 330 Feet From West Line
County Eddy G. L. Elevation 3595 Dedicated Acreage 40 Acres
Name of Producing Formation Grayburg Pool Cave

1. Is the Operator the only owner* in the dedicated acreage outlined on the plat below?
Yes X No .
2. If the answer to question one is "no," have the interests of all the owners been consolidated by communitization agreement or otherwise? Yes No . If answer is "yes," Type of Consolidation
3. If the answer to question two is "no," list all the owners and their respective interests below:

Owner

Land Description

<u>Owner</u>	<u>Land Description</u>

Section B

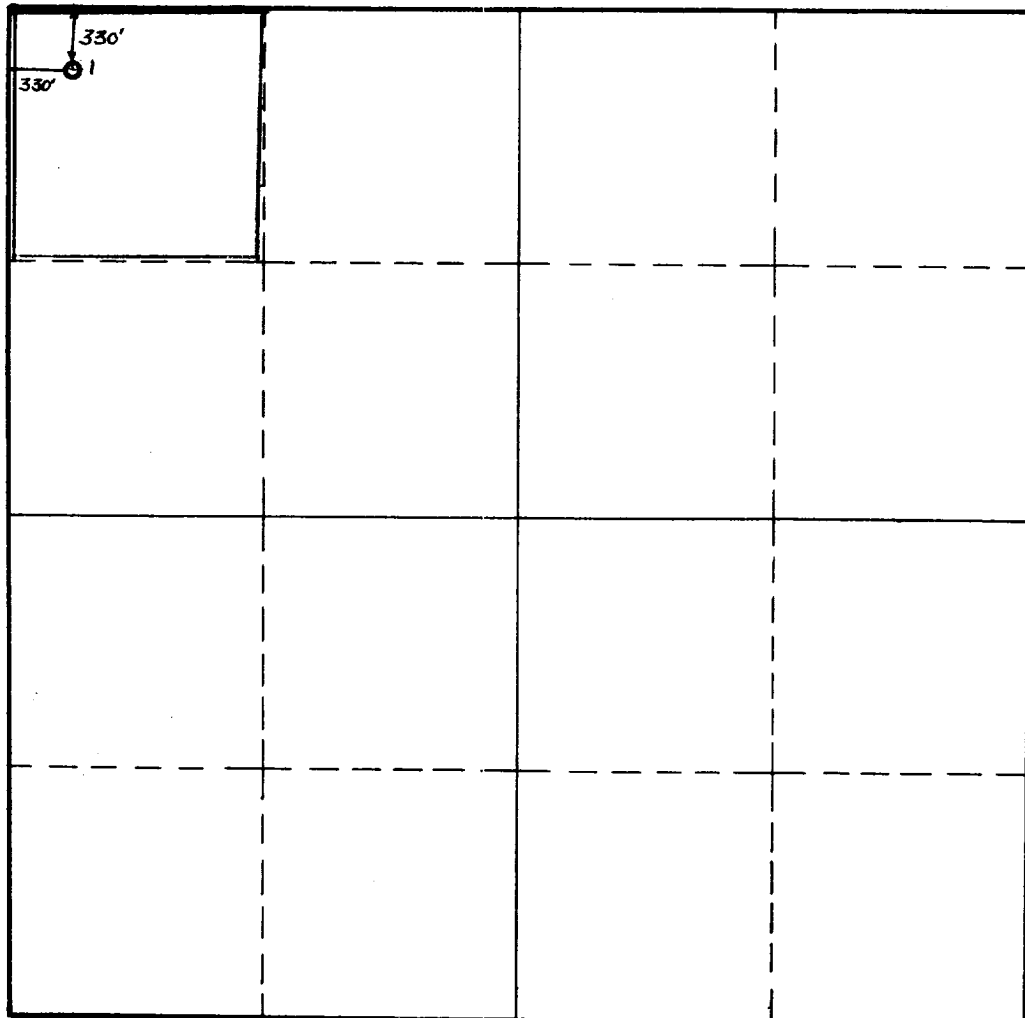

This is to certify that the information in Section A above is true and complete to the best of my knowledge and belief.

John M. Kelly
(Operator)
Kenneth D. McPherson
(Representative)

204 Llano Dr. Hobbs, N.M.
Address

This is to certify that the well location shown on the plat in Section B was plotted from field notes of actual surveys made by me or under my supervision and that the same is true and correct to the best of my knowledge and belief.

Date Surveyed January 25, 1958

Serge B. Hunsfield
Registered Professional
Engineer and/or Land Surveyor.

Certificate No. 1523
(See instructions for completing this form on the reverse side)

INSTRUCTIONS FOR COMPLETION :

1. Operator shall furnish and certify to the information called for in Section A.
2. Operator shall outline the dedicated acreage for both oil and gas wells on the plat in Section B.
3. A registered professional engineer or land surveyor registered in the State of New Mexico or approved by the Commission shall show on the plat the location of the well and certify this information in the space provided.
4. All distances shown on the plat must be from the outer boundaries of Section.
5. If additional space is needed for listing owners and their respective interests as required in question 3, Section A, please use space below

OIL CONSERVATION COMMISSION		
ARTESIA DISTRICT OFFICE		
No. Copies Received		6
DISTRIBUTION		
	NO. COPIES	REMARKS
Operator		
Surveyor	1	
Production Office		
State Land Office	1	
U. S. G. S.	2	
Transportation		
	1	✓

* "Owner" means the person who has the right to drill into and to produce from any pool and to appropriate the production either for himself or for himself and another. (65-3-29 (e) NMSA 1953 Comp.)

February 3, 1958

John M. Kelly
Box 5671
Roswell, New Mexico

Dear Sir:

This will acknowledge receipt of C-101 & C-128 on
your Sinclair State No.1 in Sec. 9-17S-29E, Eddy County,
New Mexico.

We will need one (1) extra copy of form C-101 before
approval can be ~~made~~ *made*.

IF STATE LAND SUBMIT 6 COPIES.

Yours very truly,

OIL CONSERVATION COMMISSION

M. L. Armstrong,
Supervisor, District No. 2

MLA/jn

February 2, 1940

John M. Kelly
Box 567
Roswell, New Mexico

Dear Sir:

This will acknowledge receipt of C-101 & C-102 on
your State No. 1 in Sec. 9-102-224, Bock County,
New Mexico.

We will need one (1) extra copy of form C-101 before
approval can be ~~made~~.

IT STATE LAND BUREAU & COPIES.

Yours very truly,

JOHN M. KELLY

E. L. Armstrong,
Supervisor, District No. 2

ELV/jn