

(SUBMIT IN TRIPLICATE)

UNITED STATES
DEPARTMENT OF THE INTERIOR
GEOLOGICAL SURVEY

Land Office Las Cruces

Lease No. 028731 8

Unit K

RECEIVED

SUNDRY NOTICES AND REPORTS ON WELLS

Oil Cons. Comm.	
ARTESIA OFFICE	
NOTICE OF INTENTION TO DRILL	SUBSEQUENT REPORT OF WATER SHUT-OFF
NOTICE OF INTENTION TO CHANGE PLANS	SUBSEQUENT REPORT OF SHOOTING OR ACIDIZING
NOTICE OF INTENTION TO TEST WATER SHUT-OFF	SUBSEQUENT REPORT OF ALTERING CASING
NOTICE OF INTENTION TO RE-DRILL OR REPAIR WELL	SUBSEQUENT REPORT OF RE-DRILLING OR REPAIR
NOTICE OF INTENTION TO SHOOT OR ACIDIZE	SUBSEQUENT REPORT OF ABANDONMENT
NOTICE OF INTENTION TO PULL OR ALTER CASING	SUPPLEMENTARY WELL HISTORY
NOTICE OF INTENTION TO ABANDON WELL	

(INDICATE ABOVE BY CHECK MARK NATURE OF REPORT, NOTICE, OR OTHER DATA)

Very Good *B*

September 1, 1957

Well No. 11 is located 1984 ft. from [N] line and 1050 ft. from [W] line of sec. 10

NE 1/4 of SE 1/4

170 295

(1/4 Sec. and Sec. No.)

(Twp.)

(Range)

(Meridian)

Lawson Cave

Hddy

New Mexico

(Field)

(County or Subdivision)

(State or Territory)

The elevation of the derrick floor above sea level is 3586 ft.

DETAILS OF WORK

(State names of and expected depths to objective sands; show sizes, weights, and lengths of proposed casings; indicate mudding jobs, cementing points, and all other important proposed work)

We propose to drill this well with cable tools to approximately 2,470' and complete in the Frontier zone. We propose to set 5 5/8" surface casing at approximately 375' and cement to surface. We propose to set 5 1/2" casing to T. D. We propose to acidize and sand oil free during completion if necessary to stimulate production.

RECEIVED
SEP 5 1957

I understand that this plan of work must receive approval in writing by the Geological Survey before operations may be commenced.

Company Conroy Mid-Continent Oil Company

Address P. O. Box 124

Hobbs, New Mexico

By O. T. McClonohy

Title Hobbs Area Superintendent

NEW MEXICO OIL CONSERVATION COMMISSION

Well Location and Acreage Dedication Plat

Section A.

Date 8-28-57

Operator Sunray Mid-Continent Oil Co Lease Mary Dodd "B"
Well No. 13 Unit Letter K Section 10 Township 17 Range 29 NMPM
Located 1980 Feet From South Line, 1650 Feet From West Line
County Eddy G. L. Elevation 1500 Dedicated Acreage 40 Acres
Name of Producing Formation Premier Pool Anderson Cove

1. Is the Operator the only owner* in the dedicated acreage outlined on the plat below?
Yes X No .
2. If the answer to question one is "no," have the interests of all the owners been consolidated by communitization agreement or otherwise? Yes No . If answer is "yes," Type of Consolidation
3. If the answer to question two is "no," list all the owners and their respective interests below:

Owner

Land Description

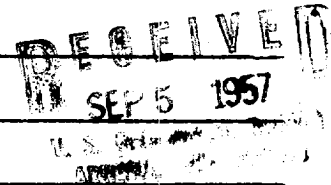

Section B

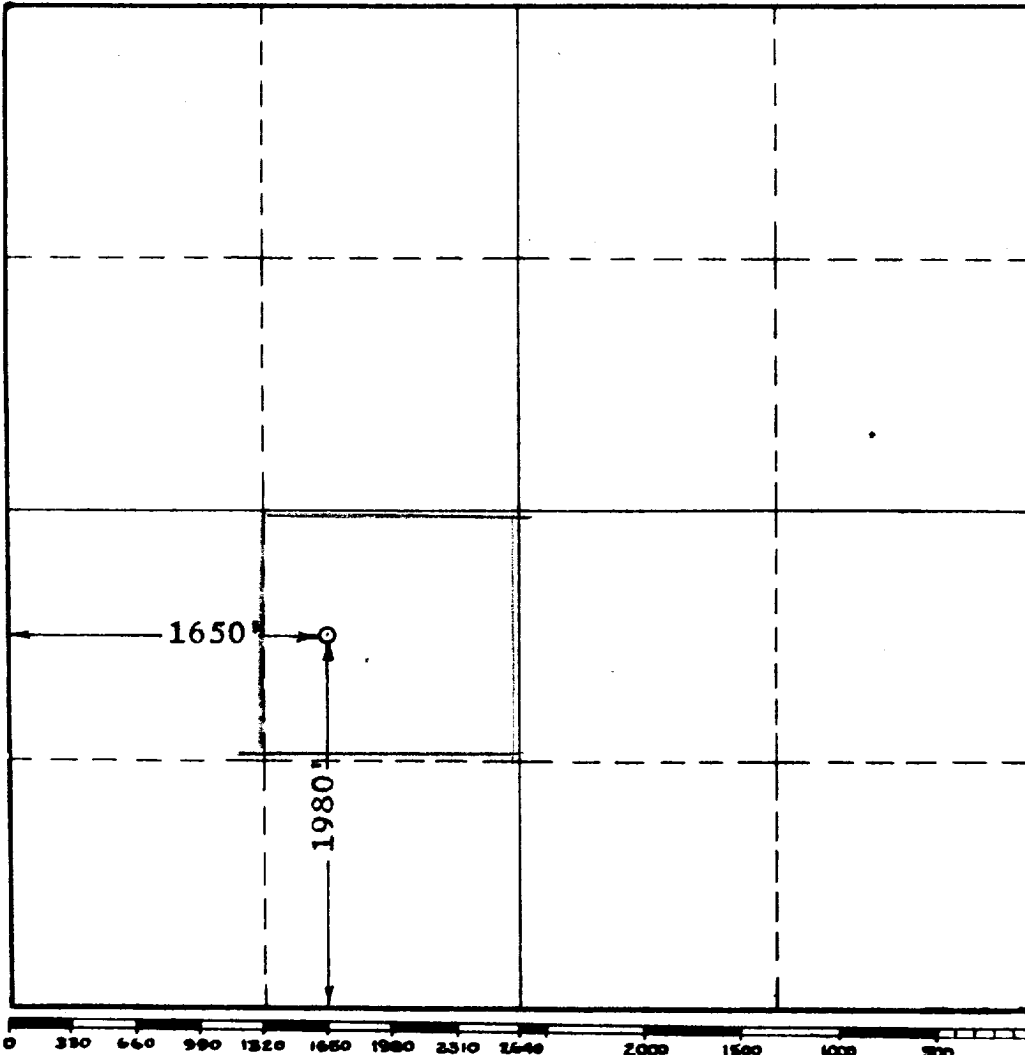

This is to certify that the information in Section A above is true and complete to the best of my knowledge and belief.

Sunray Mid-Continent Oil Co
(Operator)

C. J. McCloud
(Representative)

Bldg 128 Hobbs New Mex
Address

This is to certify that the well location shown on the plat in Section B was plotted from field notes of actual surveys made by me or under my supervision and that the same is true and correct to the best of my knowledge and belief.

Date Surveyed 8-28-57

John W. West
Registered Professional
Engineer and/or Land Surveyor.

Certificate No. 676

NEW MEXICO OIL CONSERVATION COMMISSION
Well Location and Acreage Dedication Plat

Section A.

Date 8-28-57

Operator Sunray Mid-Continent Oil Co Lease Mary Dodd "B"
Well No. 13 Unit Letter K Section 10 Township 17 Range 29 NMFM
Located 1980 Feet From South Line, 1650 Feet From West Line
County Eddy G. L. Elevation 3500 Dedicated Acreage 40 Acres
Name of Producing Formation Premier Pool Anderson Cove

1. Is the Operator the only owner* in the dedicated acreage outlined on the plat below?
Yes No .
2. If the answer to question one is "no," have the interests of all the owners been consolidated by communitization agreement or otherwise? Yes No . If answer is "yes," Type of Consolidation
3. If the answer to question two is "no," list all the owners and their respective interests below:

Owner

Land Description

RECEIVED
SEP 5 1957
U. S. GEOLOGICAL SURVEY
ALBUQUERQUE, NEW MEXICO

Section B

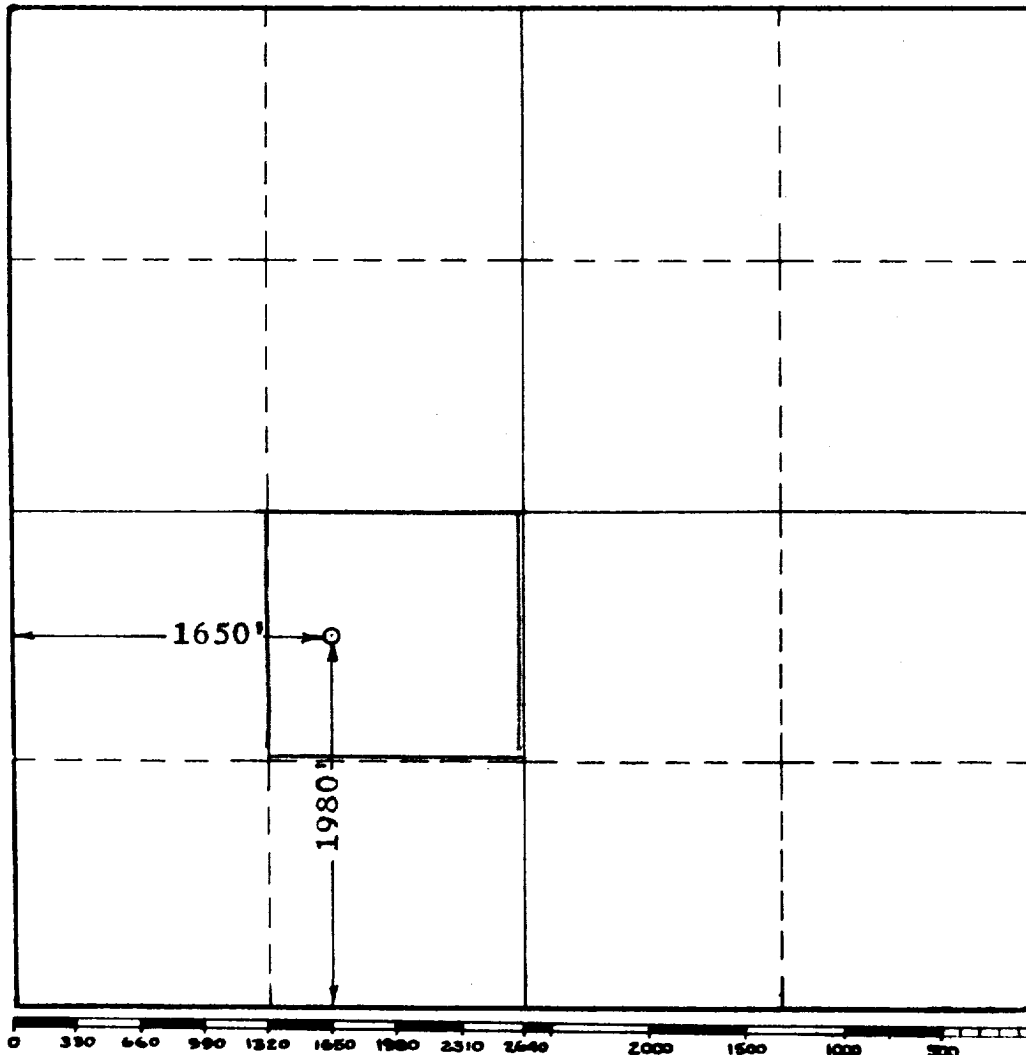

This is to certify that the information in Section A above is true and complete to the best of my knowledge and belief..

Sunray Mid-Continent Oil Co
(Operator)

C. J. M. & Clark
(Representative)

8/28 H. H. New Mexico
Address

This is to certify that the well location shown on the plat in Section B was plotted from field notes of actual surveys made by me or under my supervision and that the same is true and correct to the best of my knowledge and belief.

Date Surveyed 8-28-57

John W. West
Registered Professional
Engineer and/or Land Surveyor.

Certificate No. 676