

(SUBMIT IN TRIPLICATE)

Land Office **LC 020731(w)**

Lease No. **0**

Unit _____

UNITED STATES
DEPARTMENT OF THE INTERIOR
GEOLOGICAL SURVEY

SUNDRY NOTICES AND REPORTS ON WELLS

NOTICE OF INTENTION TO DRILL.....	SUBSEQUENT REPORT OF WATER SHUT-OFF.....
NOTICE OF INTENTION TO CHANGE PLANS.....	SUBSEQUENT REPORT OF SHOOTING OR ACIDIZING.....
NOTICE OF INTENTION TO TEST WATER SHUT-OFF.....	SUBSEQUENT REPORT OF ALTERING CASING.....
NOTICE OF INTENTION TO RE-DRILL OR REPAIR WELL.....	SUBSEQUENT REPORT OF RE-DRILLING OR REPAIR.....
NOTICE OF INTENTION TO SHOOT OR ACIDIZE.....	SUBSEQUENT REPORT OF ABANDONMENT.....
NOTICE OF INTENTION TO PULL OR ALTER CASING.....	SUPPLEMENTARY WELL HISTORY.....
NOTICE OF INTENTION TO ABANDON WELL.....	

(INDICATE ABOVE BY CHECK MARK NATURE OF REPORT, NOTICE, OR OTHER DATA)

April 1, 1952

Well No. **15** is located **350** ft. from **N** line and **2310** ft. from **E** line of sec. **10**

24/4 of 24/4 Sec. 10 **17E** **29E**
(1/4 Sec. and Sec. No.) (Twp.) (Range) (Meridian) **New Mexico**

Square Lake **144**
(Field) (County or Subdivision) (State or Territory)
The elevation of the derrick floor above sea level is _____ ft. **will furnish later**

DETAILS OF WORK

(State names of and expected depths to objective sands; show sizes, weights, and lengths of proposed casings; indicate mudding jobs, cementing points, and all other important proposed work)

We propose to drill this well to **2500'** and complete in the **Square Lake Pool**.
We propose to set a **5 1/8"** surface casing at **350'** and cement with sufficient
cement to circulate. We propose to set **5 1/2"** casing to **75'**, perforate and
oil free if necessary to stimulate production.

I understand that this plan of work must receive approval in writing by the Geological Survey before operations may be commenced.

Company **Sunray Mid-Continent Oil Company**

Address **Box 126**

Robbs, New Mexico

By **R. E. Statton**
Engineer

Title _____

NEW MEXICO OIL CONSERVATION COMMISSION
Well Location and Acreage Dedication Plat

Section A.

Date 4-1-1958

Operator Sunray Mid-Continent Oil Co. Lease M. Dodd "B"
Well No. 15 Unit Letter O Section 10 Township 17 South Range 29 East NMPM
Located 330 Feet From South Line, 2310 Feet From East Line
County Eddy G. L. Elevation 3593.1 Dedicated Acreage 40 Acres
Name of Producing Formation Metex Pool Square Lake

1. Is the Operator the only owner* in the dedicated acreage outlined on the plat below?
Yes x No .
2. If the answer to question one is "no," have the interests of all the owners been consolidated by communitization agreement or otherwise? Yes No . If answer is "yes," Type of Consolidation
3. If the answer to question two is "no," list all the owners and their respective interests below:

Owner

Land Description

Sunray Mid-Continent Oil Company

330' FSL, 2310' FEL SE/4 Section 10

Section B

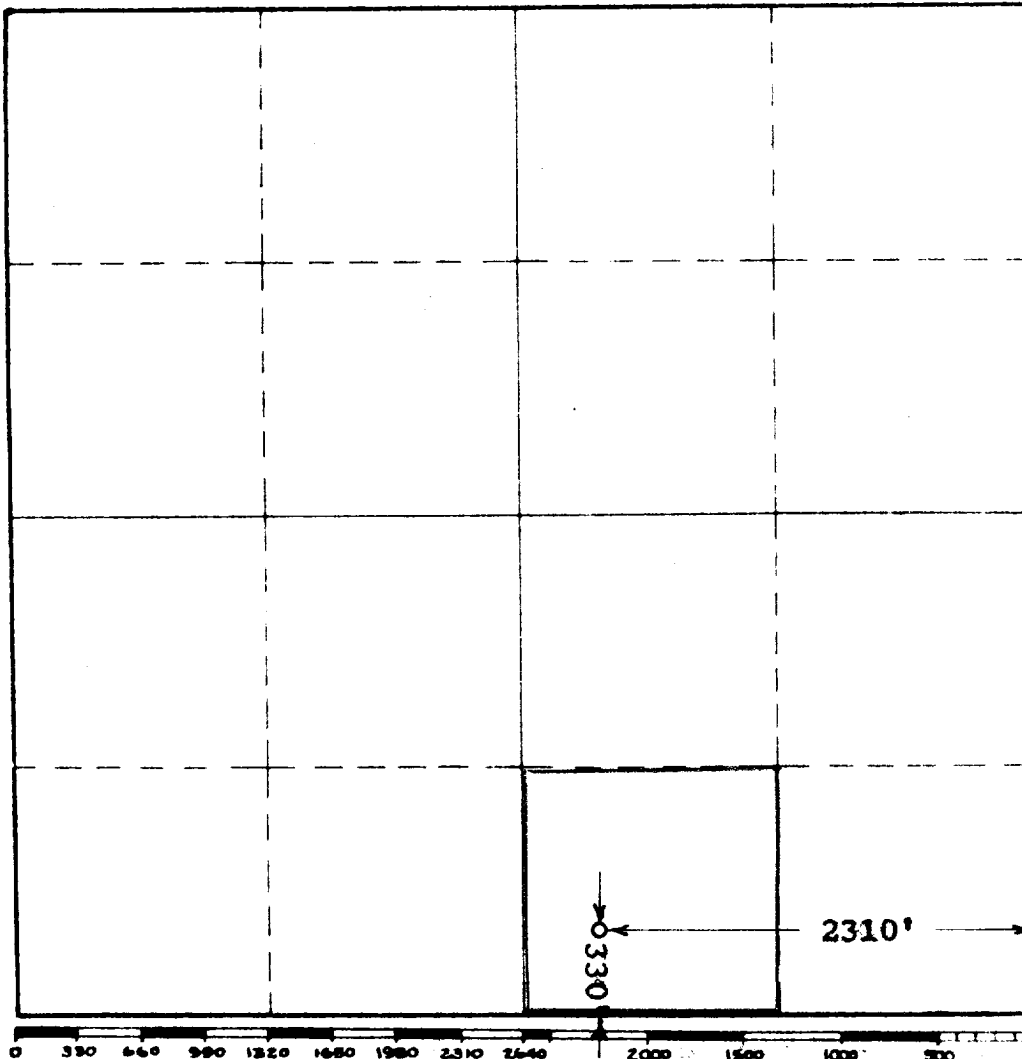

This is to certify that the information in Section A above is true and complete to the best of my knowledge and belief.

Sunray Mid-Continent Oil Co.

(Operator)

[Signature]
(Representative)

Box 128, Hobbs, New Mexico
Address

This is to certify that the well location shown on the plat in Section B was plotted from field notes of actual surveys made by me or under my supervision and that the same is true and correct to the best of my knowledge and belief.

Date Surveyed 3-31-1958

[Signature]
Registered Professional
Engineer and/or Land Surveyor

Certificate No. 676