

SUNDRY NOTICES AND REPORTS ON WELLS
(Do not use this form for proposals to drill or to deepen or plug back to a different reservoir. Use APPLICATION FOR PERMIT for such proposals.)

1. NAME OF OPERATOR
Marbob Energy Corporation

2. ADDRESS OF OPERATOR
P.O. Drawer 217, Artesia, N.M. 88210

3. LOCATION OF WELL (Report location clearly and in accordance with any State requirements. See also space 17 below.)
At surface 1960 F.W.L.
660 FNL 600 F.W.L.

4. PERMIT NO.

5. ELEVATIONS (Show whether DF, ST, GR, etc.)
3638' DF

6. LEASE DESIGNATION AND SERIAL NO.
LC-028731 (B)

7. IF INDIAN, ALLOTTEE OR TRIBE NAME

8. UNIT AGREEMENT NAME

9. FARM OR LEASE NAME
M. Dodd "B"

10. WELL NO.
6

11. FIELD AND POOL, OR WILDCAT
Grbg Jackson SR Q G SA

12. SEC., T., R., M., OR BLK. AND SURVEY OR AREA
Sec. 14-T17S-R29E

13. COUNTY OR PARISH
Eddy

14. STATE
N.M.

16. Check Appropriate Box To Indicate Nature of Notice, Report, or Other Data

NOTICE OF INTENTION TO:		SUBSEQUENT REPORT OF:	
TEST WATER SHUT-OFF	<input type="checkbox"/>	WATER SHUT-OFF	<input type="checkbox"/>
FRACTURE TREAT	<input type="checkbox"/>	FRACTURE TREATMENT	<input type="checkbox"/>
SHOOT OR ACIDIZE	<input type="checkbox"/>	SHOOTING OR ACIDIZING	<input type="checkbox"/>
REPAIR WELL	<input type="checkbox"/>	(Other)	<input type="checkbox"/>
(Other) Deepen well	<input checked="" type="checkbox"/>	(NOTE: Report results of multiple completion on Well Completion or Recompletion Report and Log form.)	

17. DESCRIBE PROPOSED OR COMPLETED OPERATIONS (Clearly state all pertinent details, and give pertinent dates, including estimated date of starting any proposed work. If well is directionally drilled, give subsurface locations and measured and true vertical depths for all markers and zones pertinent to this work.)

We propose to deepen this well from its present depth of 2513' to 3600' w/Larue Drilling Rig #2. 7" casing was run to 2296'. A 6 1/2" hole will be drilled and 4 1/2" 11.60# J-55 new casing will be run to TD and cemented. The existing well pad will be extended to 280' x 280' as shown on the attached exhibit.

18. I hereby certify that the foregoing is true and correct

SIGNED Carol J. Purcella TITLE Production Clerk DATE 2/4/85

(This space for Federal or State office use)

APPROVED BY _____ TITLE _____ DATE 2-8-85

CONDITIONS OF APPROVAL, IF ANY:

*See Instructions on Reverse Side



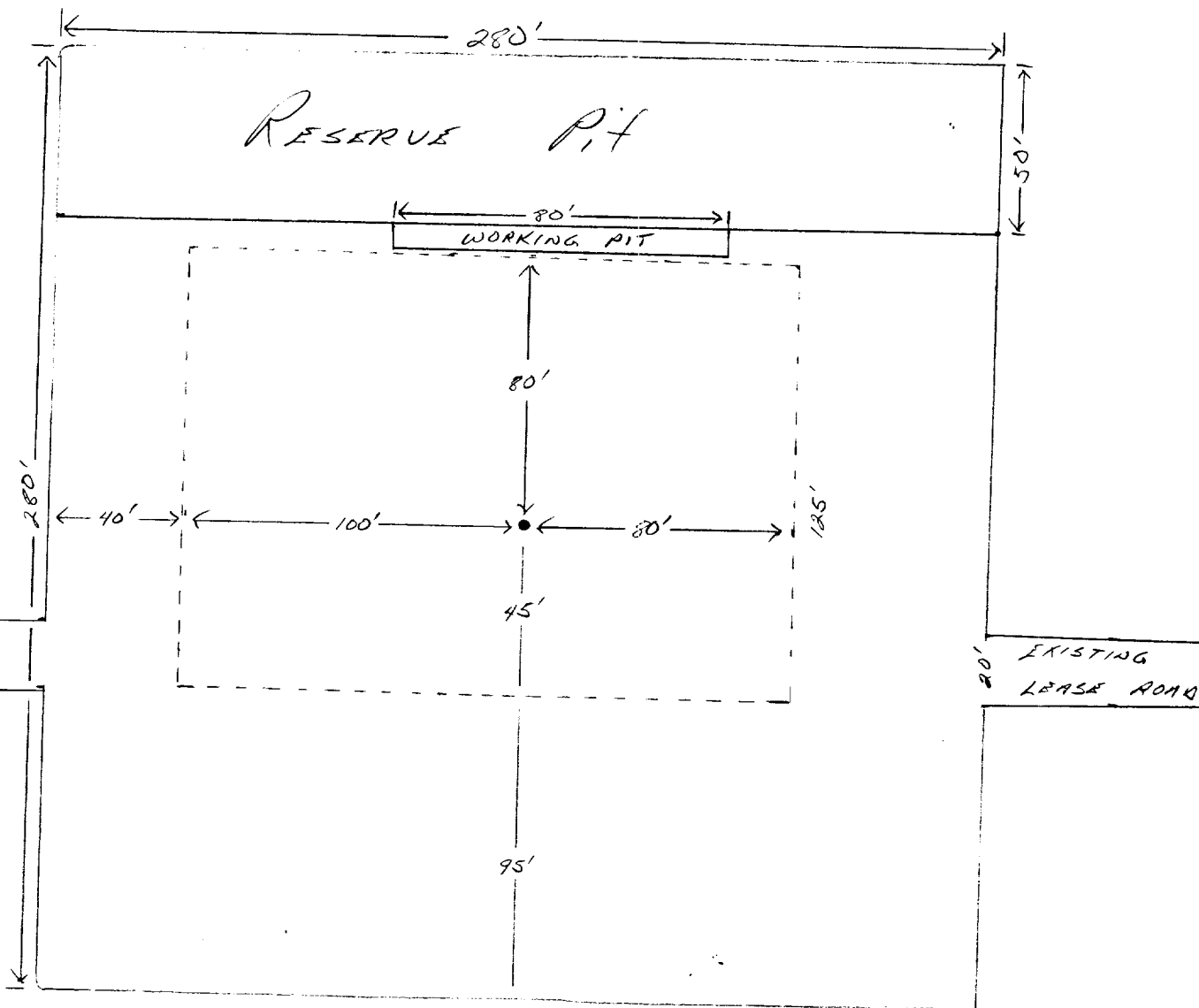

LEGEND

1cm = 20 ft.

----- Existing Pad
 _____ Proposed Pad

SUP Exhibit "D"

SKETCH OF PROPOSED WELL PAD
 AND EXISTING WELL PAD
 Marbob Energy Corporation
 Well #6 M. Dodd "B" Federal