

NOTICE OF INTENTION TO DRILL **30-015-02996**

Notice must be given to the District Office of the Oil Conservation Commission and approval obtained before drilling or recompletion begins. If changes in the proposed plan are considered advisable, a copy of this notice showing such changes will be returned to the sender. Submit this notice in **QUINTUPLICATE**. One copy will be returned following approval. See additional instructions in Rules and Regulations of the Commission. If State Land submit 6 Copies Attach Form C-128 in triplicate to first 3 copies of form C-101

Midland, Texas (Place) **June 1, 1959** (Date)

OIL CONSERVATION COMMISSION
SANTA FE, NEW MEXICO

Gentlemen:

You are hereby notified that it is our intention to commence the Drilling of a well to be known as

El Paso Natural Gas Company (Company or Operator)

Leonard State (Lease), Well No. **3**, in **3** (Unit) The well is

located **660'** feet from the **South** line and **660'** feet from the

East line of Section **16**, T. **17-S**, R. **29-E**, NMPM.

(GIVE LOCATION FROM SECTION LINE) **Undesignated** Pool, **Eddy** County

2-22-2

D	C	B	A
E	F	G	H
L	K	J	I
M	N	O	X

If State Land the Oil and Gas Lease is No. **2-10714-2**

If patented land the owner is

Address

We propose to drill well with drilling equipment as follows: **Rotary tools to 9400'**
drilling with brine water. Rotary tools to T.B. 11,000'. drilling
with gas.
The status of plugging bond is **Active**

T-17-2

Drilling Contractor **Love Drilling Co., Inc.**

P.O. Box 832

Midland, Texas

We intend to complete this well in the **Atoka (Pennsylvanian)** formation at an approximate depth of **11,000'** feet.

CASING PROGRAM

We propose to use the following strings of Casing and to cement them as indicated:

Size of Hole	Size of Casing	Weight per Foot	New or Second Hand	Depth	Sacks Cement
17-1/2"	13-3/8"	56.5#, J-55	New	750'	Circulate
9"	7-5/8"	33.7#, 26.4#, H-80	New	9,400'	400 sacks
6-1/2"	5-1/2" (linear)	20#, H-80	New	11,000'	95 sacks

If changes in the above plans become advisable we will notify you immediately.

ADDITIONAL INFORMATION (If recompletion give full details of proposed plan of work.)

JUN 3 1959

Approved _____, 19_____
Except as follows:

OIL CONSERVATION COMMISSION

By **W. L. Armstrong**

Sincerely yours,

El Paso Natural Gas Company (Company or Operator)

By **H. E. Lockett**

Position **Division Petroleum Engineer**
Send Communications regarding well to

Name **El Paso Natural Gas Company**

Address **2003 Wilco Building, Midland, Texas**

48810-210-000

OIL CONSERVATION COMMISSION	
ARTIFICIAL LIFTING OFFICE	
No. Of	
Operator	
Sales Office	
Production	
State Income	
U. S. C. S.	
Transfer	
File	

NEW MEXICO OIL CONSERVATION COMMISSION

Well Location and Acreage Dedication Plat

Section A.

Date June 1, 1959

Operator El Paso Natural Gas Company Lease Leonard State
Well No. 3 Unit Letter P Section 16 Township 17-S Range 29-E NMPM
Located 660' Feet From South Line, 660' Feet From East Line
County Eddy G. L. Elevation 3546.10 Dedicated Acreage 40 Acres
Name of Producing Formation Archie Wilcox Pool Un designated

1. Is the Operator the only owner* in the dedicated acreage outlined on the plat below?
Yes X No .
2. If the answer to question one is "no," have the interests of all the owners been consolidated by communitization agreement or otherwise? Yes No . If answer is "yes," Type of Consolidation
3. If the answer to question two is "no," list all the owners and their respective interests below:

Owner

Land Description

Section B

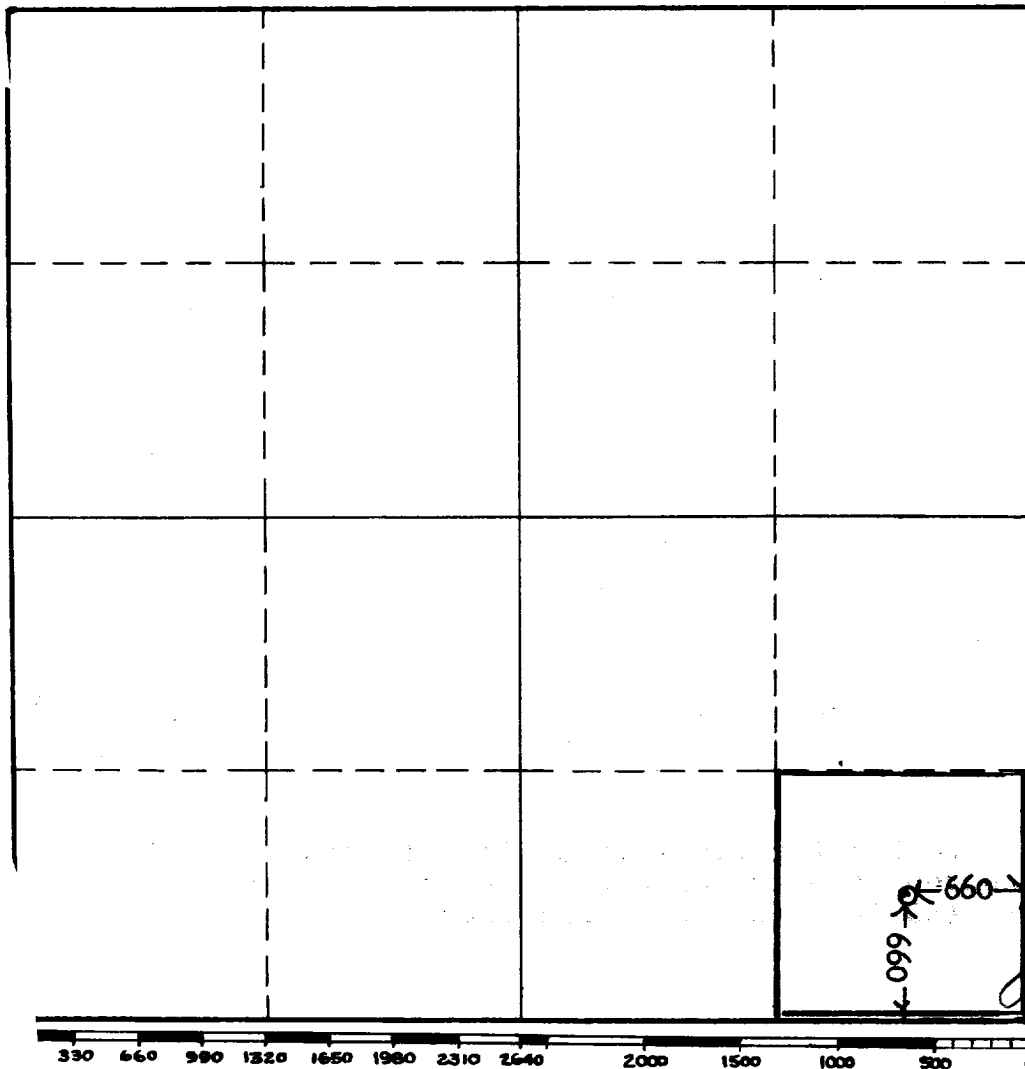

This is to certify that the information in Section A above is true and complete to the best of my knowledge and belief.

El Paso Natural Gas Company
(Operator)

D. E. Lockett
(Representative)

D. E. Lockett
2005 Wilco Bldg., Midland, Texas
Address

This is to certify that the well location shown on the plat in Section B was plotted from field notes of actual surveys made by me or under my supervision and that the same is true and correct to the best of my knowledge and belief.

Date Surveyed 5-27-59

James Douglas Aden
Registered Professional
Engineer and/or Land Surveyor.

Certificate No. 3067

INSTRUCTIONS FOR COMPLETION.

1. Operator shall furnish and certify to the information called for in Section A.
2. Operator shall outline the dedicated acreage for both oil and gas wells on the plat in Section B.
3. A registered professional engineer or land surveyor registered in the State of New Mexico or approved by the Commission shall show on the plat the location of the well and certify this information in the space provided.
4. All distances shown on the plat must be from the outer boundaries of Section.
5. If additional space is needed for listing owners and their respective interests as required in question 3, Section A, please use space below

OIL CONSERVATION COMMISSION		
REGIONAL DISTRICT OFFICE		
NO.		6
DATE		
WELL		1
STATE		1
PRODUCER		
STATUS		1
U. S. G. S.		2
Transporter		
File		✓

* "Owner" means the person who has the right to drill into and to produce from any pool and to appropriate the production either for himself or for himself and another. (65-3-29 (e) NMSA 1953 Comp.)