

NEW MEXICO  
OIL CONSERVATION COMMISSION

Form C-128

Well Location and/or Gas Proration Plat

Date June 6<sup>th</sup>, 1956

Operator Boyd-Plemers DRLG Co. Lease Continental-State

Well No. 4 Section 27 Township 17S Range 29E NMPM

Located 330 Feet From North Line, 990 Feet From West Line,

Eddy County, New Mexico. G. L. Elevation 3540

Name of Producing Formation \_\_\_\_\_ Pool \_\_\_\_\_ Dedicated Acreage \_\_\_\_\_

(Note: All distances must be from outer boundaries of Section)

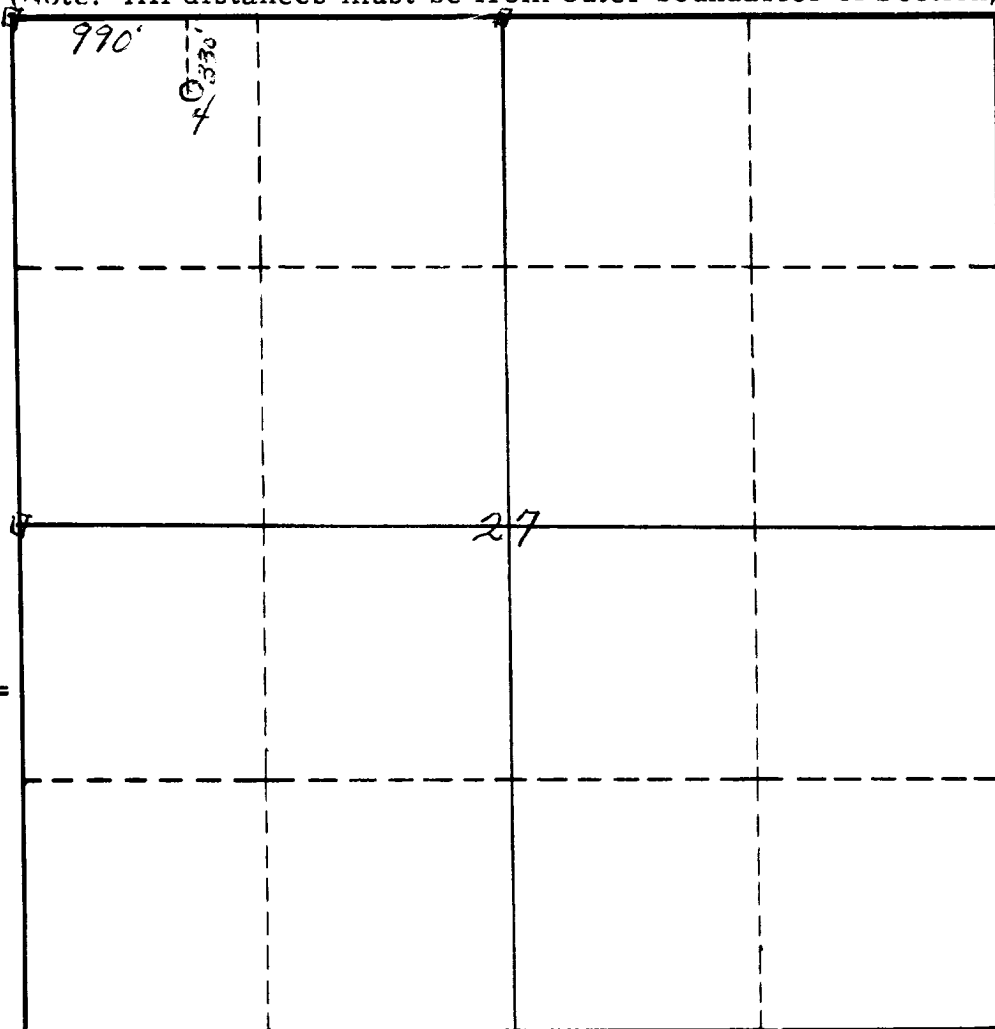

NOTE

This section of  
form is to be  
used for gas  
wells only.



SCALE: 1"=1000'

1. Is this Well a Dual Comp. ? Yes \_\_\_ No \_\_\_.
2. If the answer to Question 1 is yes, are there any other dually completed wells within the dedicated acreage ? Yes \_\_\_ No \_\_\_.

Name \_\_\_\_\_  
Position \_\_\_\_\_  
Representing \_\_\_\_\_  
Address \_\_\_\_\_

This is to certify that the above plat was prepared from field notes of actual surveys made by me or under my supervision and that the same are true and correct to the best of my knowledge and belief.

Date Surveyed June 6<sup>th</sup>, 1956  
James H. Brown NMLS #542  
Registered Professional Engineer and/or  
Land Surveyor