

Submit to Appropriate
District Office
State Lease - 6 copies
Fee Lease - 5 copies

State of New Mexico
Energy, Minerals and Natural Resources Department

Form C-101
Revised 1-1-89

01/94
BUMT
SV
OP

DISTRICT I
P.O. Box 1980, Hobbs, NM 88240

DISTRICT II
P.O. Drawer DD, Artesia, NM 88210

DISTRICT III
1000 Rio Brazos Rd., Aztec, NM 87410

OIL CONSERVATION DIVISION

P.O. Box 2088
Santa Fe, New Mexico 87504-2088

API NO. (assigned by OCD on New Wells)	
30-015-03103	
5. Indicate Type of Lease	
STATE <input checked="" type="checkbox"/>	FEE <input type="checkbox"/>
6. State Oil & Gas Lease No.	
B-10714	
7. Lease Name or Unit Agreement Name	
GJ West Coop Unit	
8. Well No.	
125	
9. Pool name or Wildcat	
Grayburg Jackson SR QN GB SA	
10. Proposed Depth	
5000'	
11. Formation	
San Andres	
12. Rotary or C.T.	
Rotary	
13. Elevations (Show whether DF, RT, GR, etc.)	
3530 GR	
14. Kind & Status Plug. Bond	
15. Drilling Contractor	
16. Approx. Date Work will start	
12-1-93	

APPLICATION FOR PERMIT TO DRILL, DEEPEN, OR PLUG BACK

1a. Type of Work:					
DRILL <input type="checkbox"/>	RE-ENTER <input checked="" type="checkbox"/>				
DEEPEN <input type="checkbox"/> PLUG BACK <input type="checkbox"/>					
b. Type of Well:					
OIL WELL <input checked="" type="checkbox"/>	GAS WELL <input type="checkbox"/>				
OTHER <input type="checkbox"/>					
2. Name of Operator					
Mack Energy Corporation					
3. Address of Operator					
P.O. Box 1359, Artesia, NM 88211-1359					
4. Well Location					
Unit Letter M : 330 Feet From The South Line and 660 Feet From The West Line					
Section 27 Township 17S Range 29E NMPM Eddy County					
10. Proposed Depth					
5000'					
11. Formation					
San Andres					
12. Rotary or C.T.					
Rotary					
13. Elevations (Show whether DF, RT, GR, etc.)					
3530 GR					
14. Kind & Status Plug. Bond					
15. Drilling Contractor					
16. Approx. Date Work will start					
12-1-93					
17. PROPOSED CASING AND CEMENT PROGRAM					
SIZE OF HOLE	SIZE OF CASING	WEIGHT PER FOOT	SETTING DEPTH	SACKS OF CEMENT	EST. TOP
12 1/4"	8 5/8"	24#	800'	235 sx	Circ.
7 7/8"	5 1/2"	17#	5000'	Sufficient to circ.	

We propose to re-enter this well, clean out to 5000' and run csg to test San Andres zone. Put well on production.

Part ID-1
2-3-95
Re-survey

Change name to GJ West Coop Unit #125. Formerly Leonard Oil Company's State B-10714 #4.

JAN 12 1995

EXP. DATE
8-1-95

IN ABOVE SPACE DESCRIBE PROPOSED PROGRAM: IF PROPOSAL IS TO DEEPEN OR PLUG BACK, GIVE DATA ON PRESENT PRODUCTIVE ZONE AND PROPOSED NEW PRODUCTIVE ZONE. GIVE BLOWOUT PREVENTER PROGRAM, IF ANY.

I hereby certify that the information above is true and complete to the best of my knowledge and belief.

SIGNATURE Crissa D. Carter TITLE Production Clerk DATE 1-1-95

TYPE OR PRINT NAME Crissa D. Carter TELEPHONE NO. 748-1288

(This space for State Use)

SUPERVISOR, DISTRICT II

FEB 1 1995

APPROVED BY _____ TITLE _____ DATE _____

CONDITIONS OF APPROVAL, IF ANY:

NUMBER OF COPIES RECEIVED	
DISTRIBUTION	
SANTA FE	
FILE	
U.S.S.	
LAND OFFICE	
TRANSPORTER	OIL GAS
PRODUCTION OFFICE	
OPERATOR	

NEW MEXICO OIL CONSERVATION COMMISSION
WELL LOCATION AND ACREAGE DEDICATION PLAT
 SEE INSTRUCTIONS FOR COMPLETING THIS FORM ON THE REVERSE SIDE

FORM C-128
 Revised 5/1/57

SECTION A

Operator Mack Energy Corporation			Lease GJ West Coop Unit		1982 No. 125
Unit Letter M	Section 27	Township 17 South	Range 29 East	County Eddy	
Actual Footage Location of Well: 330 feet from the South line and 660 feet from the West line Sec. 27					
Ground Level Elev. 3530	Producing Formation San Andres	Pool Grayburg Jackson SR QN GB SA			Dedicated Acreage: 40 Acres

1. Is the Operator the only owner in the dedicated acreage outlined on the plat below? YES ☒ NO ____ . ("Owner" means the person who has the right to drill into and to produce from any pool and to appropriate the production either for himself or for himself and another. (65-3-29 (e) NMSA 1935 Comp.)
2. If the answer to question one is "no," have the interests of all the owners been consolidated by communitization agreement or otherwise? YES ____ NO ____ . If answer is "yes," Type of Consolidation _____
3. If the answer to question two is "no," list all the owners and their respective interests below:

Owner	Land Description

SECTION B

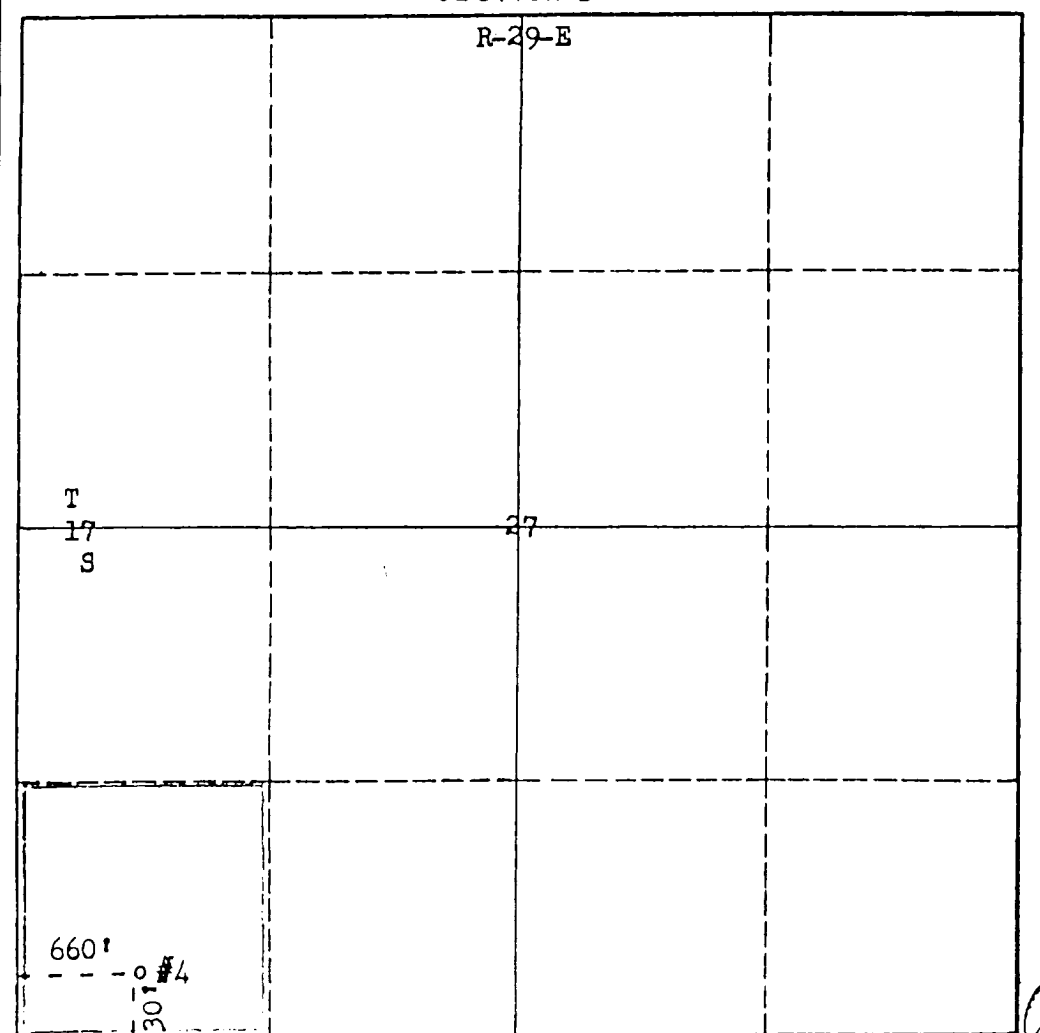

CERTIFICATION

I hereby certify that the information in SECTION A above is true and complete to the best of my knowledge and belief.

Crissa D. Carter
 Name
 Crissa D. Carter
 Position
 Production Clerk
 Company
 Mack Energy Corp.
 Date
 1-11-95

I hereby certify that the well location shown on the plat in SECTION B was plotted from field notes of actual surveys made by me or under my supervision, and that the same is true and correct to the best of my knowledge and belief.

Date Surveyed
 March 27, 1962
 Registered Professional Engineer
 and/or Land Surveyor
James H. Brown
 Certificate No. 542