



(SUBMIT IN TRIPLICATE)

UNITED STATES
DEPARTMENT OF THE INTERIOR
GEOLOGICAL SURVEYLand Office **Las Cruces**Lease No. **LC 062407**

Unit

30-015-03193

SUNDRY NOTICES AND REPORTS ON WELLS

NOTICE OF INTENTION TO DRILL	<input checked="" type="checkbox"/>	SUBSEQUENT REPORT OF WATER SHUT-OFF	
NOTICE OF INTENTION TO CHANGE PLANS		SUBSEQUENT REPORT OF SHOOTING OR ACIDIZING	
NOTICE OF INTENTION TO TEST WATER SHUT-OFF		SUBSEQUENT REPORT OF ALTERING CASING	
NOTICE OF INTENTION TO RE-DRILL OR REPAIR WELL		SUBSEQUENT REPORT OF RE-DRILLING OR REPAIR	
NOTICE OF INTENTION TO SHOOT OR ACIDIZE		SUBSEQUENT REPORT OF ABANDONMENT	
NOTICE OF INTENTION TO PULL OR ALTER CASING		SUPPLEMENTARY WELL HISTORY	
NOTICE OF INTENTION TO ABANDON WELL			

(INDICATE ABOVE BY CHECK MARK NATURE OF REPORT, NOTICE, OR OTHER DATA)

September 26, 1961

Leonard Federal

Well No. **7** is located **2150** ft. from **[S]** line and **2310** ft. from **[E]** line of sec. **35****NW/4 SE/4 Sec. 35**
(1/4 Sec. and Sec. No.)**T-17-S**
(Twp.)**R-29-E**
(Range)**NMPM**
(Meridian)**Empire Abo**
(Field)**Eddy**
(County or Subdivision)**New Mexico**
(State or Territory)The elevation of the derrick floor above sea level is **3646** ft.

DETAILS OF WORK

(State names of and expected depths to objective sands; show sizes, weights, and lengths of proposed casings; indicate mudding jobs, cementing points, and all other important proposed work)

We propose to drill, with Rotary Rig, the Leonard Federal No. 7 well as follows:

10 3/4" hole to approximately 800' -- 8 5/8" surface casing with approximately 300 sacks cement.

7 7/8" hole to approximately 6400' -- 5 1/2" production casing with approximately 425 sacks cement.

Run Gamma Ray-Neutron and Laterolog, perforate and acidize.

I understand that this plan of work must receive approval in writing by the Geological Survey before operations may be commenced.

Company **Western Development Company of Delaware**Address **P. O. Box 427****Artesia, New Mexico**By **R. W. Arenpoth**Title **Prod. Supt.**

NUMBER OF COPIES RECEIVED	
DISTRIBUTION	
SANTA FE	
FILE	
U.S.G.S.	
LAND OFFICE	
TRANSPORTER	OIL
	GAS
PRODUCTION OFFICE	
OPERATOR	

NEW MEXICO OIL CONSERVATION COMMISSION
WELL LOCATION AND ACREAGE DEDICATION PLAT
 SEE INSTRUCTIONS FOR COMPLETING THIS FORM ON THE REVERSE SIDE

FORM C-128
 Revised 5/1/57

SECTION A

Operator Western Development Company		Lease Leonard-Federal		Well No. 7
Unit Letter J	Section 30	Township 17 South	Range 29 East	County Eddy
Actual Footage Location of Well: 2310 feet from the East line and 2150 feet from the South line				
Ground Level Elev. 3646	Producing Formation Abo	Pool Empire Abo	Dedicated Acreage: 40 Acres	

1. Is the Operator the only owner in the dedicated acreage outlined on the plat below? YES _____ NO _____. ("Owner" means the person who has the right to drill into and to produce from any pool and to appropriate the production either for himself or for himself and another. (65-3-29 (e) NMSA 1935 Comp.)
2. If the answer to question one is "no," have the interests of all the owners been consolidated by communitization agreement or otherwise? YES _____ NO _____. If answer is "yes," Type of Consolidation _____
3. If the answer to question two is "no," list all the owners and their respective interests below:

Owner	Land Description
	SEP 27 1961

SECTION B

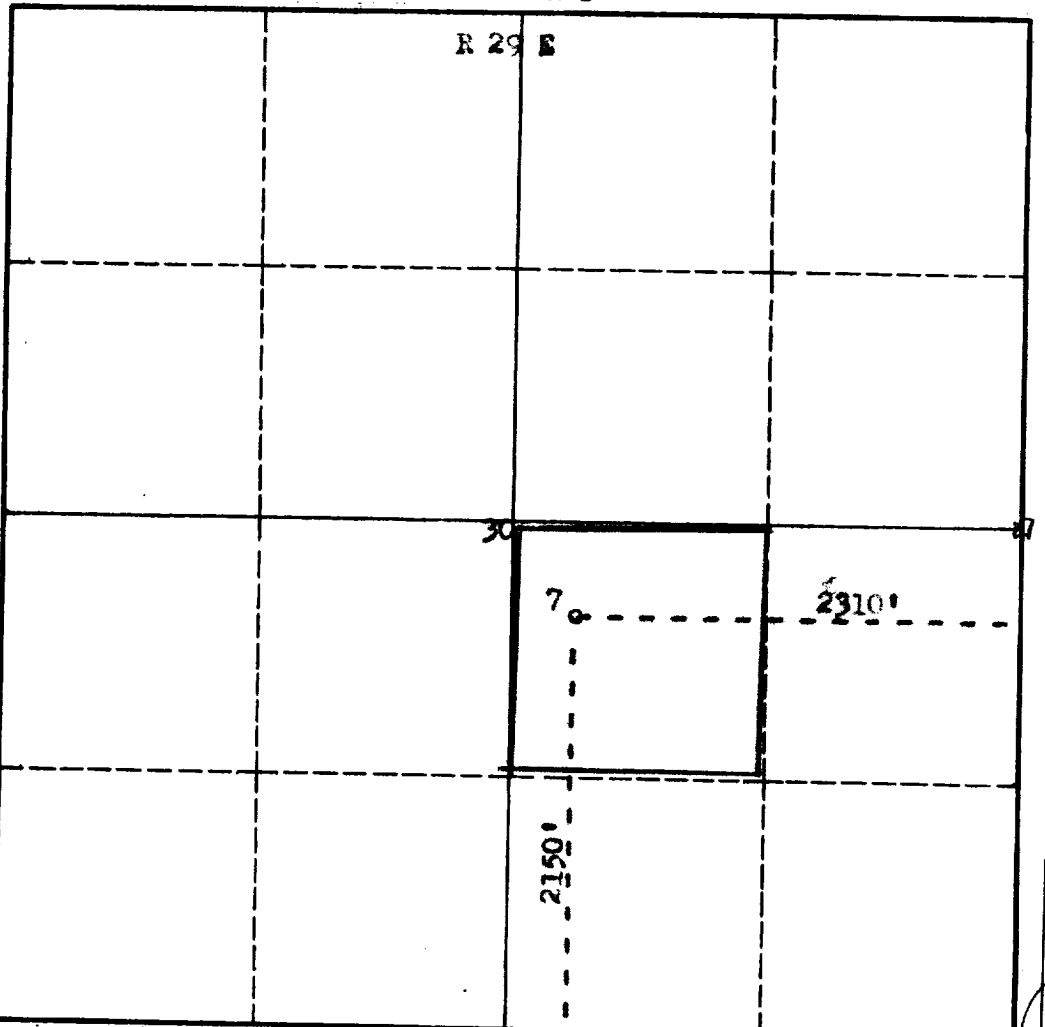

CERTIFICATION

I hereby certify that the information in SECTION A above is true and complete to the best of my knowledge and belief.

Name P. H. Durenpoth
Position Prod. Supt.
Company Western Dev. Co. of Del.
Date September 26, 1961

I hereby certify that the well location shown on the plat in SECTION B was plotted from field notes of actual surveys made by me or under my supervision, and that the same is true and correct to the best of my knowledge and belief.

Date Surveyed September 26, 1961
Registered Professional Engineer and/or Land Surveyor James H. Brown
Certificate No. N.M.L.S. No. 542

0 330 660 990 1320 1650 1980 2310 2640 2000 1500 1000 500

INSTRUCTIONS FOR COMPLETION OF FORM C-128

1. Operator shall furnish and certify to the information called for in Section A.
2. Operator shall outline the dedicated acreage for *both* oil and gas wells on the plat in Section B.
3. A registered professional engineer or land surveyor registered in the State of New Mexico or approved by the Commission shall show on the plat the location of the well and certify this information in the space provided.
4. All distances shown on the plat must be from the outer boundaries of the Section.
5. If additional space is needed for listing owners and their respective interests as required in question 3 of Section A, please use space below.