

NEW MEXICO OIL CONSERVATION COMMISSION
Santa Fe, New Mexico

Form O-101
Revised (12/1/55)

NOTICE OF INTENTION TO DRILL

APR 2 1958

Notice must be given to the District Office of the Oil Conservation Commission and approval obtained before drilling or recompletion begins. If changes in the proposed plan are considered advisable, a copy of this notice showing such changes will be returned to the sender. Submit this notice in QUINTUPLICATE. One copy will be returned following approval. See additional instructions in Rules and Regulations of the Commission. If State Land submit 6 Copies Attach Form C-128 in triplicate to first 3 copies of form C-101

Artesia, New Mexico
(Place)

March 31, 1958
(Date)

OIL CONSERVATION COMMISSION
SANTA FE, NEW MEXICO

Gentlemen:

You are hereby notified that it is our intention to commence the Drilling of a well to be known as

Kincaid & Watson

(Company or Operator)

Durham State
(Lease)

Well No. 1, in B The well is

located 990 feet from the North line and 1980 feet from the

East line of Section 32, T. 17S, R. 29E, NMPM.

(GIVE LOCATION FROM SECTION LINE) Grayburg-Jackson Pool, Eddy County

If State Land the Oil and Gas Lease is No. O. G. 181

If patented land the owner is

Address

We propose to drill well with drilling equipment as follows:

Cable Tools

The status of plugging bond is Kincaid & Watson Drilling

Company blanket bond

Drilling Contractor

Kincaid & Watson Drilling Co.

We intend to complete this well in the Premier

formation at an approximate depth of 2700 feet.

CASING PROGRAM

We propose to use the following strings of Casing and to cement them as indicated:

Size of Hole	Size of Casing	Weight per Foot	New or Second Hand	Depth	Sacks Cement
11"	8 5/8"	24 #	S. H.	400	50
8"	5 1/2"	14 #	New	2500	100

If changes in the above plans become advisable we will notify you immediately.

ADDITIONAL INFORMATION (If recompletion give full details of proposed plan of work.)

APR 2 1958

Approved, 19
Except as follows:

OIL CONSERVATION COMMISSION

By M. L. Armstrong

Sincerely yours,

Kincaid & Watson
(Company or Operator)

By R. H. Holmes

Position Agent

Send Communications regarding well to

Name Kincaid & Watson

Address Box 536, Artesia, New Mexico

OIL CONSERVATION COMMISSION	
ARTESIA DISTRICT OFFICE	
No. Copies Produced	
DISTRIBUTION	
Operator	
Santa Fe	
Proration Office	
State Land Office	
U. S. G. S.	
U. S. G. S.	

NEW MEXICO OIL CONSERVATION COMMISSION

Well Location and Acreage Dedication Plat

Section A.

Date March 31, 1958

Operator Kincaid & Watson Lease Dupham State
Well No. 1 Unit Letter B Section 32 Township 17S Range 29E NMPM
Located 990 Feet From North Line, 1980 Feet From East Line
County Eddy G. L. Elevation _____ Dedicated Acreage 40 Acres
Name of Producing Formation Premier Pool Grayburg Jackson

1. Is the Operator the only owner* in the dedicated acreage outlined on the plat below?
Yes x No _____.
2. If the answer to question one is "no," have the interests of all the owners been consolidated by communitization agreement or otherwise? Yes _____ No _____. If answer is "yes," Type of Consolidation _____
3. If the answer to question two is "no," list all the owners and their respective interests below:

Owner

Land Description

Section B

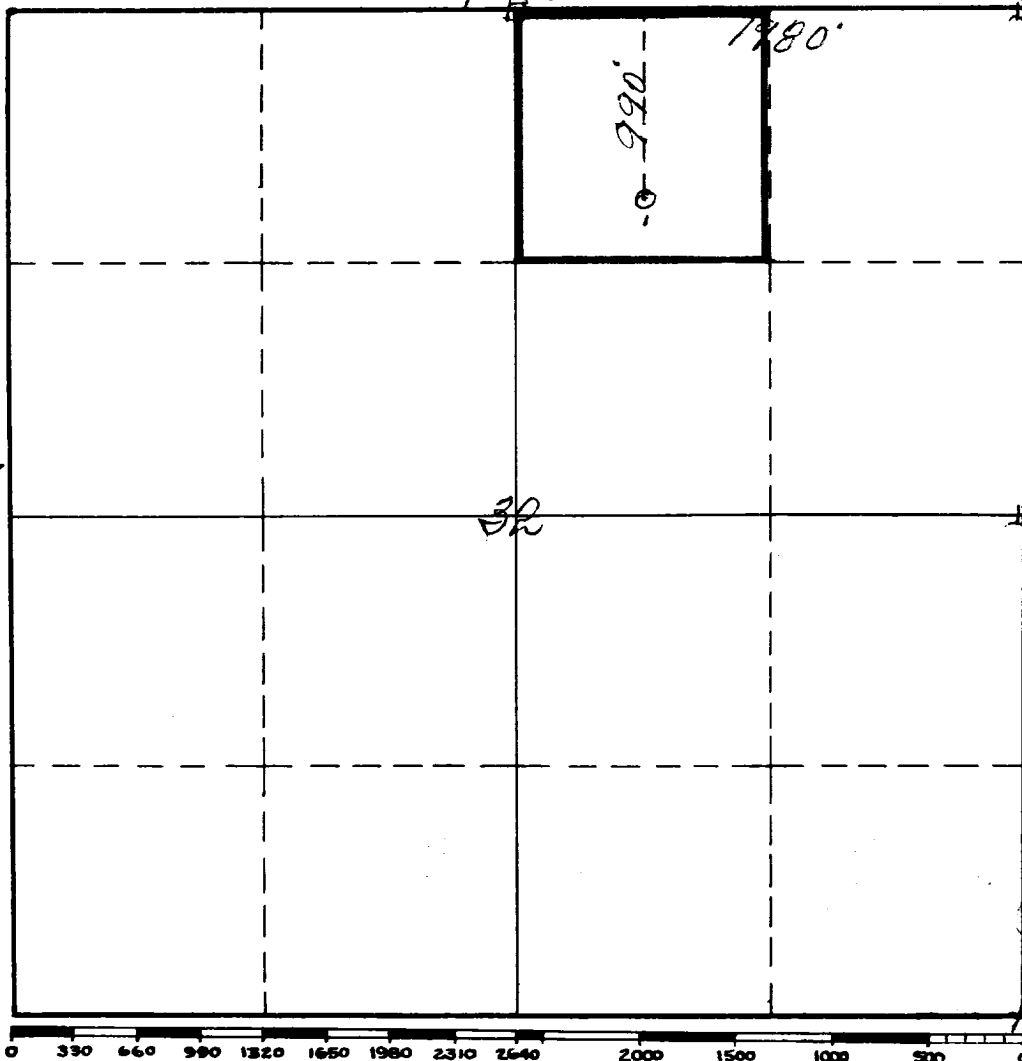

This is to certify that the information in Section A above is true and complete to the best of my knowledge and belief.

Kincaid & Watson
(Operator)

Gray Holmes Agent
(Representative)

Box 536, Artesia, N. Mex.
Address

This is to certify that the well location shown on the plat in Section B was plotted from field notes of actual surveys made by me or under my supervision and that the same is true and correct to the best of my knowledge and belief.

Date Surveyed March 28, 1958

James H. Brown
Registered Professional
Engineer and/or Land Surveyor.

Certificate No. 542

INSTRUCTIONS FOR COMPLETION

1. Operator shall furnish and certify to the information called for in Section A.
2. Operator shall outline the dedicated acreage for both oil and gas wells on the plat in Section B.
3. A registered professional engineer or land surveyor registered in the State of New Mexico or approved by the Commission shall show on the plat the location of the well and certify this information in the space provided.
4. All distances shown on the plat must be from the outer boundaries of Section.
5. If additional space is needed for listing owners and their respective interests as required in question 3, Section A, please use space below

OIL CONSERVATION COMMISSION	
ARTESIA DISTRICT OFFICE	
No. Copies Received	6
RECEIVED	
JUN 10 1953	
Operator	
Santa Fe	
Fracturing	
State of New Mexico	2
1953	

* "Owner" means the person who has the right to drill into and to produce from any pool and to appropriate the production either for himself or for himself and another. (65-3-29 (e) NMSA 1953 Comp.)