

(SUBMIT IN TRIPLICATE)

UNITED STATES
DEPARTMENT OF THE INTERIOR
GEOLOGICAL SURVEY

Land Office **Las Cruces**
Lease No. **L. C. 062407**
Unit _____

SUNDRY NOTICES AND REPORTS ON WELLS

NOTICE OF INTENTION TO DRILL.....	XX	SUBSEQUENT REPORT OF WATER SHUT-OFF.....	
NOTICE OF INTENTION TO CHANGE PLANS.....		SUBSEQUENT REPORT OF SHOOTING OR ACIDIZING.....	
NOTICE OF INTENTION TO TEST WATER SHUT-OFF.....		SUBSEQUENT REPORT OF ALTERING CASING.....	
NOTICE OF INTENTION TO RE-DRILL OR REPAIR WELL.....		SUBSEQUENT REPORT OF RE-DRILLING OR REPAIR.....	
NOTICE OF INTENTION TO SHOOT OR ACIDIZE.....		SUBSEQUENT REPORT OF ABANDONMENT.....	
NOTICE OF INTENTION TO PULL OR ALTER CASING.....		SUPPLEMENTARY WELL HISTORY.....	
NOTICE OF INTENTION TO ABANDON WELL.....			

(INDICATE ABOVE BY CHECK MARK NATURE OF REPORT, NOTICE, OR OTHER DATA)

January 12, 19 59

Leonard Federal
Well No. **6** is located **1980** ft. from **MY** line and **1790** ft. from **W** line of sec. **33**
NE/4 SW/4 Sec. 33 17 S 29 E NMPH
(1/4 Sec. and Sec. No.) (Twp.) (Range) (Meridian)
Grayburg - Jackson Eddy New Mexico
(Field) (County or Subdivision) (State or Territory)

The elevation of the derrick floor above sea level is _____ ft. **will report later.**

DETAILS OF WORK

(State names of and expected depths to objective sands; show sizes, weights, and lengths of proposed casings; indicate mudding jobs, cementing points, and all other important proposed work)

Drill with cable tools to approximately 3100feet.

Run 8 5/8" 28# SH surface csg. to total depth drilled and cement with 125 sacks, run Gamma-ray Neutron log, perforate and sand-oil frac indicated producing zones.

I understand that this plan of work must receive approval in writing by the Geological Survey before operations may be commenced.

Company **Western Development Company of Delaware**

Address **P. O. Box 427**

Artesia, New Mexico

By *[Signature]*

Title **Dist. Supt.**

APPROVED

JAN 12 1959

NEW MEXICO OIL CONSERVATION COMMISSION

Well Location and Acreage Dedication Plat

Section A ROBERT C. FLORES
ANG DISTRICT ENGINEER

Date January 12, 1959

Operator Western Development Co. of Del. Leonard Federal - L. C. 062407
Well No. 6 Unit Letter K Section 33 Township 17 S Range 29 E NMPM
Located 1980 Feet From South Line, 1790 Feet From West Line
County Eddy G. L. Elevation _____ Dedicated Acreage 40 Acres
Name of Producing Formation Grayburg San Andres Pool Grayburg Jackson

1. Is the Operator the only owner* in the dedicated acreage outlined on the plat below?
Yes xxx No _____.
2. If the answer to question one is "no," have the interests of all the owners been consolidated by communitization agreement or otherwise? Yes _____ No _____. If answer is "yes," Type of Consolidation _____
3. If the answer to question two is "no," list all the owners and their respective interests below:

Owner

Land Description

Section B

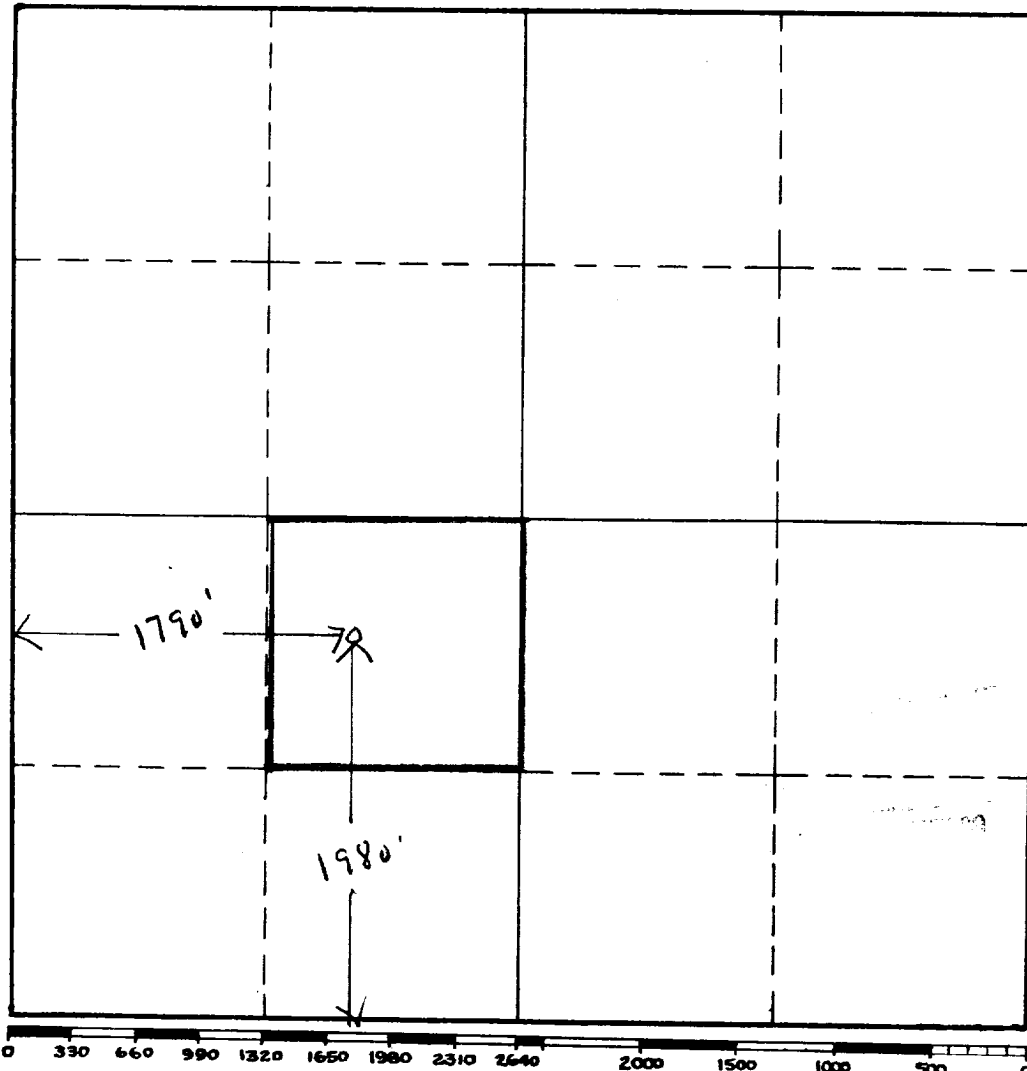

This is to certify that the information in Section A above is true and complete to the best of my knowledge and belief.

Western Development Co.
(Operator) OF Del.

R. A. L. Langer
(Representative)

Dist. Supt.

Address _____

This is to certify that the well location shown on the plat in Section B was plotted from field notes of actual surveys made by me or under my supervision and that the same is true and correct to the best of my knowledge and belief.

Date Surveyed 12-20-58

W. Bonar
Registered Professional
Engineer and/or Land Surveyor.

926

Certificate No. _____
(See instructions for completing this form on the reverse side)

INSTRUCTIONS FOR COMPLETION:

1. Operator shall furnish and certify to the information called for in Section A.
2. Operator shall outline the dedicated acreage for both oil and gas wells on the plat in Section B.
3. A registered professional engineer or land surveyor registered in the State of New Mexico or approved by the Commission shall show on the plat the location of the well and certify this information in the space provided.
4. All distances shown on the plat must be from the outer boundaries of Section.
5. If additional space is needed for listing owners and their respective interests as required in question 3, Section A, please use space below

* "Owner" means the person who has the right to drill into and to produce from any pool and to appropriate the production either for himself or for himself and another. (65-3-29 (e) NMSA 1953 Comp.)