

NEW MEXICO OIL CONSERVATION COMMISSION
Santa Fe, New Mexico

Form C-101
Revised (12/1/55)

SEP 7 1959

NOTICE OF INTENTION TO DRILL

Notice must be given to the District Office of the Oil Conservation Commission and approval obtained before drilling or recompletion begins. If changes in the proposed plan are considered advisable, a copy of this notice showing such changes will be returned to the sender. Submit this notice in QUINTUPPLICATE. One copy will be returned following approval. See additional instructions in Rules and Regulations of the Commission. If State Land submit 6 Copies Attach Form C- 128 in triplicate to first 3 copies of form C-101

Artesia, New Mexico
(Place)

August 15, 1959
(Date)

OIL CONSERVATION COMMISSION
SANTA FE, NEW MEXICO

Gentlemen:

You are hereby notified that it is our intention to commence the Drilling of a well to be known as

C. L. East

(Company or Operator)

Continental State
(Lease)

Well No. 1, in P The well is
(Unit)

located 990 feet from the South line and 990 feet from the East line of Section 33, T. 17S, R. 29E, NMPM.

(GIVE LOCATION FROM SECTION LINE)

Grayburg-Jackson Pool, Eddy County

If State Land the Oil and Gas Lease is No. E4201

If patented land the owner is

Address

We propose to drill well with drilling equipment as follows:

Ft. Worth Spudder-Cable Tools

The status of plugging bond is Bond on File

Drilling Contractor C. L. East

We intend to complete this well in the San Andres formation at an approximate depth of 3200 feet.

CASING PROGRAM

We propose to use the following strings of Casing and to cement them as indicated:

Size of Hole	Size of Casing	Weight per Foot	New or Second Hand	Depth	Sacks Cement
10 inch	8 inch	app. 24 lb.	2nd Hand	To top of salt	as required
8 inch	5 1/2 inch	" 13 lb.	New	App 3200'	50 sks. or
					required amt.

If changes in the above plans become advisable we will notify you immediately.

ADDITIONAL INFORMATION (If recompletion give full details of proposed plan of work.)

Approved SEP 23 1959, 19
Except as follows:

Sincerely yours,

C. L. East

(Company or Operator)

By

Position Agent

Send Communications regarding well to

Name R. F. McQuay

Address 120 So. Roselawn, Artesia, N. M.

OIL CONSERVATION COMMISSION

By

OIL AND GAS INDUSTRIES

NEW MEXICO OIL CONSERVATION COMMISSION
Well Location and Acreage Dedication Plat

Form C-128
Revised 5/1/57

SEP 4 1959

Section A.

Date August 18, 1959

Operator C.L. East Lease Continental State
Well No. 1 Unit Letter P Section 33 Township 17 South Range 29 East NMPM
Located 990 Feet From South Line, 990 Feet From East Line
County Eddy G. L. Elevation 3534 Dedicated Acreage 40 Acres
Name of Producing Formation Grayburg Pool Grayburg - Jackson

1. Is the Operator the only owner in the dedicated acreage outlined on the plat below?
Yes X No .
2. If the answer to question one is "no," have the interests of all the owners been consolidated by communitization agreement or otherwise? Yes No . If answer is "yes," Type of Consolidation
3. If the answer to question two is "no," list all the owners and their respective interests below:

Owner

Land Description

Section B

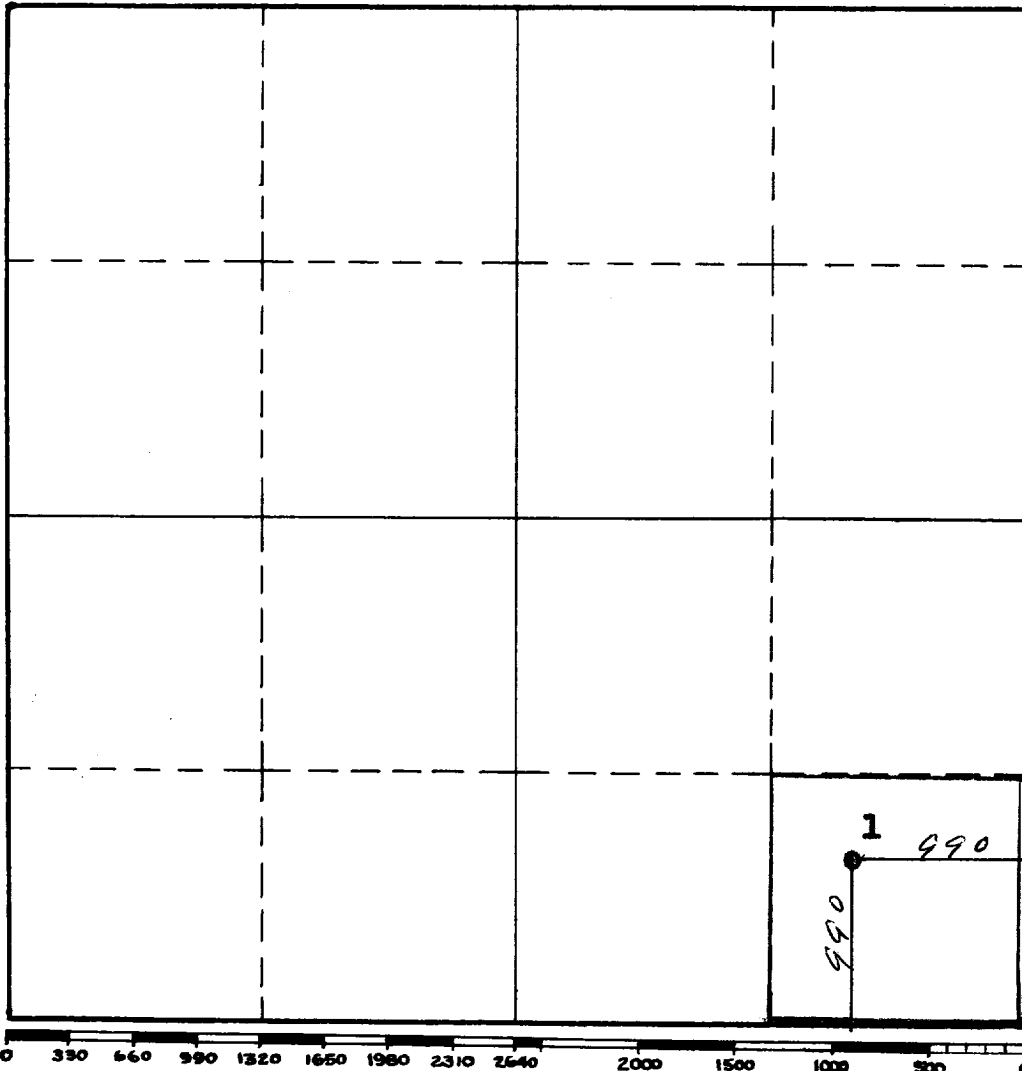

This is to certify that the information in Section A above is true and complete to the best of my knowledge and belief.

C.L. East

(Operator)

R.F. McQuay
(Representative)

Arturo N.M.

Address

This is to certify that the well location shown on the plat in Section B was plotted from field notes of actual surveys made by me or under my supervision and that the same is true and correct to the best of my knowledge and belief.

Date Surveyed 8/18/59

John A. Matlock
Registered Professional
Engineer and/or Land Surveyor.

Certificate No. 1502

(See instructions for completing this form on the reverse side)

INSTRUCTIONS FOR COMPLETION

1. Operator shall furnish and certify to the information called for in Section A.
2. Operator shall outline the dedicated acreage for both oil and gas wells on the plat in Section B.
3. A registered professional engineer or land surveyor registered in the State of New Mexico or approved by the Commission shall show on the plat the location of the well and certify this information in the space provided.
4. All distances shown on the plat must be from the outer boundaries of Section.
5. If additional space is needed for listing owners and their respective interests as required in question 3, Section A, please use space below

Form with grid lines and faint text, likely a section for listing owners and their interests as mentioned in instruction 5.

* "Owner" means the person who has the right to drill into and to produce from any pool and to appropriate the production either for himself or for himself and another. (65-3-29 (e) NMSA 1953 Comp.)