

NEW MEXICO OIL CONSERVATION COMMISSION  
Santa Fe, New Mexico

## NOTICE OF INTENTION TO DRILL OR RECOMPLETE

Notice must be given to the District Office of the Oil Conservation Commission and approval obtained before drilling or recompletion begins. If changes in the proposed plan are considered advisable, a copy of this notice showing such changes will be returned to the sender. Submit this notice in **QUINTUPPLICATE**. One copy will be returned following approval. See additional instructions in Rules and Regulations of the Commission.

Loco Hills, New Mexico  
(Place)September 15, 1961  
(Date)OIL CONSERVATION COMMISSION  
SANTA FE, NEW MEXICO

Gentlemen:

You are hereby notified that it is our intention to commence the (Drilling) (~~Recompletion~~) of a well to be known asGeneral American Oil Company of Texas  
(Company or Operator)State B-1778  
(Lease)Well No. 2in P  
(Unit)

The well is

located 1295 feet from the South line and 990 feet from theEast line of Section 36, T. 17-S, R. 29-E, NMPM.(GIVE LOCATION FROM SECTION LINE) Loco Hills Pool, Eddy CountyIf State Land the Oil and Gas Lease is No. B-1778

If patented land the owner is

Address

We propose to drill well with drilling equipment as follows:

Cable Tools to total depth.The status of plugging bond is \$10,000 Blanket bond on file.Drilling Contractor Needham Drilling CompanyWe intend to complete this well in the Loco Hills Sand (Grayburg) formation at an approximate depth of 2760 feet.

## CASING PROGRAM

We propose to use the following strings of Casing and to cement them as indicated:

Size of Hole	Size of Casing	Weight per Foot	New or Second Hand	Depth	Sacks Cement
<u>12 1/2"</u>	<u>10 3/4"</u>	<u>32#</u>	<u>Second Hand</u>	<u>400</u>	<u>Set &amp; Pulled</u>
<u>10" &amp; 8"</u>	<u>5 1/2"</u>	<u>14#</u>	<u>New</u>	<u>2730</u>	<u>To Surface</u>

If changes in the above plans become advisable we will notify you immediately.

ADDITIONAL INFORMATION (If recompletion give full details of proposed plan of work.)

**This unorthodox location was approved by N.M.O.C.C., Order No. R-2031 as an injection well.**

OCT 9 1961

Approved....., 19.....  
Except as follows:

OIL CONSERVATION COMMISSION

By M. L. Armstrong  
OIL AND GAS INSPECTOR  
Title .....

Sincerely yours,

General American Oil Company of Texas  
(Company or Operator)By R. J. HeardPosition District Superintendent  
Send Communications regarding well toName R. J. HeardAddress P. O. Box 416Loco Hills, New Mexico

**NEW MEXICO OIL CONSERVATION COMMISSION**  
**WELL LOCATION AND ACREAGE DEDICATION PLAT**

FORM C-128  
 Revised 5/1/57

SEE INSTRUCTIONS FOR COMPLETING THIS FORM ON THE REVERSE SIDE

**SECTION A**

Operator <b>General American Oil Co. of Texas</b>					Lease <b>State "B" 1778</b>	
Unit Location <b>P 1</b>	Section <b>36</b>	Township <b>17 South</b>	Range <b>29 East</b>	County <b>Bddy</b>		
Actual Footage Location of Well: <b>1295</b> feet from the <b>South</b> line and <b>990</b> feet from the <b>East</b> line						
Ground Level Elev. <b>3561.0</b>	Producing Formation <b>Loco Hills Sand</b>		Pool <b>Loco Hills</b>	Dedicated Acreage: Acres		

1. Is the Operator the only owner in the dedicated acreage outlined on the plat below? YES \_\_\_\_\_ NO \_\_\_\_\_. ("Owner" means the person who has the right to drill into and to produce from any pool and to appropriate the production either for himself or for himself and another. (63-3-29 (e) NMSA 1935 Comp.)
2. If the answer to question one is "no," have the interests of all the owners been consolidated by communication agreement or otherwise? YES \_\_\_\_\_ NO \_\_\_\_\_. If answer is "yes," Type of Consolidation \_\_\_\_\_
3. If the answer to question two is "no," list all the owners and their respective interests below:

Owner	Land Description

**SECTION B**

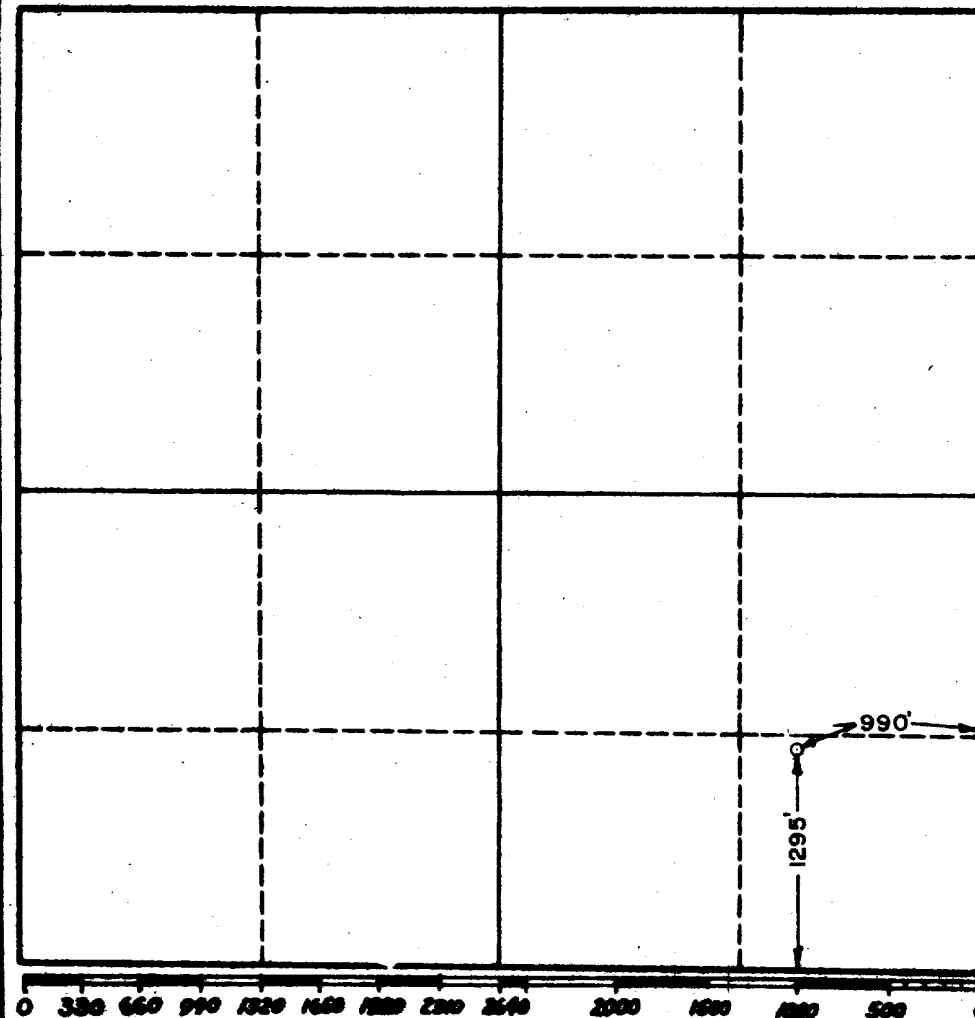

**CERTIFICATION**

I hereby certify that the information in SECTION A above is true and complete to the best of my knowledge and belief.

Name **R. A. Howard**  
 Position **Dist. Supt.**  
 Company **General American Oil Co. of Texas**  
 Date **9-18-61**

I hereby certify that the well location shown on the plat in SECTION B was plotted from field notes of actual surveys made by me or under my supervision, and that the same is true and correct to the best of my knowledge and belief.

Date Surveyed **Sept. 12, 1961**  
 Registered Professional Engineer and/or Land Surveyor **JOHN W. BOST**  
 State of **NEW MEXICO**  
 License No. **1000**  
 N. M. S. E. L. S. No. **576**

OIL CONSERVATION COMMISSION		
ARTESIA DISTRICT OFFICE		
No. Copies Received		7
DISTRIBUTION		
	NO COPIES	
ARTESIA	2	
ARTESIA	1	
ARTESIA DISTRICT OFFICE		
STATE LAND OFFICE	1	
U. S. G. E.	2	
TRANSFERRER		
FILE	1	
BUREAU OF MINES		

30r 015-03885