

NEW MEXICO
OIL CONSERVATION COMMISSION

Form C-128

Well Location and/or Gas Proration Plat

Date November 7, 1956

Operator Nash, Windfohr, & Brown Lease Jackson "B"

Well No. 18 Section 1 Township 17S Range 30E NMPM

Located 1980 Feet From South Line, 660 Feet From East Line,

Eddy County, New Mexico. G. L. Elevation _____

Name of Producing Formation Grayburg Pool Sq. Lake Dedicated Acreage 40

(Note: All distances must be from outer boundaries of Section)

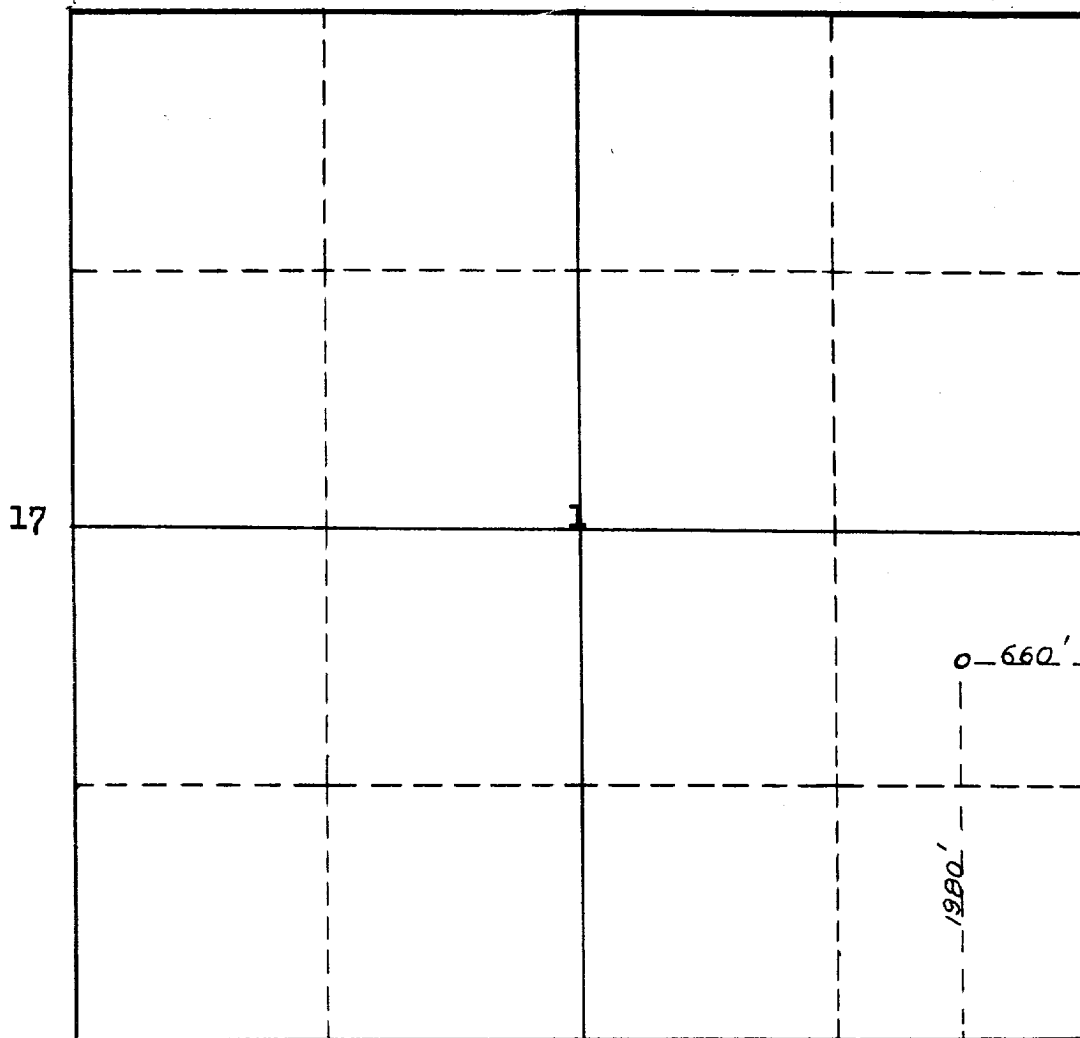

SCALE: 1"=1000'

1. Is this Well a Dual Comp. ? Yes ___ No ___
2. If the answer to Question 1 is yes, are there any other dually completed wells within the dedicated acreage? Yes ___ No X .

This is to certify that the above plat was prepared from field notes of actual surveys made by me or under my supervision and that the same are true and correct to the best of my knowledge and belief.

Name [Signature]
Position Partner
Representing Nash, Windfohr and Brown
Address 1107 Continental Life Building

Date Surveyed November 6, 1956
[Signature]
Registered Professional Engineer and/or
Land Surveyor

Fort Worth, Texas

