

UNITED STATES
DEPARTMENT OF THE INTERIOR
BUREAU OF LAND MANAGEMENT

SUNDRY NOTICES AND REPORT ON WELLS

Do not use this form for proposals to drill or to deepen or reentry to a different reservoir.
Use "APPLICATION FOR PERMIT-" for such proposals

SUBMIT IN TRIPLICATE

1. Type of Well
☐ Oil Well ☐ Gas Well ☒ Other Saltwater disposal line

2. Name of Operator
Burnett Oil Co., Inc.

3. Address and Telephone No.
801 Cherry Street, Suite 1500, Fort Worth, TX 76102 817/332-5108

4. Location of Well (Footage, Sec., T., R., M., or Survey Description)
Unit J. 1440' FSL, 1650' FEL, Sec. 14, T17S, R30E-TANK BATTERY
Unit B. 330' FNL, 1880' FEL, Sec. 23, T17S, R30E - WELL

FORM APPROVED

Budget Bureau No. 1004-0135

Expires: March 31, 1993

5. Lease Designation and Serial No.
LC 029338A

6. If Indian, Allottee or Tribe Name

7. If Unit or CA., Agreement Designation

8. Well Name and No.

Gissler A #2 T/B (Gissler A # 8

9. API Well No.

10. Field and Pool, or Exploratory Area
Grayburg-Jackson

11. County or Parish, State

Eddy County, New Mexico

12. CHECK APPROPRIATE BOX(s) TO INDICATE NATURE OF NOTICE, REPORT, OR OTHER DATA

TYPE OF SUBMISSION

TYPE OF ACTION

☒ Notice of Intent

☐ Subsequent Report

☐ Final Abandonment Notice

☐ Abandonment

☐ Recompletion

☐ Plugging Back

☐ Casing Repair

☐ Altering Casing

☒ Other SALTWATER DISPOSAL LINE

☐ Change of Plans

☒ New Construction

☐ Non-Routine Fracturing

☐ Water Shut-Off

☐ Conversion to Injection

☐ Dispose Water

(Note: Report results of multiple completion on Well
Completion or Recompletion Report and Log form)

13. Describe Proposed or Completed Operations (Clearly state all pertinent details, and give pertinent dates, including estimated date of starting any proposed work. If well is directionally drilled, give subsurface locations and measured and true vertical depths for all markers and zones pertinent to this work.)*

This new Gissler A #2 tank battery was installed to handle all production from the Gissler A #8 well as well as some future Gissler A lease completions. We now propose to lay an approx. 2250' saltwater disposal line from this battery to move this produced water to the approved GJSAU water plant in section 13. We plan to connect this new line to an existing line located south & west of the Stevens A #6 well located in section 13. Approximately 1425' of this line from the Gissler A #2 battery will share the ditch with the flowline from the Gissler A #4 well in section 14. An archaeological review of the proposed route of this line was completed by Pecos Archaeological Consultants on their report #97017 dated 14 Feb 97 and mailed to your office. A copy of this report and the plats for the proposed route are attached for your easy reference.

A copy of this report and filing is also being filed with NMOCD for approval of the produced water handling method.

14. I hereby certify that the foregoing is true and correct

Signed

Title

Petroleum Engineer

Date

(This space for Federal or State Office Use)

Approved by

Title

Date

Conditions of approval, if any:

Title 18 U.S.C. Section 1001, makes it a crime for any person knowingly and willfully to make to any department or agency of the United States any False, Fictitious or fraudulent statements or representations as to any matter within its jurisdiction.

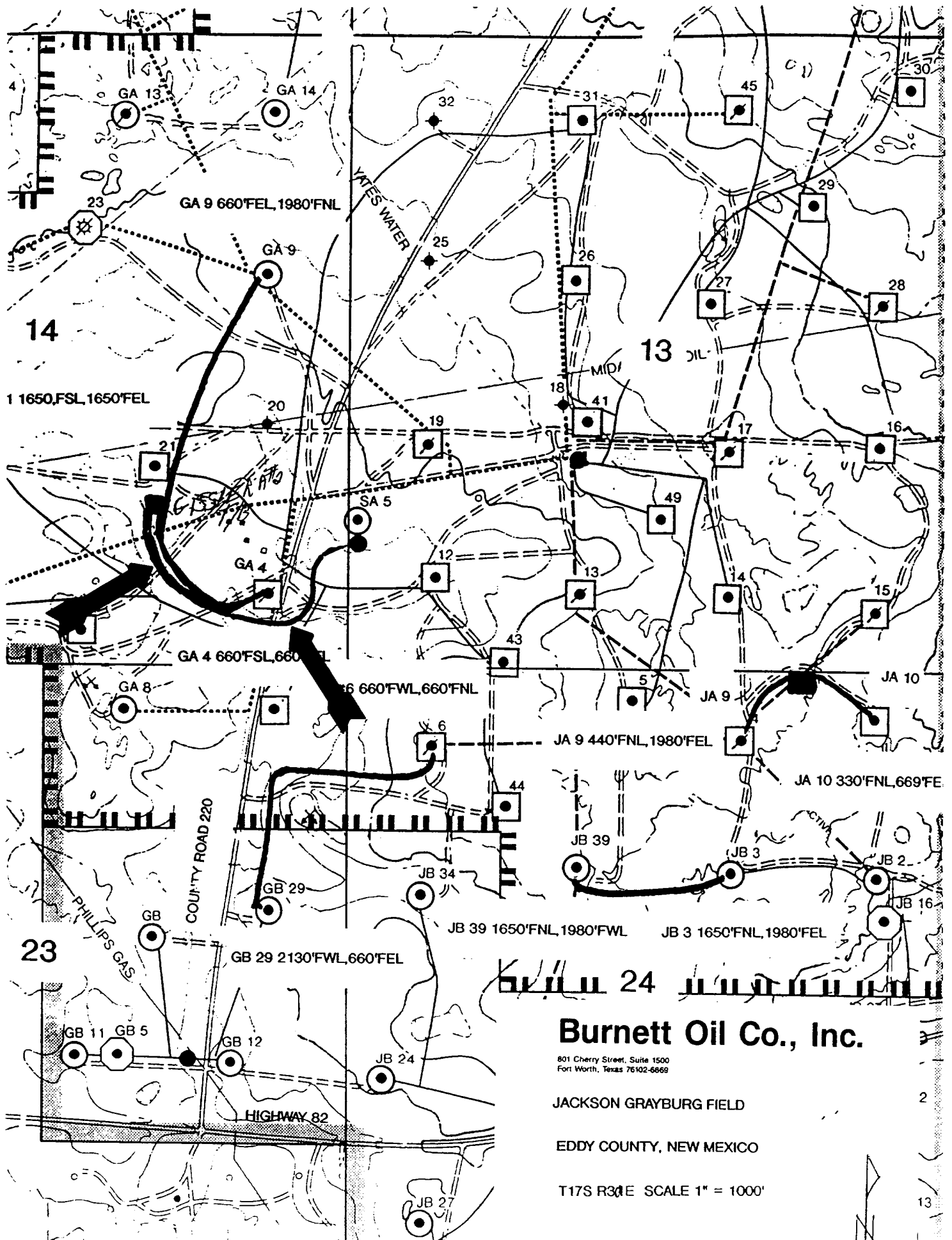

**TITLE PAGE/ABSTRACT/
NEGATIVE SITE REPORT
ROSWELL DISTRICT**

BLM/ RDO 1/95

1. BLM Report No.
2. (ACCEPTED) (REJECTED)
3. NMCRIS No. 55632

4. Title of Report (Project Title): Archeological Clearance Report for Burnett Oil Company Inc's Tank Battery, Flowline and SWD Pipeline Easements.

5. Project Date(s): 10FEB97 to 10FEB97

6. Report Date 14FEB97

7. Consultant Name & Address: Pecos Archeological Consultants, P.O. Box 1771, Carlsbad, N.M.
Direct Charge: James E. Hunt

Name:

Address:

Authors Name: James E. Hunt

field personnel names: James E. Hunt and Robert J. Martin

Phone (505-887-7029)

8. Permit No. : BLM Survey Permit No. 6-2920-97

9. Consultant Report No. : 97017

10. Sponsor Name and Address: Burnett Oil Co., Inc.
Indiv. Responsible: Sterling Randolph

Name:

Address: 801 Cherry St., Suite 1500, Ft. Worth, TX 76102

Phone (817) 332-5108

11. For BLM Use only.

12 ACREAGE:

Total No. of acres surveyed: 20.99

SURFACE OWNERSHIP: Federal: 20.99

State _____, Private

13. Location: (Maps Attached if negative survey):

a. State: NM

e. Area: T 17 S R 30 E, Sec. _____/4 ____/4 ____/4

b. County: Eddy

f. Footages: SEE ATTACHMENT

c. BLM District: Roswell

g. 7.5 ' Map Name(s): USGS Loco Hills Quadrangle, 1985.

d. Nearest City or town: Loco Hills, NM

LOCATIONAL DATA

Burnett Oil Co. Inc's pipeline easement, designated the SWD Pipeline will measure 100 ft X 2240 ft or 5.14 acres. It will be situated in the:

SW1/4 SE1/4, section 14, T17S, R30E, NMPM, Eddy Co., N.M.
SE1/4 SE1/4, section 14, T17S, R30E, NMPM, Eddy Co., N.M.
SW1/4 SW1/4, section 13, T17S, R30E, NMPM, Eddy Co., N.M.
NW1/4 SW1/4, section 13, T17S, R30E, NMPM, Eddy Co., N.M.

The easement designated the A-9 Flowline will measure 100 ft X 2248 ft or 5.16 acres. It will be situated in the:

SE1/4 NE1/4, section 14, T17S, R30E, NMPM, Eddy Co., N.M.
NE1/4 SE1/4, section 14, T17S, R30E, NMPM, Eddy Co., N.M.
NW1/4 SE1/4, section 14, T17S, R30E, NMPM, Eddy Co., N.M.
SW1/4 SE1/4, section 14, T17S, R30E, NMPM, Eddy Co., N.M.

The GJSAU # 6 Flowline will measure 100 ft X 2500 ft or 5.73 acres. It will be situated in the:

NW1/4 NW1/4, section 24, T17S, R30E, NMPM, Eddy Co., N.M.
NE1/4 NE1/4, section 23, T17S, R30E, NMPM, Eddy Co., N.M.
SE1/4 NE1/4, section 23, T17S, R30E, NMPM, Eddy Co., N.M.

The Jackson B # 3 Flowline will measure 100 ft X 1200 ft or 2.75 acres. It will be situated in the:

SE1/4 NW1/4, section 24, T17S, R30E, NMPM, Eddy Co., N.M.
SW1/4 NE1/4, section 24, T17S, R30E, NMPM, Eddy Co., N.M.

The Jackson # 9 Flowline will measure 100 ft X 1000 ft or 2.29 acres. It will be situated in the:

NW1/4 NE1/4, section 24, T17S, R30E, NMPM, Eddy Co., N.M.

The Jackson # 10 Flowline will measure 100 ft X 774 ft or 1.77 acres. It will be situated in the:

NW1/4 NE1/4, section 24, T17S, R30E, NMPM, Eddy Co., N.M.

The Jackson A Tank Battery will measure 100 ft X 140 ft or 0.32 acre. It will be situated in the:

NE1/4 NE1/4, section 24, T17S, R30E, NMPM, Eddy Co., N.M.

Map Reference: USGS Lea Quadrangle, 7.5 Minute Series, 1984.

14. a. Location: ARMS, BLM
Date: 07FEB97
List By LA#: none

b. Description of Undertaking: six pipeline easements and a tank battery site.

c. Environmental Setting (NRCS soil designation; vegetative community; etc.: The project area is located on the Querecho Plains, west of Loco Hills, NM. Local soils consist of loamy sands which belong to the Kermit-Berino association. Vegetation includes plains yucca (*Yucca glauca*), mesquite (*Prosopis juliflora*), sand sage (*Artemisia filifolia*) and grasses.

d. Field Methods: Transect Intervals: 15 M
Crew Size: 2
Time in Field: 6 hrs
Collections: None

15. Cultural Resource Findings: one IM

a. Identification and Description: IM-1 consists of a scatter of thermally-altered caliche, 50-100 fragments in a 20 X 20 m area with no associated organic deposits. It is located at station 9+00 on the A-6 flowline, in the: NE1/4 NW1/4 SE1/4, section 14, T17S, R30E, NMPM, Eddy Co., N.M.

In addition, a scatter of late historic trash was deposited on the SWD Line at station 9+00. This material is late 1940s-early 1960s and should not be considered an antiquity. It was therefore not recored as a cultural resource.

16. Management Summary: Clearance for project as planned.

I certify that the information provided above is correct and accurate and meets all appreciable BLM standards.

Responsible Archaeologist: signature

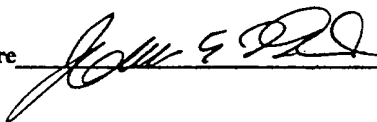

date

2/13/97

