

N. M. O. C. C. COPY
(SUBMIT IN TRIPLICATE)

Budget Bureau No. 42-R368.4.
Approval expires 12-31-60

Land Office

Location

Unit

Date **Feb 7 1962** **"B"**

O. C. C.
ARTESIA, OFFICE

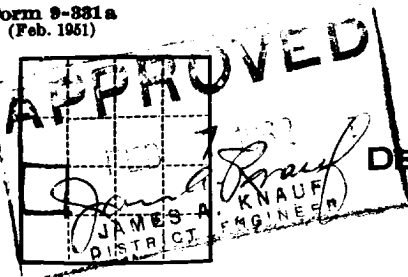

UNITED STATES
DEPARTMENT OF THE INTERIOR
GEOLOGICAL SURVEY

SUNDRY NOTICES AND REPORTS ON WELLS

NOTICE OF INTENTION TO DRILL	<input checked="" type="checkbox"/>	SUBSEQUENT REPORT OF WATER SHUT-OFF	
NOTICE OF INTENTION TO CHANGE PLANS		SUBSEQUENT REPORT OF SHOOTING OR ACIDIZING	
NOTICE OF INTENTION TO TEST WATER SHUT-OFF		SUBSEQUENT REPORT OF ALTERING CASING	
NOTICE OF INTENTION TO RE-DRILL OR REPAIR WELL		SUBSEQUENT REPORT OF RE-DRILLING OR REPAIR	
NOTICE OF INTENTION TO SHOOT OR ACIDIZE		SUBSEQUENT REPORT OF ABANDONMENT	
NOTICE OF INTENTION TO PULL OR ALTER CASING		SUPPLEMENTARY WELL HISTORY	
NOTICE OF INTENTION TO ABANDON WELL			

(INDICATE ABOVE BY CHECK MARK NATURE OF REPORT, NOTICE, OR OTHER DATA)

February 2, 19 **62**

Well No. **5** is located **2310** ft. from **XXX** **S** line and **990** ft. from **XXX** **W** line of sec. **23**
SW/4 of Sec. 23 **17-8** **30-E** **NMPM**
(1/4 Sec. and Sec. No.) (Twp.) (Range) (Meridian)
Undesignated **Eddy** **New Mexico**
(Field) (County or Subdivision) (State or Territory)

The elevation of the derrick floor above sea level is _____ ft.

DETAILS OF WORK

(State names of and expected depths to objective sands; show sizes, weights, and lengths of proposed casings; indicate mudding jobs, cementing points, and all other important proposed work)

Sinclair Oil & Gas Company's Well No. 5, Dale H. Parks "B" Lease

8-5/8" OD Casing	24#	1600'	750 Sacks
4-1/2" OD Casing	9.5#	7000'	1300 Sacks

Propose to drill with rotary tools to a depth of approximately 7000' to test the Abo Reef 6000' to total depth.

I understand that this plan of work must receive approval in writing by the Geological Survey before operations may be commenced.

Company **Sinclair Oil & Gas Company**

Address **P. O. Box 1470**

Midland, Texas

RECEIVED

FEB 7 1962

Title **Chief Clerk - Production Dept.**

NEW MEXICO OIL CONSERVATION COMMISSION
WELL LOCATION AND ACREAGE DEDICATION PLAT

SEE INSTRUCTIONS FOR COMPLETING THIS FORM ON THE REVERSE SIDE

SECTION A

Operator Sinclair Oil & Gas Company		Lease Dale H. Parke "B"		Well No. 10
Unit Letter L	Section 23	Township 17 South	Range 30 East	County Elddy
Actual Footage Location of Well: 2310 feet from the South line and 990 feet from the West line				
Ground Level Elev.	Producing Formation Alto Reef	Pool	Dedicated Acreage: 40 Acres	

1. Is the Operator the only owner in the dedicated acreage outlined on the plat below? YES ☒ NO ____ . ("Owner" means the person who has the right to drill into and to produce from any pool and to appropriate the production either for himself or for himself and another. (65-3-29 (e) NMSA 1935 Comp.)
2. If the answer to question one is "no," have the interests of all the owners been consolidated by communitization agreement or otherwise? YES ____ NO ____ . If answer is "yes," Type of Consolidation ____
3. If the answer to question two is "no," list all the owners and their respective interests below:

Owner	Land Description

SECTION B

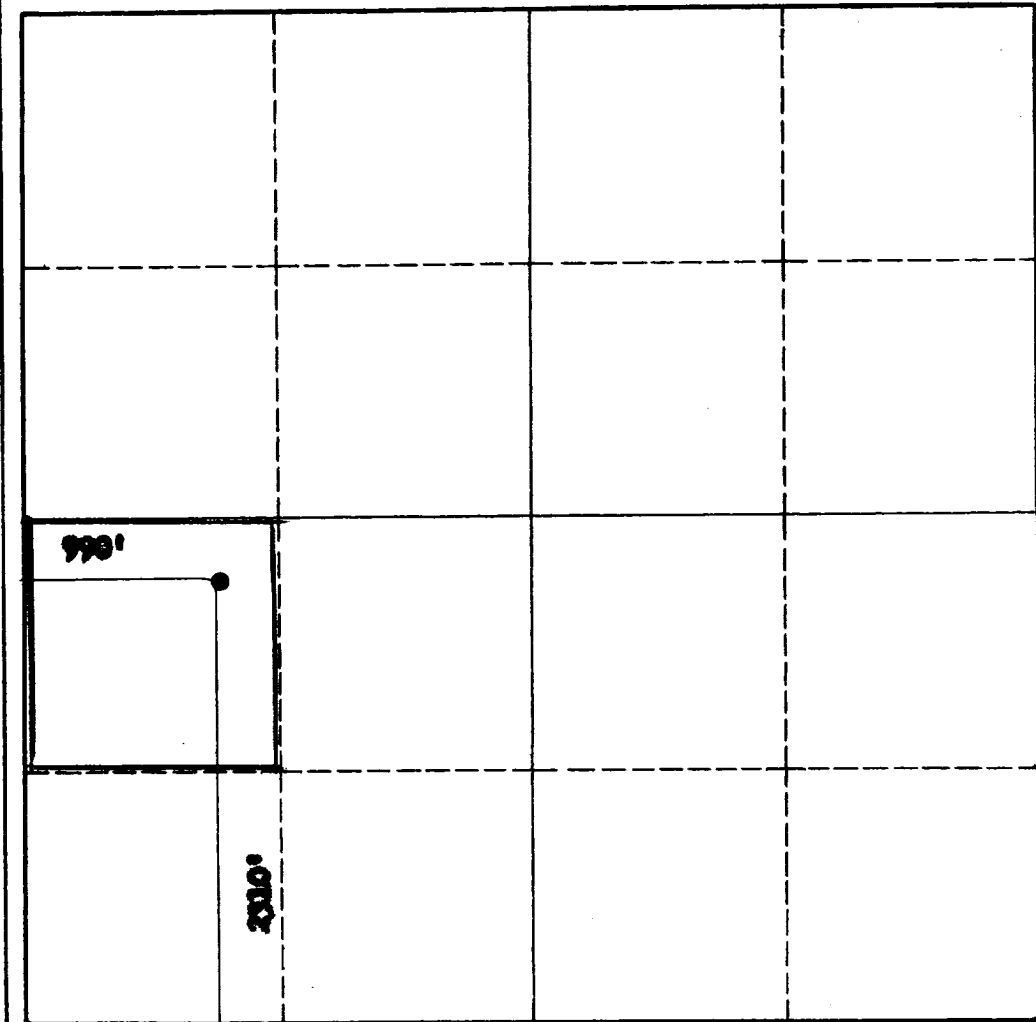

CERTIFICATION

I hereby certify that the information in SECTION A above is true and complete to the best of my knowledge and belief.

Name
R. W. Sutter
Position
Div. Clerk Prod. Dept.
Company
Sinclair Oil & Gas Co.
Date
February 2, 1962

I hereby certify that the well location shown on the plat in SECTION B was plotted from field notes of actual surveys made by me or under my supervision, and that the same is true and correct to the best of my knowledge and belief.

Date Surveyed
2/2/62
Registered Professional Engineer and/or Land Surveyor
John W. West
Certificate No.
676

INSTRUCTIONS FOR COMPLETION OF FORM C-128

1. Operator shall furnish and certify to the information called for in Section A.
2. Operator shall outline the dedicated acreage for *both* oil and gas wells on the plat in Section B.
3. A registered professional engineer or land surveyor registered in the State of New Mexico or approved by the Commission shall show on the plat the location of the well and certify this information in the space provided.
4. All distances shown on the plat must be from the outer boundaries of the Section.
5. If additional space is needed for listing owners and their respective interests as required in question 3 of Section A, please use space below.