

NEW MEXICO OIL CONSERVATION COMMISSION
WELL LOCATION AND ACREAGE DEDICATION PLAT

FORM C-128
Revised 5/1/57

SEE INSTRUCTIONS FOR COMPLETING THIS FORM ON THE REVERSE SIDE

SECTION A

| | | | | |
|--|------------------------------------|-----------------------------------|---------------------------------------|-----------------------|
| Operator Texas Pacific Coal & Oil Co. | | Lease U.S.A. Wooley "D" | | Well No. 1 |
| Unit Letter K | Section 23 | Township 17 South | Range 30 East | County Eddy |
| Actual Footage Location of Well: 2100 feet from the South line and 1650 feet from the West line | | | | |
| Ground Level Elev. | Producing Formation also | Pool Wildcat Lindsey | Dedicated Acreage: 40 Acres | |

1. Is the Operator the only owner in the dedicated acreage outlined on the plat below? YES _____ NO **X**. ("Owner" means the person who has the right to drill into and to produce from any pool and to appropriate the production either for himself or for himself and another. (65-3-29 (e) NMSA 1935 Comp.)
2. If the answer to question one is "no," have the interests of all the owners been consolidated by communitization agreement or otherwise? YES _____ NO _____. If answer is "yes," Type of Consolidation **Operating Agreement**
3. If the answer to question two is "no," list all the owners and their respective interests below:

| | |
|-------|------------------|
| Owner | Land Description |
| | |
| | |

RECEIVED

NOV 30 1961

U. S. GEOLOGICAL SURVEY
ARTESIA, NEW MEXICO
CERTIFICATION

SECTION B

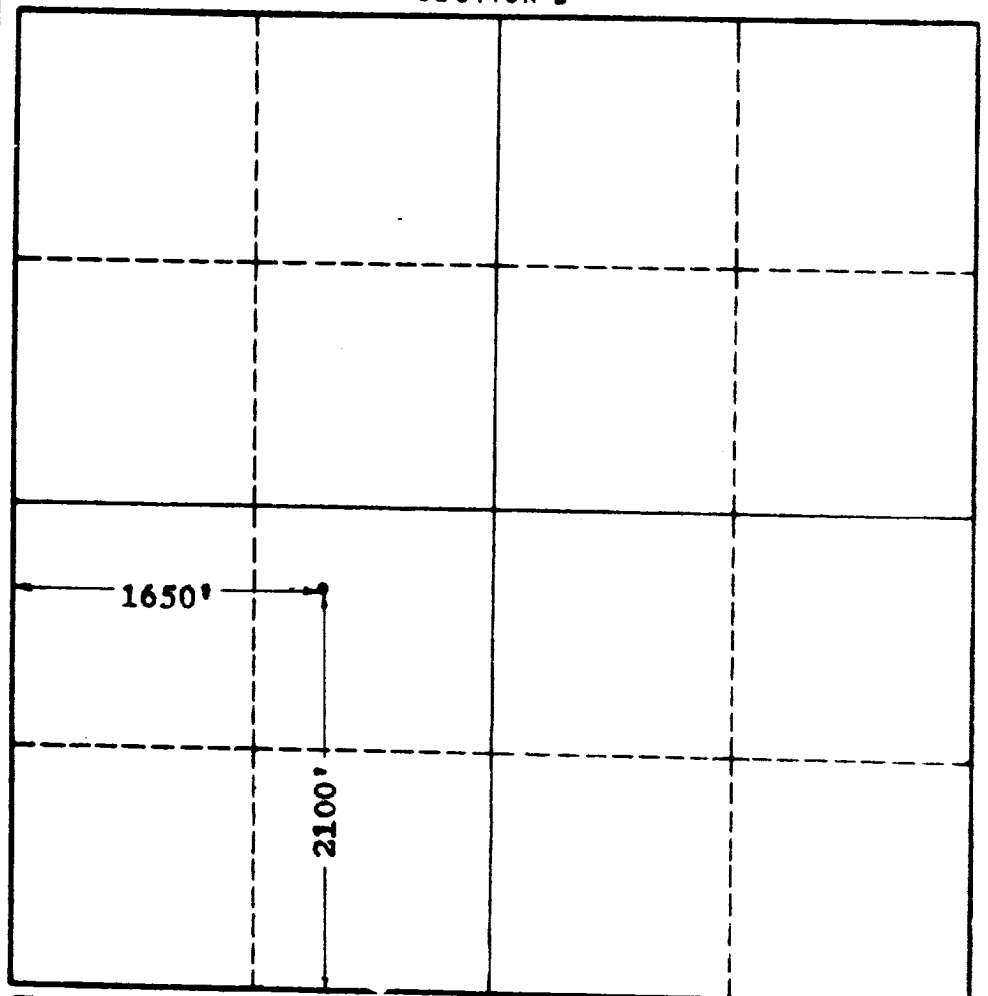

I hereby certify that the information in SECTION A above is true and complete to the best of my knowledge and belief.

Name **R. W. Lines**
Position **Executive Vice President**
Company **Texas Pacific Coal & Oil Co.**
Date **November 28, 1961**

I hereby certify that the well location shown on the plat in SECTION B was plotted from field notes of actual surveys made by me or under my supervision, and that the same is true and correct to the best of my knowledge and belief.

Date Surveyed **11-24-1961**
Registered Professional Engineer and/or Land Surveyor, **JOHN W. WEST**

John W. West
Certificate No. **N. M. P. E. NO. 676**

0 330 660 990 1320 1650 1980 2310 2640 2000 1500 1000 500 0