

NEW MEXICO OIL CONSERVATION COMMISSION
WELL LOCATION AND ACREAGE DEDICATION AT

Form C-102
 Supersedes C-128
 Effective 1-1-65

All distances must be from the outer boundaries of the Section.

Operator JFG ENTERPRISE			Lease BEESON FEDERAL		Well No. 1
Unit Letter G	Section 33	Township 17S	Range 30E	County Eddy	
Actual Footage Location of Well: 2310 feet from the North line and 2310 feet from the East line					
Ground Level Elev. 3605	Producing Formation SR, Q, Gb, SA		Pool Grayburg-Jackson		Dedicated Acreage: 40 Acres

1. Outline the acreage dedicated to the subject well by colored pencil or hatchure marks on the plat below.
2. If more than one lease is dedicated to the well, outline each and identify the ownership thereof (both as to working interest and royalty).
3. If more than one lease of different ownership is dedicated to the well, have the interests of all owners been consolidated by communitization, unitization, force-pooling, etc?

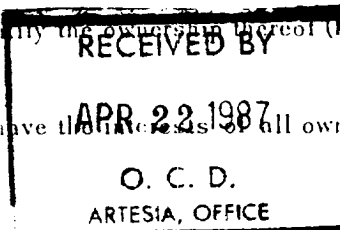

☐ Yes ☐ No If answer is "yes," type of consolidation _____

If answer is "no," list the owners and tract descriptions which have actually been consolidated. (Use reverse side of this form if necessary.) _____

No allowable will be assigned to the well until all interests have been consolidated (by communitization, unitization, forced-pooling, or otherwise) or until a non-standard unit, eliminating such interests, has been approved by the Commission.

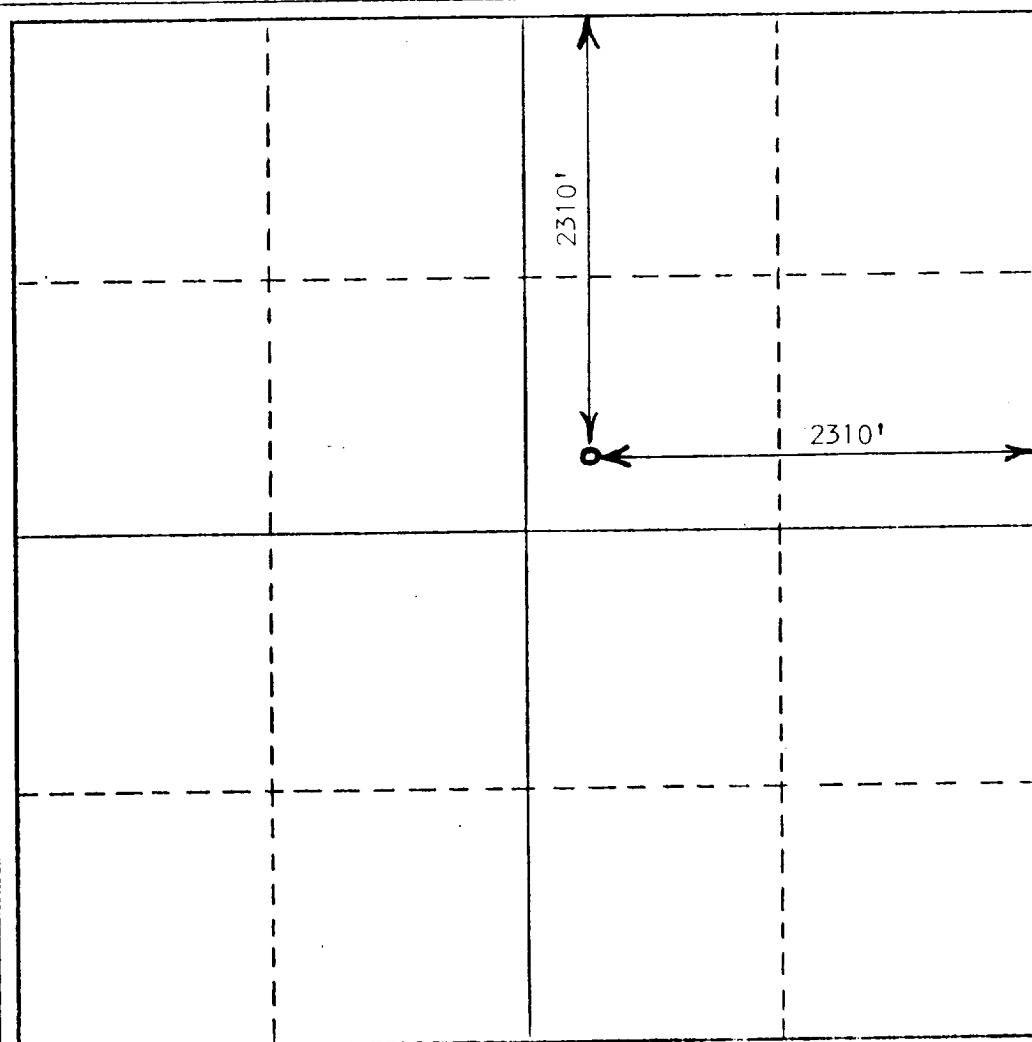

CERTIFICATION

I hereby certify that the information contained herein is true and complete to the best of my knowledge and belief.

James A. Knauf

Figure
James A. Knauf

Position
Agent

Company
JFG ENTERPRISE

Date
April 15, 1987

I hereby certify that the well location shown on this plat was plotted from field notes of actual surveys made by me or under my supervision, and that the same is true and correct to the best of my knowledge and belief.

**SEE ORIGINAL SURVEY
 (Copy Attached)**

Date Surveyed
March 19, 1948

Registered Professional Engineer
 and/or Land Surveyor

Norman W. Krouskop

Certificate No.
698

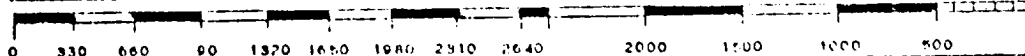

PREMIER PETROLEUM CORPORATION
Oil Producers

ARTESIA, NEW MEXICO

March 19, 1948

LAND OFFICE: Las Cruces
LEASE NO.: 060528
UNIT NO.: Maddren Beeson -F
WELL NO.: 1-F
LOCATION: S. $\frac{1}{4}$ SW $\frac{1}{4}$ NE $\frac{1}{4}$ - Sec. 33, T17S, R30E, N.N.P.M.

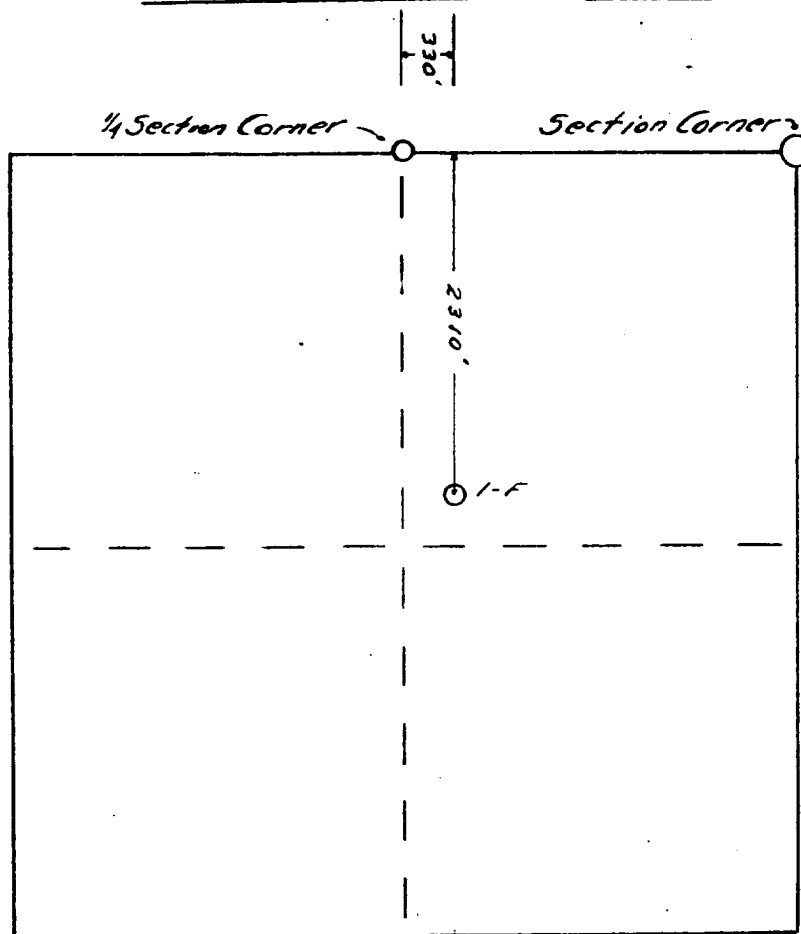

Scale 1" = 1320'

This is to certify that the Premier Petroleum Corporation Maddren Beeson No. 1-F location was surveyed and located under my supervision 2310 feet from the North and East lines (SW $\frac{1}{4}$ SW $\frac{1}{4}$ NE $\frac{1}{4}$) of Section 33, Township 17 South, Range 30 East, N.M.P.M., Eddy County, New Mexico

Norman W. Krouskop
Norman W. Krouskop
Registered Land Surveyor
License Number 698

BLOWOUT PREVENTER SKETCH

JFG Enterprise
Well #1 Beeson Federal
SW-NE Sec. 33-17S-30E

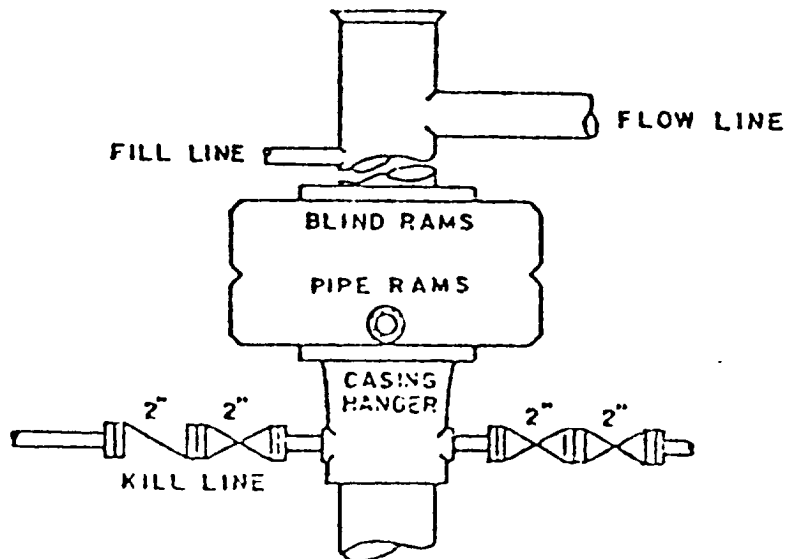

SUPPLEMENTAL RE-ENTRY DATA

JFG ENTERPRISE
WELL #1 BEESON FEDERAL
SW-NE SLC. 33-17S-30E
EDDY COUNTY, NEW MEXICO

1. SURFACE FORMATION: Sandy soils of Quaternary Age.
2. GEOLOGIC MARKERS: (Ground Elevation - 3605')

Anhydrite	270'	Queen	2522'
Salt	540'	Grayburg	2843'
Base Salt	1317'	San Andres	3451'
Yates	1483'		

3. ANTICIPATED POROSITY ZONES:

Oil: Seven Rivers, Queen, Grayburg & San Andres

4. CASING DESIGN:

<u>Size</u>	<u>Interval</u>	<u>Weight</u>	<u>Grade</u>	<u>Joint</u>	<u>Remarks</u>
8 5/8"	0 - 576'	24.0#	J-55	STC	Cemented
4 1/2"	0 - 3550'	9.5#	J-55	STC	Proposed

5. PRESSURE CONTROL EQUIPMENT: Two Ram-Type Preventers. (See attached)
6. CIRCULATING MEDIUM: Salt water system conditioned as necessary for control of viscosity and water loss.
7. TESTING, LOGGING AND CORING PROGRAMS: No coring or DST's are planned. Electric logs will include a Compensated Density Neutron Log with a Gamma Ray.
8. ABNORMAL PRESSURES, TEMPERATURES OR GASES: None anticipated.
9. ANTICIPATED STARTING DATE: It is planned that operations will commence about April 24, 1987. Duration of drilling, testing, and completion operations should be 1 to 6 weeks.

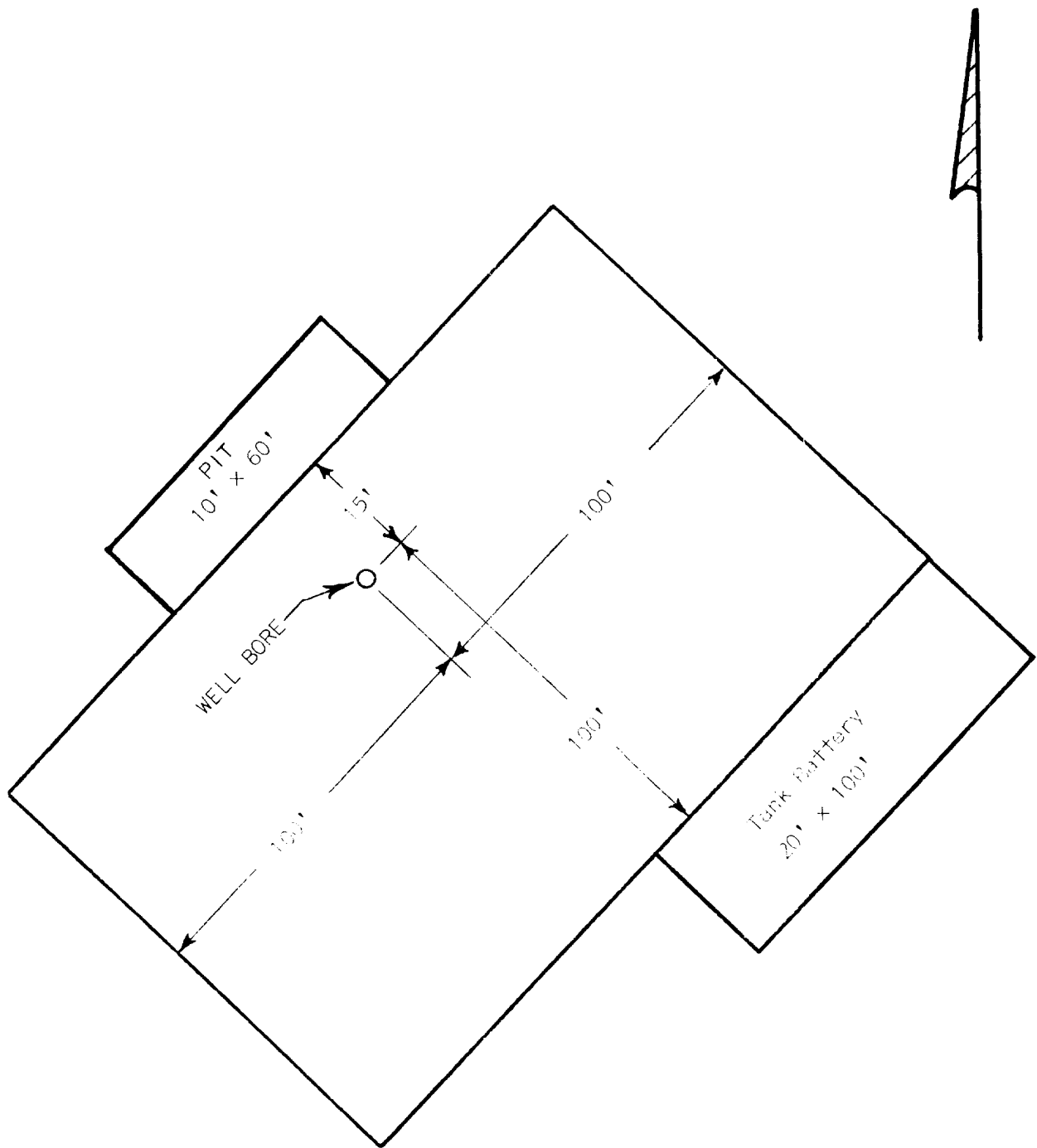

SUP Exhibit "C"
SKETCH OF WELL PAD
JFG Enterprise
Well #1 Beeson Federal
SW-NE Sec. 33-17S-30E