

(SUBMIT IN TRIPLICATE)

UNITED STATES
DEPARTMENT OF THE INTERIOR
GEOLOGICAL SURVEY

Land Office

LC 028936-D

Lease No.

Unit

J

RECEIVED

AUG 21 1961

APPROVED

AUG 17 1961

A. R. BROWN
ACTING DISTRICT ENGINEER

VARIOUS NOTICES AND REPORTS ON WELLS

NOTICE OF INTENTION TO DRILL	<input checked="" type="checkbox"/>	SUBSEQUENT REPORT OF WATER SHUT-OFF	<input type="checkbox"/>
NOTICE OF INTENTION TO CHANGE PLANS	<input type="checkbox"/>	SUBSEQUENT REPORT OF SHOOTING OR ACIDIZING	<input type="checkbox"/>
NOTICE OF INTENTION TO TEST WATER SHUT-OFF	<input type="checkbox"/>	SUBSEQUENT REPORT OF ALTERING CASING	<input type="checkbox"/>
NOTICE OF INTENTION TO RE-DRILL OR REPAIR WELL	<input type="checkbox"/>	SUBSEQUENT REPORT OF RE-DRILLING OR REPAIR	<input type="checkbox"/>
NOTICE OF INTENTION TO SHOOT OR ACIDIZE	<input type="checkbox"/>	SUBSEQUENT REPORT OF ABANDONMENT	<input type="checkbox"/>
NOTICE OF INTENTION TO PULL OR ALTER CASING	<input type="checkbox"/>	SUPPLEMENTARY WELL HISTORY	<input type="checkbox"/>
NOTICE OF INTENTION TO ABANDON WELL	<input type="checkbox"/>		

(INDICATE ABOVE BY CHECK MARK NATURE OF REPORT, NOTICE, OR OTHER DATA)

August 16,

19 61

Well No. M-6 is located 1650 ft. from N line and 1650 ft. from E line of sec. 31

NW SE 31

T-17-S;

R-30-E

(¼ Sec. and Sec. No.)

(Twp.)

(Range)

(Meridian)

Loco Hills

Eddy

New Mexico

(Field)

(County or Subdivision)

(State or Territory)

The elevation of the derrick floor above sea level is 3566.8 ft.

DETAILS OF WORK

(State names of and expected depths to objective sands; show sizes, weights, and lengths of proposed casings; indicate mudding jobs, cementing points, and all other important proposed work)

We propose to use the following strings of casing and to cement as indicated:

Drill 10" hole to 700' and set 7" - 20# new casing and cement w/50 sks. cement

Drill 8" hole to 3000' and set 4½" - 9.5# casing and cement w/150 sks. cement and mud to surface. New casing.

I understand that this plan of work must receive approval in writing by the Geological Survey before operations may be commenced.

Ambassador Oil Corporation

Company

P.O. Box 9338

Fort Worth 7, Texas

Address

Communication to:

Box 260 Artesia, New Mexico

By

Project Supervisor

Title

NUMBER OF COPIES RECEIVED	
DISTRIBUTION	
SANTA FE	
FILE	
U.S.G.S.	
LAND OFFICE	
TRANSPORTER	OIL GAS
PRODUCTION OFFICE	
OPERATOR	

FORM C-128
REV. 10/5/57

NEW MEXICO OIL CONSERVATION COMMISSION RECEIVED

WELL LOCATION AND ACREAGE DEDICATION PLAT

SEE INSTRUCTIONS FOR COMPLETING THIS FORM ON THE REVERSE SIDE

AUG 9 1961

O.C.C. ARTESIA OFFICE

SECTION A	
Operator Amesbury Oil Corp.	Lease Federal
Unit Letter J	Well No. N#6
Section 31	Township T-17-8
Range R-30-E	County O.C.C. ARTESIA OFFICE
Actual Footage Location of Well: 1650 feet from the South line and 1650 feet from the East line Ground Level Elev. 3566.8 Producing Formation Lower Hills sand Pool Lower Hills Dedicated Acreage: 40 Acres	

1. Is the Operator the only owner in the dedicated acreage outlined on the plat below? YES ☒ NO ☐ ("Owner" means the person who has the right to drill into and to produce from any pool and to appropriate the production either for himself or for himself and another. (65-3-29 (e) NMSA 1935 Comp.)
2. If the answer to question one is "no," have the interests of all the owners been consolidated by communitization agreement or otherwise? YES ☐ NO ☐ . If answer is "yes," Type of Consolidation _____
3. If the answer to question two is "no," list all the owners and their respective interests below:

Owner	Land Description

SECTION B

R-30-E

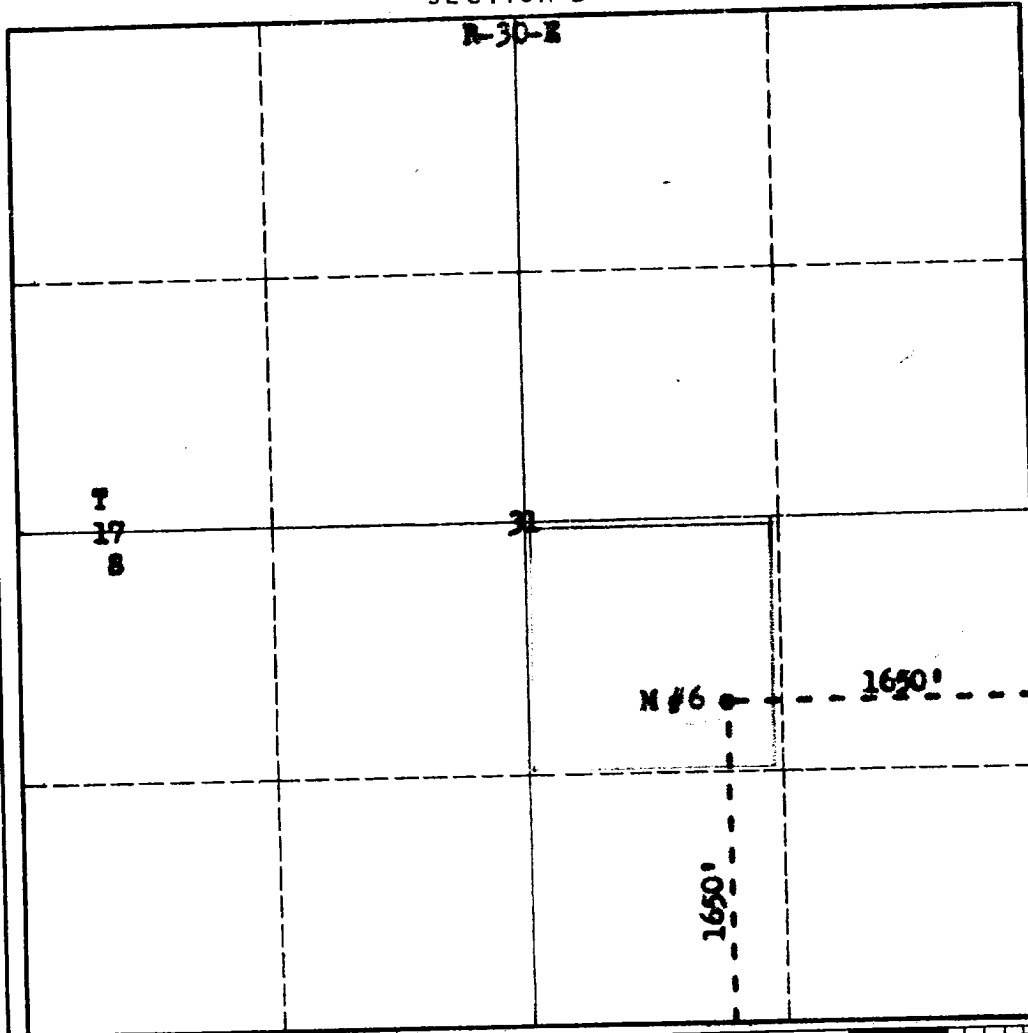

CERTIFICATION

I hereby certify that the information in SECTION A above is true and complete to the best of my knowledge and belief.

Name	E. W. Puckey
Position	Superintendent
Company	Amesbury Oil Corp.
Date	July 28, 1961

I hereby certify that the well location shown on the plat in SECTION B was plotted from field notes of actual surveys made by me or under my supervision, and that the same is true and correct to the best of my knowledge and belief.

Date Surveyed	July 28, 1961
Registered Professional Engineer and/or Land Surveyor	[Signature]

Certificate No. **3280**