

N. M. O. C. C. COPY
(SUBMIT IN TRIPLICATE)

Budget Bureau No. 42-R358.4
Approval expires 12-31-60.

Land Office Las Cruces
Lease No. 029418 (b)
Unit RECEIVED

UNITED STATES
DEPARTMENT OF THE INTERIOR
GEOLOGICAL SURVEY

APR 3 1961

SUNDRY NOTICES AND REPORTS ON WELLS

C. R.
ARTESIA, OFFICE

NOTICE OF INTENTION TO DRILL	<input checked="" type="checkbox"/>	SUBSEQUENT REPORT OF WATER SHUT-OFF	
NOTICE OF INTENTION TO CHANGE PLANS		SUBSEQUENT REPORT OF SHOOTING OR ACIDIZING	
NOTICE OF INTENTION TO TEST WATER SHUT-OFF		SUBSEQUENT REPORT OF ALTERING CASING	
NOTICE OF INTENTION TO RE-DRILL OR REPAIR WELL		SUBSEQUENT REPORT OF RE-DRILLING OR REPAIR	
NOTICE OF INTENTION TO SHOOT OR ACIDIZE		SUBSEQUENT REPORT OF ABANDONMENT	
NOTICE OF INTENTION TO PULL OR ALTER CASING		SUPPLEMENTARY WELL HISTORY	
NOTICE OF INTENTION TO ABANDON WELL			

(INDICATE ABOVE BY CHECK MARK NATURE OF REPORT, NOTICE, OR OTHER DATA)

Hobbs, New Mexico - March 29, 1961

Lea "C"
Well No. 4 is located 1980 ft. from {N} line and 1980 ft. from {E} line of sec. 11

NW/4 SE/4 Sec. 11

(1/4 Sec. and Sec. No.)

Robinson Grayburg

(Field)

17-S

(Twp.)

31-E

(Range)

T.M.P.M.

(Meridian)

Eddy

(County or Subdivision)

New Mexico

(State or Territory)

MAR 31 1961

The elevation of the derrick floor above sea level is _____ ft.

DETAILS OF WORK

(State names of and expected depths to objective sands; show sizes, weights, and lengths of proposed casings; indicate mudding jobs, cementing points, and all other important proposed work)

Propose to drill with cable tools from surface to total depth of approximately 3770' in San Andres Formation. Casing program to be approximately as follows:

Size Hole	Size Casing	Casing Point	Sacks Cement
10"	8-5/8"	900'	100
8"	5-1/2"	3660'	390

The Halliburton Pump & Plug Process will be used in cementing both strings of casing. Well will be treated with approximately 1500 bbls. oil and 30,000' 20/40 sand.

I understand that this plan of work must receive approval in writing by the Geological Survey before operations may be commenced.

Company Skelly Oil Company

Address Box 38

Hobbs, New Mexico

By

Title

Dist. Supt.

GPO 862040

Certificate No.

N. M. - P. E. & L. S. NO. 676

RECEIVED

NEW MEXICO OIL CONSERVATION COMMISSION
WELL LOCATION AND ACREAGE DEDICATION PLAT

FORM C-128
Rev. 1/57

APR 3 1961

SEE INSTRUCTIONS FOR COMPLETING THIS FORM ON THE REVERSE SIDE

D. C. C.

ARTESIA, OFFICE

SECTION A

Operator Skelly Oil Company		Lease Lea "C"		Well No. 4	
Unit Letter J	Section 11	Township 17 South	Range 31 East	County Eddy	
Actual Footage Location of Well: 1980 feet from the south line and 1980 feet from the east line					
Ground Level Elev.	Producing Formation San Andres		Pool Robinson Grayburg		Dedicated Acreage: 40 Acres

1. Is the Operator the only owner in the dedicated acreage outlined on the plat below? YES ☒ NO ☐ ("Owner" means the person who has the right to drill into and to produce from any pool and to appropriate the production either for himself or for himself and another (65-3-29 (e) NMSA 1935 Comp.))
2. If the answer to question one is "no," have the interests of all the owners been consolidated by communitization agreement or otherwise? YES ☐ NO ☐ If answer is "yes," Type of Consolidation _____
3. If the answer to question two is "no," list all the owners and their respective interests below.

Owner	Land Description	MAR 31 1961
		J. S. GEOLOGICAL SURVEY
		ARTESIA, NEW MEXICO

SECTION B

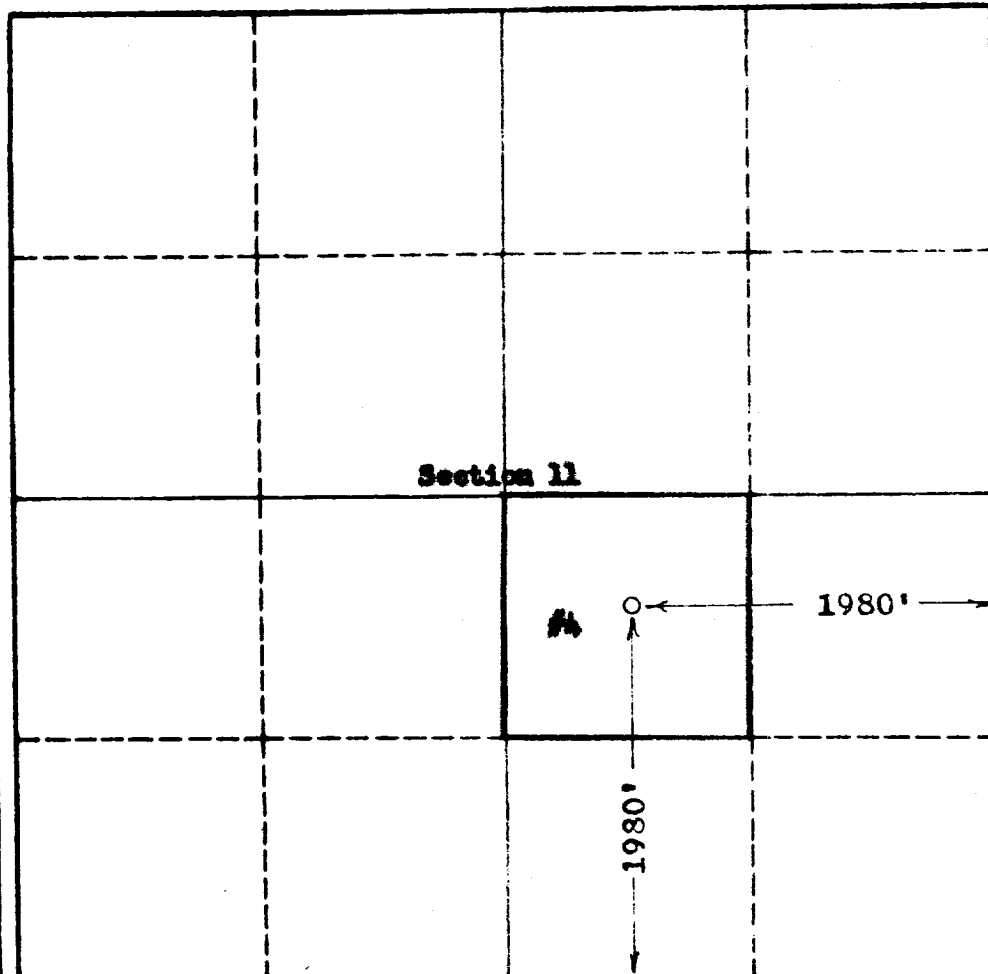

CERTIFICATION

I hereby certify that the information in SECTION A above is true and complete to the best of my knowledge and belief.

Name <i>J. J. [Signature]</i>
Position Dist. Sup.
Company Skelly Oil Company
Date March 29, 1961

I hereby certify that the information shown on the plat in SECTION B was plotted from field notes of actual surveys made by me or under my supervision, and that the same is true and correct to the best of my knowledge and belief.

Date Surveyed March 29, 1961
Registered Professional Engineer and/or Land Surveyor, JOHN W. WEST
Certificate No. N. M. - P. E. & L. S. NO. 676

0 330 660 990 1320 1650 1980 2310 2640 2000 1500 1000 500 0