

(SUBMIT IN TRIPLICATE)

UNITED STATES  
DEPARTMENT OF THE INTERIOR  
GEOLOGICAL SURVEY

Land Office Las Cruces  
Lease No. 029420 (a)  
Unit Dow "A"

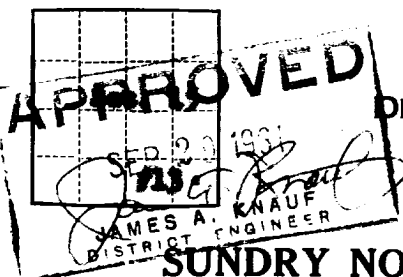

SUNDRY NOTICES AND REPORTS ON WELLS

NOTICE OF INTENTION TO DRILL	<input checked="" type="checkbox"/>	SUBSEQUENT REPORT OF WATER SHUT-OFF	
NOTICE OF INTENTION TO CHANGE PLANS		SUBSEQUENT REPORT OF SHOOTING OR ACIDIZING	
NOTICE OF INTENTION TO TEST WATER SHUT-OFF		SUBSEQUENT REPORT OF ALTERING CASING	
NOTICE OF INTENTION TO RE-DRILL OR REPAIR WELL		SUBSEQUENT REPORT OF RE-DRILLING OR REPAIR	
NOTICE OF INTENTION TO SHOOT OR ACIDIZE		SUBSEQUENT REPORT OF ABANDONMENT	
NOTICE OF INTENTION TO PULL OR ALTER CASING		SUPPLEMENTARY WELL HISTORY	
NOTICE OF INTENTION TO ABANDON WELL			

(INDICATE ABOVE BY CHECK MARK NATURE OF REPORT, NOTICE, OR OTHER DATA)

Hobbs, New Mexico - Sept. 26, 19 61

Dow "A"

Well No. 13 is located 660 ft. from N line and 660 ft. from E line of sec. 15

SE 1/4 Sec. 15

(1/4 Sec. and Sec. No.)

17-S

(Twp.)

31-E

(Range)

N.M.P.M.

(Meridian)

Grayburg Jackson

(Field)

Elddy

(County or Subdivision)

New Mexico

(State or Territory)

The elevation of the derrick floor above sea level is \_\_\_\_\_ ft.

DETAILS OF WORK

(State names of and expected depths to objective sands; show sizes, weights, and lengths of proposed casings; indicate casing for acidizing points, and all other important proposed work)

Propose to drill with cable tools from surface to total depth of approx. 3670' in the San Andres Formation. Casing program to be approx. as follows:

Size hole	Size casing	Casing point	Depth
10"	8-5/8"	750'	100
6"	4-1/2"	3670'	300

The pump & plug process will be used in cementing both strings of casing. The well will be perforated and treated with approx. 1550 bbls. of lease oil and approx. 60,000# 20/40 sand.

I understand that this plan of work must receive approval in writing by the Geological Survey before operations may be commenced.

Company Skelly Oil Company

Address Box 38

Hobbs, New Mexico

By J. E. Ault

Title Dist. Supt.

RECEIVED

SEP 29 1961

U.S. GEOLOGICAL SURVEY  
ARTESIA, NEW MEXICO

NEW MEXICO OIL CONSERVATION COMMISSION  
WELL LOCATION AND ACREAGE DEDICATION PLAT

FORM C-126  
Revised 5/1/57

SEE INSTRUCTIONS FOR COMPLETING THIS FORM ON THE REVERSE SIDE

SECTION A

Operator <b>Shelly Oil Company</b>		Lease <b>Dew "A"</b>		Well No. <b>13</b>
Unit Letter <b>P</b>	Section <b>15</b>	Township <b>17 South</b>	Range <b>31 East</b>	County <b>Eddy</b>
Actual Footage Location of Well: <b>660</b> feet from the <b>South</b> line and <b>660</b> feet from the <b>East</b> line				
Ground Level Elev.	Producing Formation <b>San Andres</b>	Pool <b>Grayburg Jackson</b>	Dedicated Acreage: <b>40</b> Acres	

1. Is the Operator the only owner in the dedicated acreage outlined on the plat below? YES ☒ NO ☐ ("Owner" means the person who has the right to drill into and to produce from any pool and to appropriate the production either for himself or for himself and another. (65-3-29 (a) NMSA 1935 Comp.)
2. If the answer to question one is "no," have the interests of all the owners been consolidated by communitization agreement or otherwise? YES ☐ NO ☐ If answer is "yes," Type of Consolidation \_\_\_\_\_
3. If the answer to question two is "no," list all the owners and their respective interests below:

Owner	Land Description

RECEIVED

SEP 29 1961

J. S. GEOLOGICAL SURVEY  
ARTESIA, NEW MEXICO

SECTION B

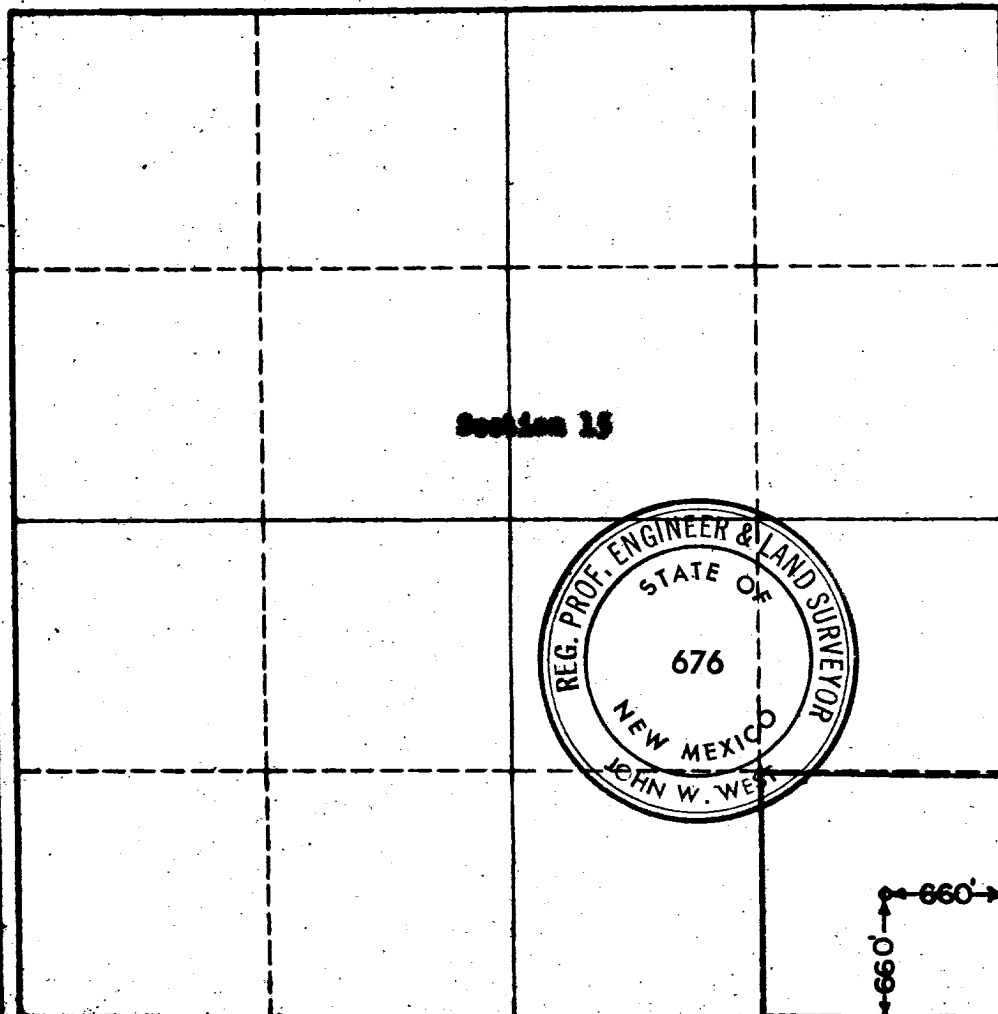

CERTIFICATION

I hereby certify that the information in SECTION A above is true and complete to the best of my knowledge and belief.

Name <i>J. E. Curb</i>
Position <b>Dist. Supt.</b>
Company <b>Shelly Oil Company</b>
Date <b>Sept. 26, 1961</b>

I hereby certify that the well location shown on the plat in SECTION B was plotted from field notes of actual surveys made by me or under my supervision, and that the same is true and correct to the best of my knowledge and belief.

Date Surveyed <b>9-23-61</b>
Registered Professional Engineer and/or Land Surveyor, <b>JOHN W. WEST</b>
Certificate No. <i>John W. West</i>
N.M. - P.E. & L.S. NO. 676