

UNITED STATES
DEPARTMENT OF THE INTERIOR
GEOLOGICAL SURVEY

APPLICATION FOR PERMIT TO DRILL, DEEPEN, OR PLUG BACK

1a. TYPE OF WORK

DRILL ☒DEEPEN ☐PLUG BACK ☐

b. TYPE OF WELL

OIL
WELL ☒GAS
WELL ☐

OTHER

SINGLE
ZONE ☒MULTIPLE
ZONE ☐

2. NAME OF OPERATOR

Shelly Oil Company

3. ADDRESS OF OPERATOR

Box 730 - Hobbs, New Mexico

4. LOCATION OF WELL (Report location clearly and in accordance with any State requirements.)*

At surface

1980' FSL & 1980' FSL Section 23-178-31E

At proposed prod. zone

14. DISTANCE IN MILES AND DIRECTION FROM NEAREST TOWN OR POST OFFICE*

Approximately 5 miles west of Maljamar, New Mexico

15. DISTANCE FROM PROPOSED*

LOCATION TO NEAREST
PROPERTY OR LEASE LINE, FT.

(Also to nearest drig. unit line, if any)

18. DISTANCE FROM PROPOSED LOCATION*
TO NEAREST WELL, DRILLING, COMPLETED,
OR APPLIED FOR, ON THIS LEASE, FT.

21. ELEVATIONS (Show whether DF, RT, GR, etc.)

3868' DF

PRESENT WORKOVER CASING AND CEMENTING PROGRAM

23.

SIZE OF HOLE	SIZE OF CASING	WEIGHT PER FOOT	SETTING DEPTH	QUANTITY OF CEMENT
-	8-5/8" OD	24#	751'	95
-	7"	20#	3202'	150
-	4-1/2"	10.5#	3855'	700

Proposed:

Shelly Unit Well No. 71 is a plugged and abandoned well. We propose to reenter, perforate and treat as follows:

1. Move in and rig up workover unit.
2. Drill out to depth of 3855'. Run Gamma Ray Neutron Log.
3. Set 4-1/2" casing from surface to Total Depth and cement to circulate to surface.
4. Perforate with estimated 30 shots. (Intervals to be picked from log.)
5. Acidize perforated intervals with 2500 gallons acid.
6. Fracture perforated intervals with 30000 gallons sand water.
7. Run tubing and put well to producing.

IN ABOVE SPACE DESCRIBE PROPOSED PROGRAM: If proposal is to deepen or plug back, give data on present productive zone and proposed new productive zone. If proposal is to drill or deepen directionally, give pertinent data on subsurface locations and measured and true vertical depths. Give preventer program, if any.

24.

SIGNED

(Signed) V. E. Fletcher

TITLE District Superintendent

DATE

August 9, 1967

(This space for Federal or State office use)

PERMIT NO.

APPROVED
CONDITIONS OF APPROVAL, IF ANY:

AUG 11 1967

H. L. BECKMAN
ACTING DISTRICT ENGINEER

RECEIVED

APPROVAL DATE

AUG 15 1967

TITLE

D. C. C.

ARTESIA, OFFICE

*See Instructions On Reverse Side

RECEIVED
AUG 11 1967
U. S. GEOLOGICAL SURVEY
ARTESIA, NEW MEXICO

Instructions

General: This form is designed for submitting proposals to perform certain well operations, as indicated, on all types of lands and leases for appropriate action by either a Federal or a State agency, or both, pursuant to applicable Federal and/or State laws and regulations. Any necessary special instructions concerning the use of this form and the number of copies to be submitted, particularly with regard to local, area, or regional procedures and practices, either are shown below or will be issued by, or may be obtained from, the local Federal and/or State office.

Item 1: If the proposal is to redrill to the same reservoir at a different subsurface location or to a new reservoir, use this form with appropriate notations. Consult applicable State or Federal regulations concerning subsequent work proposals or reports on the well.

Item 4: If there are no applicable State requirements, locations on Federal or Indian land should be described in accordance with Federal requirements. Consult local State or Federal office for specific instructions.

Item 14: Needed only when location of well cannot readily be found by road from the land or lease description. A plat, or plats separate or on this reverse side, showing the roads to, and the surveyed location of, the well, and any other required information, should be furnished when required by Federal or State agency offices.

Items 15 and 18: If well is to be, or has been directionally drilled, give distances for subsurface location of hole in any present or objective production zone.

Item 22: Consult applicable Federal or State regulations, or appropriate officials, concerning approval of the proposal before operations are started.

☆ U.S. GOVERNMENT PRINTING OFFICE : 1963-O-711-396

N. MEXICO OIL CONSERVATION COMMISSION
WELL LOCATION AND ACREAGE DEDICATION PLAT

Form C-102
Supersedes C-128
Effective 1-1-65

All distances must be from the outer boundaries of the Section.

Operator Shelly Oil Company			Lease Shelly Unit			Well No. 71		
Unit Letter J	Section 23	Township 17-S	Range 31-E	County Eddy				
Actual Footage Location of Well: 1980 feet from the South line and 1980 feet from the East line								
Ground Level Elev: 3868'DF	Producing Formation Grayburg & San Andres		Pool Grayburg Jackson		Dedicated Acreage: 40 Acres			

1. Outline the acreage dedicated to the subject well by colored pencil or hachure marks on the plat below.
2. If more than one lease is dedicated to the well, outline each and identify the ownership thereof (both as to working interest and royalty).
3. If more than one lease of different ownership is dedicated to the well, have the interests of all owners been consolidated by communitization, unitization, force-pooling, etc?

☐ Yes ☐ No If answer is "yes," type of consolidation _____

If answer is "no," list the owners and tract descriptions which have actually been consolidated. (Use reverse side of this form if necessary.) _____

No allowable will be assigned to the well until all interests have been consolidated (by communitization, unitization, forced-pooling, or otherwise) or until a non-standard unit, eliminating such interests, has been approved by the Commission.

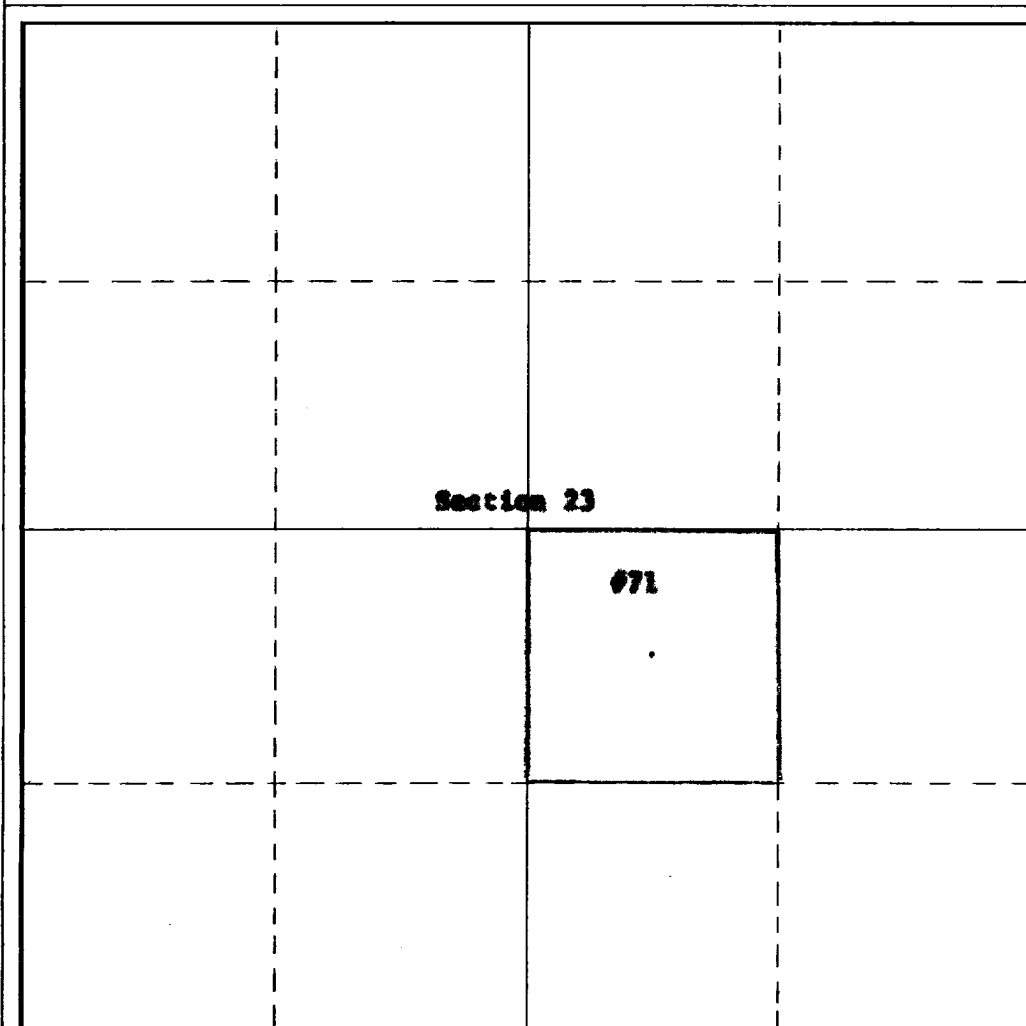

CERTIFICATION

I hereby certify that the information contained herein is true and complete to the best of my knowledge and belief.

Name
(Signed) **V. E. Fletcher**

Position
District Superintendent

Company
Shelly Oil Company

Date
AUG 9 1967

I hereby certify that the well location shown on this plat was plotted from field notes of actual surveys made by me or under my supervision, and that the same is true and correct to the best of my knowledge and belief.

Date Surveyed

Registered Professional Engineer
and/or Land Surveyor

Certificate No.

