

copy to S.F.

Form 9-331a
(Feb. 1951)

N. M. O. C. C. COPY

Budget Bureau No. 42-R358.4.
Approval expires 12-31-60.

(SUBMIT IN TRIPLICATE)

Land Office Las Cruces
Lease No. 029418-b
Unit Lea "B"

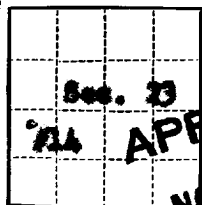

APPROVED

NOV 30 1961
SUNDAY
ACTING DISTRICT ENGINEER

**UNITED STATES
DEPARTMENT OF THE INTERIOR
GEOLOGICAL SURVEY**

RECEIVED

DEC 3 1961

SUNDAY NOTICES AND REPORTS ON WELLS

NOTICE OF INTENTION TO DRILL	<input checked="" type="checkbox"/>	SUBSEQUENT REPORT OF WATER SHUT-OFF	<input type="checkbox"/>
NOTICE OF INTENTION TO CHANGE PLANS	<input type="checkbox"/>	SUBSEQUENT REPORT OF SHOOTING OR ACIDIZING	<input type="checkbox"/>
NOTICE OF INTENTION TO TEST WATER SHUT-OFF	<input type="checkbox"/>	SUBSEQUENT REPORT OF ALTERING CASING	<input type="checkbox"/>
NOTICE OF INTENTION TO RE-DRILL OR REPAIR WELL	<input type="checkbox"/>	SUBSEQUENT REPORT OF RE-DRILLING OR REPAIR	<input type="checkbox"/>
NOTICE OF INTENTION TO SHOOT OR ACIDIZE	<input type="checkbox"/>	SUBSEQUENT REPORT OF ABANDONMENT	<input type="checkbox"/>
NOTICE OF INTENTION TO PULL OR ALTER CASING	<input type="checkbox"/>	SUPPLEMENTARY WELL HISTORY	<input type="checkbox"/>
NOTICE OF INTENTION TO ABANDON WELL	<input type="checkbox"/>		<input type="checkbox"/>

(INDICATE ABOVE BY CHECK MARK NATURE OF REPORT, NOTICE, OR OTHER DATA)

Hobbs, New Mexico - November 28, 1961

Lea "B"
Well No. 14 is located 2130 ft. from S line and 660 ft. from E line of sec. 23

NW/4 SW/4 Sec. 23 17-S 31-E N.M.P.M.
(1/4 Sec. and Sec. No.) (Twp.) (Range) (Meridian)

Grayburg Jackson Eddy New Mexico
(Field) (County or Subdivision) (State or Territory)

RECEIVED

The elevation of the derrick floor above sea level is _____ ft.

NOV 29 1961

DETAILS OF WORK

**U. S. GEOLOGICAL SURVEY
ARTERIA, NEW MEXICO**

(State names of and expected depths to objective sands; show sizes, weights, and lengths of proposed casings; indicate casing points, and all other important proposed work)

Propose to drill with Rotary Tools using gas from surface to total depth of approx. 3850' in the San Andres Formation. Casing program to be approx. as follows:

<u>Size Hole</u>	<u>Size Casing</u>	<u>Casing Point</u>	<u>Sacks Cement</u>
<u>11"</u>	<u>8-9/8"</u>	<u>750'</u>	<u>100</u>
<u>7-7/8"</u>	<u>4-1/2"</u>	<u>3850'</u>	<u>385</u>

The pump & plug process will be used in cementing both strings of casing. The well will be perforated and treated with approx. 1500 bbls. lse. oil and approx. 60,000# 20/40 sand.

I understand that this plan of work must receive approval in writing by the Geological Survey before operations may be commenced.

Company Skelly Oil Company

Address Rox 38

Hobbs, New Mexico

By J E Aab

Title Dist. Supt.

NEW MEXICO OIL CONSERVATION COMMISSION
WELL LOCATION AND ACREAGE DEDICATION PLAT

FORM C-128
Revised 5/1/57

SEE INSTRUCTIONS FOR COMPLETING THIS FORM ON THE REVERSE SIDE

SECTION A

Operator Skelly Oil Co.		Lease Lea "B"		Well No. 14
Unit Letter L	Section 23	Township 17 South	Range 31 East	County Bddy
Actual Footage Location of Well: 660 feet from the West line and 2130 feet from the South line				
Ground Level Elev.	Producing Formation San Andres	Pool Grayburg Jackson	Dedicated Acreage: 40 Acres	

1. Is the Operator the only owner in the dedicated acreage outlined on the plat below? YES ☒ NO ☐ ("Owner" means the person who has the right to drill into and to produce from any pool and to appropriate the production either for himself or for himself and another. (63-3-29 (e) NMSA 1935 Comp.)
2. If the answer to question one is "no," have the interests of all the owners been consolidated by communitization or otherwise? YES ☐ NO ☐ If answer is "yes," Type of Consolidation _____
3. If the answer to question two is "no," list all the owners and their respective interests below:

Owner	Land Description
	U. S. GEOLOGICAL SURVEY ARTESIA, NEW MEXICO

SECTION B

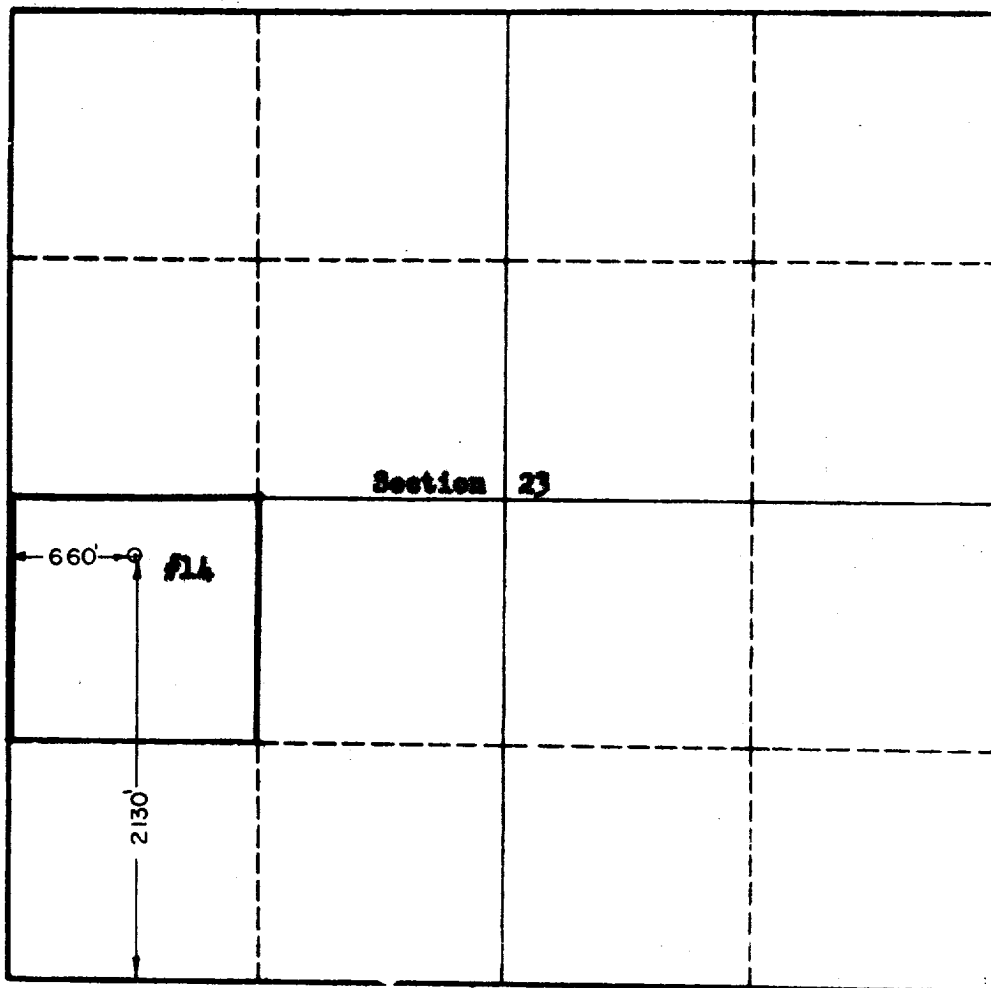

CERTIFICATION

I hereby certify that the information in SECTION A above is true and complete to the best of my knowledge and belief.

Name J. E. Galt
Position Dist. Supt.
Company Skelly Oil Company
Date November 28, 1961

I hereby certify that the well location shown on the plat in SECTION B was plotted from field notes of actual surveys made by me or under my supervision, and that the same is true and correct to the best of my knowledge and belief.

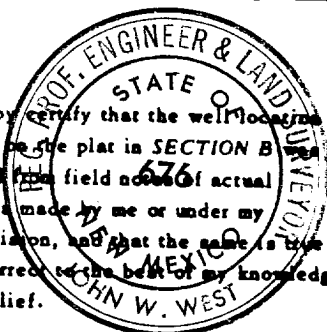

Date Surveyed 11-27-61
Registered Professional Engineer and/or Land Surveyor, JOHN W. WEST
Certificate No. N.M. - P.E. & L.S. NO. 676