

(SUBMIT IN TRIPLICATE)

UNITED STATES
DEPARTMENT OF THE INTERIOR
GEOLOGICAL SURVEY

Budget Bureau No. 42-R358.4.
Form Approved.

Land Office Las Alamos

Lease No. 11-020992 J

Unit 2

copy to

SUNDRY NOTICES AND REPORTS ON WELLS

NOTICE OF INTENTION TO DRILL	<input checked="" type="checkbox"/>	SUBSEQUENT REPORT OF WATER SHUT-OFF	
NOTICE OF INTENTION TO CHANGE PLANS		SUBSEQUENT REPORT OF SHOOTING OR ACIDIZING	
NOTICE OF INTENTION TO TEST WATER SHUT-OFF		SUBSEQUENT REPORT OF ALTERING CASING	
NOTICE OF INTENTION TO RE-DRILL OR REPAIR WELL		SUBSEQUENT REPORT OF RE-DRILLING OR REPAIR	
NOTICE OF INTENTION TO SHOOT OR ACIDIZE		SUBSEQUENT REPORT OF ABANDONMENT	
NOTICE OF INTENTION TO PULL OR ALTER CASING		SUPPLEMENTARY WELL HISTORY	
NOTICE OF INTENTION TO ABANDON WELL			

(INDICATE ABOVE BY CHECK MARK NATURE OF REPORT, NOTICE, OR OTHER DATA)

Grayburg-Jackson Unit
Well No. 5-1 is located 660 ft. from N line and 1900 ft. from E line of sec. 22
22 (1/4 Sec. and Sec. No.) 17-0 30-E N.H.P.M.
Grayburg-Jackson (Twp.) (Range) (Meridian)
Edly (County or Subdivision) New Mexico (State or Territory)

The elevation of the derrick floor above sea level is 3625 ft.

DETAILS OF WORK

(State names of and expected depths to objective sands; show sizes, weights, and lengths of proposed casings; indicate mudding jobs, cementing points, and all other important proposed work)

This well to be drilled for water injection - Under Water Flood Development
Order NO. 1-2323
Well will be drilled to Approx. 3100' and new 4" casing will be cemented to surface and perforated in Zone 6 (Premier Sand)

RECEIVED
FEB 19 1964
D. C. C.
ARTESIA OFFICE

I understand that this plan of work must receive approval in writing by the Geological Survey before operations may be commenced.

Company Ambassador Oil Corporation

Address Fort Worth, Texas

Local - Box 260

Artesia, New Mexico

By [Signature]
Title Superintendent

NUMBER OF COPIES RECEIVED	
DISTRIBUTION	
SANTA FE	
FILE	
U.S.G.S	
LAND OFFICE	
TRANSPORTER	OIL GAS
PROBATION OFFICE	
OPERATOR	

NEW MEXICO OIL CONSERVATION COMMISSION
WELL LOCATION AND ACREAGE DEDICATION PLAT
 SEE INSTRUCTIONS FOR COMPLETING THIS FORM ON THE REVERSE SIDE

FORM C-128
 Revised 5/1/57

10758
 30-015 ~~03276~~

SECTION A

Operator Ambassador Oil Corp.			Lease Grayburg-Jackson Unit		Well No. 5-1
Unit Letter H	Section 22	Township T-17-S	Range R-30-E	County Eddy	
Actual Footage Location of Well: 660 feet from the South line and 1980 feet from the West line					
Ground Level Elev. 3625	Producing Formation Grayburg		Pool Grayburg - Jackson		Dedicated Acreage: 40 Acres

1. Is the Operator the only owner in the dedicated acreage outlined on the plat below? YES _____ NO **X**. ("Owner" means the person who has the right to drill into and to produce from any pool and to appropriate the production either for himself or for himself and another. (65-3-29 (e) NMSA 1935 Comp.)
2. If the answer to question one is "no," have the interests of all the owners been consolidated by communitization agreement or otherwise? YES **X** NO _____. If answer is "yes," Type of Consolidation **Water Flood Unit Order #R2323**
3. If the answer to question two is "no," list all the owners and their respective interests below:

Owner	Land Description

RECEIVED
 FEB 19 1964
 D. C. C.
 REGISTRATION OFFICE

SECTION B

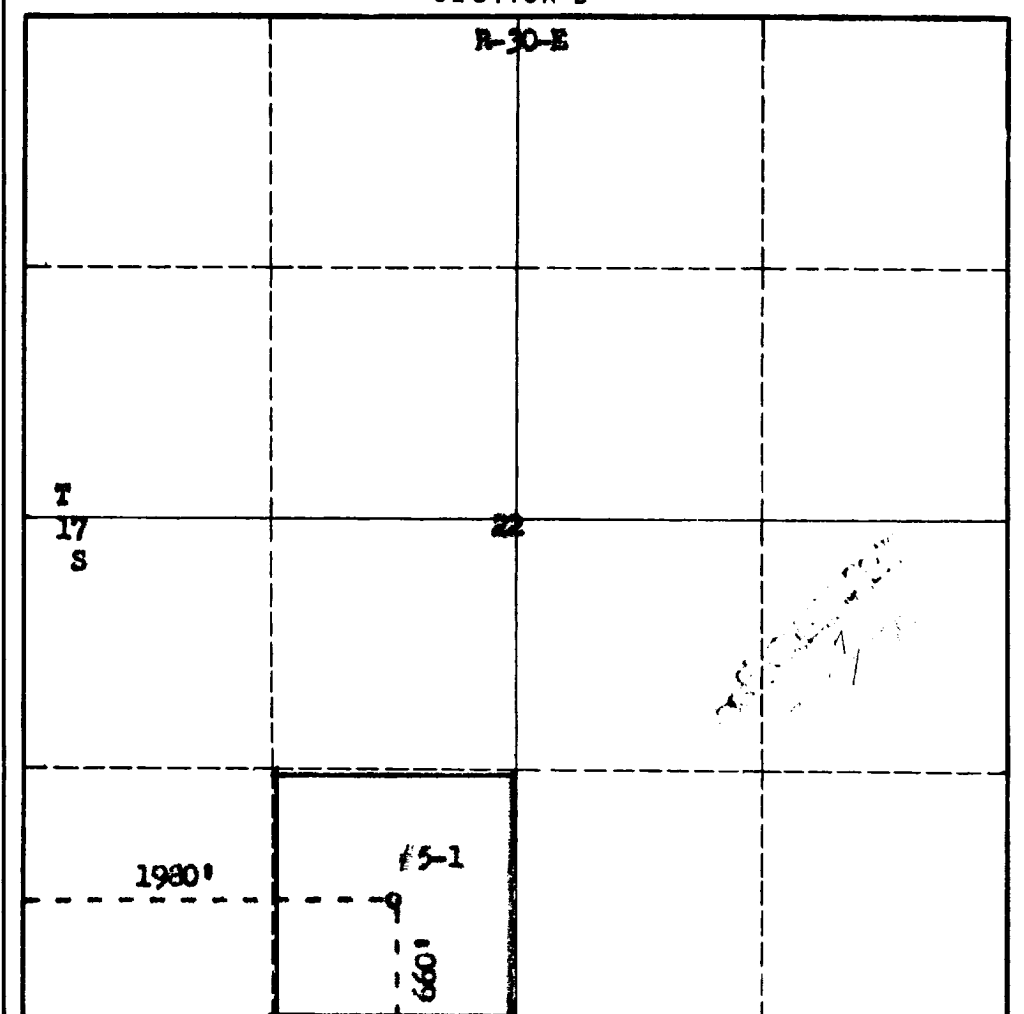

CERTIFICATION

I hereby certify that the information in SECTION A above is true and complete to the best of my knowledge and belief.

Name
Position
Company
Date

I hereby certify that the well location shown on the plat in SECTION B was plotted from field notes of actual surveys made by me or under my supervision, and that the same is true and correct to the best of my knowledge and belief.

Date Surveyed February 13, 1964
Registered Professional Engineer and/or Land Surveyor <i>James H. Loran</i>
Certificate No. 542

INSTRUCTIONS FOR COMPLETION OF FORM C-128

1. Operator shall furnish and certify to the information called for in Section A.
2. Operator shall outline the dedicated acreage for *both* oil and gas wells on the plat in Section B.
3. A registered professional engineer or land surveyor registered in the State of New Mexico or approved by the Commission shall show on the plat the location of the well and certify this information in the space provided.
4. All distances shown on the plat must be from the outer boundaries of the Section.
5. If additional space is needed for listing owners and their respective interests as required in question 3 of Section A, please use space below.