

NO. OF COPIES RECEIVED	6
DISTRIBUTION	
SANTA FE	1
FILE	1-
U.S.G.S.	2
LAND OFFICE	1
OPERATOR	1

# NEW MEXICO OIL CONSERVATION COMMISSION

30-015-10796

Form C-101  
Revised 1-1-65

5A. Indicate Type of Lease
STATE <input checked="" type="checkbox"/> FEE <input type="checkbox"/>
5. State Oil & Gas Lease No.
B-255

## APPLICATION FOR PERMIT TO DRILL, DEEPEN, OR PLUG BACK

1a. Type of Work		7. Unit Agreement Name	
b. Type of Well DRILL <input checked="" type="checkbox"/> DEEPEN <input type="checkbox"/> PLUG BACK <input type="checkbox"/> OIL WELL <input checked="" type="checkbox"/> GAS WELL <input type="checkbox"/> OTHER <input type="checkbox"/> SINGLE ZONE <input checked="" type="checkbox"/> MULTIPLE ZONE <input type="checkbox"/>		8. Farm or Lease Name State "K"	
2. Name of Operator Tenneco Oil Company		9. Well No. 15	
3. Address of Operator P. O. Box 1031 Midland, Texas		10. Field and Pool, or Wildcat Grayburg Jackson	
4. Location of Well UNIT LETTER M LOCATED 660 FEET FROM THE west LINE AND 660 FEET FROM THE south LINE OF SEC. 15 TWP. 17-S RGE. 29-E NMPM		12. County Eddy	
19. Proposed Depth 2900'		19A. Formation San Andres	20. Rotary or C.T. Rotary
21. Elevations (Show whether DF, RT, etc.) 3550 GL	21A. Kind & Status Plug. Bond In Effect	21B. Drilling Contractor Leatherwood Drlg. Co.	22. Approx. Date Work will start Upon approval

23.

## PROPOSED CASING AND CEMENT PROGRAM

SIZE OF HOLE	SIZE OF CASING	WEIGHT PER FOOT	SETTING DEPTH	SACKS OF CEMENT	EST. TOP
9-7/8"	7-5/8"	24#	360	Suff to circulate	
6-3/4"	3-1/2"	5.75#	2900	Suff to cover zones of interest	

APPROVAL VALID  
FOR 90 DAYS UNLESS  
DRILLING COMMENCED,  
EXPIRES 7-23-66

RECEIVED

APR 25 1966

O. C. C.  
ARTESIA, OFFICE

See attached Prognosis

Form C-128 submitted under separate cover by Surveyor, John W. West Engineering Co.

IN ABOVE SPACE DESCRIBE PROPOSED PROGRAM: IF PROPOSAL IS TO DEEPEN OR PLUG BACK, GIVE DATA ON PRESENT PRODUCTIVE ZONE AND PROPOSED NEW PRODUCTIVE ZONE. GIVE BLOWOUT PREVENTER PROGRAM, IF ANY.

I hereby certify that the information above is true and complete to the best of my knowledge and belief.

Signed A.W. Lang Title District Production Superintendent Date April 22, 1966

(This space for State Use)

APPROVED BY ML Armstrong TITLE Oil and Gas Inspector DATE APR 25 1966

CONDITIONS OF APPROVAL, IF ANY:

2021-2022

**NEW MEXICO OIL CONSERVATION COMMISSION  
WELL LOCATION AND ACREAGE DEDICATION PLAT**

Form C-102  
Supersedes C-138  
Effective 1-1-65

All distances must be from the outer boundaries of the Section.

Operator <b>TENNECO OIL COMPANY</b>			Lease <b>STATE "K"</b>		Well No. <b>15</b>
Unit Letter <b>M</b>	Section <b>15</b>	Township <b>17 SOUTH</b>	Range <b>29 EAST</b>	County <b>EDDY</b>	
Actual Footage Location of Well: <div style="display: flex; justify-content: space-between;"> <span>660 feet from the <b>SOUTH</b> line and</span> <span>660 feet from the <b>WEST</b> line</span> </div>					
Ground Level Elev.	Producing Formation <b>SAN ANDRES-GOLITE-ZONE</b>		Pool <b>2nd. GRAYBURG JACKSON</b>	Dedicated Acreage: <b>40(SW1/4SW1/4)</b> Acres	

1. Outline the acreage dedicated to the subject well by colored pencil or hatchure marks on the plat below.
2. If more than one lease is dedicated to the well, outline each and identify the ownership thereof (both as to working interest and royalty).
3. If more than one lease of different ownership is dedicated to the well, have the interests of all owners been consolidated by communitization, unitization, force-pooling, etc?

☐ Yes   ☐ No   If answer is "yes," type of consolidation \_\_\_\_\_

If answer is "no," list the owners and tract descriptions which have actually been consolidated (by communitization, unitization, forced-pooling, or otherwise) or until a non-standard unit, eliminating such interests, has been approved by the Commission. \_\_\_\_\_

No allowable will be assigned to the well until all interests have been consolidated (by communitization, unitization, forced-pooling, or otherwise) or until a non-standard unit, eliminating such interests, has been approved by the Commission.

**RECEIVED**

**APR 25 1966**

**O. C. C.**

ADDRESS OFFICE

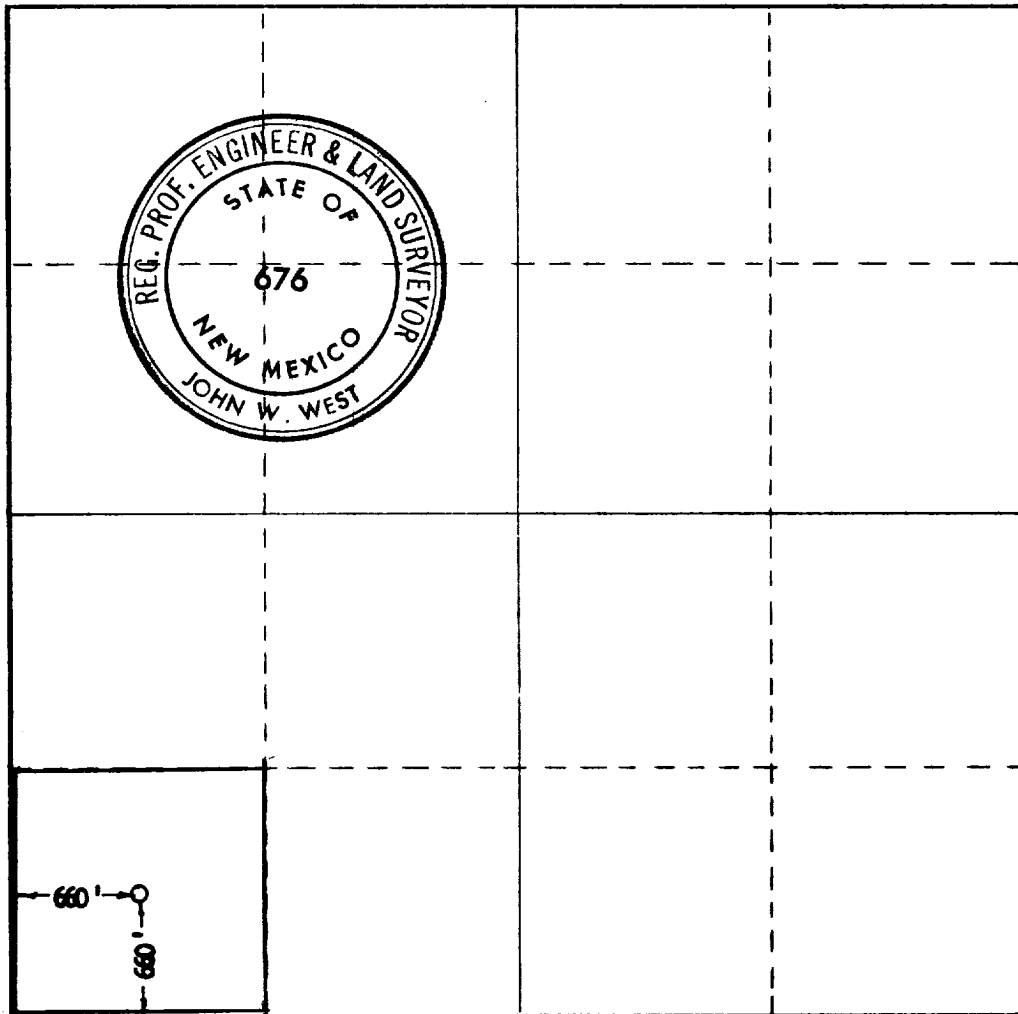

**CERTIFICATION**

I hereby certify that the information contained herein is true and complete to the best of my knowledge and belief.

Name *John W West*

Position  
**AGENT**

Company  
**TENNECO OIL CO.**

Date  
**4/23/66**

I hereby certify that the well location shown on this plat was plotted from field notes of actual surveys made by me or under my supervision, and that the same is true and correct to the best of my knowledge and belief.

Date Surveyed  
**4/23/66**

Registered Professional Engineer and/or Land Surveyor

*John W West*

Certificate No.

**676**

