

NO. OF COPIES RECEIVED	6
DISTRIBUTION	
SANTA FE	1
FILE	1
U.S.G.S.	2
LAND OFFICE	1
OPERATOR	1

NEW MEXICO OIL CONSERVATION COMMISSION

"CONNECTED C-101"

Form C-101
Revised 1-1-65

5A. Indicate Type of Lease	
STATE <input checked="" type="checkbox"/>	FEE <input type="checkbox"/>
5. State Oil & Gas Lease No.	
B-255	

APPLICATION FOR PERMIT TO DRILL, DEEPEN, OR PLUG BACK

1a. Type of Work		7. Unit Agreement Name	
b. Type of Well DRILL <input checked="" type="checkbox"/> DEEPEN <input type="checkbox"/> PLUG BACK <input type="checkbox"/>		8. Farm or Lease Name	
OIL WELL <input checked="" type="checkbox"/> GAS WELL <input type="checkbox"/> OTHER <input type="checkbox"/>		State "K"	
2. Name of Operator		9. Well No.	
Tennessee Oil Company		15	
3. Address of Operator		10. Field and Pool, or Wildcat	
P. O. Box 1031 Midland, Texas		Grayburg Jackson	
4. Location of Well		12. County	
UNIT LETTER <u>N</u> LOCATED <u>760</u> FEET FROM THE <u>West</u> LINE		Midy	
AND <u>660</u> FEET FROM THE <u>South</u> LINE OF SEC. <u>15</u> TWP. <u>17-S</u> RGE. <u>29E</u> NMPM			
19. Proposed Depth		19A. Formation	
2900		San Andres	
20. Rotary or C.T.		Rotary	
21. Elevations (Show whether DF, RT, etc.)		21B. Drilling Contractor	
3550 GL		Lee Sherwood Drlg. Co.	
21A. Kind & Status Plug. Bond		22. Approx. Date Work will start	
In Effect		Upon approval	

23.

PROPOSED CASING AND CEMENT PROGRAM

SIZE OF HOLE	SIZE OF CASING	WEIGHT PER FOOT	SETTING DEPTH	SACKS OF CEMENT	EST. TOP
9-7/8"	7-5/8"	24#	360	Suff to circulate	
6-3/4"	3-1/8"	5.75#	2900	Suff to cover zones of interest	

"To correct Footage from west line of section."

RECEIVED

APPROVAL VALID
FOR 90 DAYS UNLESS
DRILLING COMMENCED,

EXPIRES 7-24-66

APR 23 1966

F. B. D.
ARTS & CRAFTS, OFFICE

Form C-128 submitted under separate cover by Surveyor, John W. West Eng. Co.

IN ABOVE SPACE DESCRIBE PROPOSED PROGRAM: IF PROPOSAL IS TO DEEPEN OR PLUG BACK, GIVE DATA ON PRESENT PRODUCTIVE ZONE AND PROPOSED NEW PRODUCTIVE ZONE. GIVE BLOWOUT PREVENTER PROGRAM, IF ANY.

I hereby certify that the information above is true and complete to the best of my knowledge and belief.

Signed A.W. Lang Title District Production Superintendent April 25, 1966

(This space for State Use)

APPROVED BY R. L. Stamm TITLE OIL AND GAS INSPECTOR DATE APR 26 1966

CONDITIONS OF APPROVAL, IF ANY:

NEW MEXICO OIL CONSERVATION COMMISSION
WELL LOCATION AND ACREAGE DEDICATION PLAT

Form C-102
Supersedes C-128
Effective 1-1-65

All distances must be from the outer boundaries of the Section.

Operator TENNECO OIL COMPANY		Lease STATE K		Well No. 15	
Unit Letter M	Section 15	Township 17 SOUTH	Range 29 EAST	County EDDY	
Actual Footage Location of Well: 660 feet from the SOUTH line and 760 feet from the WEST line					
Ground Level Elev.	Producing Formation SAN ANDRES-OOLITIC ZONE		Pool GRAYBURG JACKSON	Dedicated Acreage: 40(SW1/4SW1/4) Acres	

1. Outline the acreage dedicated to the subject well by colored pencil or hatchure marks on the plat below.
2. If more than one lease is dedicated to the well, outline each and identify the ownership thereof (both as to working interest and royalty).
3. If more than one lease of different ownership is dedicated to the well, have the interests of all owners been consolidated by communitization, unitization, force-pooling, etc?

☐ Yes ☐ No If answer is "yes," type of consolidation _____

RECEIVED
APR 26 1966

O. C. C.

If answer is "no," list the owners and tract descriptions which have actually been consolidated (Use reverse side of this form if necessary.) _____

No allowable will be assigned to the well until all interests have been consolidated (by communitization, unitization, forced-pooling, or otherwise) or until a non-standard unit, eliminating such interests, has been approved by the Commission.

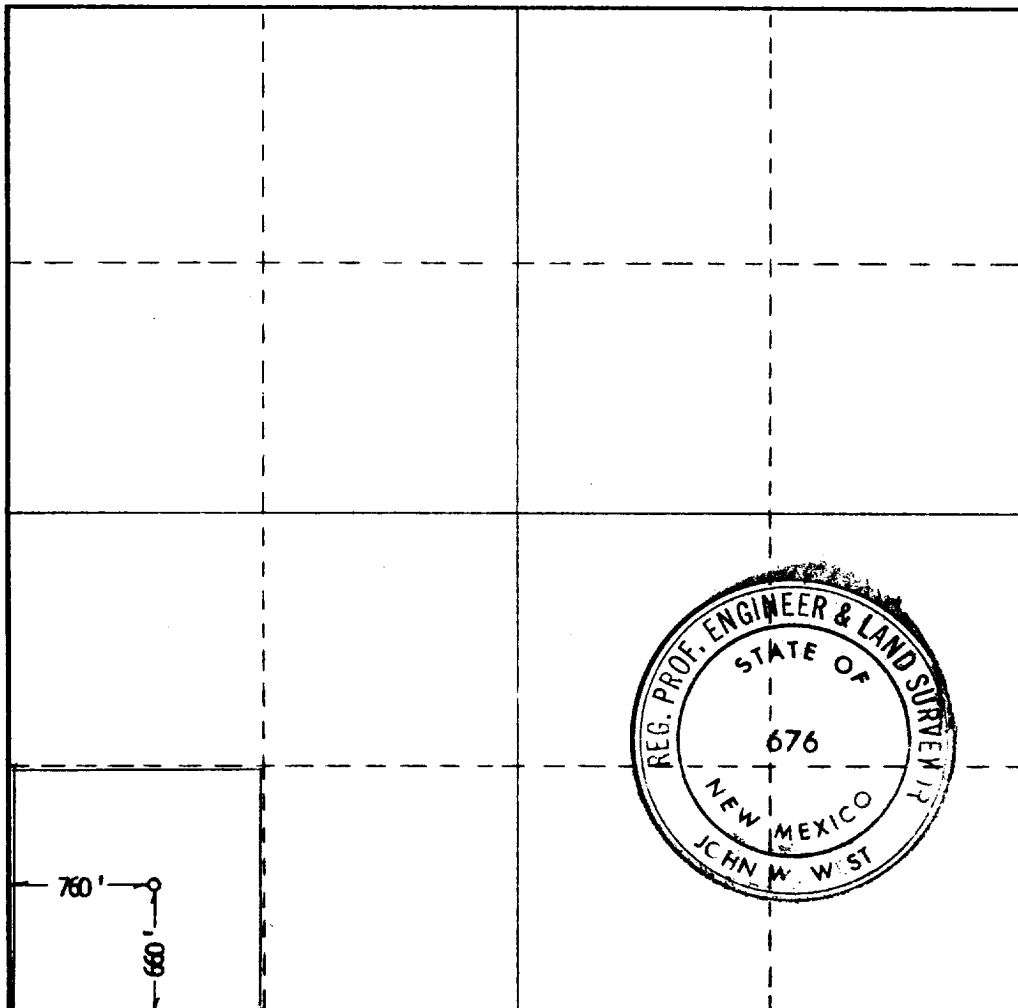

CERTIFICATION

I hereby certify that the information contained herein is true and complete to the best of my knowledge and belief.

Name *John W. West*
Position

AGENT

Company

TENNECO OIL COMPANY

Date

4/25/66

I hereby certify that the well location shown on this plat was plotted from field notes of actual surveys made by me or under my supervision, and that the same is true and correct to the best of my knowledge and belief.

Date Surveyed

4/25/66

Registered Professional Engineer and/or Land Surveyor

John W. West
Certificate No.

676

0 330 660 990 1320 1650 1980 2310 2640 2000 1500 1000 500 0

