

COPIES RECEIVED	
DISTRIBUTION	
SANTA FE	
FILE	
U.S.G.S.	
LAND OFFICE	
OPERATOR	

NEW MEXICO OIL CONSERVATION COMMISSION

Form C-101
Revised 1-1-65

RECEIVED

NOV 24 1971

O.C.C.

ARTERIA, OFFICE

APPLICATION FOR PERMIT TO DRILL, DEEPEN, OR PLUG BACK

1a. Type of Work DRILL <input checked="" type="checkbox"/> DEEPEN <input type="checkbox"/> PLUG BACK <input type="checkbox"/>		7. Unit Agreement Name -	
b. Type of Well OIL WELL <input checked="" type="checkbox"/> GAS WELL <input type="checkbox"/> OTHER <input type="checkbox"/> SINGLE ZONE <input checked="" type="checkbox"/> MULTIPLE ZONE <input type="checkbox"/>		8. Farm or Lease Name Etz B State	
2. Name of Operator Texas American Oil Corporation		9. Well No. 18	
3. Address of Operator 1012 Midland Savings Bldg., Midland, Texas 79701		10. Field and Pool, or Wildcat Grayburg Jackson	
4. Location of Well UNIT LETTER G LOCATED 1980 FEET FROM THE North LINE AND 1980 FEET FROM THE East LINE OF SEC. 16 TWP. 17S RGE. 30E NMPM		12. County Eddy	
21. Elevations (Show whether DF, RT, etc.) 3679 GR		22. Approx. Date Work will start January 20, 1972	
21A. Kind & Status Plug. Bond J.S. Ward & Son		21B. Drilling Contractor WEK Drilling Company	
19. Proposed Depth 3350'		19A. Formation Grayburg Jackson	
20. Rotary or C.T. Rotary			

23.

PROPOSED CASING AND CEMENT PROGRAM

SIZE OF HOLE	SIZE OF CASING	WEIGHT PER FOOT	SETTING DEPTH	SACKS OF CEMENT	EST. TOP
11"	8-5/8"	20#	525	150 sx.	Circ.
7-7/8"	4-1/2"	9.50#	3300	450 sx.	1800

APPROVAL VALID
FOR 90 DAYS UNLESS
DRILLING COMMENCED,

EXPIRES 3-1-72

IN ABOVE SPACE DESCRIBE PROPOSED PROGRAM: IF PROPOSAL IS TO DEEPEN OR PLUG BACK, GIVE DATA ON PRESENT PRODUCTIVE ZONE AND PROPOSED NEW PRODUCTIVE ZONE. GIVE BLOWOUT PREVENTER PROGRAM, IF ANY.

I hereby certify that the information above is true and complete to the best of my knowledge and belief.

Signed Roy K. Valla Title Production Manager Date November 23, 1971

(This space for State Use)

APPROVED BY W. A. Gussert TITLE OIL AND GAS INSPECTOR DATE DEC 1 1971

CONDITIONS OF APPROVAL, IF ANY:

MEXICO OIL CONSERVATION COMMISS
WELL LOCATION AND ACREAGE DEDICATION PLAT

Form C-102
 Supersedes C-128
 Effective 1-1-65

All distances must be from the outer boundaries of the Section.

Operator <i>Grayburg Jackson</i>			Lease <i>1980</i>		Well No. <i>1-1</i>
Unit Letter G	Section <i>15</i>	Township 17 S.	Range <i>10 E.</i>	County Box	
Actual Footage Location of Well: <i>1980</i> feet from the <i>1980</i> line and <i>1980</i> feet from the <i>1980</i> line					
Ground Level Elev. <i>579</i>	Producing Formation <i>SA</i> Grayburg Jackson	Pool Grayburg Jackson	Dedicated Acreage; <i>40</i> Acres		

1. Outline the acreage dedicated to the subject well by colored pencil or hachure marks on the plat below.
2. If more than one lease is dedicated to the well, outline each and identify the ownership thereof (both as to working interest and royalty).
3. If more than one lease of different ownership is dedicated to the well, have the interests of all owners been consolidated by communitization, unitization, force-pooling, etc?

☐ Yes ☐ No If answer is "yes;" type of consolidation _____

If answer is "no," list the owners and tract descriptions which have actually been consolidated. (Use reverse side of this form if necessary.) _____

No allowable will be assigned to the well until all interests have been consolidated (by communitization, unitization, forced-pooling, or otherwise) or until a non-standard unit, eliminating such interests, has been approved by the Commission.

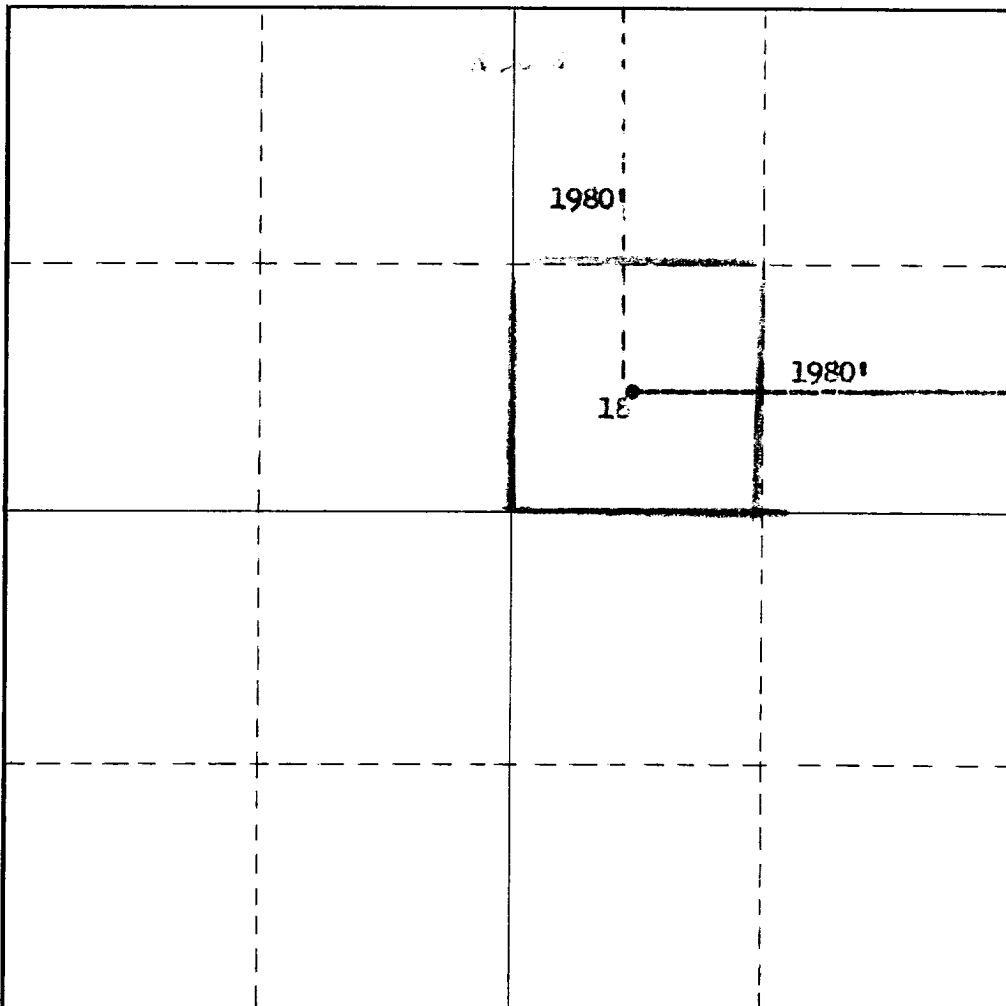

CERTIFICATION

I hereby certify that the information contained herein is true and complete to the best of my knowledge and belief.

Name *Roy K. Valla*
 Position **Production Manager**
 Company **Texas American Oil Corp.**
 Date **November 23, 1971**

I hereby certify that the well location shown on this plat was plotted from field notes of actual surveys made by me or under my supervision, and that the same is true and correct to the best of my knowledge and belief.

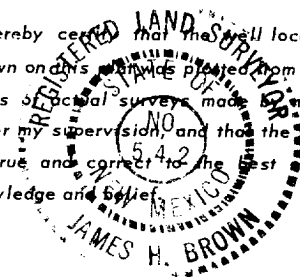

Date Surveyed _____

Registered Professional Engineer and/or Land Surveyor

James H. Brown
 Certificate No. *542*

0 330 660 990 1320 1650 1980 2310 2640 2970 3300 3630 3960 4290 4620 4950 5280 5610 5940 6270 6600