

UNITED STATES
DEPARTMENT OF THE INTERIOR
GEOLOGICAL SURVEY

APPLICATION FOR PERMIT TO DRILL, DEEPEN, OR PLUG BACK

1a. TYPE OF WORK DRILL <input checked="" type="checkbox"/> DEEPEN <input type="checkbox"/> PLUG BACK <input type="checkbox"/>		5. LEASE DESIGNATION AND SERIAL NO. LC 02948(b)	
b. TYPE OF WELL OIL WELL <input checked="" type="checkbox"/> GAS WELL <input type="checkbox"/> OTHER <input type="checkbox"/> SINGLE ZONE <input type="checkbox"/> MULTIPLE ZONE <input type="checkbox"/>		6. IF INDIAN, ALLOTTEE OR TRIBE NAME ---	
2. NAME OF OPERATOR Skelly Oil Company		7. UNIT AGREEMENT NAME Skelly Unit	
3. ADDRESS OF OPERATOR P. O. Box 1351, Midland, Texas 79701		8. FARM OR LEASE NAME Skelly Unit	
4. LOCATION OF WELL (Report location clearly and in accordance with any State requirements.*) At surface 660' from North Line, 660' from East Line, Sec. 14, T-17S, R-31E At proposed prod. zone		9. WELL NO. 112	
14. DISTANCE IN MILES AND DIRECTION FROM NEAREST TOWN OR POST OFFICE* ---		10. FIELD AND POOL, OR WILDCAT Grayburg-Jackson X	
10. DISTANCE FROM PROPOSED* LOCATION TO NEAREST PROPERTY OR LEASE LINE, FT. (Also to nearest drig. unit line, if any) ---		11. SEC., T., R., M., OR BLK. AND SURVEY OR AREA Sec. 14-17S-31E	
18. DISTANCE FROM PROPOSED LOCATION* TO NEAREST WELL, DRILLING, COMPLETED, OR APPLIED FOR, ON THIS LEASE, FT. ---		12. COUNTY OR PARISH Eddy	
16. NO. OF ACRES IN LEASE 5200		13. STATE New Mexico	
17. NO. OF ACRES ASSIGNED TO THIS WELL 40		20. ROTARY OR CABLE TOOLS Rotary	
21. ELEVATIONS (Show whether DF, RT, GR, etc.) Unknown		22. APPROX. DATE WORK WILL START* Immediately	

PROPOSED CASING AND CEMENTING PROGRAM

SIZE OF HOLE	SIZE OF CASING	WEIGHT PER FOOT	SETTING DEPTH	QUANTITY OF CEMENT
11"	8-5/8"	24#	630'	350 sacks
7-7/8"	5-1/2"	14#	3920'	850 sacks

We propose to drill with rotary tools from surface to total depth of approximately 3920' and complete in the Grayburg-Jackson pool.

The pump and plug process will be used in cementing all strings of casing. The 8-5/8" will be set at approximately 630' and cemented to surface behind pipe. The 5-1/2" OD casing will be perforated at approximately 3300' to 3800' and will be stimulated.

RECEIVED

DEC 10 1971

O. C. C.

ARTESIA, OFFICE

RECEIVED
DEC 8 1971
U. S. GEOLOGICAL SURVEY
ARTESIA, NEW MEXICO

IN ABOVE SPACE DESCRIBE PROPOSED PROGRAM: If proposal is to deepen or plug back, give data on present productive zone and proposed new productive zone. If proposal is to drill or deepen directionally, give pertinent data on subsurface locations and measured and true vertical depths. Give blowout preventer program, if any.

24. SIGNED (Signed) C. J. LOVE TITLE Dist. Production Manager DATE Dec. 7, 1971

(This space for Federal or State office use)

PERMIT NO. APPROVAL DATE DEC 8 1971

APPROVED BY [Signature] TITLE DISTRICT ENGINEER DATE DEC 8 1971

CONDITIONS OF APPROVAL, IF ANY:

Instructions

General: This form is designed for submitting proposals to perform certain well operations, as indicated, on all types of lands and leases for appropriate action by either a Federal or a State agency, or both, pursuant to applicable Federal and/or State laws and regulations. Any necessary special instructions concerning the use of this form and the number of copies to be submitted, particularly with regard to local, area, or regional procedures and practices, either are shown below or will be issued by, or may be obtained from, the local Federal and/or State office.

Item 1: If the proposal is to redrill to the same reservoir at a different subsurface location or to a new reservoir, use this form with appropriate notations. Consult applicable State or Federal regulations concerning subsequent work proposals or reports on the well.

Item 4: If there are no applicable State requirements, locations on Federal or Indian land should be described in accordance with Federal requirements. Consult local State or Federal office for specific instructions.

Item 14: Needed only when locations of well cannot readily be found by road from the land or lease description. A plat, or plats, separate or on this reverse side, showing the roads to, and the surveyed location of, the well, and any other required information, should be furnished when required by Federal or State agency offices.

Items 15 and 18: If well is to be, or has been directionally drilled, give distances for subsurface location of hole in any present or objective production zone.

Item 22: Consult applicable Federal or State regulations, or appropriate officials, concerning approval of the proposal before operations are started.

**NEW MEXICO OIL CONSERVATION COMMISSION
WELL LOCATION AND ACREAGE DEDICATION PLAT**

Form C-102
Supersedes C-128
Effective 1-1-65

All distances must be from the outer boundaries of the Section.

Operator SKELLY OIL CO			Lease SKELLY UNIT		Well No. 112
Unit Letter A	Section 14	Township 17 SOUTH	Range 31 EAST	County EDDY	
Actual Footage Location of Well:					
660 feet from the NORTH line and		660 feet from the EAST line			
Ground Level Elev. Unknown	Producing Formation Crayburg and San Andres	Pool Crayburg-Jackson	Dedicated Acreage: 40 Acres		

1. Outline the acreage dedicated to the subject well by colored pencil or hatchure marks on the plat below.
2. If more than one lease is dedicated to the well, outline each and identify the ownership thereof (both as to working interest and royalty).
3. If more than one lease of different ownership is dedicated to the well, have the interests of all owners been consolidated by communitization, unitization, force-pooling, etc?

☐ Yes ☐ No If answer is "yes," type of consolidation _____

If answer is "no," list the owners and tract descriptions which have actually been consolidated. (Use reverse side of this form if necessary.) _____

No allowable will be assigned to the well until all interests have been consolidated (by communitization, unitization, forced-pooling, or otherwise) or until a non-standard unit, eliminating such interests, has been approved by the Commission.

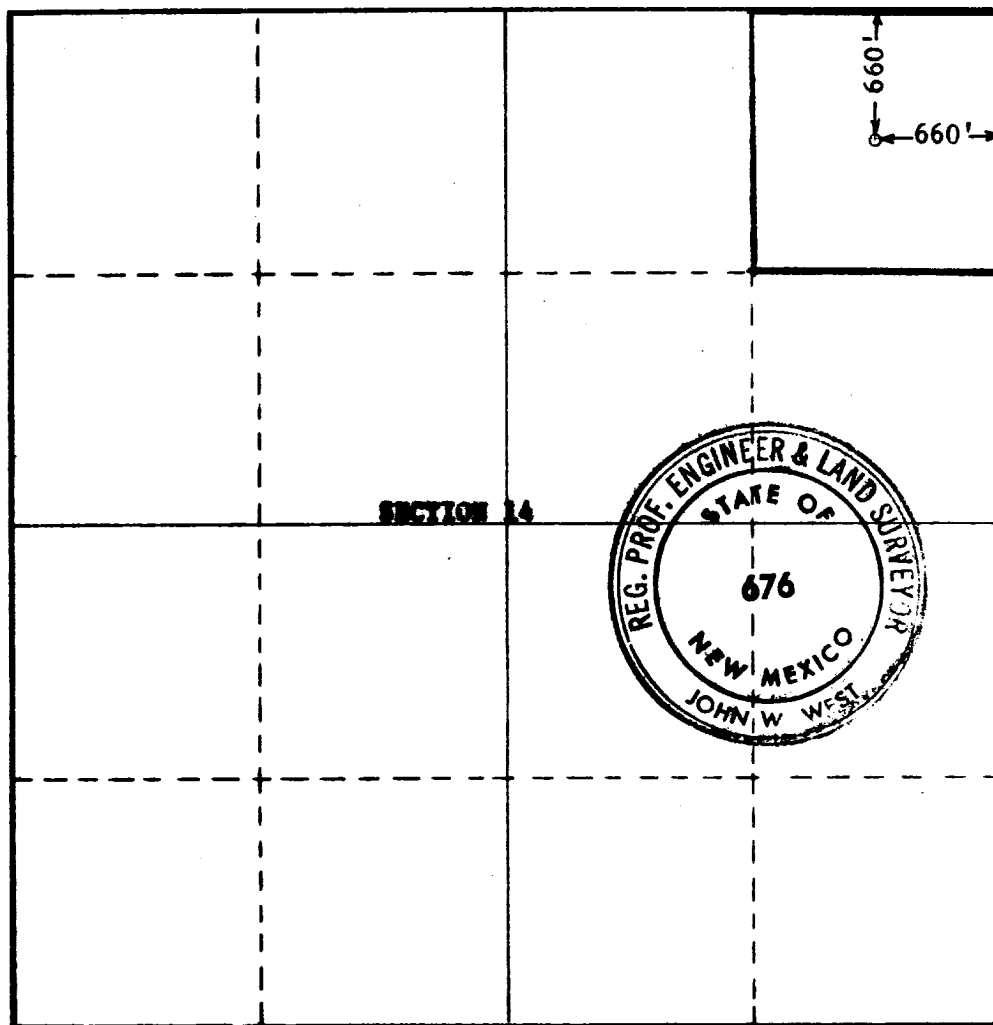

CERTIFICATION

I hereby certify that the information contained herein is true and complete to the best of my knowledge and belief.

Name C. J. Love
 Position **District Production Manager**
 Company **Skelly Oil Company**
 Date **December 7, 1971**

I hereby certify that the well location shown on this plat was plotted from field notes of actual survey made by me or under my supervision and that the same is true and correct to the best of my knowledge.

**RECEIVED
DEC 8 1971
U.S. GEOLOGICAL SURVEY
ARTESIA, NEW MEXICO**

Date Surveyed **DECEMBER 3, 1971**
 Registered Professional Engineer and/or Land Surveyor

John W. West
 Certificate No. **676**

