

NEW MEXICO CONSERVATION COMMISSION  
WELL LOCATION AND ACREAGE DEDICATION

RECEIVED  
C-102  
Supersedes C-128  
Effective 1-1-65

All distances must be from the outer boundaries of the Section.

NOV 1 1972

Operator <i>J. Cecil Rhodes &amp; Panoil Exploration</i>		Lease <b>ANDERSON FEDERAL</b>		Well No. <b>1</b>
Unit Letter <b>O</b>	Section <b>7</b>	Township <b>17 SOUTH</b>	Range <b>30 EAST</b>	County <b>EDDY</b>
Actual Footage Location of Well: <b>660</b> feet from the <b>SOUTH</b> line and <b>1980</b> feet from the <b>EAST</b> line				
Ground Level Elev. <b>3662</b>	Producing Formation <b>PENN</b>	Pool <i>Anderson Brn</i> <b>Wildcat</b>	Dedicated Acreage: <b>160</b>	

1. Outline the acreage dedicated to the subject well by colored pencil or hachure marks on the plat below.
2. If more than one lease is dedicated to the well, outline each and identify the ownership thereof (both as to working interest and royalty).
3. If more than one lease of different ownership is dedicated to the well, have the interests of all owners been consolidated by communitization, unitization, force-pooling, etc?

☐ Yes ☒ No

If answer is "yes," type of consolidation

*ONE LEASE*  
~~Leases to be communitized in event of commercial well.~~

If answer is "no," list the owners and tract descriptions which have actually been consolidated. (Use reverse side of this form if necessary.)

No allowable will be assigned to the well until all interests have been consolidated (by communitization, unitization, forced-pooling, or otherwise) or until a non-standard unit, eliminating such interests, has been approved by the Commission.

CERTIFICATION

I hereby certify that the information contained herein is true and complete to the best of my knowledge and belief.

Name  
**K. D. McPeters**  
Position  
**Agent**  
Company  
**J. Cecil Rhodes & Panoil Exploration, Inc.**  
Date  
**12-28-71**

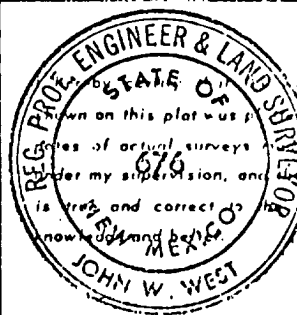

Date Surveyed  
**DECEMBER 23, 1971**

Registered Professional Engineer and/or Land Surveyor

*John W. West*  
Certificate No. **676**

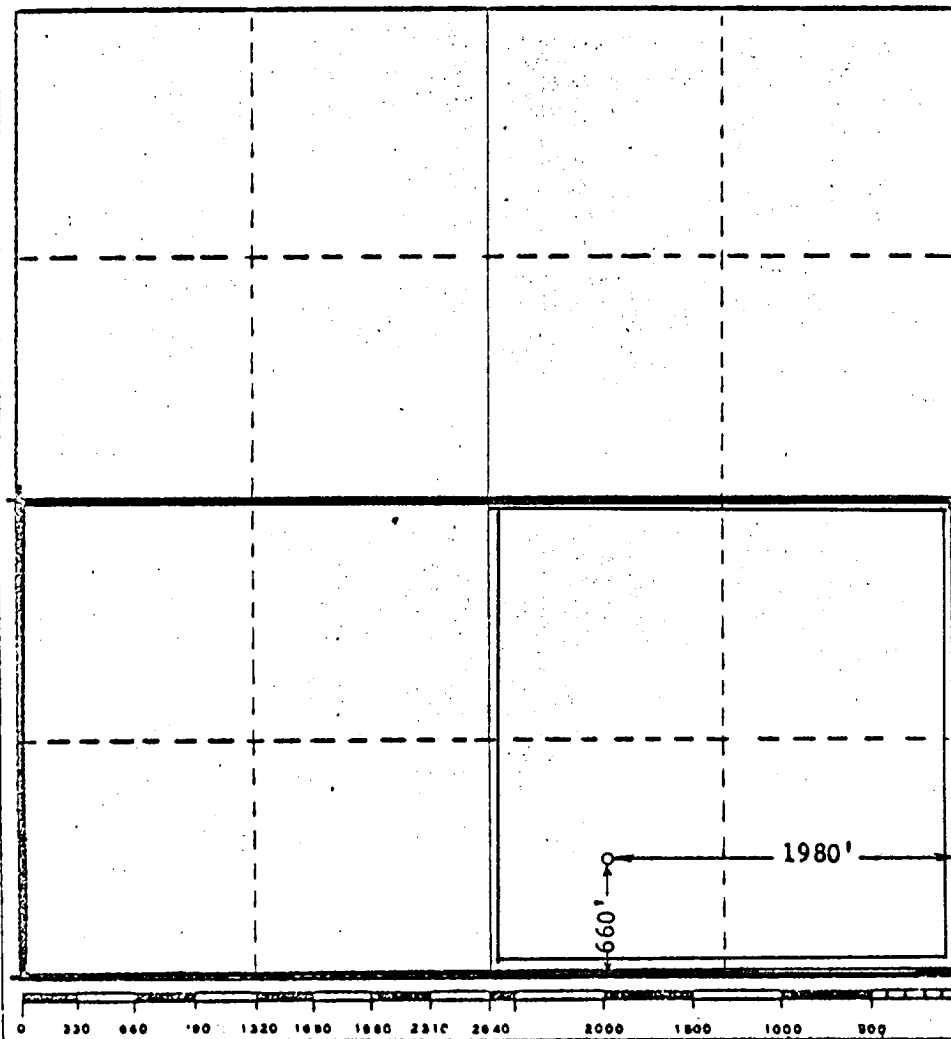

CHANGED TO INDICATE 160 ACRE SPACING UNIT  
RATHER THAN 320 AS ORIGINALLY FILED