

UNITED STATES  
DEPARTMENT OF THE INTERIOR  
GEOLOGICAL SURVEY

APPLICATION FOR PERMIT TO DRILL, DEEPEN, OR PLUG BACK

1a. TYPE OF WORK  
DRILL ☒ DEEPEN ☐ PLUG BACK ☐  
b. TYPE OF WELL  
OIL WELL ☒ GAS WELL ☐ OTHER ☐ SINGLE ZONE ☐ MULTIPLE ZONE ☐

2. NAME OF OPERATOR  
Texas American Oil Corporation

3. ADDRESS OF OPERATOR  
1012 Midland Savings Building, Midland, Texas 79701

4. LOCATION OF WELL (Report location clearly and in accordance with any State requirements)  
At surface  
660' FNL & 1980' FEL, Sec 17-17S-30E  
At proposed prod. zone

14. DISTANCE IN MILES AND DIRECTION FROM NEAREST TOWN OR POST OFFICE\*  
1 Mile north Loco Hills

15. DISTANCE FROM PROPOSED\*  
LOCATION TO NEAREST  
PROPERTY OR LEASE LINE, FT.  
(Also to nearest drlg. unit line, if any) 660

18. DISTANCE FROM PROPOSED LOCATION\*  
TO NEAREST WELL, DRILLING, COMPLETED,  
OR APPLIED FOR, ON THIS LEASE, FT. -

21. ELEVATIONS (Show whether DF, RT, GR, etc.)  
3673 GR

23. PROPOSED CASING AND CEMENTING PROGRAM

SIZE OF HOLE	SIZE OF CASING	WEIGHT PER FOOT	SETTING DEPTH	QUANTITY OF CEMENT
11"	8-5/8"	20#	500	150 sx
7-7/8"	4-1/2"	9.50#	3300	450 sx

5. LEASE DESIGNATION AND SERIAL NO.

NM 2933

6. IF INDIAN, ALLOTTEE OR TRIBE NAME

7. UNIT AGREEMENT NAME

8. FARM OR LEASE NAME

Collier Federal

9. WELL NO.

2

10. FIELD AND POOL, OR WILDCAT

Grayburg Jackson

11. SEC., T., R., M., OR BLK.  
AND SURVEY OR AREA

17-17-30

12. COUNTY OR PARISH

Eddy

13. STATE

New Mexico

RECEIVED  
MAR 13 1972  
U. S. GEOLOGICAL SURVEY  
ARTESIA, NEW MEXICO

IN ABOVE SPACE DESCRIBE PROPOSED PROGRAM: If proposal is to deepen or plug back, give data on present productive zone and proposed new productive zone. If proposal is to drill or deepen directionally, give pertinent data on subsurface locations and measured and true vertical depths. Give blowout preventer program, if any.

24. SIGNED [Signature] TITLE Engineer DATE March 14, 1972

(This space for Federal or State office use)

PERMIT NO. APPROVAL DATE

APPROVED BY TITLE DATE

CONDITIONS OF APPROVAL, IF ANY:

\*See Instructions On Reverse Side

APPROVED  
MAR 16 1972  
R. L. BEEKMAN  
ACTING DISTRICT ENGINEER

V MEXICO OIL CONSERVATION COMMISSION  
WELL LOCATION AND ACREAGE DEDICATION PLAT

Form C-102  
Supersedes C-128  
Effective 1-1-65

All distances must be from the outer boundaries of the Section.

Operator <b>Texas American Oil Corporation</b>			Lease <b>Collier Federal</b>		Well No. <b>2</b>
Unit Letter <b>B</b>	Section <b>17</b>	Township <b>17 South</b>	Range <b>30 East</b>	County <b>Eddy</b>	
Actual Footage Location of Well: <b>660</b> feet from the <b>North</b> line and <b>1980</b> feet from the <b>East</b> line					
Ground Level Elev. <b>3673</b>	Producing Formation <b>Grayburg Jackson</b>		Pool <b>Grayburg Jackson</b>		Dedicated Acreage; <b>40</b> Acres

1. Outline the acreage dedicated to the subject well by colored pencil or hachure marks on the plat below.
2. If more than one lease is dedicated to the well, outline each and identify the ownership thereof (both as to working interest and royalty).
3. If more than one lease of different ownership is dedicated to the well, have the interests of all owners been consolidated by communitization, unitization, force-pooling, etc?

☐ Yes ☐ No If answer is "yes," type of consolidation \_\_\_\_\_

If answer is "no," list the owners and tract descriptions which have actually been consolidated. (Use reverse side of this form if necessary.) \_\_\_\_\_

No allowable will be assigned to the well until all interests have been consolidated (by communitization, unitization, forced-pooling, or otherwise) or until a non-standard unit, eliminating such interests, has been approved by the Commission.

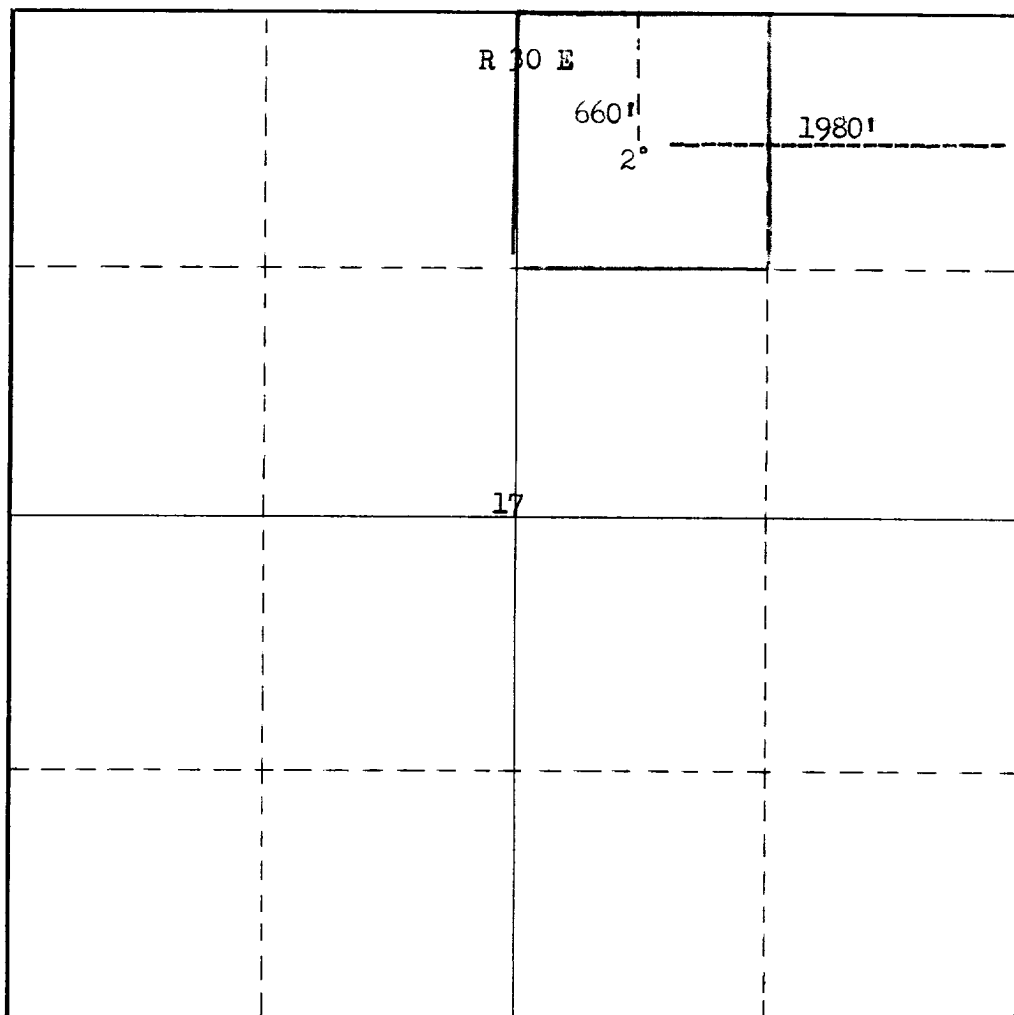

CERTIFICATION

I hereby certify that the information contained herein is true and complete to the best of my knowledge and belief.

Name  
**N. T. Emanuel**  
Position  
**Engineer**  
Company  
**Texas American Oil Corp.**  
Date  
**March 14, 1972**

I hereby certify that the location shown on this plat was plotted from field notes of actual surveys made by me or under my supervision and that the same is true and correct to the best of my knowledge and belief.

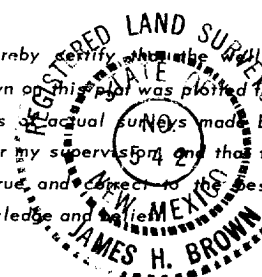

Date Surveyed  
**November 9, 1971**  
Registered Professional Engineer  
and/or Land Surveyor

Certificate No.

**542**

T  
17  
S

0 330 660 990 1320 1650 1980 2310 2640 2000 1500 1000 500