

UNITED STATES
DEPARTMENT OF THE INTERIOR
GEOLOGICAL SURVEY

APPLICATION FOR PERMIT TO DRILL, DEEPEN, OR PLUG BACK

1a. TYPE OF WORK
DRILL ☒ DEEPEN ☐ PLUG BACK ☐

b. TYPE OF WELL
OIL WELL ☒ GAS WELL ☐ OTHER ☐
SINGLE ZONE ☒ MULTIPLE ZONE ☐

2. NAME OF OPERATOR
Skelly Oil Company

3. ADDRESS OF OPERATOR
P. O. Box 1351, Midland, Texas 79701

4. LOCATION OF WELL (Report location clearly and in accordance with any State requirements.)
At surface

1980' FSL and 1980' FWL, Sec. 11-17S-31E
At proposed prod. zone

14. DISTANCE IN MILES AND DIRECTION FROM NEAREST TOWN OR POST OFFICE*

15. DISTANCE FROM PROPOSED*
LOCATION TO NEAREST
PROPERTY OR LEASE LINE, FT.
(Also to nearest drig. unit line, if any)

16. NO. OF ACRES IN LEASE
640

17. NO. OF ACRES ASSIGNED
TO THIS WELL
40

18. DISTANCE FROM PROPOSED LOCATION*
TO NEAREST WELL, DRILLING, COMPLETED,
OR APPLIED FOR, ON THIS LEASE, FT.

19. PROPOSED DEPTH
3970'

20. ROTARY OR CABLE TOOLS
Rotary

21. ELEVATIONS (Show whether DF, RT, GR, etc.)
Unknown

22. APPROX. DATE WORK WILL START*
Immediately

23. PROPOSED CASING AND CEMENTING PROGRAM

SIZE OF HOLE	SIZE OF CASING	WEIGHT PER FOOT	SETTING DEPTH	QUANTITY OF CEMENT
11"	8-5/8"	24#	650'	350
7-7/8"	5-1/2"	15.5#	3970'	850

The pump and plug process will be used in cementing all strings of casing. The 8-5/8" will be set at approximately 650' and cemented to surface behind pipe. The 5-1/2" OD casing will be cemented to surface and perforated in the Grayburg-San Andres at approximately 3200' to 3950' and will be stimulated.

Verbal approval received by telephone from Mr. R. L. Beekman 5-1-72.

RECEIVED

MAY 4 1972

RECEIVED

MAY - 3 1972

U. S. GEOLOGICAL SURVEY
ARTESIA, NEW MEXICO

IN ABOVE SPACE DESCRIBE PROPOSED PROGRAM: If proposal is to deepen or plug back, give data on present productive zone and proposed new productive zone. If proposal is to drill or deepen directionally, give pertinent data on subsurface locations and measured and true vertical depths. Give blowout preventer program, if any.

24. (Signed) C. J. LOVE

TITLE Dist. Production Manager

DATE May 1, 1972

SIGNED (This space for Federal or State office use)

PERMIT NO.

APPROVAL DATE

TITLE

DATE

APPROVED BY
COMMISSIONER OF GEOLOGY, NEW MEXICO

Verbally 5-1-72
H. L. BECKMAN
ACTING DISTRICT ENGINEER

THIS APPROVAL IS RECEIVED IF OPERATIONS
ARE NOT COMMENCED WITHIN 3 MONTHS.
AUG - 3 1972
See Instructions On Reverse Side

**N. MEXICO OIL CONSERVATION COMMISS.
WELL LOCATION AND ACREAGE DEDICATION PLAT**

Form C-102
Supersedes C-128
Effective 1-1-65

All distances must be from the outer boundaries of the Section.

Operator SKELLY OIL COMPANY			Lease LEA "C"		Well No. 8
Unit Letter K	Section 11	Township 17 SOUTH	Range 31 EAST	County EROY	
Actual Footage Location of Well:					
1980 feet from the SOUTH line and		1980 feet from the WEST line			
Ground Level Elev. Unknown	Producing Formation Grayburg-San Andres		Pool Grayburg-Jackson	Dedicated Acreage: 40 Acres	

1. Outline the acreage dedicated to the subject well by colored pencil or hachure marks on the plat below.

2. If more than one lease is dedicated to the well, outline each and identify the ownership thereof (both as to working interest and royalty).

3. If more than one lease of different ownership is dedicated to the well, have the interests of all owners been consolidated by communitization, unitization, force-pooling, etc?

☐ Yes ☐ No If answer is "yes," type of consolidation _____

If answer is "no," list the owners and tract descriptions which have actually been consolidated. (Use reverse side of this form if necessary.) _____

No allowable will be assigned to the well until all interests have been consolidated (by communitization, unitization, forced-pooling, or otherwise) or until a non-standard unit, eliminating such interests, has been approved by the Commission.

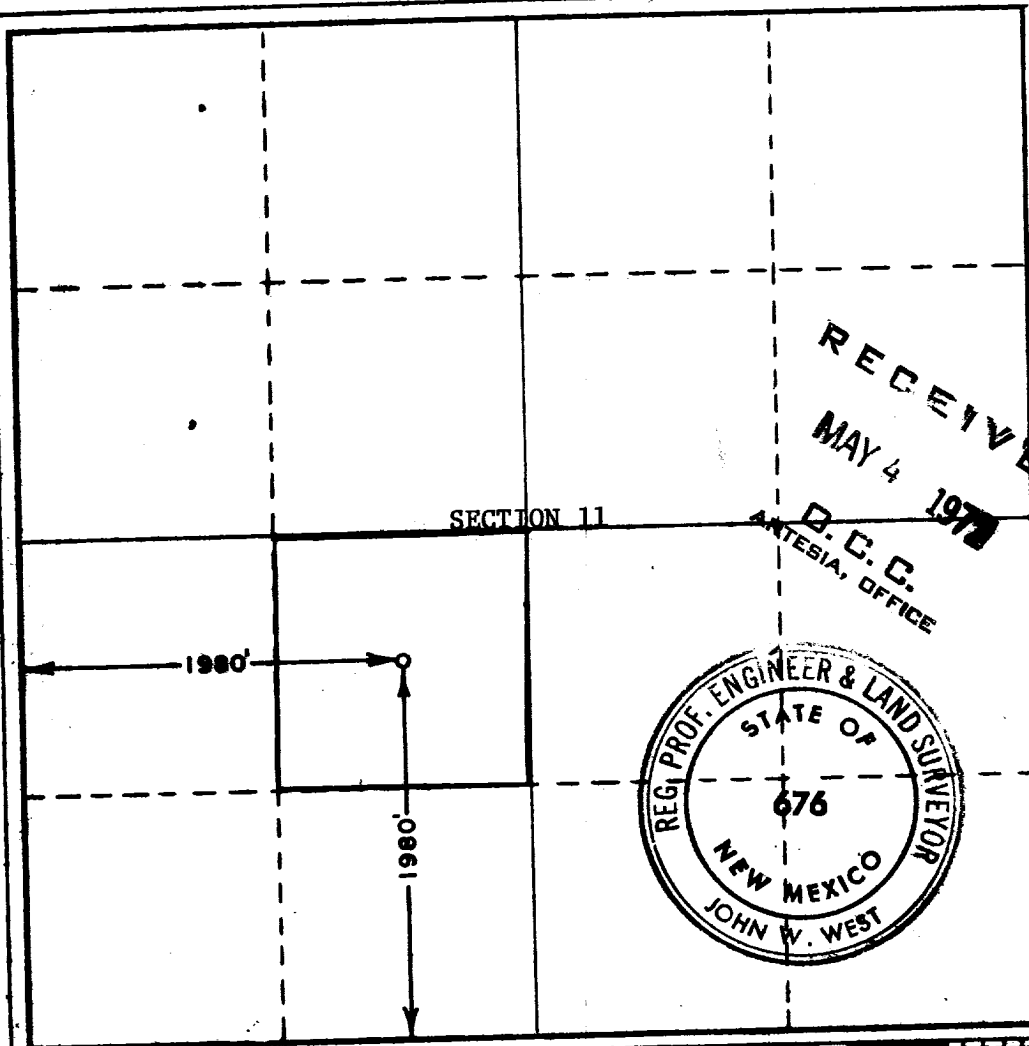

CERTIFICATION

I hereby certify that the information contained herein is true and complete to the best of my knowledge and belief.

Name C. J. Love C. J. Love
Position District Production Manager
Company Skelly Oil Company

Date May 1, 1972

RECEIVED
I hereby certify that the well location shown on this plat was surveyed in the field notes of MAY 2, 1972 by me or under my supervision, and that the same is correct. **U.S. GEOLOGICAL SURVEY**
ARTESIA, NEW MEXICO

Date Surveyed APRIL 27, 1972
Registered Professional Engineer and/or Land Surveyor
John W. West

Certificate No. **676**