

UNITED STATES
DEPARTMENT OF THE INTERIOR
GEOLOGICAL SURVEY

APPLICATION FOR PERMIT TO DRILL, DEEPEN, OR PLUG BACK

1a. TYPE OF WORK DRILL <input checked="" type="checkbox"/> DEEPEN <input type="checkbox"/> PLUG BACK <input type="checkbox"/>		5. LEASE DESIGNATION AND SERIAL NO. NM 074936
b. TYPE OF WELL OIL WELL <input checked="" type="checkbox"/> GAS WELL <input type="checkbox"/> OTHER <input type="checkbox"/> SINGLE ZONE <input type="checkbox"/> MULTIPLE ZONE <input type="checkbox"/>		6. IF INDIAN, ALLOTTEE OR TRIBE NAME
2. NAME OF OPERATOR Kennedy Oil Co., Inc.		7. UNIT AGREEMENT NAME
3. ADDRESS OF OPERATOR Box 151 Artesia, New Mexico 88210		8. FARM OR LEASE NAME McIntyre
4. LOCATION OF WELL (Report location clearly and in accordance with any State requirements.)* At surface 660' FSL Sec. 17, T-17S, R-30E NMPM At proposed prod. zone 860' FWL (SW/4 SW/4)		9. WELL NO. 4
14. DISTANCE IN MILES AND DIRECTION FROM NEAREST TOWN OR POST OFFICE* 1-mile NW Loco Hills, N.M.		10. FIELD AND POOL, OR WILDCAT Grayburg-Jackson X
15. DISTANCE FROM PROPOSED* LOCATION TO NEAREST PROPERTY OR LEASE LINE, FT. (Also to nearest drlg. unit line, if any)	16. NO. OF ACRES IN LEASE 320	11. SEC., T., R., M., OR BLK. AND SURVEY OR AREA. Sec. 17, T-17S, R-30 E NMPM
18. DISTANCE FROM PROPOSED LOCATION* TO NEAREST WELL, DRILLING, COMPLETED, OR APPLIED FOR, ON THIS LEASE, FT.	19. PROPOSED DEPTH 3700'	12. COUNTY OR PARISH 13. STATE Eddy N.M.
21. ELEVATIONS (Show whether DF, RT, GR, etc.) 3649 GR		17. NO. OF ACRES ASSIGNED TO THIS WELL 40
23. PROPOSED CASING AND CEMENTING PROGRAM		20. ROTARY OR CABLE TOOLS Rotary
		22. APPROX. DATE WORK WILL START* Upon Approval

SIZE OF HOLE	SIZE OF CASING	WEIGHT PER FOOT	SETTING DEPTH	QUANTITY OF CEMENT
11"	8 5/8"	20	500'	Circulate
7 7/8"	5 1/2"	14	3700'	400

Propose to drill the Grayburg San Andres producing sections to a depth of 3700'.

Propose to perforate and stimulate as necessary.

Well will either be drilled with air or water. If drilled with air a control head will be used. If drilled with water and native mud the hole will be mudded up 100' from T.D. to clean hole for logging and a 10" 3000 # blowout preventer will be used.

RECEIVED

JUN 5 1972

O. C. C.
ARTESIA, OFFICE

RECEIVED

MAY 12 1972

U. S. GEOLOGICAL SURVEY
ARTESIA, NEW MEXICO

IN ABOVE SPACE DESCRIBE PROPOSED PROGRAM: If proposal is to deepen or plug back, give data on present productive zone and proposed new productive zone. If proposal is to drill or deepen directionally, give pertinent data on subsurface locations and measured and true vertical depths. Give blowout preventer program, if any.

24. SIGNED [Signature] TITLE Vice Pres. DATE May 12, 1972

(This space for Federal or State office use)

PERMIT NO. _____ APPROVAL DATE MAY 26 1972
DISTRICT ENGINEER

APPROVED BY [Signature] TITLE _____ DATE MAY 26 1972
CONDITIONS OF APPROVAL, IF ANY: _____

*See Instructions On Reverse Side

Instructions

General: This form is designed for submitting proposals to perform certain well operations, as indicated, on all types of lands and leases for appropriate action by either a Federal or a State agency, or both, pursuant to applicable Federal and/or State laws and regulations. Any necessary special instructions concerning the use of this form and the number of copies to be submitted, particularly with regard to local, area, or regional procedures and practices, either are shown below or will be issued by, or may be obtained from, the local Federal and/or State office.

Item 1: If the proposal is to redrill to the same reservoir at a different subsurface location or to a new reservoir, use this form with appropriate notations. Consult applicable State or Federal regulations concerning subsequent work proposals or reports on the well.

Item 4: If there are no applicable State requirements, locations on Federal or Indian land should be described in accordance with Federal requirements. Consult local State or Federal office for specific instructions.

Item 14: Needed only when location of well cannot readily be found by road from the land or lease description. A plat, or plats, separate or on this reverse side, showing the roads to, and the surveyed location of, the well, and any other required information, should be furnished when required by Federal or State agency offices.

Items 15 and 18: If well is to be, or has been directionally drilled, give distances for subsurface location of hole in any present or objective production zone.

Item 22: Consult applicable Federal or State regulations, or appropriate officials, concerning approval of the proposal before operations are started.

**NEW MEXICO OIL CONSERVATION COMMISSION
WELL LOCATION AND ACREAGE DEDICATION PLAT**

Form C-102
Supersedes C-128
Effective 1-1-65

All distances must be from the outer boundaries of the Section.

Operator KENNEDY OIL COMPANY, INC.			Lease McINTYRE		Well No. 4
Unit Letter M	Section 17	Township 17 South	Range 30 East	County Eddy	
Actual Footage Location of Well: 660 feet from the South line and 860 feet from the West line					
Ground Level Elev. 3649	Producing Formation Grayburg		Pool Grayburg-Jackson		Dedicated Acreage: 40 Acres

1. Outline the acreage dedicated to the subject well by colored pencil or hachure marks on the plat below.
2. If more than one lease is dedicated to the well, outline each and identify the ownership thereof (both as to working interest and royalty).
3. If more than one lease of different ownership is dedicated to the well, have the interests of all owners been consolidated by communitization, unitization, force-pooling, etc?

☐ Yes ☐ No If answer is "yes," type of consolidation _____

If answer is "no," list the owners and tract descriptions which have actually been consolidated. (Use reverse side of this form if necessary.) _____

No allowable will be assigned to the well until all interests have been consolidated (by communitization, unitization, forced-pooling, or otherwise) or until a non-standard unit, eliminating such interests, has been approved by the Commission.

R 30 E

17

CERTIFICATION

I hereby certify that the information contained herein is true and complete to the best of my knowledge and belief.

[Signature]

Name

Vice President

Position

Kennedy Oil Co., Inc.

Company

May 12, 1972

Date

RECEIVED

I hereby certify that the well location shown on this plat was plotted from field notes of _____ or under the supervision of _____ the same is true and correct to the best of my knowledge and belief.

Date Surveyed

May 11th, 1972

Registered Professional Engineer
and/or Land Surveyor

[Signature: James H. Brown]

Certificate No. **542**

**T
17
S**

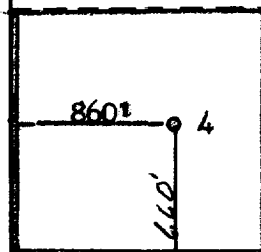

0 330 660 990 1320 1650 1980 2310 2640 2000 1500 1000 500