

UNITED STATES
DEPARTMENT OF THE INTERIOR
GEOLOGICAL SURVEY

30-015-20662

APPLICATION FOR PERMIT TO DRILL, DEEPEN, OR PLUG BACK

1A. TYPE OF WORK

DRILL ☒DEEPEN ☐PLUG BACK ☐

B. TYPE OF WELL

OIL
WELL ☒GAS
WELL ☐OTHER ☐SINGLE
BORE ☐MULTIPLE
BORE ☐

2. NAME OF OPERATOR

GENERAL AMERICAN OIL COMPANY OF TEXAS

3. ADDRESS OF OPERATOR

P. O. BOX 416 Loco Hills, New Mexico 88255

4. LOCATION OF WELL (Report location clearly and in accordance with any State requirements.)

At surface

1980' FSL and 1980' FEL, Sec. 30, T17S, R30E

At proposed prod. zone

14. DISTANCE IN MILES AND DIRECTION FROM NEAREST TOWN OR POST OFFICE*

2 Miles West of Loco Hills, N.M.

10. DISTANCE FROM PROPOSED*
LOCATION TO NEAREST
PROPERTY OR LEASE LINE, FT.
(Also to nearest drig. unit line, if any)

1980'

16. NO. OF ACRES IN LEASE

1115

18. DISTANCE FROM PROPOSED LOCATION*
TO NEAREST WELL, DRILLING, COMPLETED,
OR APPLIED FOR, ON THIS LEASE, FT.

1320'

19. PROPOSED DEPTH

3400'

21. ELEVATIONS (Show whether DF, RT, GR, etc.)

3595' GL

23.

PROPOSED CASING AND CEMENTING PROGRAM

SIZE OF HOLE	SIZE OF CASING	WEIGHT PER FOOT	SETTING DEPTH	QUANTITY OF CEMENT
12-1/8"	8-5/8"	20#	490'	100 bks
7-7/8"	4-1/2"	9.5#	3400'	400 bks

We propose to drill this well to 3400' and complete in the Grayburg and San Andres.
All zones indicating porosity ~~wikit~~ will be acidized or sand fraced.

Mud Program: Water and native mud. Will mud up 100' from T.D. to clean hole for logging. A 10" 3,000# blowout preventer will be used in drilling this well.

IN ABOVE SPACE DESCRIBE PROPOSED PROGRAM: If proposal is to deepen or plug back, give data on present productive zone and proposed new productive zone. If proposal is to drill or deepen directionally, give pertinent data on subsurface locations and measured and true vertical depths. Give blowout preventer program, if any.

24.

SIGNED

H. E. Hallett

TITLE District Superintendent

DATE May 30, 1972

(This space for Federal or State office use)

PERMIT NO.

APPROVAL DATE

JUN 1 1972

APPROVED BY
CONDITIONS OF APPROVAL, IF ANY:*John G. Brail*

TITLE

District Superintendent

DATE

JUN 1 1972

**NEW MEXICO OIL CONSERVATION COMMISSION
WELL LOCATION AND ACREAGE DEDICATION PLAT**

Form C-102
Supersedes C-128
Effective 1-1-65

All distances must be from the outer boundaries of the Section.

Operator GENERAL AMERICAN OIL COMPANY OF TEXAS			Lease 17-30-4		Well No. 23
Unit Letter J	Section 31	Township 17N	Range 30E	County 104	
Actual Footage Location of Well: 1500 feet from the 17-30-4 line and 1500 feet from the 17-30-4 line					
Ground Level Elev. 3770	Producing Formation 17-30-4		Pool 17-30-4		Dedicated Acreage: 10 Acres

1. Outline the acreage dedicated to the subject well by colored pencil or hachure marks on the plat below.
2. If more than one lease is dedicated to the well, outline each and identify the ownership thereof (both as to working interest and royalty).
3. If more than one lease of different ownership is dedicated to the well, have the interests of all owners been consolidated by communitization, unitization, force-pooling, etc?

☐ Yes ☐ No If answer is "yes," type of consolidation _____

If answer is "no," list the owners and tract descriptions which have actually been consolidated. (Use reverse side of this form if necessary.) _____

No allowable will be assigned to the well until all interests have been consolidated (by communitization, unitization, forced-pooling, or otherwise) or until a non-standard unit, eliminating such interests, has been approved by the Commission.

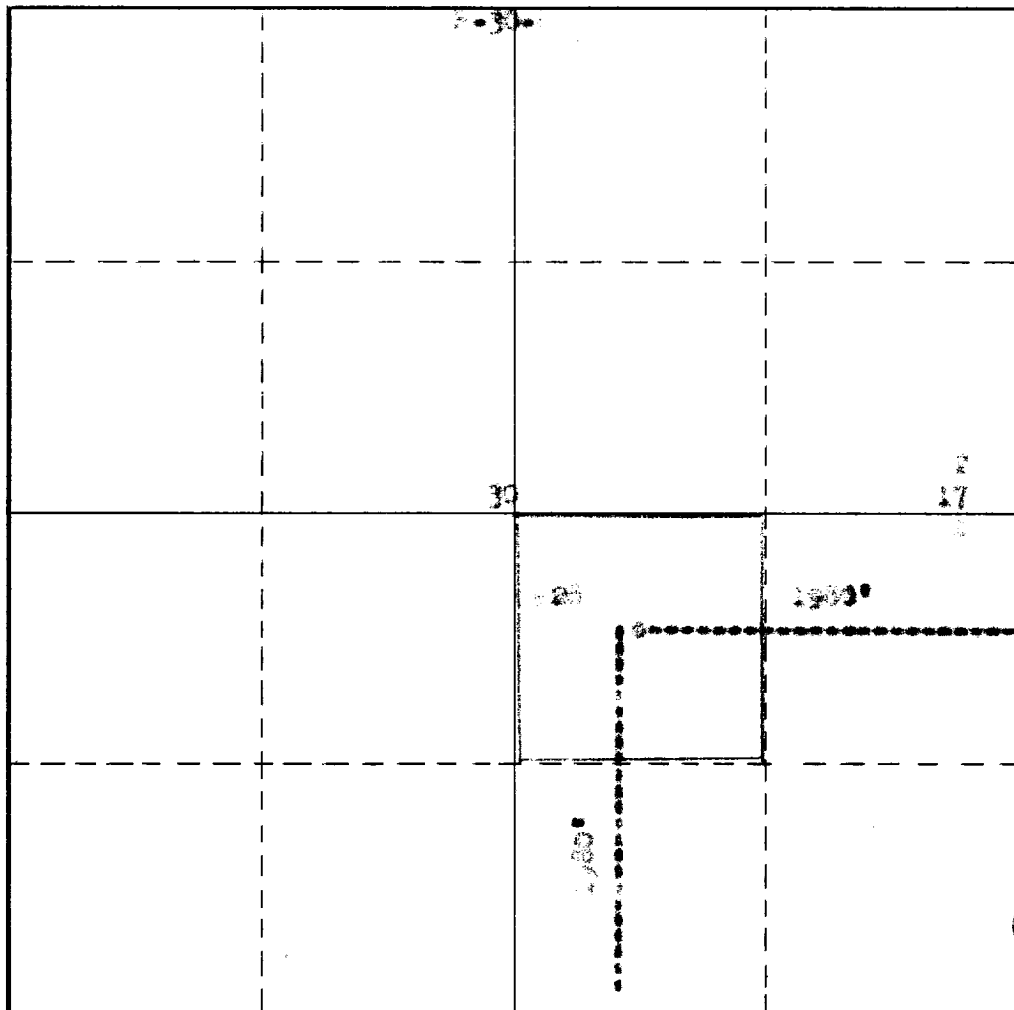

CERTIFICATION

I hereby certify that the information contained herein is true and complete to the best of my knowledge and belief.

W. E. Walter

Name
W. E. Walter
Position
District Superintendent
Company
General American Oil Co. of Texas
Date
May 30, 1972

I hereby certify that the information shown on this plat was placed on field notes by me or under my supervision and that the same is correct to the best of my knowledge and belief.

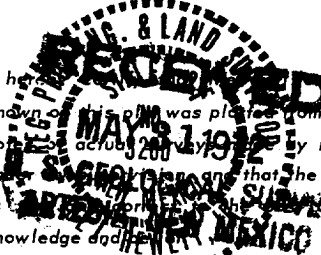

MAY 27 1972

Date Surveyed
May 27 1972
Registered Professional Engineer and/or Land Surveyor

Certificate No.

