

NEW MEXICO OIL CONSERVATION COMMISSION
WELL LOCATION AND ACREAGE DEDICATION PLAT

RECEIVED

Form C-102
Supersedes C-128
Effective 1-1-65
JUN 8 1972

All distances must be from the outer boundaries of the Section.

Operator ANADARKO PRODUCTION COMPANY			Lease Loce Hills FEDERAL #1		O.C. No. ARTESIA, OFFICE 8-9
Unit Letter K	Section 9	Township 17-N	Range 30-E	County Lddy	
Actual Footage Location of Well: 1980 feet from the South line and 1980 feet from the West line					
Ground Level Elev. 3684	Producing Formation Grayour		Pool Grayburg-Jackson	Dedicated Acreage: 40 Acres	

1. Outline the acreage dedicated to the subject well by colored pencil or hachure marks on the plat below.
2. If more than one lease is dedicated to the well, outline each and identify the ownership thereof (both as to working interest and royalty).
3. If more than one lease of different ownership is dedicated to the well, have the interests of all owners been consolidated by communitization, unitization, force-pooling, etc?

☐ Yes ☐ No If answer is "yes," type of consolidation _____

If answer is "no," list the owners and tract descriptions which have actually been consolidated. (Use reverse side of this form if necessary.) _____

No allowable will be assigned to the well until all interests have been consolidated (by communitization, unitization, forced-pooling, or otherwise) or until a non-standard unit, eliminating such interests, has been approved by the Commission.

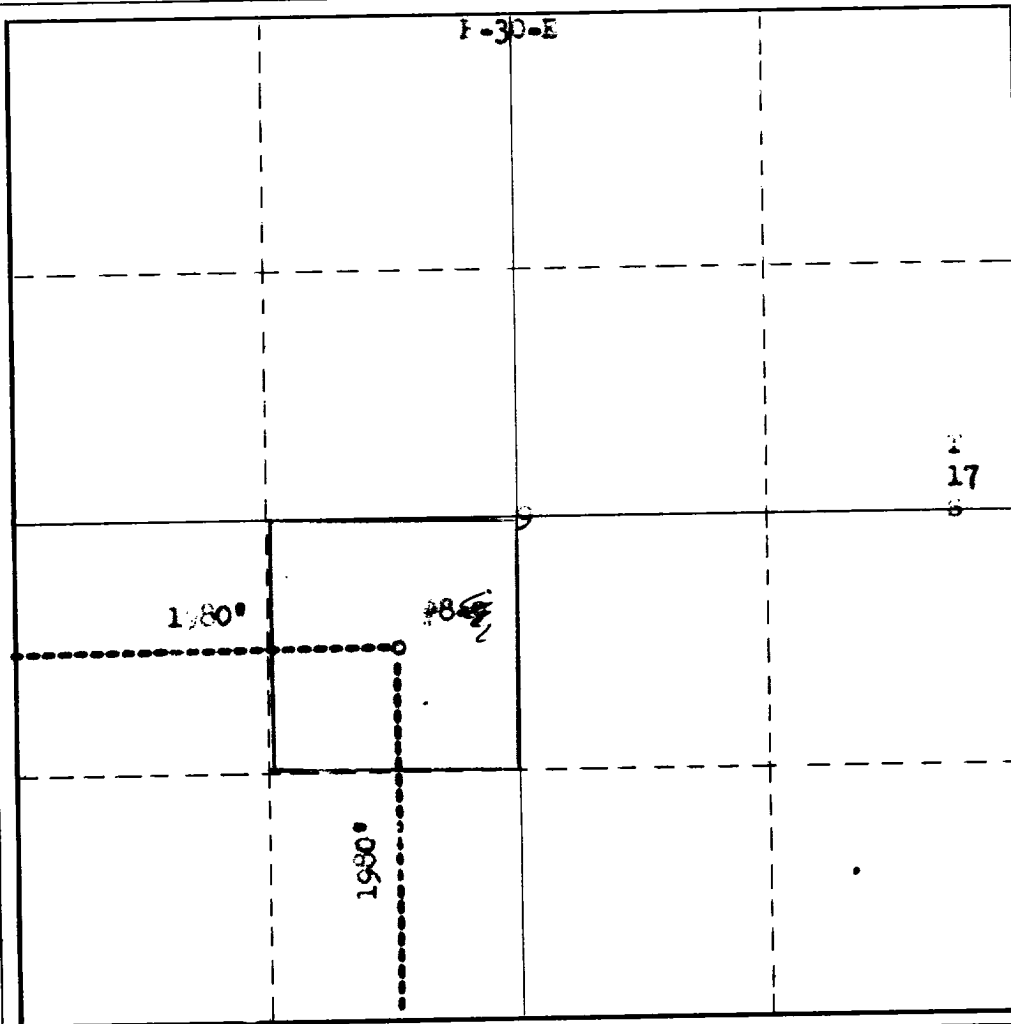

CERTIFICATION

I hereby certify that the information contained herein is true and complete to the best of my knowledge and belief.

Original signed by

Name
D. R. Layton
Position
District Superintendent
Company
Anadarko Production Co.
Date
27 May 1972

I hereby certify that the information shown on this plat was plotted from field notes of **May 11 1972** and that the same is true and correct to the best of my knowledge and belief.

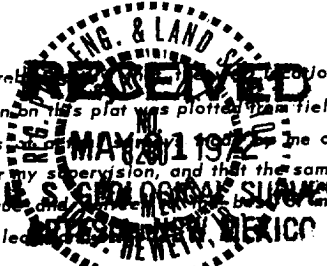

MAY 26 1972

Date Surveyed
May 11 1972
Registered Professional Engineer
and/or Land Surveyor
Jay J. Hewitt

3250.

Certificate No.

